

Nokia Car Kit CK-300

Quick Guide and Safety

Information

DECLARATION OF CONFORMITY

Hereby, NOKIA CORPORATION, declares that this HF-21W product is in compliance with the essential requirements and other relevant provisions of Directive 1999/5/EC. The product is in conformity with the limits defined in Directive 2004/104/EC (amending Directive 72/245/EEC), Annex I, paragraph 6.5, 6.6, 6.8 and 6.9. A copy of the Declaration of Conformity can be found at http://www.nokia.com/phones/declaration_of_conformity/.

CE0434

© 2008 Nokia. All rights reserved.

Reproduction, transfer, distribution or storage of part or all of the contents of this document in any form without the prior written permission of Nokia is prohibited.

Nokia, Nokia Connecting People, and Navi are trademarks or registered trademarks of Nokia Corporation. Other product and company names mentioned herein may be trademarks or tradenames of their respective owners.

Bluetooth is a registered trademark of Bluetooth SIG, Inc.

Nokia operates a policy of ongoing development. Nokia reserves the right to make changes and improvements to any of the products described in this document without prior notice.

Under no circumstances shall Nokia be responsible for any loss of data or income or any special, incidental, consequential or indirect damages howsoever caused.

The contents of this document are provided "as is". Except as required by applicable law, no warranties of any kind, either express or implied, including, but not limited to, the implied warranties of merchantability and fitness for a particular purpose, are made in relation to the accuracy, reliability or contents of this document. Nokia reserves the right to revise this document or withdraw it at any time without prior notice.

The availability of particular products may vary by region. Please check with the Nokia dealer nearest to you.

Export Controls

This device may contain commodities, technology or software subject to export laws and regulations from the US and other countries. Diversion contrary to law is prohibited.

Issue 1 EN

For your safety

Read these simple guidelines. Not following them may be dangerous or illegal. Read the complete user and installation guide for further information.

Your device and its enhancements may contain small parts. Keep them out of reach of small children.

**SWITCH ON SAFELY**

Do not switch the device on when wireless phone use is prohibited or when it may cause interference or danger.

**ROAD SAFETY COMES FIRST**

Obey all local laws. Always keep your hands free to operate the vehicle while driving. Your first consideration while driving should be road safety.

**INTERFERENCE**

All wireless devices may be susceptible to interference, which could affect performance.

**SWITCH OFF WHEN REFUELING**

Do not use the device at a refueling point. Do not use near fuel or chemicals.

**SWITCH OFF NEAR BLASTING**

Follow any restrictions. Do not use the device where blasting is in progress.

**QUALIFIED SERVICE**

Only qualified personnel may install or repair this product.

**ENHANCEMENTS**

Use only approved enhancements. Do not connect incompatible products.

**CONNECTING TO OTHER DEVICES**

When connecting to any other device, read its user guide for detailed safety instructions. Do not connect incompatible products.

1. Quick start

Thank you for choosing the Nokia Car Kit CK-300. With the car kit, you can conveniently make and receive hands-free calls and listen to music stored on your mobile device through your car stereo system.

This chapter describes the basic features of the car kit. Read carefully the complete user and installation guide on the CD-ROM that is supplied with the car kit.

■ Set up

1. Have the car kit installed by a qualified service technician using the original Nokia parts supplied in the sales package. For instructions, see the user and installation guide.
2. If you want to operate the car kit through a user interface optimized for car use, download the CarMenu application from the product page at www.nokia.com or your local Nokia website, and install the application on your compatible mobile device.
3. Connect your compatible mobile device to the car kit using Bluetooth wireless technology. For instructions, see the user and installation guide.

■ Input device

1. Voice dialing key
2. Mute key
3. Mode key
4. Call key
5. End key
6. Navi™ wheel

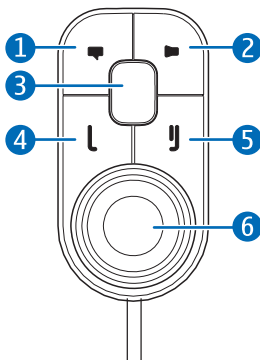

■ Operation without CarMenu

You can operate the car kit with or without the CarMenu application. This section describes how you can use the input device when CarMenu is not installed on your mobile device.

Voice dialing key

Press and hold the voice dialing key to activate voice dialing on a compatible mobile device when no call is in progress.

Mute key

Press the mute key to switch a call between the car kit and a compatible mobile device.

Press and hold the mute key to mute or unmute the microphone during a call.

Mode key

Press the mode key to start, pause, or resume music playback when the music player of your mobile device is active.

Call key

Press the call key to answer a call.

Press the call key twice to redial the last dialed number.

End key

Press the end key to end the active call or reject an incoming call.

Navi wheel

Press and hold the wheel to do the following:

- Switch the car kit on or off when the ignition sense wire is not connected
- Connect the car kit to a paired device (press and hold the wheel for about 1 second)

Turn the wheel to do the following:

- Adjust the volume during a call
- Skip to the next or previous track of a playlist, artist, or album when a track is playing or paused

■ Operation with CarMenu

If you want to operate the car kit through a user interface optimized for car use, download the CarMenu application from the product page at www.nokia.com or your local Nokia website, and install the application on your compatible mobile device. Also read the CarMenu user guide on the CD-ROM.

You can use the Nokia Maps application with CarMenu if Nokia Maps is installed on your mobile device.

Install CarMenu

For the installation, you may need the administrator rights for your PC. You also need the following:

- A compatible mobile device based on Series 60 version 3.0 (or higher). The device must support the Bluetooth specification and profiles described in the user and installation guide.
- An Internet connection from your PC or mobile device. Contact your service provider for information about data transmission charges.
- Three megabytes of free memory in your mobile device
- The USB cable that is supplied with your mobile device
- A compatible PC with the Windows XP or Windows Vista operating system

To install CarMenu to your mobile device, do the following:

1. If you want to install CarMenu on a compatible memory card that you use with your mobile device, insert the card in the device.
2. If you use a PC for the Internet connection, place the supplied CD-ROM in the CD-ROM drive (or a compatible DVD drive) on your PC, and select the CarMenu download option in the program that

starts automatically (if the CD-ROM autorun feature is set to on in Windows). Follow the displayed instructions to download the CarMenu installation file from the Nokia website to the PC, and copy the file from the PC to your mobile device or the memory card inserted in it. You can also download the file from the product page at www.nokia.com or your local Nokia website without using the CD-ROM.

If you use the web browser of your compatible mobile device for the Internet connection, download the CarMenu installation file from the product page at www.nokia.com or your local Nokia website to your mobile device or the memory card inserted in it.

3. Start the installation as described in the user guide of your mobile device, and follow the instructions shown in the installation program.
4. To launch the CarMenu application, switch on the car kit.

Use CarMenu with the input device

Voice dialing key

Press and hold the voice dialing key to activate voice dialing on a compatible mobile device when no call is in progress.

In Nokia Maps, pressing the voice dialing key performs the same function as when you press the 4 key on your mobile device. If navigation is active, the last voice instruction is repeated.

Mute key

Press the mute key to do the following:

- Switch a call between the car kit and a compatible mobile device
- Set the car kit volume to silent when no call is in progress

Press and hold the mute key to mute or unmute the microphone during a call.

Mode key

Press the mode key to do the following:

- Switch between the phone and music player mode and Nokia Maps (if running)
- Return to the main screen of the current mode

Press and hold the mode key to return to the main screen of the phone mode from any mode.

Call key

In the phone mode, press the call key to do the following:

- Answer a call
- Switch between an active call and a call on hold
- View the list of last dialled numbers in the main screen

In the phone mode, press the call key twice to redial the last dialled number in the main screen.

In the music player mode, press the call key to do the following:

- Play the track displayed on your mobile device or pause or resume playing
- Play all the tracks of the selected playlist, artist, or album starting from the first track

In Nokia Maps, pressing the call key performs the same function as when you press the left selection key on your mobile device.

End key

Press the end key to do the following:

- End the active call or reject a call
- Clear a calendar note from the screen
- Return to the previous screen or menu level
- Delete a single character when you write text or numbers
- Stop playing the displayed track in the main screen of the music player mode
- In Nokia Maps, pressing the end key performs the same function as when you press the right selection key on your mobile device

Press and hold the end key to exit to the main screen of the current mode.

Navi wheel

Press the wheel to do the following:

- Answer an incoming call
- Perform the function shown at the bottom of the screen, to select an item (such as a menu function), or to clear a calendar note from the screen
- In Nokia Maps, pressing the Navi wheel performs the same function as when you press the middle selection key or the middle of the scroll key on your mobile device

Press and hold the wheel to do the following:

- Switch the car kit on or off when the ignition sense wire is not connected
- Connect the car kit to a paired device (press and hold the wheel for about 1 second)

Turn the wheel to either direction to do the following:

- Scroll to an item (such as a menu function) or through a list
- Adjust the volume during a call
- In the music player mode, skip to the next or previous track of a playlist, artist, or album when a track is playing or paused
- In Nokia Maps, turning the wheel performs the same function as when you press the scroll key up or down on your mobile device

Turn the wheel left in the main screen to enter a phone number or use speed dialing.

Turn the wheel right in the main screen to search for a contact in [Contacts](#).

■ Charge the connected device

To charge the battery in your compatible Nokia device while using the car kit, connect the device to the car kit using the connectivity cable CA-113CU.

2. Car kit installation

For instructions on installing the car kit parts in a vehicle, refer to the user and installation guide. Observe the following safety guidelines when installing the car kit.

- Only a qualified service technician should install or service the car kit using the approved original Nokia parts supplied in the sales package. Faulty installation or service may be dangerous and may invalidate any warranty which may apply to the car kit.

End users should remember that the car kit comprises complex technical equipment that requires professional installation using special tools and expert know-how.

- Instructions given in the user and installation guide are general guidelines that apply to the installation of the car kit in an automobile. However, due to the wide variety of car types and models available on the market, the guide cannot consider the individual technical requirements relevant to any particular vehicle. Contact the vehicle manufacturer for detailed information about the vehicle in question.
- The car kit is suitable for use only in vehicles with 12-V, negative grounding. Use on other supply voltages or alternative polarity will damage the equipment.
- Remember that modern automotive systems include onboard computers where key vehicle parameters are stored. Improper disconnection of the car battery may cause loss of data, necessitating extensive effort for reinitialization of the system. If you have any concerns, contact your car dealer before any installation work is done.
- Do not wire the car kit equipment to the high-voltage lines of the ignition system.
- When installing the parts of the car kit, ensure that none of them interfere with or hinder the steering or braking systems or other controls or systems used in the operation of the vehicle (for example,

airbags) or disturb your field of vision while driving. Ensure that the car kit and any of its components are not installed where you might come in contact with it in the event of an accident or collision.

When mounting a mobile holder, ensure that the phone display is clearly visible for the user.

- Your service technician or dealer may be able to provide you with information on alternatives for mounting the equipment suitably in your vehicle without requiring drilled holes.
- Do not smoke when working on the car. Ensure that there is no source of fire or flame nearby.
- Take care not to cause damage to electrical cables, fuel or brake lines, or safety equipment during installation work.
- RF signals may affect improperly installed or inadequately shielded electronic systems in motor vehicles such as electronic fuel injection systems, electronic antiskid (antilock) braking systems, electronic speed control systems, and airbag systems. Should you notice a fault or change in the operation of such a system, contact your car dealer.
- Ensure that cables are placed so that they will not be subject to mechanical wear and tear (for example, not laid under car seats or over sharp edges).

■ Integration with a car stereo system

The car kit can be connected to the car stereo system in three different ways. Select the appropriate connection options depending on the components available in the sales package.

Setup option 1

For phone calls, use the ISO system cable CA-139 (if supplied with the car kit), or a cable specific to the car radio, to connect the car kit to the car radio and its speakers.

For music, use a cable specific to your car radio to connect the 3.5-mm (0.14 inch) stereo output to the AUX input of the car radio.

You can connect the car kit to a loudspeaker with an impedance of at least 2 ohms. The optimal impedance for the car kit is 4 ohms. If the impedance is over 8 ohms, the output power is significantly lower than normal.

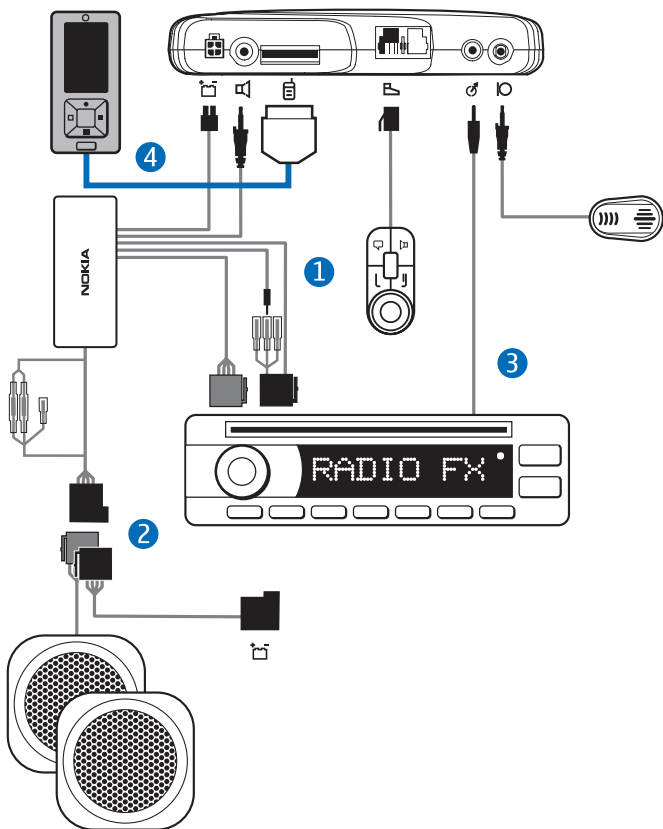

1. Disconnect the two ISO connectors from the car radio for power and loudspeakers, and replace them with the two connectors of the system cable CA-139.

Connect the wire labeled "Mute" of the system cable to one of the wires labeled "Mute 1", "Mute 2", or "Mute 3" according to the pinning of the car radio. Leave the other labeled mute wires

connected as they are. Connect the wires of the same colour together.

For phone calls, connect the system cable CA-139 to the power output and the loudspeaker output of the hands-free unit.

2. Check the +12-V power pin and the ignition pin of the two ISO connectors coming from the car and the respective pins of the system cable CA-139. If necessary, swap the two wires of the system cable. Connect the system cable to the two open ISO connectors.
3. Connect the stereo music output of the hands-free unit (a standard 3.5-mm stereo connector) to the AUX input of the car radio. Use an appropriate cable specific to your car radio (this cable is not supplied with the car kit).
4. To charge a compatible Nokia mobile device through the car kit, connect one end of the connectivity cable CA-113CU to the hands-free unit and the other end to the 2.0-mm (0.08 inch) charging connector of the mobile device.

To play music from a mobile music player that has a standard 3.5-mm (0.14 inch) audio connector, plug the 3.5-mm (0.14 inch) connector of the connectivity cable to the music device.

After you have made all the connections described above, connect the external input device CU-10 and the microphone MP-2 to the respective connectors on the hands-free unit.

Setup option 2

If the car radio has a mobile phone input and an AUX input for music devices, you can connect your mobile device to the speakers of the car radio.

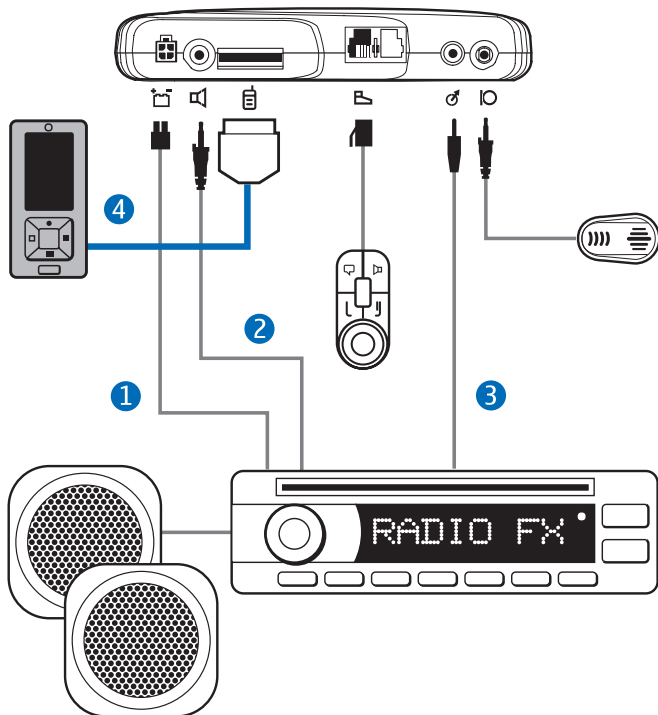

1. Connect the respective wires of the power cable PCU-4 to the car battery and ignition sense (if available). Connect the car radio mute signal (if available) to the car radio. Plug the connector into the hands-free unit.
2. For phone calls, connect the loudspeaker output of the hands-free unit to the mobile phone input of the car radio. Use an appropriate

cable specific to your car radio (this cable is not supplied with the car kit).

3. Connect the stereo music output of the hands-free unit (a standard 3.5-mm stereo connector) to the AUX input of the car radio. Use an appropriate cable specific to your car radio (this cable is not supplied with the car kit).
4. To charge a compatible Nokia mobile device through the car kit, connect one end of the connectivity cable CA-113CU to the hands-free unit and the other end to the 2.0-mm (0.08 inch) charging connector of the mobile device.

To play music from a mobile music player that has a standard 3.5-mm (0.14 inch) audio connector, plug the 3.5-mm (0.14 inch) connector of the connectivity cable to the music device.

After you have made all the connections described above, connect the external input device CU-10 and the microphone MP-2 to the respective connectors on the hands-free unit.

Setup option 3

You can use the external loudspeaker SP-3 and the power cable PCU-4 as follows (if supplied with the car kit):

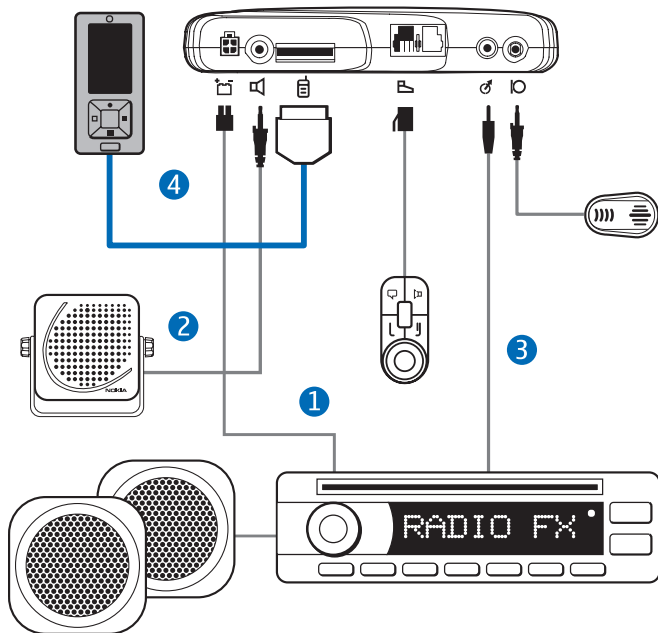

1. Connect the respective wires of the power cable PCU-4 to the car battery and ignition sense (if available). Connect the car radio mute signal (if available) to the car radio. Plug the connector into the hands-free unit.
2. For phone calls, connect the loudspeaker output of the hands-free unit to the loudspeaker SP-3.
3. Connect the stereo music output of the hands-free unit (a standard 3.5-mm stereo connector) to the AUX input of the car radio. Use an

appropriate cable specific to your car radio (this cable is not supplied with the car kit).

4. To charge a compatible Nokia mobile device through the car kit, connect one end of the connectivity cable CA-113CU to the hands-free unit and the other end to the 2.0-mm (0.08 inch) charging connector of the mobile device.

To play music from a mobile music player that has a standard 3.5-mm (0.14 inch) audio connector, plug the 3.5-mm (0.14 inch) connector of the connectivity cable to the music device.

After you have made all the connections described above, connect the external input device CU-10 and the microphone MP-2 to the respective connectors on the hands-free unit.

Care and maintenance

Your car kit is a product of superior design and craftsmanship and should be treated with care. The suggestions below will help you protect your warranty coverage.

- Keep the car kit dry. Precipitation, humidity and all types of liquids or moisture can contain minerals that will corrode electronic circuits.
- Do not use or store the car kit in dusty, dirty areas. Its moving parts and electronic components can be damaged.
- Do not attempt to open the car kit. Non-expert handling may damage it.
- Do not use harsh chemicals, cleaning solvents, or strong detergents to clean the car kit parts.
- Do not paint the car kit parts. Paint can clog the moving parts and prevent proper operation.

If the car kit is not working properly, take the vehicle to an authorized service facility for the car kit to be serviced.

Additional safety information

■ Vehicles

RF signals may affect improperly installed or inadequately shielded electronic systems in motor vehicles such as electronic fuel injection systems, electronic antiskid (antilock) braking systems, electronic speed control systems, and air bag systems. For more information, check with the manufacturer or its representative of your vehicle or any equipment that has been added.

Faulty installation or service may be dangerous and may invalidate any warranty that may apply to the device. Check regularly that all wireless device equipment in your vehicle is mounted and operating properly. Do not store or carry flammable liquids, gases, or explosive materials in the same compartment as the device, its parts, or enhancements. For vehicles equipped with an air bag, remember that air bags inflate with great force. Do not place objects, including installed or portable wireless equipment in the area over the air bag or in the air bag deployment area. If in-vehicle wireless equipment is improperly installed and the air bag inflates, serious injury could result.