

Nokia Stereo Headset WH-800

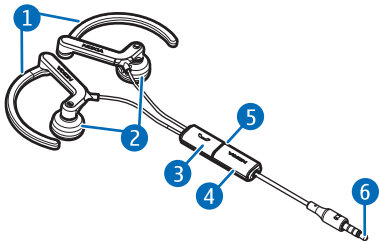

9211097/2



© 2009 Nokia. All rights reserved.

Nokia, Nokia Connecting People and the Nokia Original Accessories logo are trademarks or registered trademarks of Nokia Corporation.

Introduction

With the Nokia Stereo Headset WH-800, you can make and answer calls and listen to music from a compatible device.

This product may contain small parts. Keep them out of the reach of small children. Surface of this device does not contain nickel in platings. Surface of this device contains stainless steel and other alloys.

Parts of the device are magnetic. Metallic materials may be attracted to the device. Do not place credit cards or other magnetic storage media near the device, because information stored on them may be erased.



Warning: When you use the headset, your ability to hear outside sounds may be affected. Do not use the headset where it can endanger your safety.

Get started

To connect the headset to a compatible Nokia device that has the Nokia 3.5 mm AV connector, insert the headset plug (part 6 shown on the title page) into the AV connector. For details, see the user guide of your device.

To connect the headset to a compatible Nokia device that has the Nokia 2.5 mm AV connector, connect the supplied AD-52 adapter to the headset plug and then the adapter to the device.

To connect the headset to a compatible device (such as a music player) that has the standard 3.5 mm audio connector, connect the supplied

AD-63 adapter to the headset plug and then the adapter to the device. When you use this adapter, you can only use the headset to listen to music.

Wear the headset so that the microphone (4) is near to your mouth. Slide the earloops (1) over your ears. Gently insert the earpieces (2) into your ears, and rotate the earloops for the best fit. The headset is now ready for use.

Adjust the volume

To adjust the volume, press the volume key (5) up or down.

Calls

To make a call, use your mobile device in the normal way when the headset is connected to your mobile device. During the call, speak into the microphone of the headset.

If your mobile device supports voice dialling, press and hold the answer/end key (3), and proceed as described in the user guide of your mobile device.

To answer or end a call, press the answer/end key. To reject a call, press the answer/end key twice.

Care and maintenance

Your device is a product of superior design and craftsmanship and should be treated with care. The following suggestions will help you protect your warranty coverage.

- Keep the device dry. Precipitation, humidity, and all types of liquids or moisture can contain minerals that will corrode electronic circuits. If your device does get wet, allow it to dry completely.
- Do not use or store the device in dusty, dirty areas. Its moving parts and electronic components can be damaged.

- Do not store the device in hot areas. High temperatures can shorten the life of electronic devices, damage batteries, and warp or melt certain plastics.
- Do not store the device in cold areas. When the device returns to its normal temperature, moisture can form inside the device and damage electronic circuit boards.
- Do not attempt to open the device.
- Do not drop, knock, or shake the device. Rough handling can break internal circuit boards and fine mechanics.
- Do not use harsh chemicals, cleaning solvents, or strong detergents to clean the device.
- Do not paint the device. Paint can clog the moving parts and prevent proper operation.

If the product is not working properly, take it to the nearest authorised service facility for service.



Disposal

The crossed-out wheeled-bin symbol on your product, literature, or packaging reminds you that all electrical and electronic products, batteries, and accumulators must be taken to separate collection at the end of their working life. This requirement applies to the European Union and other locations where separate collection systems are available. Do not dispose of these products as unsorted municipal waste.

By returning the products to collection you help prevent uncontrolled waste disposal and promote the reuse of material resources. More detailed information is available from the product retailer, local waste authorities, national producer responsibility organizations, or your local Nokia representative. For the product Eco-Declaration or instructions for returning your obsolete product, go to country-specific information at www.nokia.com.