User Guide

Nokia Universal Portable USB Charger DC-19

NOKIA

User Guide

Nokia Universal Portable USB Charger DC-19

Contents

For your safety	3
About your portable charger	4
Keys and parts	5
Charge your portable charger	6
Charge your device with the portable charger	7
Charge your device and portable charger together	8
Product and safety information	9
Copyrights and other notices	9

For your safety

Read these simple guidelines. Not following them may be dangerous or illegal.



ROAD SAFETY COMES FIRST

Obey all local laws. Always keep your hands free to operate the vehicle while driving. Your first consideration while driving should be road safety.



QUALIFIED SERVICE

Only qualified personnel may install or repair this product.



BATTERIES, CHARGERS, AND OTHER ACCESSORIES

Use only batteries, chargers, and other accessories approved by Microsoft Mobile for use with this device. Do not connect incompatible products.



KEEP YOUR DEVICE DRY

Your device is not water-resistant. Keep it dry.

About your portable charger

With the Nokia Universal Portable USB Charger DC-19, you can charge the battery of your phone or a compatible device when you don't have access to a regular power source.

You can easily put the portable charger in your pocket, and take it anywhere you want.

Read this user guide carefully before using the product. Also, read the user guide for the device that you connect to the product.

Keys and parts

Get to know your portable charger.

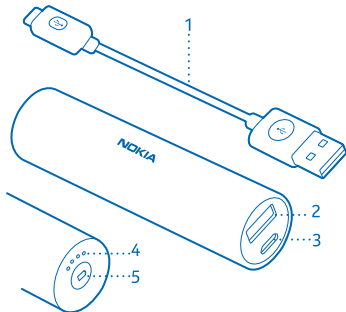

- 1 Charging and data cable CA-189CD
- 2 USB connector
- 3 Charger connector
- 4 Indicator lights
- 5 Power indicator key

The surface of this product is nickel-free.

Some of the accessories mentioned in this user guide, such as charger, headset, or data cable, may be sold separately.

Charge your portable charger

The built-in battery has been partially charged at the factory, but you may need to recharge it before you can use your portable charger.

Charge your portable charger in the correct temperature: 0°C – +45°C. If the temperature is outside this range, all the indicator lights blink fast, and your portable charger stops charging.

1. Plug a compatible USB charger (sold separately) into a wall outlet, or connect the USB end of the cable CA-189CD to a computer.
2. Connect the micro-USB end of the cable CA-189CD to the charger connector of your portable charger.

The indicator lights switch on and 1 indicator light blinks steadily while the battery is charging, showing you the progress. When the battery is fully charged, all the indicator lights switch on for 10 seconds.

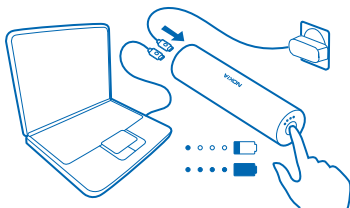

3. When the battery is full, disconnect the compatible USB charger from your portable charger, then from the wall outlet.

When you unplug a charger, hold and pull the plug, not the cord.

Check the battery level

Press the power indicator key. The indicator lights switch on for 10 seconds, showing you the remaining battery level. Each indicator light represents 25% of the battery capacity.

If the battery is empty or low, the first indicator light blinks fast.

You can also check the battery level when disconnecting the charging cable from your portable charger.

Charge your device with the portable charger

Phone battery running out, and no wall outlet or charger nearby? Use the portable charger to charge your phone or other compatible device on the go.

Use your portable charger to charge your device in the correct temperature: -15°C – $+55^{\circ}\text{C}$. If the temperature is outside this range, all the indicator lights blink fast, and your portable charger stops charging.

1. Connect the USB end of the cable CA-189CD to the USB connector of your portable charger.
2. Connect the micro-USB end of the cable CA-189CD to the charger connector of the device you want to charge.

The indicator lights switch off while charging. You can press the power indicator key to check the remaining battery level.

Check your device for the charging progress. The charging time varies based on your device and the usage.

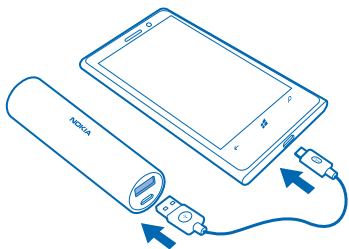

Charge your device and portable charger together

Both your device and portable charger battery low? Find a wall outlet or a computer to charge them together.

1. Connect your device to the portable charger with the cable CA-189CD.
2. Connect your portable charger to a USB compatible wall charger or computer.

Your device charges first, if your portable charger has sufficient power. If not, your portable charger charges first, until its power is sufficient enough.

The indicator lights switch on and 1 indicator light blinks steadily while charging. If your device draws more power than the portable charger gets from the wall charger or computer, the indicator lights show you the decreasing battery level. When your portable charger is fully charged, all the indicator lights switch on for 10 seconds.

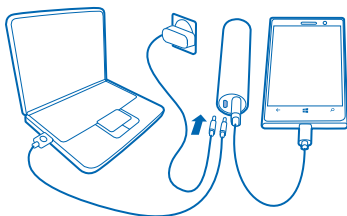

Product and safety information

Take care of your device

Handle your device, battery and accessories with care. The following suggestions help you keep your device operational.

- Keep the device dry. Precipitation, humidity, and all types of liquids or moisture can contain minerals that corrode electronic circuits. If your device gets wet, let the device dry.
- Do not use or store the device in dusty or dirty areas.
- Do not store the device in high temperatures. High temperatures may damage the device or battery.
- Do not store the device in cold temperatures. When the device warms to its normal temperature, moisture can form inside the device and damage it.
- Do not open the device.
- Unauthorized modifications may damage the device and violate regulations governing radio devices.
- Do not drop, knock, or shake the device or the battery. Rough handling can break it.
- Only use a soft, clean, dry cloth to clean the surface of the device.

Recycle



Always return your used electronic products, batteries, and packaging materials to dedicated collection points. This way you help prevent uncontrolled garbage disposal and promote the recycling of materials. All materials of the device can be recovered as materials and energy. Check how to recycle your Nokia products at www.nokia.com/recycle.

Battery and charger info

Your device has an internal, non-removable, rechargeable battery. Do not attempt to remove the battery, as you may damage the device.

Microsoft Mobile may make additional battery or charger models available for this device.

Battery and charger safety

To unplug a charger or an accessory, hold and pull the plug, not the cord.

When your charger is not in use, unplug it. If left unused, a fully charged battery will lose its charge over time.

Always keep the battery between 59°F and 77°F (15°C and 25°C) for optimal performance. Extreme temperatures reduce the capacity and lifetime of the battery. A device with a hot or cold battery may not work temporarily.

Do not dispose of batteries in a fire as they may explode. Obey local regulations. Recycle when possible. Do not dispose as household garbage.

Do not dismantle, cut, crush, bend, puncture, or otherwise damage the battery in any way. If a battery leaks, do not let liquid touch skin or eyes. If this happens, immediately flush the affected areas with water, or seek medical help. Do not modify, attempt to insert foreign objects into the battery, or immerse or expose it to water or other liquids. Batteries may explode if damaged.

Use the battery and charger for their intended purposes only. Improper use, or use of unapproved or incompatible batteries or chargers may present a risk of fire, explosion, or other hazard, and may invalidate any approval or warranty. If you believe the battery or charger is damaged, take it to a service center before continuing to use it. Never use a damaged battery or charger. Only use the charger indoors. Do not charge your device during a lightning storm.

Copyrights and other notices

DECLARATION OF CONFORMITY



Hereby, Microsoft Mobile Oy declares that this DC-19 product is in compliance with the essential requirements and other relevant provisions of Directive 2004/108/EC.

The availability of products may vary by region. For more info, contact your dealer. This device may contain commodities, technology or software subject to export laws and regulations from the US and other countries. Diversion contrary to law is prohibited.

THE CONTENTS OF THIS DOCUMENT ARE PROVIDED "AS IS." EXCEPT AS REQUIRED BY APPLICABLE LAW, NO WARRANTIES OF ANY KIND, EITHER EXPRESS OR IMPLIED, INCLUDING, BUT NOT LIMITED TO, THE IMPLIED WARRANTIES OF MERCHANTABILITY AND FITNESS FOR A PARTICULAR PURPOSE, ARE MADE IN RELATION TO THE ACCURACY, RELIABILITY OR CONTENTS OF THIS DOCUMENT. MICROSOFT MOBILE RESERVES THE RIGHT TO REVISE THIS DOCUMENT OR WITHDRAW IT AT ANY TIME WITHOUT PRIOR NOTICE.

TO THE MAXIMUM EXTENT PERMITTED BY APPLICABLE LAW, UNDER NO CIRCUMSTANCES SHALL MICROSOFT MOBILE OR ANY OF ITS LICENSORS BE RESPONSIBLE FOR ANY LOSS OF DATA OR INCOME OR ANY SPECIAL, INCIDENTAL, CONSEQUENTIAL OR INDIRECT DAMAGES HOWSOEVER CAUSED.

Reproduction, transfer or distribution of part or all of the contents in this document in any form without the prior written permission of Microsoft Mobile is prohibited. Microsoft Mobile operates a policy of continuous development. Microsoft Mobile reserves the right to make changes and improvements to any of the products described in this document without prior notice.

Microsoft Mobile does not make any representations, provide a warranty, or take any responsibility for the functionality, content, or end-user support of third-party apps provided with your device. By using an app, you acknowledge that the app is provided as is.

FCC/INDUSTRY CANADA/MEXICO NOTICE

This device complies with part 15 of the FCC rules and Industry Canada license-exempt RSS standard(s). Operation is subject to the following two conditions: (1) This device may not cause harmful interference, and (2) this device must accept any interference received, including interference that may cause undesired operation. For more info, go to transition.fcc.gov/oet/rfsafety/rf-faqs.html. Any changes or modifications not expressly approved by Microsoft Mobile could void the user's authority to operate this equipment.

Note: This equipment has been tested and found to comply with the limits for a Class B digital device, pursuant to part 15 of the FCC Rules. These limits are designed to provide reasonable protection against harmful interference in a residential installation. This equipment generates, uses and can radiate radio frequency energy and, if not installed and used in accordance with the instructions, may cause harmful interference to radio communications. However, there is no guarantee that interference will not occur in a particular installation. If this equipment does cause harmful interference to radio or television reception, which can be determined by turning the equipment off and on, the user is encouraged to try to correct the interference by one or more of the following measures:

- Reorient or relocate the receiving antenna.
- Increase the separation between the equipment and receiver.
- Connect the equipment into an outlet on a circuit different from that to which the receiver is connected.
- Consult the dealer or an experienced radio/TV technician for help.

TM & © 2014 Microsoft Mobile. All rights reserved. Nokia is a TM of Nokia Corporation. Third party products/names may be TMs of their respective owners.