User Guide

Portable Wireless Speaker MD-12

NOKIA

User Guide

Portable Wireless Speaker MD-12

Contents

Safety	3
Get started	4
About your accessory	4
Keys and parts	4
Charge your speaker	4
Switch your speaker on	5
Basic use	6
Pair and connect	6
About Bluetooth connectivity	6
Pair and connect your speaker using Bluetooth	6
Pair and connect your speaker using NFC	7
Clear the pairings	7
Connect your speaker manually	8
Indicator lights	8
Make and receive calls	8
Listen to music	9
Reset your speaker	9
Product and safety information	10
Copyrights and other notices	11

Safety

Read these simple guidelines. Not following them may be dangerous or illegal.



SWITCH OFF IN RESTRICTED AREAS

Switch the device off when mobile phone use is not allowed or when it may cause interference or danger, for example, in aircraft, in hospitals or near medical equipment, fuel, chemicals, or blasting areas. Obey all instructions in restricted areas.



INTERFERENCE

All wireless devices may be susceptible to interference, which could affect performance.



BATTERIES, CHARGERS, AND OTHER ACCESSORIES

Use only batteries, chargers, and other accessories approved by Microsoft Mobile for use with this device. Do not connect incompatible products.



KEEP YOUR DEVICE DRY

Your device is not water-resistant. Keep it dry.



PROTECT YOUR HEARING

To prevent possible hearing damage, do not listen at high volume levels for long periods. Exercise caution when holding your device near your ear while the loudspeaker is in use.

Get started

Learn how to start using your speaker.

About your accessory

With your Portable Wireless Speaker MD-12, you can listen to music or handle a voice call from your phone or other compatible device. A single speaker fills the room with clear, high-quality audio, and you can enjoy a more powerful sound by placing your speaker on a resonating surface such as a table.

For more info on operation and safety, see the user guide of your phone or other device.

Read this user guide carefully before using the product. Also, read the user guide for the device that you connect to the product.

Keys and parts

Get to know the keys and parts of your speaker.

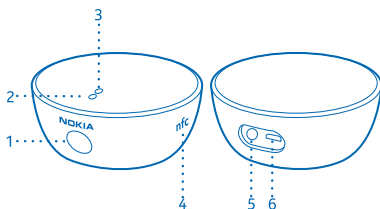

- 1 Multifunction key
- 2 Bluetooth indicator light
- 3 Battery indicator light
- 4 NFC area
- 5 Audio connector (3.5 mm)
- 6 Charger connector

The surface of this product is nickel-free.

Some of the accessories mentioned in this user guide, such as charger, headset, or data cable, may be sold separately.

Charge your speaker

Charge your speaker using a USB cable connected to a computer, or a compatible charger.



Charge the battery before using the speaker.

1. Connect a compatible USB cable to your computer or a compatible charger to a wall outlet.
2. Connect the micro-USB end of the cable to the charger connector on your speaker. When the battery is fully charged, the red battery indicator light turns green.
3. Disconnect the cable from the speaker, then from the computer, or disconnect the charger from the wall outlet.

Switch your speaker on

Switch your speaker on to check the battery.

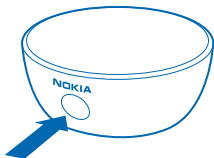

Press and hold the multifunction key for 3 seconds. If the battery is full, the battery indicator light flashes green once. If the battery indicator light is orange, you may need to charge the battery soon. If the light flashes red fast, charge the battery. When the battery is critically low, the speaker beeps repeatedly.

The speaker automatically connects to the last connected device. If you have never paired your speaker with a device, or you have cleared the pairings, the speaker goes into pairing mode.

If the speaker is not connected within 30 minutes, it switches off.

Switch the speaker off

Press and hold the multifunction key for 4 seconds. The speaker closes all connections and switches off.

Basic use

Learn the basics of using your speaker.

Pair and connect

Before you can use your speaker, you need to connect it to a compatible device.

Connect your speaker with:

- Bluetooth
- NFC
- Standard audio cable (3.5 mm)

You can pair your speaker with up to 8 devices, but connect to only one at a time.

If the connected device leaves the Bluetooth range, the speaker tries to reconnect for 15 minutes. If the device returns within range, the speaker reconnects automatically. The speaker stays connectable for another 15 minutes before switching off.

About Bluetooth connectivity

You can use Bluetooth to connect wirelessly to other compatible devices, such as mobile phones.

The devices don't have to be in direct line of sight, but they must be within 10 metres (33 feet) of each other. The connection may be affected by obstructions such as walls or other electronic devices.



This device is compliant with Bluetooth Specification 3.0 supporting the following profiles: hands-free (1.6), headset (1.2), advanced audio distribution (1.3), and audio/video remote control (1.5). Check with the manufacturers of other devices to determine their compatibility with this device.

Pair and connect your speaker using Bluetooth

Before using the speaker, connect it to a compatible device.

1. When the speaker is switched off, press and hold the multifunction key for 5 seconds. The Bluetooth indicator light flashes quickly.

2. Switch Bluetooth on in your device, search for Bluetooth devices, and select the speaker from the list.

3. If necessary, type in the passcode **0000**.

When the speaker is connected, the Bluetooth indicator light flashes slowly.

The next time you switch the speaker on, it automatically connects to the last connected device. To switch to another previously paired device, first close the active connection in your connected device.

If the connection is lost, the Bluetooth indicator light flashes twice repeatedly.

Pair and connect your speaker using NFC

If your device supports Near Field Communication (NFC), it's easy to pair your speaker.

Before pairing, unlock the phone screen and make sure NFC is switched on in your compatible device.

Tap the NFC areas of the speaker and the device together. The device connects to the speaker automatically. If the speaker is switched off, it switches on before connecting.

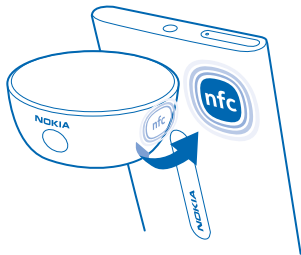

★ **Tip:** To reconnect a previously paired device, tap the NFC areas of the device and the speaker together. The speaker closes the active connection before reconnecting.

To close the connection, tap the NFC areas together again.

For more info on NFC, see the user guide of your device.

Clear the pairings

If you want to clear all the pairings and settings, restore your speaker to the factory settings.

Make sure the speaker is switched off.

Press and hold the multifunction key for more than 8 seconds.

The battery indicator light flashes green and red and the speaker goes back into pairing mode.

After you've cleared the pairings, you must pair the speaker before you can use it again.

If you want to pair with the same device after clearing the pairings, also clear that pairing in the other device before pairing again.

Connect your speaker manually

If your device doesn't support Bluetooth, you can use a standard audio cable (3.5 mm) to connect your speaker.

Make sure your speaker is switched on.

Connect a standard audio cable (3.5 mm) to the audio connector on your speaker and on your device.

When you connect your speaker using a cable, Bluetooth is switched off automatically, and the Bluetooth indicator light stays on.

When you disconnect the cable, Bluetooth is switched on, and the speaker connects automatically to the last connected Bluetooth device.

Indicator lights

Wonder what the different lights on your speaker mean?

Battery indicator lights:

One long flash	Switching on or off
Continuous	Charging
Off	The battery is fully charged

Bluetooth indicator light:

Flashing quickly	Pairing
Flashing slowly	Connected
Flashing twice repeatedly	Connection is lost
Continuous	Bluetooth is switched off

Make and receive calls

Need to pick up a call on the go? You can use your speaker for handling voice calls.

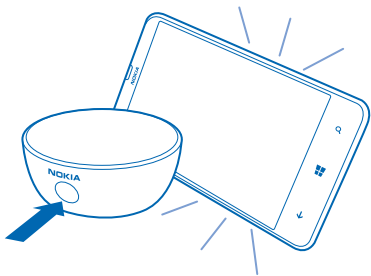

Make sure your speaker is on and connected to your compatible device.

1. To make a call, use the phone.
2. To answer or end a call, press the multifunction key once.
3. To reject an incoming call, press the multifunction key twice.

★ **Tip:** If the voice call quality is poor when you're using your speaker, switch Wi-Fi off in your phone.

Listen to music

With your speaker, you can fill the room with music from your phone or computer.

Connect a phone or other compatible device to your speaker, and use your device to play your favourite music.

★ **Tip:** To enjoy an even more powerful sound, place the speaker on a resonating surface, such as a table.

⚠ **Warning:** Continuous exposure to high volume may damage your hearing. Listen to music at a moderate level.

Reset your speaker

If you encounter problems, resetting your speaker may help.

1. Connect a standard audio cable (3.5 mm) to the audio connector on your speaker.
2. Press and hold the multifunction key, and at the same time, connect the speaker to a computer using a compatible charging cable, or to a compatible charger plugged into a wall outlet.

Resetting your speaker preserves your pairings and other settings.

Product and safety information

Take care of your device

Handle your device, battery and accessories with care. The following suggestions help you keep your device operational.

- Keep the device dry. Precipitation, humidity, and all types of liquids or moisture can contain minerals that corrode electronic circuits. If your device gets wet, let the device dry.
- Do not use or store the device in dusty or dirty areas.
- Do not store the device in high temperatures. High temperatures may damage the device or battery.
- Do not store the device in cold temperatures. When the device warms to its normal temperature, moisture can form inside the device and damage it.
- Do not open the device.
- Unauthorised modifications may damage the device and violate regulations governing radio devices.
- Do not drop, knock, or shake the device or the battery. Rough handling can break it.
- Only use a soft, clean, dry cloth to clean the surface of the device.

Parts of the device are magnetic. Metallic materials may be attracted to the device. Do not place credit cards or other magnetic storage media near the device, because info stored on them may be erased.

Recycle



Always return your used electronic products, batteries, and packaging materials to dedicated collection points. This way you help prevent uncontrolled waste disposal and promote the recycling of materials. All materials of the device can be recovered as materials and energy. Check how to recycle your Microsoft Mobile products at www.nokia.com/recycle.

Crossed-out wheeled-bin symbol



The crossed-out wheeled-bin symbol on your product, battery, literature, or packaging reminds you that all electrical and electronic products and batteries must be taken to separate collection at the end of their working life. Do not dispose of these products as unsorted municipal waste: take them for recycling. For info on your nearest recycling point, check with your local waste authority, or go to www.nokia.com/support. For more info on the environmental attributes of your device, see www.nokia.com/ecoprofile.

Battery and charger info

Your device has an internal, non-removable, rechargeable battery. Do not attempt to remove the battery, as you may damage the device.

Microsoft Mobile may make additional battery or charger models available for this device.

Battery and charger safety

To unplug a charger or an accessory, hold and pull the plug, not the cord.

When your charger is not in use, unplug it. If left unused, a fully charged battery will lose its charge over time.

Always keep the battery between 15°C and 25°C (59°F and 77°F) for optimal performance. Extreme temperatures reduce the capacity and lifetime of the battery. A device with a hot or cold battery may not work temporarily.

Do not dispose of batteries in a fire as they may explode. Obey local regulations. Recycle when possible. Do not dispose as household waste.

Do not dismantle, cut, crush, bend, puncture, or otherwise damage the battery in any way. If a battery leaks, do not let liquid touch skin or eyes. If this happens, immediately flush the affected areas with water, or seek medical help. Do not modify, attempt to insert foreign objects into the battery, or immerse or expose it to water or other liquids. Batteries may explode if damaged.

Use the battery and charger for their intended purposes only. Improper use, or use of unapproved or incompatible batteries or chargers may present a risk of fire, explosion, or other hazard, and may invalidate any approval or warranty. If you believe the battery or charger is damaged, take it to a service centre before continuing to use it. Never use a damaged battery or charger. Do not charge your device during a lightning storm. Only use the charger indoors.

Implanted medical devices

To avoid potential interference, manufacturers of implanted medical devices recommend a minimum separation of 15.3 centimetres (6 inches) between a wireless device and the medical device. Persons who have such devices should:

- Always keep the wireless device more than 15.3 centimetres (6 inches) from the medical device.
- Switch the wireless device off if there is any reason to suspect that interference is taking place.
- Follow the manufacturer directions for the implanted medical device.

If you have any questions about using your wireless device with an implanted medical device, consult your health care provider.

Copyrights and other notices

DECLARATION OF CONFORMITY

CE0979

Hereby, Microsoft Mobile Oy declares that this MD-12 product is in compliance with the essential requirements and other relevant provisions of Directive 1999/5/EC. A copy of the Declaration of Conformity can be found at www.nokia.com/global/declaration-of-conformity.

The availability of products may vary by region. For more info, contact your dealer. This device may contain commodities, technology or software subject to export laws and regulations from the US and other countries. Diversion contrary to law is prohibited.

The contents of this document are provided "as is". Except as required by applicable law, no warranties of any kind, either express or implied, including, but not limited to, the implied warranties of merchantability and fitness for a particular purpose, are made in relation to the accuracy, reliability or contents of this document. Microsoft Mobile reserves the right to revise this document or withdraw it at any time without prior notice.

To the maximum extent permitted by applicable law, under no circumstances shall Microsoft Mobile or any of its licensors be responsible for any loss of data or income or any special, incidental, consequential or indirect damages howsoever caused.

Reproduction, transfer or distribution of part or all of the contents in this document in any form without the prior written permission of Microsoft Mobile is prohibited. Microsoft Mobile operates a policy of continuous development. Microsoft Mobile reserves the right to make changes and improvements to any of the products described in this document without prior notice.

Microsoft Mobile does not make any representations, provide a warranty, or take any responsibility for the functionality, content, or end-user support of third-party apps provided with your device. By using an app, you acknowledge that the app is provided as is.

FCC/INDUSTRY CANADA NOTICE

This device complies with part 15 of the FCC rules and Industry Canada licence-exempt RSS standard(s). Operation is subject to the following two conditions: (1) This device may not cause harmful interference, and (2) this device must accept any interference received, including interference that may cause undesired operation. For more info, go to transition.fcc.gov/oet/rfsafety/rf-faqs.html. Any changes or modifications not expressly approved by Microsoft Mobile could void the user's authority to operate this equipment.

Note: This equipment has been tested and found to comply with the limits for a Class B digital device, pursuant to part 15 of the FCC Rules. These limits are designed to provide reasonable protection against harmful interference in a residential installation. This equipment generates, uses and can radiate radio frequency energy and, if not installed and used in accordance with the instructions, may cause harmful interference to radio communications. However, there is no guarantee that interference will not occur in a particular installation. If this equipment does cause harmful interference to radio or television reception, which can be determined by turning the equipment off and on, the user is encouraged to try to correct the interference by one or more of the following measures:

- Reorient or relocate the receiving antenna.
- Increase the separation between the equipment and receiver.
- Connect the equipment into an outlet on a circuit different from that to which the receiver is connected.

- Consult the dealer or an experienced radio/TV technician for help.

NOTE: FCC Radiation Exposure Statement: This equipment complies with FCC radiation exposure limits set forth for an uncontrolled environment. This transmitter must not be co-located or operating in conjunction with any other antenna or transmitter.

TM & © 2014 Microsoft Mobile. All rights reserved. Nokia is a TM of Nokia Corporation. Third party products/names may be TMs of their respective owners.

The Bluetooth word mark and logos are owned by the Bluetooth SIG, Inc. and any use of such marks by Microsoft Mobile is under license.