

Nokia N9 User Guide

Contents	
Safety	4
Get started	6
Keys and parts	6
Insert the SIM card and charge the battery	8
First start-up	11
Find more help	15
Basic use	15
Home views and status area	15
Touch screen	20
Write text	24
Control profiles, tones, and volume	28
Search your phone	29
Explore Nokia services	29
Personalisation	31
Change the wallpaper	31
View notifications and feeds	31
Connectivity	32
Internet connections	32
WLAN	34
NFC	35
Bluetooth	38
USB data cable	40
Web and RSS feeds	40
Web browser	40
RSS feeds	42
Contacts and social networking friends	43
Contacts	43
Social networking friends	46
Calls	47
Ways to make calls	47
Call a phone number	48
Call a contact	48
Make a conference call	48
Answer or decline calls	49
Answer a call	49
Reject a call	49
Turn to silence	50
Divert calls to your voice mailbox or another phone number	50
Call your voice mailbox	51
During a call	51
Activate the loudspeaker during a call	51
Noise cancellation	51
Answer a waiting call	52
Recent calls	52
View your missed calls	53
View your received calls	53
Call the last dialled number	53
About internet calls	53
Install an internet call service	54
Sign in to an internet call service	54
Make an internet call	54
Set your availability status	55
Messaging and social networks	55
Set up all your accounts in one go	55
Messages	56
Instant messaging	58
Mail	58
Mail for Exchange	60
Music and videos	61
Music player	61
Videos	64
Camera and Gallery	65
Take photos	65
Record videos	69
Send and share photos and videos	69
Gallery	71
Photo editor	74

Video editor	75
View your photos and videos wirelessly on your home entertainment system	75

Maps and navigation	76
GPS	76
Maps	78
Drive	85

Productivity and time	88
Time management	88
Productivity	92

Phone management	93
Keep your phone software and applications up to date	93
Back up	94
Manage applications	95
Memory	97
Synchronise content	97
Protect your phone	98
Reset your phone	100
Battery	101

Tips	103
Access codes	103
Send your security code to a trusted person	104

Protect the environment	104
Save energy	104
Recycle	104

Product and safety information	105
---------------------------------------	------------

Index	112
--------------	------------

Safety

Read these simple guidelines. Not following them may be dangerous or illegal. For further information, read the complete user guide.

SWITCH OFF IN RESTRICTED AREAS



Switch the device off when mobile phone use is not allowed or when it may cause interference or danger, for example, in aircraft, in hospitals or near medical equipment, fuel, chemicals, or blasting areas. Obey all instructions in restricted areas.

ROAD SAFETY COMES FIRST



Obey all local laws. Always keep your hands free to operate the vehicle while driving. Your first consideration while driving should be road safety.

INTERFERENCE



All wireless devices may be susceptible to interference, which could affect performance.

QUALIFIED SERVICE



Only qualified personnel may install or repair this product.

BATTERIES, CHARGERS, AND OTHER ACCESSORIES



Use only batteries, chargers, and other accessories approved by Nokia for use with this device. Third-party chargers that comply with the IEC/EN 62684 standard, and that can connect to your device micro USB connector, may be compatible. Do not connect incompatible products.

KEEP YOUR DEVICE DRY



Your device is not water-resistant. Keep it dry.

GLASS PARTS



The device screen is made of glass. This glass can break if the device is dropped on a hard surface or receives a substantial impact. If the glass breaks, do not touch the glass parts of the device or attempt to remove the broken glass from the device. Stop using the device until the glass is replaced by qualified service personnel.

PROTECT YOUR HEARING

Listen to a headset at a moderate level, and do not hold the device near your ear when the loudspeaker is in use.

Get started

Keys and parts

Front

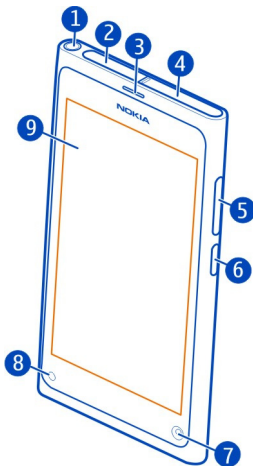

- 1 Nokia AV connector (3.5 mm)
- 2 Micro-USB connector
- 3 Earpiece
- 4 SIM card holder
- 5 Volume/Zoom key. Used also to change the profile.
- 6 Power/Lock key
- 7 Front camera lens
- 8 Charging indicator
- 9 Touch screen

Do not attempt to remove the battery from the device. To replace the battery, take the device to your nearest authorised service facility.

Back

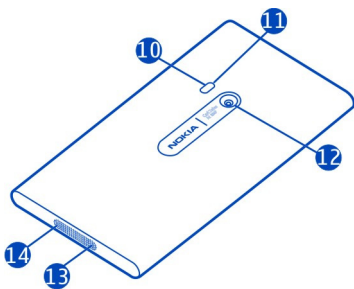

- 10 Camera flash
- 11 Secondary microphone
- 12 Camera lens. If there is protective tape on the camera lens, remove the tape.
- 13 Microphone
- 14 Loudspeaker

Headset

You can connect a compatible headset or compatible headphones to your phone.

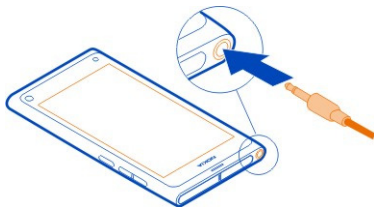

Control music with your headset

To pause or resume playback, press the button on the headset. To skip to the next song, press the button for about two seconds.

Do not connect products that create an output signal, as this may damage the device. Do not connect any voltage source to the Nokia AV connector. If you connect an external device or headset, other than those approved by Nokia for use with this device, to the Nokia AV connector, pay special attention to volume levels.

Antenna locations

Avoid touching the antenna area while the antenna is in use. Contact with antennas affects the communication quality and may reduce battery life due to higher power level during operation.

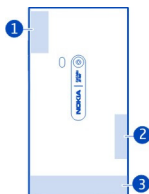

- 1 GPS antenna
- 2 Bluetooth and WLAN antenna
- 3 Cellular antenna

Insert the SIM card and charge the battery

Insert the SIM card

This device is designed to be used with a mini-UICC SIM card, also known as a micro-SIM card only. A micro-SIM card is smaller than the standard SIM card.

Do not attach any stickers to your SIM card.

- 1 To open the cover of the micro-USB connector, press the left end of the cover.

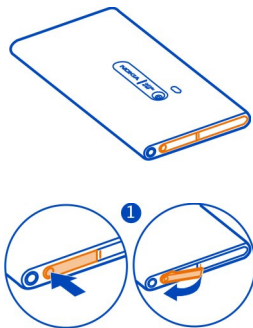

- 2 To unlock the SIM card holder, slide the holder to the left. Carefully pull out the holder.

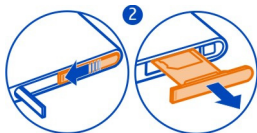

- 3 Make sure the contact area is facing up, and insert the SIM card into the SIM card holder.



- 4 Insert the SIM card holder back into the phone. To lock the SIM card holder, slide the holder to the right.



- 5 Close the cover of the micro-USB connector.

Remove the SIM card

- 1 Open the cover of the micro-USB connector.
- 2 To unlock the SIM card holder, slide the holder to the left. Carefully pull out the holder.
- 3 Pull the card out.

Charge the battery

Your battery has been partially charged at the factory, but you may need to recharge it before you can switch on your phone for the first time.

If the phone indicates a low charge, do the following:

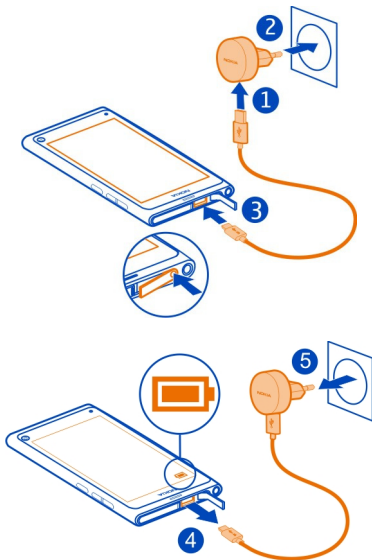

You do not need to charge the battery for a specific length of time, and you can use the phone while it is charging.

When the battery is charging, the charging indicator flashes slowly. When the battery is full, the charging indicator is continuously on.

If the battery is completely discharged, it may take several minutes before the charging indicator is displayed or before any calls can be made.

Charge the battery over USB

Battery low, but you don't have a charger with you? You can use a compatible USB cable to connect your phone to a compatible device, such as a computer.

You can use USB charging when a wall outlet is not available. Data can be transferred while charging the device. The efficiency of USB charging power varies significantly, and it may take a long time for charging to start and the device to start functioning.

You can use your phone while it's charging.

To avoid breaking the charger connector, be careful when connecting or disconnecting the charger cable.



About the battery

Your phone has an internal, nonremovable, rechargeable battery. Use only Nokia approved chargers designated for this phone. You can also use a compatible USB data cable to charge your phone.

! **Important:** Only qualified personnel or an authorised service facility should replace the battery. Unauthorised battery replacement may invalidate your warranty.

Authorised retail points may also offer a battery replacement service.

To check the condition of the battery, select  and **Device > Battery**.

You can set your phone to automatically activate power saving mode when the battery charge level is low. Select  and **Device > Battery > Power saving mode**, and activate **Automatic**.

When power saving mode is activated, you may not be able to modify the settings of certain applications.

First start-up

Switch the phone on or off

Press and hold the power key until the phone vibrates.

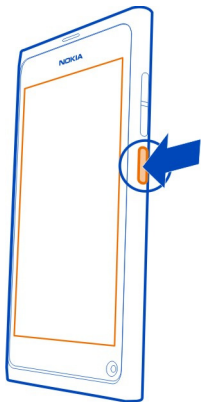

Use your phone for the first time

Get off to a flying start – your phone guides you through the initial setup when you insert your SIM card and switch your phone on for the first time. You can also subscribe to the Tips and Offers service, to receive helpful tips and tricks on how to make the most of your phone.

To use Nokia services, create a Nokia account. You need an internet connection. For information about data transmission charges, contact your service provider. If you can't connect to the internet, you can create an account later.

If you already have a Nokia account, sign in.

Tip: Forgotten your password? You can request it to be sent to you in a mail or text message.

To create a Nokia account later, use your phone to access a Nokia service, and you are prompted to create an account.

To make an emergency call during the initial setup, select .

Lock the keys and screen

To avoid accidentally making a call when your phone is in your pocket or bag, lock the keys and screen of your phone.

Press the power key.

Unlock the keys and screen

Press the power key, and swipe from the outside of the screen onto the screen. You can swipe from any direction.

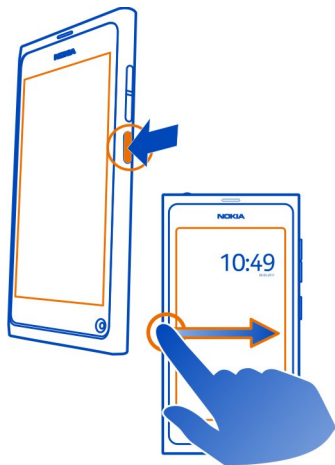

Tip: You can also tap the screen twice, and swipe from the outside of the screen onto the screen.

Tip: Received a notification on the lock screen? To go straight to the related application, drag the notification to the left or right edge of the screen.

Set the keys and screen to lock automatically



- 1 Select  and Device > Display > Display time-out.
- 2 Select the length of time after which the keys and screen are locked automatically.

Copy contacts from your old phone

If your contacts list is empty, you can easily copy your contacts from your old phone — even if it's not a Nokia phone.

Your old phone needs to support Bluetooth, and the contacts need to be stored in the phone memory, not on the SIM card.

Select , and follow the instructions.

Tip: To copy your contacts later, in the contacts list, select  > **Import contacts**. To copy your calendar events and text messages, select  > **Sync and backup** > **Sync**. The available options may vary.

Copy content from your computer

Get off to a flying start without missing a beat. You can copy your important info, such as calendar entries and contacts, to your new phone from your computer.

If your calendar and other content is stored online, for example, in a Google, Microsoft Exchange, or Windows Live account, just add the account to your phone, and sync content straight from the cloud.

- 1 Select .
- 2 Add your account to your phone.
- 3 Check that the sync is active, and select **Done**.

Tip: If you use an online calendar, you may be able to sync it with CalDAV.

If your content, such as contacts and calendar entries, is only stored locally in Outlook on your PC, copy them to your new phone from your Hotmail account.

- 1 Sync the desired content from your Outlook to Hotmail using Microsoft Office Outlook Hotmail Connector. To download and install, search for it at www.microsoft.com/download, and follow the instructions shown on your computer. You may need to select to manually configure the settings.
- 2 To import the content from Hotmail to your new phone, select , and **Add account** > **Mail for Exchange**.
- 3 Type in your Hotmail or Windows Live mail address, your username and password, and select **Manual setup**.
- 4 Type in **m.hotmail.com** as the server address, and select **Done**.

Install Nokia Link on your computer

Have your favourites with you, wherever you may roam. Use the Nokia Link computer application to sync your own music, videos, and photos, or back up your phone to your computer.

To find out more about Nokia Link, or to download and install the latest version on your computer, go to www.nokia.com/nokialink.

When you connect your phone to your computer, select **Sync and connect** as the USB connection mode.

Your phone is not compatible with Nokia Suite.

Find more help

Use the user guide in your phone

Select .

Search the user guide

Select , and start entering a word in the search field.

Switch between the user guide and an application

To return to the home view, swipe from the outside of the screen onto the touch screen. To open the desired application, select the application from the Applications or Open applications view.

Links to related topics may be at the end of instructions.

Support

When you want to learn more about how to use your phone, or if you're unsure how your phone should work, read the user guide in your phone. Select .

If you have an issue, do the following:

- Reboot your phone. Press and hold the power key for at least 8 seconds. The phone switches off. To switch your phone on again, press and hold the power key until the phone vibrates.
- Update your phone software
- Restore the original factory settings

If your issue remains unsolved, contact Nokia for repair options. Go to www.nokia.com/repair. Before sending your phone for repair, always back up your data, as all personal data in your phone may be deleted.

Basic use

Home views and status area

Switch between views

Your phone has separate views for applications, notifications and feeds, and for open applications.

Flick left or right.

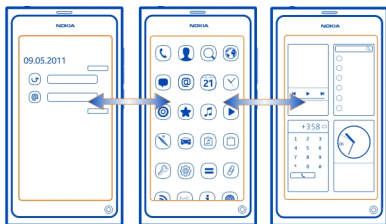

- In the Events view, you receive notifications of messages and missed calls. Feeds from different applications or services are also displayed.
- In the Applications view, you can open applications.
- In the Open applications view, you can switch between open applications and tasks, and close applications you're not using.

Close an application

Tap and hold the Open applications view, and select  on the application.

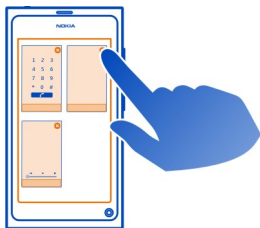

Tip: To close the current application fully, you can also swipe from the top of the screen. Unsaved data in the app may be lost.

Switch between open applications

In the Open applications view, you can see which applications and tasks are open in the background, and switch between them.

Select the desired application.

Tip: To see an overview of open applications, place two fingers on the screen, and slide your fingers together. To return to the more detailed view, slide your fingers apart.

Applications running in the background increase the demand on battery power and use memory. To close an application that you are not using, tap and hold the Open applications view, and select  on the application to close.

Open the status menu to access common settings

You don't have to navigate long paths to, for example, open, switch, or close an internet connection, or change your availability status. You can access these settings directly in the status menu, no matter what application or view you are in.



Tap the status area.

Close the status menu

Tap the status area.

Open the quick launch bar to access common applications

In all applications, and even on the lock screen, you can easily make a call, or access the camera, web, or messages.

When holding your phone upright, drag your finger from below the bottom of the screen onto the screen, and hold your finger in place, until the quick launch bar is displayed.

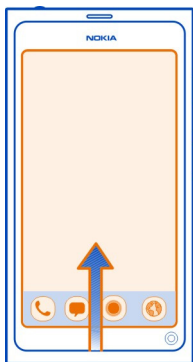

Close the quick launch bar

Tap outside the quick launch bar.

Reorganise the Applications view

Did you know that you can personalise the Applications view? Move your favourite applications to the top of the view, and hide the less used in folders.

Select and hold the application icon, and drag it to the new location.

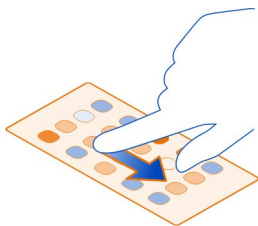

Create a folder

- 1 Tap and hold the Applications view.
- 2 From the toolbar, select **New folder**.
- 3 Open the new folder, select the folder name, and rename the folder.

Remove an application or folder

Select and hold the application or folder icon, and select .

You can only remove empty folders, and may not be able to remove some applications.

Status area indicators

Your phone's status area shows you what's going on in your phone. These are some of the icons that may be shown in the status area:

General indicators



An alarm is set.



The silent profile is activated.



Indicates the battery status. In power saving mode, the indicator is .

Notification indicators



You have missed a call.



You have a new mail message.



You have a new text message.



You have a new voicemail message.



An update is available for your phone software.

Call indicators



A call is active.



A call is active. Your microphone is muted.



Your calls are diverted to another number or your voice mailbox.

Availability indicators



Your availability status is online.



Your availability status is busy.

Network indicators





You have a GSM data connection (network service).  indicates that data is being transferred.



You have an EGPRS data connection (network service).  indicates that data is being transferred.











You have a 3G data connection (network service).  indicates that data is being transferred.

 You have an HSPA data connection (network service).  indicates that data is being transferred.

 Your phone is connected to a WLAN.

Connectivity indicators

-  Signal strength
-  The SIM card is not available.
-  Flight mode is activated.
-  Bluetooth is activated.  indicates that data is being transferred.
-  GPS is activated.
-  Your phone is transferring content.  indicates that a transfer is pending.  indicates that a transfer has failed.

Touch screen

About the touch screen

To control your phone, lightly touch the screen with your fingertips. The screen does not respond when you use your fingernails.

If your fingertips are cold, the screen may not respond to your touch.

 **Important:** Avoid scratching the touch screen. Never use an actual pen, pencil, or other sharp object on the touch screen.

Touch screen actions

To use your phone, tap or tap and hold the touch screen.

Open an app or select an item

Tap the app or item.

Go back to the home view

To leave an app and go back to the home view, swipe from the outside of the touch screen onto the screen. You can swipe from the left, right, or bottom of the screen. The app is left running in the background.

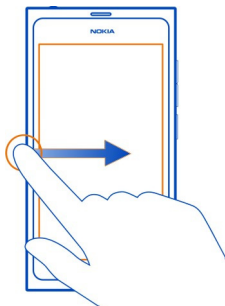

Tip: To close the current app fully, swipe from the top of the screen. Unsaved data in the app may be lost.

Flick

Place your finger on the screen, then slide it in the direction you want.



Example: To switch between home views, flick left or right. To scroll in a list or menu, slide your finger up or down.

Tap and hold to see more options

Place your finger on an item until the menu opens.

Example: To send a contact card or delete an alarm, tap and hold the contact or alarm, then select the option you want.

Drag an item

Tap and hold the item, and slide your finger across the screen. The item follows your finger.

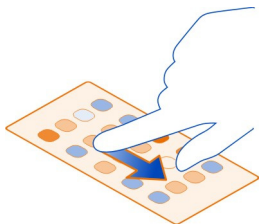

Example: To reorder your apps in the Applications view, tap and hold the desired app icon, and drag it to another place.

Zoom in or out

Place two fingers on an item, such as a photo or web page, and slide your fingers apart or together.



Open view-specific options

Tap  in the currently open app.

Switch a setting on or off

Tap the switch.

Set your phone to lock automatically

Want to protect your phone against unauthorised use? Define a security code, and set your phone to lock itself automatically when you're not using it.

- 1 Select  and Security > Device lock.

- 2 Select **Security code**, and enter a security code (at least 5 characters). You can use numbers, symbols, and upper and lower case letters.

Keep the security code secret and in a safe place separate from your phone. If you forget the security code, and cannot recover it, your personal data is deleted before you can use the phone again. If you've set the number of times you can enter the wrong security code, your phone deletes your data and resets itself back to original settings after the last try. If you haven't limited the number of times, your phone requires service before you can use it again.

- 3 Select **Autolock**, and define the length of time after which the phone is locked automatically.

Unlock your phone

- 1 Press the power key, and swipe from the outside of the screen onto the screen. You can swipe from any direction.
- 2 Enter the security code, and select **OK**.

Tip: You can also tap the screen twice, and swipe from the outside of the screen onto the screen.

Tip: When you update your phone software using the Nokia Software Updater PC app, the language of your on-screen keyboard is set back to the default language. If your security code includes characters that are not part of this on-screen keyboard, select , then swipe left or right across the keyboard to change the language of the on-screen keyboard to the one you used when creating the security code.

Tip: If you have defined a trusted person, if you ever forget your security code, you can send them the code in a text message. Select **Device lock** > **Trusted person** > **Select trusted person** and a contact from the list. If the trusted person's phone number changes in the contacts list, you need to change it manually

Phone lock settings

You can define a security code and set your phone to automatically lock itself when you're not using it.

Some services, such as Mail for Exchange, may require that you define a security code for your phone. Depending on administrator security requirements, also your phone lock settings may be changed, such as Autolock and Number of tries.

Select  and **Security** > **Device lock**, and from the following:

Autolock — Set the length of time before the phone locks automatically.

Security code — Change the security code. To use the phone lock, you need to define a security code.

Number of tries — Set a limit for incorrect security code attempts. After the limit is reached, the phone is reset to original settings and all user data is deleted.

Trusted person — Set one of your contacts as a trusted person. If you have defined a trusted person, if you ever forget your security code, you can send the code to the trusted person in a text message. After entering the incorrect security code, select **Recover**, and follow the displayed instructions.

Remote security features — Set up remote lock. If you lose your phone, you can remotely lock it or delete the data saved on it.

Write text

Write with the virtual keyboard

Select a text input field.

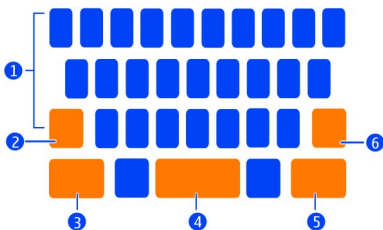

- 1 Character keys
- 2 Shift key
- 3 Symbol key
- 4 Space key
- 5 Enter key
- 6 Backspace key

Insert an upper case character when writing in lower case, or vice versa

Select the shift key before inserting the character. To activate caps lock mode, select the key twice. The shift key is highlighted. To return to normal mode, select the shift key again.

Enter a number or a special character

Select the symbol key. To view more symbols, select the **1/2** key.

Tip: To quickly add a number or a commonly used special character, select the symbol key, and slide your finger to the character without lifting. When you lift your finger, the character is inserted, and the keyboard returns to the normal text view.

Enter an accented character

Select and hold the character to which you want to add an accent, and slide your finger to the desired accented character without lifting.

Delete a character

Select the backspace key.

Change the font

In some applications, such as Mail and Notes, you can change the font. Select the text input field, and from the pop-up menu, select the desired option. To change the font of an individual word, drag to select the word, and select **T** and the desired option.

Copy and paste text

In a text input field, drag to select the text you want to copy, and from the pop-up menu, select **Copy**. To paste the text, select a text input field, then select the place where you want to paste the text, and from the pop-up menu, select **Paste**.

Use several writing languages

Select  and **Time and language > Text input > Installed input methods**, then select the writing languages.

If you have selected more than one writing language, you can switch between languages.

Change the writing language

Place a finger beyond the left or right edge of the touch screen, and drag your finger across over the virtual keyboard.

Close the virtual keyboard

Flick the virtual keyboard down, or tap outside the text input field.

Tip: To place the cursor precisely where you want to, select and hold the text, until a magnifier is displayed. Without lifting your finger, drag the cursor to the desired location.



Write text using error correction

Error correction is based on a built-in dictionary to which you can add new words.

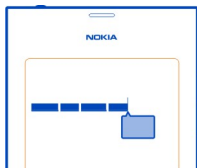

- 1 Start writing the word. The word suggestion changes after each key selection.
- 2 To accept a suggested word, select the suggested word.
- 3 To view more spelling suggestions, select and hold the suggested word.
- 4 To add a word to the dictionary, select and hold the suggested word, and select **Add to dictionary**.

Deactivate error correction for all editors in your phone

Select  and **Time and language** > **Text input**, and deactivate **Error correction**.

Tip: To use the space key to accept a suggested word, select  and **Time and language** > **Text input**, and activate **Insert with space key**. If you want to insert a space without accepting the suggested word, select the backspace key.

Write using Swype

Want to write faster? Use Swype to write text quickly and easily.

Activate Swype

- 1 Select  and **Time and language** > **Text input**, and activate **Swype**.
- 2 Select **Swype settings** and the language.

Write using Swype

To open the virtual keyboard, select a text input field. Slide your finger from letter to letter; you don't have to be so accurate. Swype usually knows if you want to write the same letter twice without you doing anything, but if you want to be sure, scribble on or make a loop on the letter. A space is automatically inserted when you lift your finger to write the next word.

Tip: To temporarily deactivate the auto space feature, slide your finger from the space key to the backspace key. To make this setting permanent, or to modify other settings, select and hold the Swype key on the bottom left of the keyboard.

Write and edit text using word suggestion

As you write, a list of possible words is displayed. To scroll through the list, drag your finger left or right on the list. If the desired word is displayed, select it. If the desired word is first in the list, start entering the next word, and the word is automatically inserted.

To see a list of alternatives for a word that you have already entered, select the word.

Add a word to the dictionary

Write the letters of the word one by one, then select the word from the word suggestion list. Confirm when asked.

Tip: To add several words, phone numbers, or words that contain numbers and symbols to the dictionary quickly, drag to highlight them, then select the Swype key.

Change the case of a word

Drag to highlight the word, then swipe from the Swype key to the shift key. Select the desired option from the list.

Tip: To capitalise the initial letter of a word, in one fluid motion, place your finger on the letter, slide your finger up above the keyboard, and slide back down to the next letter. Write the rest of the word as normal.

Insert an accented character, symbol, or number

To view a list of characters available on a particular key, select and hold the key. Select the character from the list.

Example: To insert the letter á, select and hold the **a** key, and from the displayed list, select **á**.

Tip: If you want to move the cursor within the text, or find other options for editing your text, swipe from the Swype key to the **+!=** key.

For more help, tips, and videos on using Swype, go to www.swype.com.

Control profiles, tones, and volume

Change the volume of a call, song, or video

Use the volume keys.

The built-in loudspeaker allows you to speak and listen from a short distance without having to hold the phone to your ear.

Activate or deactivate the loudspeaker during a call

Select .

Change your profile for meetings

Waiting for a call but can't let your phone ring? You can set your phone to discreetly beep once instead of ringing.

Open the status menu, and drag the profile slider to **Beep**.

Tip: You can also use the volume keys to change the current profile. Press the volume keys up or down until the desired profile is displayed.

This is possible in views where the key is not used for controlling volume or zoom level.

Tip: You can personalise the ringtones or sound volume, and select whether the phone vibrates when you receive a call. Select  and **Sounds and vibration**.

Tip: Download more ringtones from Nokia Store. Select  and **Sounds and vibration** > **Ringtone** > **Get more from Nokia Store**. To learn more about Nokia Store, go to www.nokia.com/support.

Use your phone offline

In places where you do not want to make or receive calls, you may still access your calendar, music, and offline games if you activate flight mode. Switch the phone off when mobile phone use is not allowed or when it may cause interference or danger.

Select  and activate **Flight mode**.

When flight mode is activated, you can still connect to a WLAN to, for example, read your mail or browse the internet. You can also activate Bluetooth and NFC.

Remember to comply with the instructions and safety requirements given by, for example, an airline, and any applicable laws and regulations.

Silence your phone

When the silent profile is activated, your phone tones are muted. Activate this profile when you are, for example, at the cinema or in a meeting.

Open the status menu, and drag the profile slider to **Silent**.

When the silent profile is activated, alarm tones still sound. You can also, for example, listen to music.

Search your phone

Explore your phone and the internet. As you enter your search word, search starts narrowing down the results for you, listing suggestions such as help topics, apps, music, videos and much more.

- 1 Select .
- 2 Start entering a search word, and select from the proposed matches.
- 3 To search on the internet, select the internet search link at the end of the search results.

Search from within an application

Select , start entering a search word, and select from the proposed matches. This is not available in all applications.

Explore Nokia services

Nokia services

With Nokia services, you can find new places and services, and stay in touch with your friends. You can do, for example, the following:

- Download games, applications, videos, and ringtones to your phone
- Find your way with free walk and drive navigation, plan trips, and view locations on a map
- Get music

Some items are free of charge, others you may need to pay for.

The available services may also vary by country or region, and not all languages are supported.

To use Nokia services, you need a Nokia account. When you access a service on your phone, you are prompted to create an account.

For more information, go to www.nokia.com/support.

Nokia account

When you switch your phone on for the first time, your phone guides you through creating a Nokia account.

With your Nokia account, you can, for example:

- Access all Nokia services with a single username and password, both on your phone and a compatible computer
- Download content from Nokia services
- Save details about your phone model and contact information. You can also add your payment card details.
- Save your favourite places to Nokia Maps

To learn more about the Nokia account and Nokia services, go to www.nokia.com/support.

To create a Nokia account later, use your phone to access a Nokia service, and you are prompted to create an account.

About the Nokia Maps web service

 With the Nokia Maps web service, you can view locations from all around the world.

You can do the following:

- Search for addresses, places of interest, and services
- Create routes, and get turn-by-turn directions
- Save your favourite places and routes to your Nokia account
- Synchronise your favourites with your compatible Nokia phone, and access them on the go.

To use the Nokia Maps web service, go to www.nokia.com/maps.

About Nokia Music

With Nokia Music, you can download songs to your phone and your compatible computer.

To start discovering music, go to www.nokia.com/music.

About Nokia Store

 You can download mobile games, apps, videos, pictures, and ringtones to your phone. Some items are free of charge; others you need to pay for with your credit card or in your phone bill.

The availability of payment methods depends on your country of residence and your network service provider.



Nokia Store offers content that is compatible with your phone and relevant to your tastes and location.

Select . To learn more about Nokia Store, go to www.nokia.com/support.

Personalisation

Change the wallpaper

Want to see your favourite landscape or pictures of your family in the background of the lock screen? You can change the wallpaper to personalise the lock screen to your liking.

- 1 Select  and the desired picture.
- 2 Tap the screen to display the toolbar, and select  > **Set as wallpaper**.
- 3 Move the cropping area, to get the best possible fit.
- 4 Select **Done**.

Tip: You can also use preinstalled pictures, or download more wallpapers from Nokia Store. Select  and **Wallpaper**. To learn more about Nokia Store, go to www.nokia.com/support.

View notifications and feeds

Read recent posts from your social networking contacts and favourite web feeds, all in the same view with your received notifications.

The Events view contains the following:

- Notifications about, for example, your missed calls, unread messages, and software updates
- Feeds from different applications and services, such as social networking applications and web feeds

The Events view items are interactive. Select, for example, the feed you want to view in more detail.

Example: To check and install suggested software updates, select the notification indicated with .

When you set up your social networking accounts, your friends' status updates are automatically displayed in the Events view. Similarly, if you activate **Show feed on home screen** when you subscribe to web feeds, your feeds are automatically displayed.

Tip: You can refresh feeds manually. In the Events view, select **Refresh**.

Remove a current feed from a certain application or service

Select and hold the feed, and select **Clear**.

This does not deactivate the feed.

Using services or downloading content may cause transfer of large amounts of data, which may result in data traffic costs.

Connectivity

Internet connections

Define how your phone connects to the internet

Does your network service provider charge you a fixed fee for data transfer, or on a pay as you use basis? To use the optimal connection method, modify the WLAN and mobile data settings.

Select  and **Internet connection > Connect to internet**.

If your network service provider charges you a fixed fee, the easiest method is to set your phone to connect to WLAN and mobile data connections automatically, to keep your phone constantly online.

Connect to an available WLAN

Select and hold the WLAN connection, and select **Use automatically**.

Use a mobile data connection

Select and hold the mobile data connection, and select **Use automatically**.

Stop using the connection automatically

Select and hold the connection, and select **Use manually**.

If your network service provider costs depend on the amount of data you use, you may want to select the network manually. If there are no automatically used networks available and you do something that requires an internet connection, you are asked to select a connection.

Request confirmation before using a mobile data connection when outside your home network

Select  and **Mobile network > Data roaming > Always ask**.

To set the phone to connect automatically, select **Always allow**. Connecting when abroad can raise data transfer costs substantially.

When you connect to a network for the first time, all your credentials and settings for that network are saved, so that you don't have to enter the data every time you connect.

To view a list of your automatically and manually used networks, select  and **Internet connection > Edit networks**.

Keep track of your data traffic

To avoid surprises with mobile data costs, you can set your phone to notify you when you have transferred a certain amount of data using your mobile data connection.

Select  and **Mobile network > Counters**.

View the amount of data sent and received

Go to **In home network** or **When roaming**.

Get a notification every time you reach a limit

Go to **In home network** or **When roaming**. Activate **Data limit warning**, and enter the limit in the field.

The limit is active by default when outside the home network.

The limit is phone specific. If you use your SIM card in another phone, you need to set the limits in that phone.

Close data connections when not in use

To help save data costs, you can set your phone to close the mobile data connection when you don't need it.

Select  and **Mobile network** or **Internet connection**.

If you deactivate background connections, the internet connection is active only when you, for example, select a web link. Your phone does not activate the connection automatically, for example, to check for new mail. When outside the home network, background mobile data connections are deactivated by default.

Close background connections

Deactivate **Allow background connections**.

Close a network connection

If an application in the background is using an internet connection, you can close the connection without closing the application.

- 1 Open the status menu. Your current network connections are displayed.

- 2 Select the connection to close and **Disconnect**.

Close all network connections

Select  and activate **Flight mode**.

WLAN

About WLAN connections

You can connect to a wireless local area network (WLAN) in the status menu. Tap the status area.

 **Important:** Use encryption to increase the security of your WLAN connection. Using encryption reduces the risk of others accessing your data.



 **Note:** Using WLAN may be restricted in some countries, for example, in France and Ireland. For more information, contact your local authorities.

This phone supports the 802.11a, 802.11b, 802.11g, and 802.11n WLAN protocols. You can create an 802.11n connection using either the 2.4 or 5 GHz frequency band.

Connect to a WLAN at home

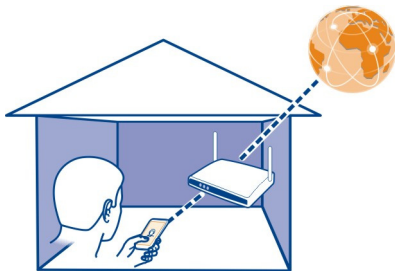
To help save data costs, connect to your home WLAN when you are at home and want to browse the web on your phone.





- 1 Open the status menu, and select **No internet connection**.
You can see the available network connections.  indicates a WLAN connection, and  indicates a mobile data connection.
- 2 Select your home WLAN and **Connect**.
If your home WLAN is secured, enter the passcode.
If your home WLAN is hidden, select **Hidden WLAN** > **Connect**, and enter the network name (service set identifier, SSID).

Connect to a WLAN on the move

Connecting to a WLAN is a handy way of accessing the internet when not at home. Connect to public WLANs in public places, such as a library or internet café.

- 1 Open the status menu, and select **No internet connection**.

You can see the available network connections.  indicates a WLAN connection, and  indicates a mobile data connection.

- 2 Select the desired WLAN connection and **Connect**.

Close the WLAN connection

- 1 Open the status menu.
- 2 Select the connection and **Disconnect**.

About streaming your media files

Are there some photos or videos stored on your phone that you would like to see on another device, such as a TV? Or some music that you would like to listen to through your home stereo? Use your phone to stream media files to your DLNA devices wirelessly.

To do this, you need a WLAN, and your phone and the DLNA device need to be connected to the WLAN. For best results, your wireless router should be connected to your DLNA device over a cable connection.

For more info on how to set up the WLAN connection, go to www.nokia.com/support.

Stream photos or videos

[See "View your photos and videos wirelessly on your home entertainment system", p. 75.](#)

Stream music

[See "Stream your music wirelessly on your home entertainment system", p. 63.](#)

NFC

About NFC

Near Field Communication (NFC) makes connecting and sharing easy and fun. Nokia phones and accessories that support NFC are connected wirelessly when you touch them together.

With NFC, you can:

- Share your own content between two compatible phones that support NFC.

- Connect to compatible Bluetooth accessories that support NFC, such as a headset or a wireless loudspeaker.
- Touch tags to get more content for your phone or to access online services.

The NFC area is on the back of your phone, above the camera. Touch other phones or accessories with the NFC area.

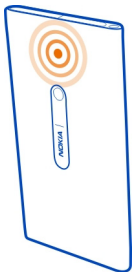

You can use NFC when the phone screen is on.

For more info, watch the NFC tutorial videos on your phone.

Activate NFC

Select  and **Device** > **NFC**, and activate **NFC**.

Connect to a Bluetooth accessory using NFC

Touch the NFC area of the accessory with the NFC area of your phone.



Disconnect the accessory

Touch the NFC area of the accessory again.

For more information, see the user guide of the accessory.

Send a picture, video, or contact to another phone that supports NFC

You can share your own pictures, videos, and contacts when you touch another phone that supports NFC.

Share a picture

- 1 Select a picture in Gallery.
- 2 Touch the NFC area of the other phone with the NFC area of your phone. The picture is sent using Bluetooth.

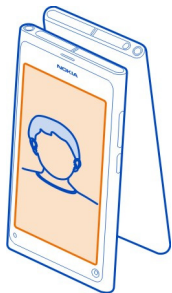

Access an online service using NFC

When you touch an NFC tag that contains a web address with the NFC area of your phone, the website opens in your phone web browser.



Tip: NFC tags can also contain information such as a phone number or business card. When you see a phone number in an advertisement that supports NFC, to call the number, touch the tag.

Bluetooth

About Bluetooth connectivity

Select  and **Bluetooth**.

You can connect wirelessly to other compatible devices, such as phones, computers, headsets, and car kits.

You can use the connection to send items from your phone, and print files with a compatible printer.

Since devices with Bluetooth wireless technology communicate using radio waves, they do not need to be in direct line-of-sight. However, they must be within 10 metres (33 feet) of each other, although the connection may be subject to interference from obstructions such as walls or from other electronic devices.

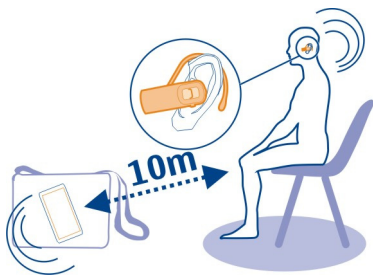

When your phone is locked, only connections to authorised devices are possible.

! **Note:** There may be restrictions on the use of Bluetooth technology in some countries. For example, in France, you are only allowed to use Bluetooth technology indoors. For more information, contact your local authorities.

Connect to a wireless headset

With a wireless headset, you can answer a call even if your phone is not directly at hand, and you can have your hands free, for example, to continue working at your computer during a call. Wireless headsets are available separately.

Select  and **Bluetooth**.

- 1 Activate **Bluetooth**.
- 2 Switch the headset on.
- 3 Select **Bluetooth devices**.
- 4 To pair your phone and the headset, select the headset from the list.

5 You may need to enter a passcode. For details, see the user guide of the headset.

Send a picture or other content to another phone or device

You can use Bluetooth to send pictures, videos, and other content created by you to your friend's compatible phones and devices and to your computer.

You can have several Bluetooth connections active at a time. For example, if you are connected to a compatible headset, you can also send files to another compatible device at the same time.

- 1 Select and hold the item, for example, a picture, and select **Share > Bluetooth**.
- 2 Select the device to connect to. Bluetooth devices within range are displayed.
- 3 If the other device requires a passcode, enter the passcode. The passcode, which you can define yourself, must be entered in both devices. The passcode in some devices is fixed. For details, see the user guide of the device.

The passcode is valid only for the current connection.

Tip: If you connect to a device frequently, to set it as authorised, select  and **Bluetooth**. Make sure Bluetooth is activated. Select **Bluetooth devices** and the device, and activate **Connect automatically**. When a device is authorised, you do not have to enter the passcode every time.

Protect your phone

When Bluetooth is activated in your phone, you can control who can find and connect to your phone.

Select  and **Bluetooth**.

Prevent others from detecting your phone

Deactivate **Visibility**.

When your phone is hidden, others cannot detect it. However, paired devices can still connect to your phone.

Operating the device in hidden mode is a safer way to avoid malicious software. Do not accept Bluetooth connection requests from sources you do not trust. You can also deactivate Bluetooth function when you are not using it.

Do not pair with or accept connection requests from an unknown device. This helps to protect your phone from harmful content.

USB data cable

Sync photos or other content between your phone and a computer

You can use a USB cable to sync photos, videos, music, and other content created by you between your phone and a computer.

- 1 Use a compatible USB cable to connect your phone to a compatible computer. The phone is displayed as a portable device on your computer.
- 2 Use the file manager of the computer to sync the content.

Select the USB mode

For best results when using a USB cable to get content from or when synchronising with your computer, use the appropriate USB mode.

- 1 Use a compatible USB cable to connect your phone to your compatible computer or other device.
- 2 When prompted, select from the following:

Use as mass storage — Your phone is recognised as a USB flash memory. You can also connect your phone to other devices, such as a home or car stereo.

While connected to a computer in this mode, you may not be able to use some of the phone applications. It is possible to use your computer to view, sync, move, or delete the photos, music, and other content stored on your phone.

Sync and connect — You have connected to a computer that has Nokia Link installed. In this mode, you can synchronise your phone with Nokia Link and use other Nokia Link features.

This mode is activated automatically when you open the Nokia Link application.

Tip: To set the default USB mode, used every time you connect your phone, select  and **Accessories > USB**.

Web and RSS feeds

Web browser

About the web browser

Select .

Catch up on the news, and visit your favourite websites. You can use your phone web browser to view web pages on the internet.

To browse the web, you must be connected to the internet.

Tip: In all apps, and even on the lock screen, you can easily access the web. Hold your phone upright, and drag your finger from below the bottom of the screen onto the screen. Hold your finger in place, until the quick launch bar is displayed.

Websites may ask to access your current location info to, for example, personalise the info they show you. If you allow a website to use your location info, your location may be visible to others, depending on the website. Read the privacy policy of the website.

Browse the web

Select .

Tip: If your service provider does not charge you a fixed fee for data transfer, to save data costs in your phone bill, you can use a WLAN to connect to the internet.

Go to a website

Select from your most visited websites, or select the web address bar, and write a web address.

Search the internet

Select the web address bar, write a search word, and select the search word below the web address bar.

Open a new browser window

Select  > Open new window.

Zoom in or out

Place two fingers on the screen, and slide your fingers apart or together.

Tip: To quickly fit a section of a web page to your phone screen, double-tap the screen.

Copy text

- 1 Select and hold a word.
- 2 Drag to select the text you want to copy, and select **Copy**.

Send a web link

Select  > Share this page and the sharing method.

Let the browser remember your passwords

Select  and Applications > Web, and activate Remember passwords.

Clear private data

Select  and **Applications > Web > Clear private data** and what you want to clear.

Add a bookmark

If you visit the same websites all the time, add them to your Applications view, so you can easily access them.

Select .

While browsing, select  > **Add to home screen**.

Tip: To find your bookmarks more easily, create a folder for them in the Applications view.

Tip: While browsing, to quickly go to a website you visit often, select the web address bar and a website from your most visited websites.



RSS feeds

Subscribe to a web feed

You don't have to visit your favourite websites regularly to keep up with what's new on them. You can subscribe to web feeds and get links to latest content automatically. You can read your feeds in Feeds or in the Events view.

Select .

Web feeds on web pages are usually indicated with . They are used to share, for example, the latest news headlines or blog entries.

- 1 Select , and go to a blog or web page that contains a web feed.
- 2 Select  > **Subscribe to feed**.
- 3 To show the feed in the Events view, activate **Show feed on home screen**.

Tip: If you know the address of the feed, you can add the feed in Feeds. Select , and enter the address.

Update a feed

Select and hold the feed, and select **Update**.

Update all feeds

Select .

Set feeds to automatically update

Select  and **Applications > Feeds > Update feeds > Always automatically**.

Define how often feeds are updated

Select  and Applications > Feeds > Auto-update interval.

Contacts and social networking friends**Contacts****About Contacts**

Select .

You can save and organise your friends' phone numbers, addresses, and other contact information.

Save phone numbers and mail addresses

You can save your friends' phone numbers, mail addresses, and other information to your contacts list.



Select .

Add a contact to the contacts list

- 1 Select .
- 2 Select a field, and fill in the details.

Tip: Create a contact card for yourself, so you can easily send your contact information to others.

Edit contact information

- 1 Select a contact.
- 2 Select  > Edit.
- 3 Select a field, and edit the details.
- 4 To view more fields, select .

Save a number from a received call or message

Have you received a call or a message from a person whose phone number is not yet saved in the contacts list? You can easily save the number in a contact list entry.

Save a number from a received call

- 1 Select .
- 2 Select a phone number and .
- 3 To create a new contacts list entry, select Add new. To add the number to an existing entry, select Merge.

Save a number from a received message

- 1 Select .
- 2 Select and hold a conversation, and select **Open contact card**.
- 3 Select **Save**.
- 4 Select **Edit**, and fill in the contact details. To add the number to an existing entry, select **Merge**.

Find contacts quickly

Want to find someone's contact info quickly without too much scrolling? Set your most important contacts as favourites. That way they're shown at the top of the contacts list. You can also fast scroll or search to browse your contacts list.

Select .

Set a contact as a favourite

Select the contact and . The contact is moved to the top of your contacts list.

Remove a contact from favourites

Select the contact and . The contact remains in your standard contacts list.

Fast scroll to a contact

Slide your finger up and down on the right side of the contacts list to jump to a letter of the alphabet.

Search for a contact

Start writing in the **Search** field. Matching contacts are shown.

Tip: If you are signed in to Mail for Exchange or Skype, you can also search the contacts stored on those services.

Add a photo for a contact

Want to see quickly who is calling you? Add a photo from Gallery, or take a new photo.

Select .

- 1 Select and hold the contact, and from the pop-up menu, select **Edit**.
- 2 Select **Add image**.
- 3 To use an existing photo, select **Select from Gallery** and a photo.
- 4 To take a new photo, select **Capture new image**.

- 5 To crop the photo, drag the slider at the bottom right corner of the frame. Drag the frame to reposition.
- 6 Select **Done**.

If you have linked contacts from social networking services to your contacts list, the photo used in the service is used automatically.



Change the photo for a contact

- 1 Select the contact and the current photo.
- 2 Select a new photo from Gallery, or take a new photo.

Set a ringtone for a contact

Want to be able to hear that a particular person is calling you? You can set a ringtone specifically for that person.

Select .

- 1 Select a contact.
- 2 Select  > **Edit** >  > **Ringtone:**, and the ringtone to use for the contact.

Copy contacts from the SIM card to your phone

If you have contacts stored on your SIM card, you can copy them to your phone. You can add more details to contacts that are stored on your phone, such as alternative phone numbers, addresses, or a picture.

Select .



- 1 Select  > **Import contacts** > **SIM card**.
- 2 Select the contacts you want to copy, or select **Mark all** to copy all the contacts.
- 3 Select **Import**.

Tip: After copying your SIM contacts to your phone, or after importing contacts, any duplicate contacts are automatically merged into one.

Create a contact group

When you have created contact groups, you can send a message to several people at the same time. For example, you can assign the members of your family to one group.

Select .

- 1 Select  > **Add group**.
- 2 Enter a name for the group.
- 3 Select .

- 4 Select the contacts you want to add to the group, and select **Done**.
- 5 Select **Save**.

Send a message to a group of people

Would you like to send a message to all your family members quickly? If you have assigned them to a group, you can send a message to all of them at the same time.

Select .

- 1 Select the group.
- 2 Select **Message** or **Mail**.

Social networking friends

About online friends

You can bring all the status updates posted by your friends to your social networking services to a single view. Feeds from your social networking applications are shown in the Events view. You can also comment on your friends' status updates. If you link your online friends' profiles to their entries in your contacts list, their status updates are displayed on their contact cards in your contacts list.

Using social networking services requires network support.

For information about data transmission charges, contact your service provider.

The social networking services are third-party services and not provided by Nokia. Check the privacy settings of the social networking service you are using as you may share information with a large group of people. The terms of use of the social networking service apply to sharing information on that service. Familiarise yourself with the terms of use and the privacy practices of that service.

Bring your online friends status updates to one view

Sign in to social networking services, so you can see your online friends' status updates in the Events view.

Select .

- 1 Select **Add account** and a service.
- 2 Sign into the social networking service that you use.

Show your online friends' status updates in the contact cards

When you add an account for a social networking service, you can allow the automatic linking of your online friends' profiles from the services to the friends' entries in your contacts list. After linking, you can set your most important contacts as favourites,

and you'll see their latest status update in Contacts. You can also see the contact details and latest status updates in the individual contact cards.

Select .

Import your friends' profiles

- 1 Select  > **Import contacts** > **Online service**.
- 2 Select a service, and create an account, if necessary. Your friends' profiles are linked automatically to their entries in your contacts list.

Contact details are copied to the respective entries in your contact list when possible. Existing details are not deleted. Any duplicate contacts are automatically merged into one.

Tip: Some services do not automatically merge imported contacts. To merge imported contacts manually, select  > **Merge contacts** > **Refresh**.

Merge your friends' profiles

- 1 Select the contact and  > **Merge**.
- 2 Select one or more other profiles to link to the contact.

Tip: If you set your most important contacts as favourites, you can see their latest status update in Contacts.

View others' availability information

With availability indicators, you can see when your friends are online. You can see their location and if they are available to chat or answer an internet call, and they can see your availability information.

Sign in to the instant messaging or internet call services that you use, and select .

Availability information is displayed on the contact picture if supported by the online service.

Calls





Ways to make calls

To make a call, you can:

- Enter a phone number
- Search your contacts list
- Select from your last dialled numbers

Call a phone number

Select .

- 1 Select .
- 2 Enter the phone number.
To delete a number, select 
To enter the + character, used for international calls, select * twice.
- 3 To make the call, select .
- 4 To end the call, select .

Tip: In all apps, and even on the lock screen, you can easily make a call. Hold your phone upright, and drag your finger from below the bottom of the screen onto the screen. Hold your finger in place, until the quick launch bar is displayed.

Call a contact

Select .

- 1 To search for a contact, enter the first letters or characters of the contact's first or second name in the search field.
- 2 Select the contact and the number.

Send a message to the contact



Select the contact and  next to the phone number.

Make a conference call

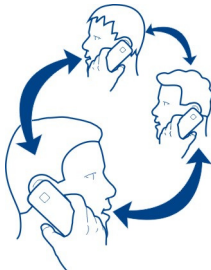
Your phone supports conference calls between a maximum of six participants, including yourself. Conference call is a network service.



- 1 Make a call to the first participant.

- 2 To make a call to another participant, select  > **New call to contact** or **Open Phone**. The first call is put on hold.
- 3 When the new call is answered, to start the conference call, select  **Conference call**.

Add a new participant to a conference call

Make a call to another participant, and to add the new call to the conference call, select  **Conference call**.

Have a private conversation with a conference call participant

Select .

Next to the participant name or number, select . The conference call is put on hold on your phone. The other participants continue the conference call.

To return to the conference call, select .

Drop a participant from a conference call

Select , and next to the participant name or number, select .

End an active conference call

Select .

Answer or decline calls

When someone is calling, you can:

- Answer the call
- Decline the call
- Decline the call with a text message
- Silence the call

You can set your phone to divert all calls to your voice mailbox or to another phone number.

Answer a call



When a call arrives, select .

When someone is calling you while your phone is locked, to access the incoming call view, swipe from the outside of the screen onto the screen. You can then answer the call.

Reject a call

When a call arrives, select .

Reply to a call with a text message

- 1 When a call arrives, select  > , and edit the message, informing that you cannot answer the call.
- 2 To send the message, select **Send**.

Tip: You can automatically divert rejected calls to your voice mailbox or another phone number (network service). Select  and **Device > Call > Call divert**.

Turn to silence

If your phone rings in a situation where you do not want to be disturbed, you can silence the ringing tone.

When your phone rings, turn your phone face down.

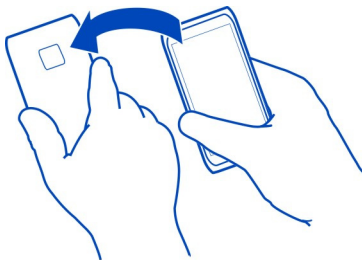
**Divert calls to your voice mailbox or another phone number**

If you cannot answer your calls, you can divert incoming calls to your voice mailbox or another phone number. Remember to set up your voice mailbox before diverting your calls there.

Select  and **Device > Call > Call divert**.

Call divert is a network service. For details, contact your service provider.

Divert all voice calls to your voice mailbox

- 1 Activate **All voice calls**.
- 2 Select  > **Voicemail**.

Divert all voice calls to another phone number

- 1 Activate **All voice calls**.
- 2 Type in the number, or select  to use a number saved in your contacts list.

Several diverting options, such as **If busy** and **If not answered** can be active at the same time.

Call your voice mailbox



You can divert your incoming calls to your voice mailbox. Callers can also leave you a message if you do not answer. Voice mailbox is a network service.

Select .



Select , and select and hold **1**.

If the voice mailbox number is not saved, your phone asks for it. Type in the number received from your network service provider, and select **Save**.

Change the phone number of your voice mailbox

- 1 Select  and  >  > **Edit voicemail number**.
- 2 Type in the number, and select **Save**.

Add another voice mailbox

- 1 Select  and  >  > **Edit voicemail number** > **Add number**.
- 2 Type in the number, and select **Save**.

During a call

During a call, you can:

- Activate the loudspeaker
- Add callers, to make a conference call
- Answer a waiting call

Activate the loudspeaker during a call

To allow others in the room to join in with a call, activate the built-in loudspeaker.

Select  **Loudspeaker**.

Deactivate the loudspeaker

Select  **Loudspeaker**.

Noise cancellation

If you are calling from a noisy environment, your phone filters out background noise, to make your voice sound clearer to the person at the other end of the line.

Noise cancellation is not available when using the loudspeaker or a headset.

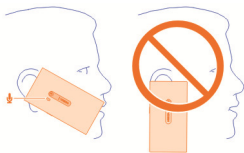

For the best noise cancellation, hold the phone with the earpiece to your ear and the main microphone towards your mouth. Do not cover the secondary microphone next to the camera flash.

If you want to let the person at the other end of the line also hear the background noise, for example, the music when you're at a concert, you can temporarily deactivate noise cancellation.

Activate or deactivate noise cancellation

Select  and **Device** > **Call**, and activate or deactivate **Noise cancellation**.

Answer a waiting call

You can answer a call when you have another call in progress. Call waiting is a network service.

Select the waiting call and . The first call is put on hold.

Activate, deactivate, or check the status of the service

Select  and **Device** > **Call**, and activate or deactivate **Call waiting**.

Swap between an active call and a call on hold

Select the call.

Connect the call on hold to the active call to start a conference call

Select  **Conference call**.

End an active call

Select .

End both calls

Select  > **End all calls**.

Recent calls

Your call history is stored on your phone.

Missed and received calls are logged only if supported by the network, and the phone is switched on and within the network service area.

View your missed calls



In the Events view, you can see when you have missed calls. To view the phone numbers or contacts, select the displayed notification. The caller's name is displayed if stored in the contacts list.

Missed and received calls are logged only if supported by the network, and the phone is switched on and within the network service area.

Call back a contact or number

Select the contact or number and .

View the missed calls list later

Select  and  >  > Missed calls.

View your received calls

Select .

Received calls are logged only if supported by the network, and the phone is switched on and within the network service area.

Select  >  > Received calls.

Call back the contact or number

Select the contact or number and .

Call the last dialled number

Trying to call someone, but they are not answering? It is easy to call them again. In the call history view, you can see information about the calls you have made and received.

Select .

Select  > , and from the pop-up menu, select **Dialled calls**.

To call the last dialled number, select the contact or number from the list and .

About internet calls

You can make and receive calls over the internet. Internet call services may support calls between computers, between mobile phones, and between a VoIP device and a traditional telephone. The internet call service is a network service.

Some internet call service providers allow free internet calls. For availability and connectivity costs, contact your internet call service provider.

To make or receive an internet call, you must be in the service area of a WLAN or have a packet data (GPRS) connection in a 3G network, and be signed in to an internet call service.

Install an internet call service

Select .

- 1 Select **Add account** and an internet call service provider.
- 2 Enter required details, such as your username and password.
- 3 To sign in to the service, select **Sign in**.

When an internet call service has been installed, the service is displayed in the contacts list and the Accounts application.

Tip: You can search for internet call services from Nokia Store. To learn more about Nokia Store, go to www.nokia.com/support.

Sign in to an internet call service

Select .

Select the internet call service, and activate the account.

Deactivate a service

Select the account, and deactivate it. When you deactivate an account, all content related to the account is hidden.



Set all services to offline

Set your availability status to **All offline**.

Make an internet call



When you are signed into an internet call service, you can make an internet call from the contacts list or enter a phone number manually.

Call a contact in the contacts list

- 1 Select  and .
- 2 Select a contact and an internet call service.

Make an internet call to a phone number

- 1 Select  and .

- 2 Enter the phone number.
- 3 Select , an internet call service, and .

Set your availability status

Want to receive instant messages or internet calls from your friends? Set your availability status to .

Open the status menu, and select **Availability**.

Set your availability status for all your accounts

Select **All online** or **All offline**.

Set your availability for an individual account

Select the account and the desired availability status.

When you're signed in to several instant messaging or internet call services at the same time, you can post a single status message to all the services.

Post a status message

- 1 Open the status menu, and select **Availability** > **Update status message**.
- 2 Select the text input field, and write your status message.
- 3 Select **Update**.

Share your location in your status message

- 1 Open the status menu, and select **Availability** > **Update status message** > **Add location**.
- 2 Select **Street**, **District**, or **City**.
- 3 Select the **Add location** check box.

Location sharing is available only if it is supported by the service.

 **Important:** Before sharing your location, always consider carefully with whom you are sharing. Check the privacy settings of the social networking service you are using, as you might share your location with a large group of people.

Messaging and social networks

Set up all your accounts in one go

Set up and manage your accounts for instant messaging (IM), mail, and various other services, all in one view.

Select .

- 1 Select **Add account**.
- 2 Select an account, and follow the displayed instructions.
- 3 After setting up the account, to add another account, select **Add more accounts**.

When you set up an account, you need to sign in with your credentials. Your phone remembers your credentials in future.

Tip: To protect your accounts against unauthorised use, lock your phone when not in use.

Deactivate a service

Select the account, and deactivate it. When you deactivate an account, all content related to the account is hidden.

Remove a service

Select the account and  > **Delete**.

Messages

About Messages

Select .

You can send and receive different kinds of messages:

- Text messages
- Multimedia messages that contain your pictures or videos
- Instant messages (network service)

Messages requires network support.

Tip: To access messages quickly, hold your phone upright, and drag your finger from below the bottom of the screen onto the screen. Hold your finger in place, until the quick launch bar is displayed.

You can send text messages that are longer than the character limit for a single message. Longer messages are sent as two or more messages. Your service provider may charge accordingly.



Characters with accents, other marks, or some language options, take more space, limiting the number of characters that can be sent in a single message.

Using services or downloading content may cause transfer of large amounts of data, which may result in data traffic costs.

Send a message

With text and multimedia messages, you can quickly contact your friends and family. In a multimedia message, you can attach your videos, photos, and sound clips that you want to share.

Select .

- 1 Select .
- 2 To select recipients from the contacts list, select the To field and . To type in the recipient's name or phone number, select the To field.
- 3 Write your message.
- 4 To add an attachment, select .

Tip: If you want to add a new photo to your message, select  > Camera. Take the photo, and it is added to your message.

- 5 Select **Send**.

Sending a message with an attachment may be more expensive than sending a normal text message. For more information, contact your service provider.

If the item you insert in a multimedia message is too large for the network, the device may automatically reduce the size.

Only compatible devices can receive and display multimedia messages. Messages may look different in different devices.

Read a received message

When you receive a new message, a notification is shown in the Events view. Select the notification to open the message.

To view your messages later, select .

Reply to the received message

- 1 Select a conversation in the Messages view.
- 2 Select the text input field at the bottom of the display.
- 3 Write your message.
- 4 Select **Send**.

Forward the message

- 1 Select a conversation in the Messages view.
- 2 Select and hold the message, and select **Forward**.

Forward a multimedia message

- 1 Select a conversation in the **Messages** view.
- 2 Select the multimedia message.
- 3 Select  > **Forward**.

Save a picture or other multimedia item

With the message open, select and hold the item, and select **Save as**. You can view the item in the corresponding application. For example, to view saved photos, open Gallery.

Tip: To view text messages and instant messages separately, select .

Change the phone language

Select  and **Time and language** > **Language**.

Instant messaging

Create an instant messaging account

To chat with your contacts, you need an instant messaging account in your phone.

Select  and **Add account**, and follow the displayed instructions.

Send an instant message

Select .

- 1 Select  and a contact.
- 2 Write your message, and select **Send**.

Tip: You can sign in to and chat in several services at the same time. Switch between different chat services in the **Open applications** view.

Mail

About Mail

Select .

You can start using your existing mail address with your phone, and read, respond to, and organise your mail on the go.

Sending or receiving mail on your phone may be chargeable. For information on possible costs, contact your service provider.

Mail is a network service, and may not be available in all regions.

Add a mailbox

You can add several mailboxes to your phone.

Select .

Select an account, and follow the displayed instructions.

Add a mailbox later

Select , and follow the displayed instructions.

Delete a mailbox

- 1 Select .
- 2 Select the mailbox and  > Delete.

Read a received mail

When you receive new mail, a notification is shown in the Events view. Select the notification to open the mail.

To read your mail later, select .

Tip: To zoom in or out, place two fingers on the screen, and slide them together or apart.

Reply to the mail

With the mail open, select  > **To sender**, or if there is more than one recipient, select **To all**.

Forward the mail

With the mail open, select .



Delete the mail

With the mail open, select .

Send a mail

You can use your phone to write and send mail, and attach files to your mail.

Select . If you have more than one mail account, select an account.

- 1 Select .
- 2 Type in the mail address. To add a recipient from your contacts list, select .



Tip: When using your Mail for Exchange account, your phone can also search recipients from your global address list. Just type in part of the recipient's name, select the number next to the suggested recipient, then select the recipient.

- 3 To add an attachment, select  > **Attachments:**.

4 Select Send.

View mail threads



You can view your mails as threads. With threads, it is easy to keep up with what has been said as you can see all mails you have sent or received under a subject in a single view.

Select  and a mailbox. If threads are not showing, select  and **Applications > Mail** to switch them on.

Select a thread to open it. Use the arrow buttons to browse through the thread. If you want to quickly search for a particular mail, select **Threads** and a mail.

You can have both mail threads and single mails in your inbox. Each thread has a number on the right that indicates how many mails there are in the thread.



Reply to a mail in a thread

With the thread open, select . You are replying to the latest mail in the thread. If you want to reply to a mail in the middle of the thread, browse to the mail, then select .

Forward a thread

With the thread open, select . The forwarded thread is added as an attachment.

Delete a mail

With the thread open, select . The latest mail in the thread is deleted. To delete the whole thread, select **Thread >  > Delete thread**.

Mail for Exchange

About Mail for Exchange

Would you like to have your work mail, contacts, and calendar at hand, whether you are sitting by your computer or on the go with your phone? You can synchronise the important content between your phone and a Microsoft Exchange server.

Select  and **Add account > Mail for Exchange**.

Mail for Exchange can be set up only if your company has a Microsoft Exchange server. In addition, your company IT administrator must have activated Microsoft Exchange ActiveSync for your account.

Use of the Mail for Exchange is limited to over-the-air synchronisation of PIM information between the Nokia device and the authorised Microsoft Exchange server.

Before starting to set up Mail for Exchange, make sure you have the following:

- A corporate mail address
- Your Exchange server name (contact your company IT department)
- Your network domain name (contact your company IT department)
- Your office network password



Depending on the Exchange server configuration, you may need to enter additional information. If you do not know the correct information, contact your company IT department.

When you set up your Mail for Exchange account, your phone may ask you to define a security code. Depending on your Mail for Exchange administrator's security requirements, also your phone lock settings may be changed, such as Autolock and Number of tries. When you have defined a security code, if you don't use your phone for a while, it locks itself. To use your phone again, you need to enter the code.

Synchronisation takes place automatically in intervals defined when setting up the Mail for Exchange account. Only content defined when setting up the account is synchronised. To synchronise additional content, modify the Mail for Exchange settings.

Respond to a meeting request

You can respond to meeting requests using Mail for Exchange. When you accept a meeting request, it appears in your calendar.

- 1 In the Events view, select the mail notification, or select  and the mail. If you have more than one mail account, select an account.
- 2 Select  > Accept, Tentative, or Decline.

Music and videos

Music player

About the music player

Select .

You can use your phone's music player to listen to music and podcasts while on the move.

Play music

Select .



Select a song or album. You can also select a podcast.

Tip: To listen to songs in a random order, select .

Pause or resume playback

To pause playback, select ; to resume, select .

Play the next or previous song

Select  or , or flick the album art left or right.

Browse music in Nokia Music

Select **Music Store**.

Delete music from your collection

Select and hold a song or album, and select **Delete**.

Tip: When listening to music, you can return to the home screen, leaving the music playing in the background.

Create a playlist

Want to listen to different music for different moods? With playlists, you can create selections of songs to play in a specific order.

Select .

- 1 Select and hold a song or album, and from the pop-up menu, select **Add to playlist**.
- 2 Enter a name for the playlist.

Play a playlist

Select **Playlists** and the desired playlist.

Remove a song from a playlist

In the playlist view, select  > **Remove songs** > **Remove**.

This does not delete the song from the phone; it only removes it from the playlist.

Tip: To quickly add the song you're listening to the Favourites playlist, select .

Explore recommendations from Nokia Music

Want to explore new music but don't know where to start? Let your phone suggest albums matching your taste, and get inspired.

Select .

When browsing artists, albums, or songs, select an album suggested under **You might also like**.

Deactivate Nokia Music recommendations

Select  and Applications > Music, and deactivate Show recommendations.

Stream your music wirelessly on your home entertainment system

You can stream music on your phone to another device that supports DLNA, such as a TV.

Before starting, make sure your network setup is correct. [See "About streaming your media files", p. 35.](#)

- 1 If needed, switch the media sharing server on. Select  and Device > Media sharing settings > Media sharing > On.

To later access the media sharing server from the status menu, switch Always show Media sharing in status menu to On.

- 2 If asked, type in the WLAN password.
- 3 Control playback of your music on the other device that supports DLNA.

Sync your music between your phone and computer

Do you have music on your computer that you want to listen on your phone? You can use a USB cable to sync your music between your phone and a computer.

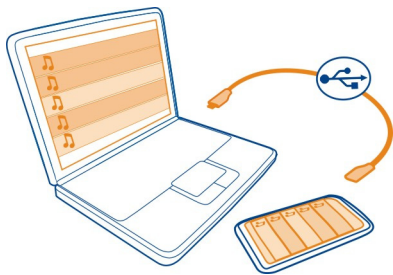

- 1 Connect your phone to your computer with a compatible USB cable.
- 2 Select Sync and connect.
- 3 On your computer, open Nokia Link, and follow the instructions shown on the computer. For more info, see the Nokia Link help.

Tip: Get more music from Nokia Music. Select . To learn more about Nokia Music, go to www.nokia.com/music.

Videos

About Videos

Select .

You can browse, download, and watch videos on your phone when out and about.

Tip: Get new videos from Nokia Store. For more information, go to www.nokia.com/support.

Using services or downloading content may cause transfer of large amounts of data, which may result in data traffic costs.

Play a video

To browse your video collection, select . To browse the videos you have recorded, select .

- 1 Select a video.
- 2 To use the video player controls, tap the screen.

Sync your videos between your phone and PC

Do you have videos that you want to watch on your phone? You can sync your videos between your computer and your phone.

- 1 Use a compatible USB cable to connect your phone to your computer.
- 2 Select **Sync and connect**.
- 3 On your computer, open Nokia Link. For more info, see the Nokia Link help.

On your phone, videos that are in a supported format are displayed in Videos.

Stream or download videos from the internet

You can download or stream videos over the air from compatible internet video services. When you stream a video, you can start to watch it soon after starting; you do not need to wait for the whole video to download first.

Select , and search for a video.

Play a video

Select a video. To access the video player controls, tap the screen.

Some videos can be streamed over the air, but others must be first downloaded to your phone. Downloads continue in the background if you close the application. The downloaded videos are saved in Videos.

Tip: Get new videos from Nokia Store. To learn more about Nokia Store, go to www.nokia.com/support.

Using services or downloading content may cause transfer of large amounts of data, which may result in data traffic costs.

Enjoy surround sound through your headphones

Want to enjoy the realistic and intense sounds of a movie or a concert experience? With Dolby™ Digital Plus 5.1 multichannel audio, you can enjoy immersive surround sound over any pair of headphones.

- 1 Connect headphones to your phone.

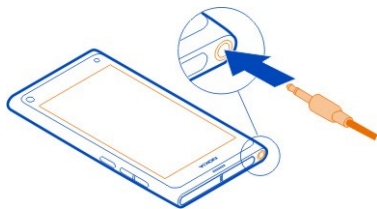

- 2 To activate or deactivate surround sound, select  and **Applications > Videos > Dolby Headphone**.

Dolby™ Headphone can use any native 5.1 content, but can also convert 2-channel content into surround sound.

Camera and Gallery

Take photos

About the camera

Select .

Why carry a separate camera if your phone has all you need for capturing memories? With your phone camera, you can easily take photos or record videos.

The back camera on your phone is an 8-megapixel autofocus camera. The wide-angle Carl Zeiss™ lens lets you capture more, by broadening the angle of view, for example, when taking a group photo in a confined space.

You can later use your phone to view or edit the photos and view the videos, share them on the internet, or send them to compatible devices.

Tip: To access the camera quickly, hold your phone upright, and drag your finger from below the bottom of the touch screen onto the screen. Hold your finger in place, until the quick launch bar is displayed.

Take a photo

Select .

Select and hold . The focus is locked when a blue rectangle is displayed. To take the photo, lift your finger. Do not move the phone before the photo is saved and the phone is ready for a new photo.

Zoom in or out

Use the volume keys.

Focus on a specific object or area



Tap the object or area on the screen.

Touch focus is always activated. However, it is not available in landscape or sports scene modes.

When taking a photo, you can recompose it without losing the focus point.

Recompose a photo while taking it

- 1 To lock the focus, select and hold . The focus is locked when a blue rectangle is displayed.
- 2 Recompose the photo.
- 3 To take the photo, lift your finger.

Tip: To mark a photo as a favourite right after taking it, select , tap the screen to show the toolbar, and select . Later, you can find the photo on the  tab in Gallery.

With the face tracking feature, you can take sharp photos of people's faces. It optimises focus, white balance, and exposure, and draws rectangles around faces, even when they are moving. It is not available in landscape, sports, night, and macro scene modes.

Switch face tracking on or off

Tap the settings area, and switch **Face detection** on or off.

If you tap the screen to move the focus, face tracking is switched off. To switch it on again, tap the middle of the screen. Face tracking is also switched on when you return to the camera from another view.

Photos and videos taken with your phone are saved in Gallery. To open Gallery, select



Camera tips

Select

Here are some tips to help you use the camera.

- Use both hands to keep the camera steady.
- To zoom in, use the volume keys or the zoom slider on the screen.

When you zoom in, the image quality may decrease.

- To interrupt taking a photo after selecting , slide your finger away from , then lift it.
- The camera goes to battery saving mode after about a minute of inactivity. To wake up the camera, tap the screen.

Keep a safe distance when using the flash. Do not use the flash on people or animals at close range. Do not cover the flash while taking a photo.

- To switch between taking photos and recording videos, select or .
- To change camera settings, such as flash, scene modes, aspect ratio, and resolution, tap the settings area 7M, and select the setting.
- By default, photos use the 16:9 aspect ratio and have a 7 Mpix resolution. This aspect ratio is best suited to view the photos on a TV, as there are no black edges. To take 8 Mpix photos, change the aspect ratio to 4:3. Tap the settings area, and select the appropriate settings.
- To share a photo or video with NFC directly from the camera, the photo or video needs to be shown on the screen. By default, the captured content is not shown after taking a photo or recording a video. To show it, tap the settings area, and select the appropriate setting for Show captured content.
- In all applications, and even on the lock screen, you can easily access the camera. Hold your phone upright, and drag your finger from below the bottom of the touch screen onto the screen. Hold your finger in place, until the quick launch bar is shown.

Take a close-up photo

It can be tricky to get small objects, such as insects or flowers, in focus. You need to move the camera closer to the object. To take sharp and precise photos of even the tiniest details, use close-up mode.

Select .

Switch close-up mode on

Tap the settings area, and in **Scene**, select **Macro**.

Take a photo in the dark

Want to take better photos even in dim light? Switch night mode on.

Select .

Switch night mode on

Tap the settings area, and in **Scene**, select **Night**.

Tip: You can also record videos in dim light. To turn night video mode on, switch to video mode, tap the settings area, and select **Video at night**.

Take a photo of a moving object

Are you at a sports event and want to capture the action with your phone? Use sports mode to take a sharper photo of moving people.

Select .

Switch sports mode on

Tap the settings area, and in **Scene**, select **Sports**.

Take a series of photos

Would you like to shoot lots of photos quickly, to capture the perfect moment of an action or facial expression? Use continuous shutter mode.

Select .

Change the shutter mode

Tap the settings area, then switch **Continuous shutter mode** on.

Save location info to your photos and videos

If you sometimes want to find all your photos or videos that match a certain location, or sometimes struggle to remember where you were when you took a particular photo or recorded a video, you can set your phone to automatically record the location and add geotags to your photos and videos.

GPS is used to record the coordinates of your location. Geotagging converts the coordinates into location tags with info of, for example, the country and the city. This is a network service and may result in data costs.

The location info may not be available in all regions.

Select .

You need to switch GPS on before you can switch geotagging on.

Switch GPS and geotagging on

- 1 Tap the settings area, and select **Use GPS**.

It may take several minutes to obtain the coordinates of your location. The availability and quality of GPS signals may be affected by your location, buildings, natural obstacles, and weather conditions. This feature requires network service.

- 2 Select **Use geotags**.

Tip: You can also add or edit geotags later, in Gallery.





Location information can be attached to an image or a video clip, if location information is available. Location information may become visible to third parties, if images or video clips are shared.

Record videos

Record a video

Besides taking photos with your phone, you can also capture your special moments as videos.

Select .

- 1 To switch from photo mode to video mode, if necessary, select .
- 2 To start recording, select . A red record icon is displayed.
- 3 To stop recording, select . The video is automatically saved in Gallery. To open Gallery, select .



Send and share photos and videos

Send a photo or video

You can send photos and videos in a multimedia or mail message, or using Bluetooth or NFC.

Select .

Send in a multimedia message

- 1 Take a photo or record a video.
- 2 Select  >  **Multimedia message**.

- 3 To select a recipient from your contacts list, select **To** > . To write the recipient's name or phone number manually, select the **To** field, and write the name or phone number.
- 4 Select **Send**.

Send in a mail

- 1 Take a photo or record a video.
- 2 Select > and **Mail**.
- 3 To select a recipient from your contacts list, select . You can also write the address in the **To** field.
- 4 Select **Send**.

Send using Bluetooth

- 1 Take a photo or record a video.
- 2 Select > and **Bluetooth**.
- 3 Select the device to connect to, and select **Continue**.
- 4 If the other device requires a passcode, type in the passcode.

Send using NFC

- 1 Take a photo or record a video.
- 2 Select > and **NFC**.
- 3 Touch the other phone with the NFC area of your phone.

Share a photo or video directly from the camera

After taking a photo or recording a video, you can upload your photo or video to a sharing service.

Select .

- 1 Take a photo or record a video.
- 2 Select .
- 3 If necessary, tap the screen to show the toolbar, and select > **New account**.
- 4 Sign into a sharing service, and follow the displayed instructions.

Tip: You can also share pictures or videos from Gallery, or with another phone that supports NFC. To share with NFC, after taking a photo or recording a video, touch the NFC area of the other phone with the NFC area of your phone.

Not all sharing services support all file formats or videos recorded in high quality.

Gallery**About Gallery**

Select .

The photos you have taken or videos you have recorded are collected in Gallery, where you can view and edit them.



You can also view the photos and videos on a compatible TV.

To find your photos and videos easily, add tags to them, or mark them as favourites.

View a photo or video

Select .

Browse photos and videos

To browse all photos on the phone or videos recorded with the phone camera, select , then scroll up or down. To browse the photos taken or videos recorded with the phone camera, select , then scroll up or down.

View a photo in full screen mode

Select the photo. To show the toolbar, tap the photo.

Zoom in or out

Place two fingers on the screen, and slide your fingers apart or together.



Tip: To quickly zoom in or out, double-tap the screen.

View photos as a slide show

Select a photo, tap the screen to show the toolbar, and select  > **Slide show**. The slide show starts from the selected photo. To stop the slide show, tap the screen.

Play a video

Select a video.

Photos and videos can also be sent to you from a compatible device. You can view a received photo directly in Gallery and a received video in Videos.

Organise your photos and videos

To organise your photos and videos, add tags to them, or mark them as favourites. With tags and favourites, it's easy to categorise and find the photos and videos in Gallery.

Select .

Tags are keywords that you can create and attach to your photos and videos. Geotags are tags that include location information, such as country and city.

Add a tag

- 1 Select a photo or video, tap the screen to show the toolbar, and select  > **Edit tags**.
- 2 Select a tag. To create a new tag, select **Add new tag**.

You can also add the same tags to several photos or videos at a time.

Add tags to several photos or videos

- 1 In the Gallery main view, select  > **Edit tags**.
- 2 Select the photos or videos and **Edit tags**.
- 3 Select the tags, or create new ones, and select **Done**.

Add a geotag

Select a photo or video, tap the screen to show the toolbar, and select  > **Edit tags** > **Edit geotags**. Move the indicator to the correct location, then select **Done** > **Done**.

View the photos and videos that match a tag

In the Gallery main view, select  > **Filter by tags**, then select the tag and **View**. You can also view photos and videos that match several tags. Selecting several tags shows the photos and videos that are marked with all of the selected tags.

Mark as a favourite

Select a photo or video, tap the screen to show the toolbar, and select .

View the photos and videos that are marked as favourites

In the Gallery main view, open the  tab.

Tag people in your photos

To easily combine the names with the faces in your photos, add face tags to your photos in Gallery.

Select .

Face recognition needs to be on before you can add face tags.

Switch face recognition on

Select  and Applications > Gallery, and switch Face recognition on.

Add a face tag to an unnamed face

- 1 Select a photo, tap the screen to show the toolbar, and select the bubble with the question mark.
- 2 Write the name, or select , and select the person from your contacts list.
- 3 Select **Save**.

After you have named a face a few times, the app starts to suggest a name for a face it recognises.

Accept or change a suggested face tag

- 1 Select a photo, tap the screen to show the toolbar, and select the bubble with the suggested name.
- 2 To accept the suggested name, select **Save**. To change the name, select , then select the person from your contacts list. You can also start writing a name, and the phone suggests a matching name from your contacts list.

Tip: To quickly accept the suggested name, double-tap the bubble.

- 3 Select **Save**.

View tagged photos

In the Gallery main view, open the  tab.

All the face tags that you have added to your photos in your phone may not be visible when you share the photos in a social networking service. In some social networking services, you can only add face tags to persons on your friend list.

View a photo or video on a TV

Want to show the photos and videos on your phone to your family and friends? Connect your phone to a compatible TV, and view the photos and videos on a bigger screen.

You need to use a Nokia Video Connectivity Cable (available separately), and may need to change the TV-out settings.

Change the TV-out settings

Select  and Accessories > TV-out.

Do not connect products that create an output signal as this may cause damage to the phone. Do not connect any voltage source to the headset connector. If you connect an external device or headset, other than those approved by Nokia for use with this phone, to the headset connector, pay special attention to volume levels.

- 1 Plug a Nokia Video Connectivity Cable to the video input of a compatible TV. The colour of the plugs must match the colour of the sockets.
- 2 Plug the other end of the Nokia Video Connectivity Cable to the headset connector of your phone.
- 3 Select a photo or video.

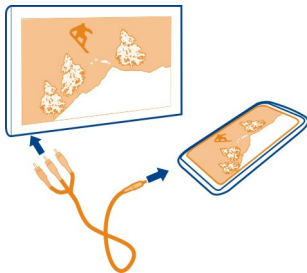

Tip: If your TV supports DLNA, and is connected to a WLAN, you can view the photos and videos also without the cable connection. [See "View your photos and videos wirelessly on your home entertainment system", p. 75.](#)

Photo editor

Edit a photo you have taken

Do you need to crop your photos or remove red eyes? You can easily do simple edits to the photos you have taken with your phone.

When you edit a photo, you do not lose the original shot. In other words, you can undo all the edits or revert to the original photo at any time.

Select .

Apply an effect

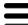
Select a photo, tap the screen to show the toolbar, and select  > **Edit** and the desired option. The changes you make are saved automatically.

You can undo or redo changes even after closing Gallery or restarting the phone.

Undo or redo an effect

Select  or .

To view your edited photos, select .



Reset to original

Select the photo, tap the screen to show the toolbar, and select  > **Edit** > **Reset to original**.

Video editor**Edit your videos**

Cut and trim your videos down to the essentials.

Select  and a video.

- 1 Tap the screen to show the toolbar, and select  > **Edit**.
- 2 Drag the handles to mark the start and end of your video.
- 3 To add music to your video, select .
- 4 To preview your video, select .
- 5 To save your video, select **Done**.

If you try to send a video in a multimedia message, and the file size or length exceeds the allowed limit, the video editor opens automatically.

View your photos and videos wirelessly on your home entertainment system

You can stream photos and videos on your phone to another device that supports DLNA, such as a TV.

Before starting, make sure your network setup is correct. [See "About streaming your media files", p. 35.](#)

- 1 If needed, switch the media sharing server on. Select  and **Device** > **Media sharing settings** > **Media sharing** > **On**.
To later access the media sharing server from the status menu, switch **Always show Media sharing in status menu** to **On**.

- 2 If asked, type in the WLAN password.
- 3 View and control playback of your photos and videos on the other device that supports DLNA.

Maps and navigation

GPS

About positioning methods

Your phone displays your location using GPS, A-GPS, WLAN, or cellular positioning.

The Global Positioning System (GPS) is a satellite-based navigation system used for calculating your location. Assisted GPS (A-GPS) is a network service that sends you GPS data, improving the speed of the positioning. In addition, other enhancements to GPS may be used to improve and speed up the positioning. These may require transferring small amounts of data over the cellular network.

Wireless local area network (WLAN) positioning improves position accuracy when GPS signals are not available, especially when you are indoors or between tall buildings.

With cellular positioning, the position is determined through the cellular network antenna your phone is currently connected to.

To save on data costs, you can deactivate A-GPS in your phone positioning settings, but calculating your location may take much longer.

You can deactivate WLAN in your phone internet connection settings.

Depending on the available positioning methods, the accuracy of positioning may vary from a few metres to several kilometres.

The availability and quality of GPS signals may be affected by your location, satellite positions, buildings, natural obstacles, weather conditions, and adjustments to GPS satellites made by the United States government. GPS signals may not be available inside buildings or underground.

Do not use GPS for precise location measurement, and never rely solely on the location information provided by GPS and cellular networks.

Coordinate information may not be available in all regions.

Deactivate assisted GPS (A-GPS)

Assisted GPS (A-GPS) helps your phone determine your current location more quickly. A-GPS is a network service. To save on data costs, especially when abroad, you can deactivate the service.

Select  and **Device > GPS and positioning**, and deactivate **Mobile data connection**.

The Assisted GPS (A-GPS) network service retrieves location information using the cellular network, and assists GPS in calculating your current location.

Your phone is preconfigured to use the Nokia A-GPS service, if no service provider-specific A-GPS settings are available. The assistance data is retrieved from the Nokia A-GPS service server only when needed.

You must have a mobile data internet access point defined in the phone to retrieve assistance data.

 **Note:** The use of assisted positioning methods may involve exchanging your location data, wireless network identifiers along with your unique phone or network service provider identifiers with a location server. Nokia processes this information anonymously. Depending on your positioning settings and your use of location services, your phone may connect to other service providers' servers, which are not controlled or operated by Nokia. Check the privacy policies of such service providers to understand how they process your location data.

Tips on creating a GPS connection

Check the satellite signal status

 in the status area indicates an active GPS connection.

If a satellite signal cannot be found, consider the following:

- If you are indoors, go outdoors to receive a better signal.
- If you are outdoors, move to a more open space.
- If the weather conditions are bad, the signal strength may be affected.
- Some vehicles have tinted (athermic) windows, which may block the satellite signals.
- Make sure you do not cover the antenna with your hand.



- Use an external GPS receiver.

The GPS receiver uses the phone battery. Using GPS may drain the battery more quickly.

Maps

About Maps

Select .

Maps shows you what is nearby, and guides you where you want to go.

- Find cities, streets, and places of interest.
- Plan your route.
- Find your way with turn-by-turn directions.

Some services may not be available in all countries, and may be provided only in selected languages. The services may be network dependent. For more information, contact your network service provider.

Using services or downloading content may cause transfer of large amounts of data, which may result in data traffic costs.

Contents of digital maps may sometimes be inaccurate and incomplete. Never rely solely on the content or the service for essential communications, such as in emergencies.

Some content is generated by third parties and not Nokia. The content may be inaccurate and is subject to availability.

View your location and the map

See your current location on the map, and browse maps of different cities and countries.

Select .

- 📍 indicates your current location, if available. If your current location is not available,
- 📍 indicates your last known location.

Browse the map

- 1 Drag the map with your finger. By default, the map is oriented north.
- 2 You can also use two fingers to rotate the map.

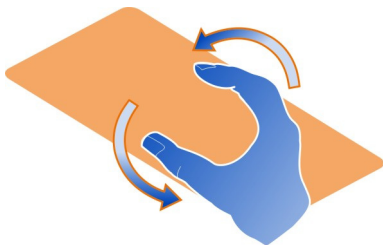

To enable two-finger rotation, select **⋮** > **Settings**, and activate **Two-finger map rotation**.

View your current location

Select 📍 on the map.

If you search for or browse to a location, and view details about the location, the information for the location you are currently viewing is displayed. To return to viewing your current location, or to view information for your current location, select 📍.

Zoom in or out

To zoom in, double-tap the map, or place two fingers on the map and slide them apart. To zoom out, slide your fingers together.

Tip: You can also use the zoom bar. To display the bar in the different views, select **⋮** > **Settings**, and activate **Zoom bar**.

If you browse to an area not covered by the street maps that are stored on your phone, and you have an active data connection, new street maps are automatically downloaded.

New street maps are also downloaded if you upgrade to the latest Maps application version.

Map coverage varies by country and region.

Change the look of the map

View the map in different modes, to easily identify where you are.

Select .

Select  and from the following:

Map — In the standard map view, details such as location names or motorway numbers are easy to read.

Satellite — For a detailed realistic view, use satellite images.

Terrain — View at a glance the ground type, for example, when you are travelling off-road.

Public transport lines — View selected public transport services, such as metro, bus, or tram routes.

3D Mode — For a more realistic view, change the perspective of the map.

Nightmode — Dim the colours of the map. When travelling at night, the map is easier to read in this mode.

3D Landmarks — Display prominent buildings and attractions on the map.

The available options and features may vary by region. The unavailable options are dimmed.



Get guidance

You can get guidance for walking, driving, or travelling by public transport.

Select  and .

Voice guidance, if available for your language, helps you find your way to a destination, leaving you free to enjoy the journey.



Get voice guidance

- 1 Use your current location as the starting point, or enter a location in the field, and select from the proposed matches.
- 2 Enter the destination in the appropriate field.
- 3 The selected destination is displayed on the map. Select the destination marker and  or , and select **Get directions**.
- 4 To start voice-guided navigation, select **Navigate**. To view written directions, select .

Tip: For walk navigation, voice guidance is by default deactivated. To activate it, select  > **Voice guidance**, or, if no language has been selected **Select voice**.

You can get guidance on which bus, train, or underground lines to use, and how to get to the stations or stops.

Get guidance for public transport

- 1 When you have entered your destination, select the destination marker on the map and  > **Get directions**.
A map of the route is displayed.
- 2 For detailed instructions, select .

Tip: To navigate to a place you have found through nearby or category search, select the place marker and .

Download and update maps

Save street maps to your phone, so you can browse the maps without an internet connection and save on data costs when travelling.

Select .

To download and update maps on your phone, you need an active WLAN connection.

Download maps

- 1 Select **...** > **Manage maps** >  > **Add maps**.
- 2 Select the continent and country, and select **Download**.

Update maps

- 1 Select **...** > **Manage maps** >  > **Check for updates**.
- 2 If new updates are available, the phone offers those to you. Select **Download**.

Use Maps offline

To save data costs, especially when travelling, you can also use Maps without an internet connection.

Select .

When you have downloaded the needed maps to your phone, you can use, for example, positioning, search, and navigation also in offline mode.

Select **...** > **Settings**, and deactivate **Online**.

Tip: To make sure that you can use Maps offline when abroad, download the needed maps to your phone before the trip.

Find a location

Maps helps you find specific locations, places of interest, and businesses.

Select  and .

Search for a location



- 1 Enter search words, such as a street address or place name in the Search field.
- 2 Select an item from the list of proposed matches.
The location is displayed on the map.

If no search results are found, make sure the spelling of your search words is correct.

View the list of proposed matches

Select .

Search for nearby places

- 1 Select 
The nearby public places are shown as place markers on the map.
- 2 To view a list of the nearby places, select .
- 3 To view the details of a place, select the place marker and its information field.

Search for places by category

- 1 Select  > Categories and a category.
- 2 To view the details of a place, select the place from the list.
- 3 To view the place on a bigger map, tap the map.

Tip: To view the details of a found place, you can also select its marker on the map.

Problems with your internet connection may affect results when searching online.

If you have maps of the searched area stored on your phone, to avoid data transfer costs, you can also get search results without an active internet connection, but the search results may be limited.

Save a favourite place

Save an address or a place of interest, so it can be quickly used later.

Select .

Save a place

On the map, select a location marker and its information field.

On the information page, select ☆.

View and edit your favourite places

You can quickly access the places you have saved.

Select  and  > Favourites.

View a saved place on the map

In your favourites list, select the place, and tap the map.

It is also possible to check the contact information for a saved place, if available. For example, you can call a restaurant or view its website.

Contact a place

- 1 In your favourites list, select the place and **Contact**.
- 2 You can select the phone number, mail address, or web address.

Edit or delete a saved place

- 1 In your favourites list, select the place.
- 2 Select , and edit the name or description. To delete the place, select **Delete**.

Send a place to a friend

When you want to show your friends where a place is on the map, you can send the place to them.

Select .

To view the place on the map, your friends don't need to have a Nokia phone, but an active internet connection is required.



- 1 Select the location marker on the map and its information field. The information page is displayed.
- 2 Select .

A mail or text message containing a link to the location on the map is sent to your friend.



Walk to your destination

When you need directions to follow a route on foot, Maps guides you over squares, and through parks, pedestrian zones, and even shopping centres.

Select .

- 1 Select , and enter your destination.
- 2 On the map, select the destination location marker and  > **Get directions**.
- 3 To start voice-guided navigation, select **Navigate**.

View the whole route

- 1 Select .
- 2 To zoom into your current location, select .

Deactivate voice guidance

Select  > **Voice guidance**.

Change the guidance voice

 > **Select voice**.

Prevent the display switching off

 > **Backlight always on**.

Use the compass

When the compass is switched on and properly calibrated, the map rotates so that it shows the direction you are facing. The compass points to true north.

Select .

Switch the compass on

Select .

Switch the compass off

Select . The map is oriented north.

If the compass needs calibration, follow the instructions shown on the phone.

The compass has limited accuracy. Electromagnetic fields, metal objects, or other external circumstances may also affect the accuracy of the compass. The compass should always be properly calibrated.

Give feedback on Maps

Participate in improving the Maps application, and send your feedback.

Select .

- 1 Select  > **Feedback**.
- 2 Select how likely you are to recommend Maps to other people.

You can also give your reasons. The feedback is anonymous.

3 Select **Submit**.

To give feedback, you need to have an active internet connection.

After you have sent your feedback for the current version of Maps, the option is no longer available.

Drive

Drive to your destination

When you need clear turn-by-turn directions optimised for use while driving, Drive helps you get to your destination.

Select .

To use Drive, you need to be signed in to your Nokia account.

Drive to a destination

Select  > **Set destination** and the appropriate option.

Tip: To set your destination, you can also select and hold your destination on the map, and select **Drive to**.

You can start driving without a set destination. The map follows your location.

By default, the map rotates to your driving direction. The compass always points north.

Drive to your home

Select  > **Set destination** > **Home**.

When you select Home for the first time, you are asked to define your home location.

Change your home location

Select  > **Settings** > **Home location**.

Tip: To explore your surroundings on a full screen map, tap the map.

See an overview of your route

In the navigation view, select .

Obey all local laws. Always keep your hands free to operate the vehicle while driving. Your first consideration while driving should be road safety.

Get voice guidance

Voice guidance helps you find your way to a destination, leaving you free to enjoy the journey.

Select .

- 1 Select  > **Settings** > **Navigation voice**.
- 2 Select a language, or to deactivate voice guidance, select **None**. Voice guidance may not be available for your language.

You can also download new navigation voices.

Download navigation voices

Select  > **Settings** > **Navigation voice** > **Download new** and a voice.

You can use other applications when navigating, and still hear the voice guidance.

View places on the map

Looking for a petrol station, parking place, or a place to eat? Set your phone to display them on the map.

Select .

- 1 Select  > **Settings** > **Map layers** > **Places**.
- 2 Select the categories you want to see on the map.



Tip: Drive displays landmarks, such as prominent buildings and attractions, on the map. Landmarks are best viewable in 3D. If you don't see any landmarks, zoom in.

If you want to hide landmarks, select  > **Settings** > **Map layers**, and deactivate **Landmarks**.

Select your preferred route

Drive can choose the route that best suits your needs and preferences.

Select .

- 1 Select  > **Set destination** and the appropriate option.
- 2 Before starting navigation, select .
- 3 Define if you want to allow or avoid using, for example, motorways, toll roads, or ferries.
- 4 Select  > **Start navigation**.

Navigate offline

To save data costs, you can also use Drive offline.

Select .

Select  > **Settings**, and clear the **Connection** check box.

Some features, such as search results, may be limited when using Drive offline.

Change the look of the Drive view

Would you like to see a more realistic 3D map, or are you using Drive at night, when it's dark? With the different map modes, you can see the information you need clearly at all times.

Select .

Change the map type

Select  > 2D, 3D, or Sat..

To see the map clearly also when it is dark, you can activate night mode.



Activate night mode

Select  > **Settings** > **Map colours** > **Night**.

Save a place

To aid your travel planning, you can search for hotels, attractions, or petrol stations, and save them to your phone.

Select .

- 1 To search for an address or place, select  > **Set destination** > **Search**.
- 2 Select the place from the proposed matches.
- 3 Select .

Save your current location

Select  > **Save location**.

Drive to a saved place

Select  > **Set destination** > **Favourites** and the place.

Synchronise your favourites

Plan where you want to go on your trip – find the places at the Nokia Maps website, synchronise the saved places with your phone, and access the plan on the go.

Select .

Synchronise saved places

Select  > Set destination > Favourites > Synchronize.

Synchronising requires an internet connection, and may involve the transmission of large amounts of data through your service provider's network. For information about data transmission charges, contact your service provider.

To use the Nokia Maps web service, go to www.nokia.com/maps.

Productivity and time

Time management

Clock

Learn how to set the time and date of your phone, and how to set alarms.

About the clock

Select .

Set and manage alarms.

Set an alarm

Want to wake up to your favourite song in the morning? You can use your phone as an alarm clock.

Select .

- 1 Select .
- 2 Set the alarm time, and enter a description.
- 3 To set the alarm to sound, for example, at the same time every day, select **More options** > **Repeat** > **Every day**.
- 4 To set the alarm tone, select **Alarm tone**.

Remove an alarm

In the Alarms view, select and hold the alarm, and from the pop-up menu, select **Delete**.

Tip: In the Alarms view, you can use the switch to temporarily deactivate an alarm.

Snooze an alarm

When an alarm sounds, you can snooze the alarm. This pauses the alarm for a defined length of time.

When the alarm sounds, select **Snooze**.

Set the length of the snooze time for an alarm

Select the alarm and **More options** > **Snooze time**, and set the length of time.

Tip: To snooze the alarm, you can also turn your phone face down.

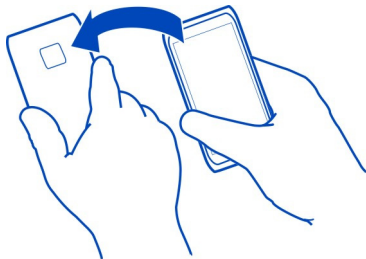

Set the time and date

Select  and **Time and language** > **Time and date**.

Update the time and date automatically

You can set your phone to update the time, date, and time zone automatically. Automatic update is a network service.

Select  and **Time and language** > **Time and date**, and activate **Automatic time update**.

Calendar

About the calendar

Select .

With your phone calendar, you can keep your schedules organised.

View your schedule for the week

You can browse your calendar events in different views. To see an overview of a particular week, use the week view.

Select .



Select .

Tip: To view a list of your upcoming events, select .

Add a task to your to-do list

Do you have important tasks to handle at work, library books to return, or maybe an event you want to attend? You can add tasks (to-do notes) to your calendar. If you have a particular deadline, set a reminder.

Select .

- 1 Select  > Show to-dos.
- 2 Select .
- 3 Fill in the fields.
- 4 Activate **Due date**.
- 5 To set a reminder, select **Reminder:** and the interval, and set the reminder time.

Mark a task as completed

In the to-do list, select the check box next to the task.

Add a calendar event

Select .

- 1 In a calendar view, select .
- 2 Fill in the fields.
- 3 To invite participants, select  > Add contacts >  and the contacts.
- 4 Select Save.

Set the default length of reminder time

Select  and Applications > Calendar > Default reminder displayed, and set the length of the reminder.

Add the location to a calendar entry

Do you have an appointment in a place you are not familiar with? If you add the location to the meeting entry, you can check the location from a map before setting off.

Select .

Add the location manually

When adding a meeting event, select **Location:**, and enter the address.



Select the location from the map

- 1 When adding a meeting event, select **Add location** > .
- 2 To zoom in, tap the map twice.
- 3 Select a location on the map.
- 4 Select **Done**.

To add a location to a meeting event later, open the meeting event, and select .

Use separate calendars for work and free time

You can have more than one calendar. Create one for work and others for your free time, such as family or hobbies.

Select  and  > **Manage calendars**.

Create a new calendar

- 1 Select .
- 2 Enter a name, and set a colour code for the calendar. In different calendar views, the colour codes indicate to which calendar an event is saved.

When a calendar is hidden, the calendar events and reminders are not displayed in different calendar views or in the Events view.

Define the visibility for a calendar

Select the desired calendar, and activate or deactivate **Show this calendar and reminders**.

Modify the settings for a calendar

Select  and **Applications** > **Calendar**.

Use Microsoft ActiveSync™

- 1 Select  > **Add account**.

- 2 Select **Mail for Exchange**, and enter your user credentials.
- 3 Select **Manual setup**, and select the items you want to sync.
- 4 Enter the server address, and select **Done**.

Sync with another mail or calendar service

- 1 Select  > **Add account**.
- 2 Select a service, enter your user credentials, and select **Sign in**.

Productivity

Use the calculator

Select .

- 1 Enter the first number of the calculation.
- 2 Select a function, such as add or subtract.
- 3 Enter the second number of the calculation.
- 4 Select =.

This feature is designed for personal use. Accuracy may be limited.

Read office documents

You can view documents, such as PDFs, Microsoft Office and Open Document Format documents, spreadsheets, and presentations.

Select .

Sort files by name, date, or document type

Select  > **Sort by** > **Name, Time or Type**

View a document in full screen mode

Select the document. To display the toolbar, tap the document.

Jump to a page

Select , and enter the page number.

Share a document

- 1 Select  > **Share**.
- 2 Select the sharing method.

Not all file formats or features are supported.

Make a shopping list

Shopping lists on paper are easy to lose. Instead of writing them on paper, you can make your shopping lists with Notes. This way, you always have the list with you!

Select .

- 1 To add a new note, select **+**.
- 2 Enter text in the note field.

Phone management

Keep your phone software and applications up to date

About phone software and app updates

Stay in step with the beat – update your phone software and apps to get new and enhanced features for your phone. Updating the software may also improve your phone performance. You may also receive important security updates.

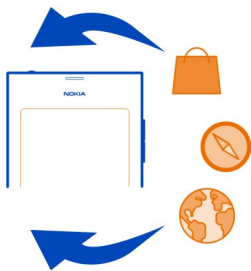

It is recommended that you back up your personal data before updating your phone software.

Warning:

If you install a software update, you cannot use the device, even to make emergency calls, until the installation is completed and the device is restarted.

Using services or downloading content may cause transfer of large amounts of data, which may result in data traffic costs.

Before starting the update, connect a charger or make sure the device battery has enough power.

After the update, the instructions in the user guide may no longer be up to date. You may find the updated user guide at www.nokia.com/support.



View your software version

Select  and About product.

Tip: You can also dial ***#0000#**.



Update phone software and applications using your phone

Your phone informs you when updates are available for your phone software or for individual applications. To keep your phone up to date, download and install the updates on your phone (network service). You can also check for updates manually.

When an update is available for your phone software, a notification message with the icon  is displayed in the Events view. Updates for individual applications are indicated with the icon . To view and install the available update, select the notification message.

It is recommended that you create a backup before updating your phone software.

Check for updates manually

- 1 Select  > Applications > Manage applications.
- 2 Open the  tab, and select  to refresh the view.

You can update individual applications or all available applications.

Update phone software using your PC

You can use the Nokia Software Updater PC app to update your phone software. You need a compatible PC, a high-speed internet connection, and a compatible USB cable to connect your phone to the PC. To restore all your personal info to your phone, back up your phone to your computer before you start updating your phone.

Tip: When you update your phone software, the language of your on-screen keyboard is set back to the default language. If your security code includes characters that are not part of this on-screen keyboard, select , then swipe left or right across the keyboard to change the language of the on-screen keyboard to the one you used when creating the security code.

You can download the Nokia Software Updater app from www.nokia.com/support.

Back up

Back up files

Want to make sure that you will not lose any important files? You can create backups of the phone memory.

Select  and Sync and backup > Backup.

It is recommended that you back up the phone memory regularly.

Tip: To restore a backup, select the backup file to restore and **Restore**, and follow the instructions shown on the phone. You may not be able to restore some installed applications.

Large media files such as photos and videos are not included in the phone backups. You can use the Nokia Link application to sync your important files, such as photos and videos, with a compatible computer. You can also use Nokia Link to back up and restore content, such as your contacts, calendar entries, and messages. To access the backup and restore feature, select .

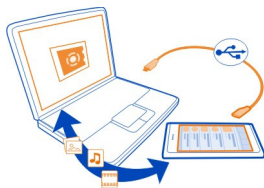

Manage applications

About Applications

Select  > Applications > Manage applications.

You can update and remove application packages, such as applications and add-ons.

Install new applications

With Nokia Store, you can download mobile games, applications, and different kinds of add-ons to your phone.

Select .

On some websites, to install an application, you can select a link to a file with the .deb file extension. To be able to install applications from mail attachments, file systems, websites, or repositories other than Nokia Store, you need to enable this in the installation settings.

Enable installation from outside Nokia Store

Select  and Applications > Installations, and activate **Allow installations from non-Store sources**.

Only install applications that are compatible with your phone.

! **Important:** Only install and use applications and other software from sources that you trust. Applications from untrusted sources may include malicious software that can access data stored in your device, cause financial harm, or damage your device.

View installed applications

Select  > **Applications** > **Manage applications**.

View the details of an application

Select the application.

Remove an application from your phone

You can remove installed applications that you no longer want to keep or use, to increase the amount of available memory.

Tap and hold the Applications view, and select  on the application.

Once confirmed and started, the uninstallation process cannot be cancelled.

If you remove an application, you may not be able to open files created with the removed application.

If an installed application depends on a removed application, the installed application may stop working. For details, see the user guide of the installed application.

To view the details of an application before removing it, select  > **Applications** > **Manage applications** and the application. To remove the application, select **Uninstall**.

Restore an application package

You can create a backup file for your phone and, if needed, later restore the application packages you want.

You may not be able to restore some of the installed applications.

- 1 Select  > **Sync and backup** > **Backup**.
- 2 Select a backup file to restore and **Restore**, and follow the displayed instructions.
- 3 After the restore, you are asked if you also want to restore application packages. If there are packages to be restored, to view the available packages, select **Yes**.
- 4 Select the application package to restore and **Restore**.

You can also restore application packages later. Select  > **Applications** > **Manage applications**.

Memory

Free up phone memory

Do you need to increase the available phone memory, so you can install more applications or add more content?

You can delete the following if no longer needed:

- Text, multimedia, and mail messages
- Contact entries and details
- Applications
- Music, pictures, or videos

Copy content you want to keep to a compatible computer.

Synchronise content

Synchronise your important information

Would you like to have your contacts, calendar, notes, and other content backed up and at hand, whether you are sitting by your computer or on the go with your phone? Synchronise your important content to online services, and access them from anywhere you go. You can also synchronise content with other devices, such as phones or computers.

Synchronise with online services

Select .

Synchronise with other devices

Select  > Sync and backup > Sync.

When you open the application, the default or previously used synchronisation profiles are displayed. You may receive synchronisation settings as a configuration message from your service provider.

Synchronise with online services

Have all your accounts, contacts, calendar entries, and other important information synchronised to your phone. Back up your important content online for easy transfer or restoring to your phone.

Select .

Synchronising with services is on by default.

Include or exclude content

Select an account and the content type to include or exclude.

The available options may vary.

Deactivate sync

Select an account, and deactivate Schedule.

Synchronise content with another phone

Keep your important information synchronised between, for example, your personal and work phone.

Select  > Sync and backup > Sync.

Create a sync profile

- 1 Select Add device. If you already have created other sync profiles, select .
- 2 Select the other phone and Continue
- 3 Follow the displayed instructions on both phones.
- 4 Select the content to synchronise. The available options may vary. You may also be able to select which phone's data you want to keep if there are conflicts, for example, different phone numbers for the same contact.
- 5 To synchronise, select Sync.

Synchronise using an existing sync profile

Make sure Bluetooth is activated on both phones, and select Sync.

Include or exclude content types

In the desired profile, select the content types.

Remove a sync profile

In the desired profile, select .

Protect your phone

Set your phone to lock automatically

Want to protect your phone against unauthorised use? Define a security code, and set your phone to lock itself automatically when you're not using it.

- 1 Select  and Security > Device lock.
- 2 Select Security code, and enter a security code (at least 5 characters). You can use numbers, symbols, and upper and lower case letters.
Keep the security code secret and in a safe place separate from your phone. If you forget the security code, and cannot recover it, your personal data is deleted before you can use the phone again. If you've set the number of times you can enter the wrong security code, your phone deletes your data and resets itself

back to original settings after the last try. If you haven't limited the number of times, your phone requires service before you can use it again.

- 3 Select **Autolock**, and define the length of time after which the phone is locked automatically.

Unlock your phone

- 1 Press the power key, and swipe from the outside of the screen onto the screen. You can swipe from any direction.
- 2 Enter the security code, and select **OK**.

Tip: You can also tap the screen twice, and swipe from the outside of the screen onto the screen.

Tip: When you update your phone software using the Nokia Software Updater PC app, the language of your on-screen keyboard is set back to the default language. If your security code includes characters that are not part of this on-screen keyboard, select , then swipe left or right across the keyboard to change the language of the on-screen keyboard to the one you used when creating the security code.

Tip: If you have defined a trusted person, if you ever forget your security code, you can send them the code in a text message. Select **Device lock** > **Trusted person** > **Select trusted person** and a contact from the list. If the trusted person's phone number changes in the contacts list, you need to change it manually

Phone lock settings

You can define a security code and set your phone to automatically lock itself when you're not using it.

Some services, such as Mail for Exchange, may require that you define a security code for your phone. Depending on administrator security requirements, also your phone lock settings may be changed, such as Autolock and Number of tries.

Select  and **Security** > **Device lock**, and from the following:

Autolock — Set the length of time before the phone locks automatically.

Security code — Change the security code. To use the phone lock, you need to define a security code.

Number of tries — Set a limit for incorrect security code attempts. After the limit is reached, the phone is reset to original settings and all user data is deleted.

Trusted person — Set one of your contacts as a trusted person. If you have defined a trusted person, if you ever forget your security code, you can send the code to the trusted person in a text message. After entering the incorrect security code, select **Recover**, and follow the displayed instructions.

Remote security features — Set up remote lock. If you lose your phone, you can remotely lock it or delete the data saved on it.

Hide private information from your notifications

Don't want to let other people see who has called you? When you have missed a call or received a message, a notification is displayed on the lock screen. You can define how much information is displayed.

Select  and **Notifications** > **Notifications**, and activate or deactivate **Hide private information**.

When Hide private information is activated, only the number of received messages and missed calls is displayed.

When Hide private information is not activated, when you have received a message or missed a call, the following information is displayed:

- The name of the person who has tried to call you
- The sender of the message you have received
- Part of the message content

Develop your own applications

You can create your own applications for the phone using an applicable software development kit (SDK).

You need to activate developer mode on the phone to be able to use it as a target for application development. Developer mode enables connectivity between the development host and the phone, and provides a few additional tools on the phone.

Activate developer mode

Select  and **Security** > **Developer mode**, and activate **Developer mode**.

It is recommended that you do not activate developer mode, unless you intend to develop applications for the phone. Activating developer mode does not expose the phone to security risks, but you may accidentally delete important system files.

For more information, go to developer.nokia.com.

Reset your phone

If your phone stops responding

Restart your phone. Press and hold the power key for at least 8 seconds. To switch your phone on again, press and hold the power key until the phone vibrates.

No content, such as contacts or messages, is deleted.

Restore original settings

If your phone is not working properly, you can reset some settings to their original values.

- 1 End all active calls and connections.
- 2 Select  and **Reset > Restore settings**.
- 3 If prompted, enter the security code.

After restoring the original settings, the phone switches off, and then on again. This may take longer than usual.

Restoring original settings does not affect personal data stored on your phone, such as:

- Contacts
- Calendar entries
- Documents, music, messages, or notes
- Internet bookmarks
- Accounts, security codes, or passwords

Prepare your phone for recycling

If you buy a new phone, or otherwise want to dispose of your phone, Nokia recommends that you recycle your phone. Beforehand, remove all personal info and content from your phone.

Remove all content and restore settings to the default values

- 1 Back up the content you want to keep to a compatible computer.
- 2 End all active connections and calls.
- 3 Select  and **Reset > Clear device**.
The process may take several minutes.
- 4 Your phone switches off. Wait until the spinning icon on the screen has disappeared, then switch your phone on again. Check carefully that all your personal content, such as contacts, photos, music, videos, notes, messages, mails, presentations, games, and other installed applications have been removed. Content and info stored on the SIM card is not removed.

Remember to remove your SIM card from the phone.

Battery

Prolong battery life

If it seems you're always looking for a charger, there are steps you can take to reduce the power consumption of your phone, and keep talking for longer.

102 Phone management

- Always charge the battery fully.
- When power saving mode is activated, the phone does not scan, or scans less often, for available WLAN networks, and closes connections when they are not used by any application.

Tip: To check the battery status, and activate power saving mode, select  and **Device > Battery**.

Close the applications you are not using

Tap and hold the Open applications view, and select **Close all**, or select  on the application you want to close.

Sounds and effects

- Mute unnecessary tones, such as touch screen tones.
- Use wired headphones, rather than the loudspeaker.
- Change the length of the time-out period after which the phone display switches off.

Set the length of the time-out period

Select  and **Device > Display > Display time-out**.

Decrease display brightness

Select , and drag the Brightness slider.

Activate a dark wallpaper

Select  and **Wallpaper**.

Network use

- If you are listening to music or otherwise using your phone, but do not want to make or receive calls, activate the flight mode.
- Use a WLAN connection to connect to the internet, rather than a packet data (GPRS or 3G) connection.
- If your phone is set to use both GSM and 3G networks (dual mode), the phone uses more power when searching for the 3G network.

Set your phone to use only the GSM network

Select  and **Mobile network > Network mode > GSM**.

Deactivate Bluetooth when not needed

Select  and **Bluetooth**.

Establish a packet data (3G or GPRS) connection only when needed

Select  and **Mobile network > Data roaming** and activate **Always ask**.

Tips**Access codes**

<p>PIN code (4-8 digits)</p>	<p>This protects your SIM card against unauthorised use or is required to access some features.</p> <p>You can set your phone to ask for the PIN code when you switch it on.</p> <p>If not supplied with your SIM card or you forget the code, contact your service provider.</p> <p>If you type in the code incorrectly three times in a row, you need to unblock the code with the PUK code.</p>
<p>PUK code (8 digits)</p>	<p>This is required to unblock a PIN code.</p> <p>If not supplied with your SIM card, contact your service provider.</p>
<p>IMEI number (15 digits)</p>	<p>This is used to identify valid phones in the network. The number can also be used to block, for example, stolen phones. You may also need to give the number to Nokia Care services.</p> <p>To view your IMEI number, dial *#06#.</p>
<p>Lock code (security code) (min. 5 digits or characters)</p>	<p>This helps you protect your phone against unauthorised use.</p> <p>You can set your phone to ask for the lock code that you define.</p> <p>Keep the code secret and in a safe place, separate from your phone.</p> <p>If you forget the security code, and cannot recover it, your personal data is deleted before you can use the phone again. If you've set the number of times you can type in the wrong security code, your phone deletes your data and resets itself back to original settings after the last try. If you haven't limited</p>

the number of times, your phone requires service before you can use it again.

For more information, contact Nokia Care or your phone dealer.

Send your security code to a trusted person

Want to protect your phone, but afraid you may forget your security code? Define a trusted person, and if you forget your security code, you can send the code to that trusted person.

Define your trusted person

Select  and **Security** > **Device lock** > **Trusted person** > **Select trusted person**, and select the desired contact.

If the phone number of your trusted person changes, you need to change it manually.

Recover the code

After entering the incorrect security code, select **Recover**, and follow the displayed instructions.

Protect the environment

Save energy

You do not need to charge your battery so often if you do the following:

- Close applications and data connections, such as your WLAN or Bluetooth connection, when not in use.
- Lower the brightness of the screen.
- Set your phone to enter power saving mode after the minimum period of inactivity.
- Switch off unnecessary sounds, such as touch screen tones.

Recycle



When this phone has reached the end of its working life, all of its materials can be recovered as materials and energy. To guarantee the correct disposal and reuse,

Nokia co-operates with its partners through a program called We:recycle. For information on how to recycle your old Nokia products and where to find collection sites, go to www.nokia.com/werecycle, or call the Nokia Care contact centre.

Recycle packaging and user guides at your local recycling scheme.



The crossed-out wheeled-bin symbol on your product, battery, literature, or packaging reminds you that all electrical and electronic products, batteries, and accumulators must be taken to separate collection at the end of their working life. This requirement applies in the European Union. Do not dispose of these products as unsorted municipal waste. For more information on the environmental attributes of your device, see www.nokia.com/ecodeclaration.

Product and safety information

Network services and costs

Your device is approved for use on the UMTS 850, 900, 1900, 1700/2100, 2100 MHz and GSM 850, 900, 1800, 1900 MHz networks. To use the device, you need a subscription with a service provider.

Using network services and downloading content to your device requires a network connection and may result in data traffic costs. Some product features require support from the network, and you may need to subscribe to them.

View information about your phone

To view type approval notices and detailed information about your phone's software and hardware, select  and About product.

Open source software notice

This product includes certain open source software.

The exact terms of the licences, disclaimers, acknowledgements, and notices are reproduced in the materials provided with this product. Nokia offers to provide you with the source code as defined in the applicable licence. Go to harmattan-dev.nokia.com, or send a mail to sourcecode.request@nokia.com or a written request to:

Source Code Requests

Nokia Corporation

P.O.Box 226

FI-00045 Nokia Group

Finland

This offer is valid for a period of three (3) years from the date of the distribution of this product by Nokia.

By submitting a request, you give your consent that Nokia (or third parties on behalf and under direct authority of Nokia) will process your personal data. The processing will be done for the purpose of the request and the undertakings related

106 Product and safety information

to it. The main reason for storing this data is to prove compliance with the license terms. The data processing will be done in compliance with Nokia guidelines and applicable legislation.

Take care of your device

Handle your device, battery, charger and accessories with care. The following suggestions help you protect your warranty coverage.

- Keep the device dry. Precipitation, humidity, and all types of liquids or moisture can contain minerals that corrode electronic circuits. If your device gets wet, allow the device to dry.
- Do not use or store the device in dusty or dirty areas. Moving parts and electronic components can be damaged.
- Do not store the device in high temperatures. High temperatures can shorten the life of the device, damage the battery, and warp or melt plastics.
- Do not store the device in cold temperatures. When the device warms to its normal temperature, moisture can form inside the device and damage electronic circuits.
- Do not attempt to open the device other than as instructed in the user guide.
- Unauthorised modifications may damage the device and violate regulations governing radio devices.
- Do not drop, knock, or shake the device. Rough handling can break internal circuit boards and mechanics.
- Only use a soft, clean, dry cloth to clean the surface of the device.
- Do not paint the device. Paint can clog moving parts and prevent proper operation.
- Keep your device away from magnets or magnetic fields.
- To keep your important data safe, store it in at least two separate places, such as your device, memory card, or computer, or write down important information.

During extended operation, the device may feel warm. In most cases, this is normal. If you suspect the device is not working properly, take it to the nearest authorised service facility.

Recycle

Always return your used electronic products, batteries, and packaging materials to dedicated collection points. This way you help prevent uncontrolled waste disposal and promote the recycling of materials. Check how to recycle your Nokia products at www.nokia.com/recycling.

Batteries and chargers

Battery and charger information

Your device has an internal, non-removable, rechargeable battery. Do not attempt to remove the battery, as you may damage the device. To replace the battery, take the device to the nearest authorised service facility.

This device is intended for use when supplied with power from the following chargers: AC-16. The exact Nokia charger model number may vary depending on the plug type, identified by E, X, AR, U, A, C, K, B, or N.

Third-party chargers that comply with the IEC/EN 62684 standard, and that can connect to your device micro USB connector, may be compatible.

The battery can be charged and discharged hundreds of times, but it will eventually wear out. When the talk and standby times are noticeably shorter than normal, to replace the battery, take the device to the nearest authorised service facility.

Battery safety

 **Note:** The battery in your device is non-removable, so refer to the battery-related statements as applicable to your device.

When you unplug a charger or an accessory, hold and pull the plug, not the cord.

When your charger is not in use, unplug it from the electrical plug and the device. Do not leave a fully charged battery connected to a charger, as overcharging may shorten the battery's lifetime. If left unused, a fully charged battery will lose its charge over time.

Always keep the battery between 15°C and 25°C (59°F and 77°F). Extreme temperatures reduce the capacity and lifetime of the battery. A device with a hot or cold battery may not work temporarily.

Accidental short-circuiting can happen when a metallic object touches the metal strips on the battery. Short-circuiting may damage the battery or the connecting object.

Do not dispose of batteries in a fire as they may explode. Dispose of batteries according to local regulations. Recycle when possible. Do not dispose as household waste.



Do not dismantle, cut, open, crush, bend, puncture, or shred cells or batteries. If a battery leaks, do not let battery liquid touch skin or eyes. If this happens, immediately flush the affected areas with water, or seek medical help.

Do not modify, remanufacture, attempt to insert foreign objects into the battery, or immerse or expose it to water or other liquids. Batteries may explode if damaged.

Use the battery and charger for their intended purposes only. Improper use, or use of unapproved batteries or incompatible chargers may present a risk of fire, explosion, or other hazard, and may invalidate any approval or warranty. If you believe the battery or charger is damaged, take it to a service centre for inspection before continuing to use it. Never use a damaged battery or charger. Only use the charger indoors.

Additional safety information

Make an emergency call

- 1 Make sure the phone is switched on.
- 2 Check for adequate signal strength. You may also need to do the following:
 - Insert a SIM card.
 - Make sure flight mode is not activated.
 - If the phone screen and keys are locked, unlock them.
- 3 Go to the Applications view, and select  and .
- 4 Enter the official emergency number for your present location. Emergency call numbers vary by location.
- 5 Select  to start the call.
- 6 Give the necessary information as accurately as possible. Do not end the call until given permission to do so.

Make an emergency call without entering PIN, PUK, or security code

- 1 When the phone asks for the code, select .
- 2 Enter the emergency number for your present location.
- 3 Select Call to start the call. After the emergency call, you need to enter the required PIN, PUK, or security code to be able to use other phone functions.

When you switch your phone on for the first time, you are asked to create your Nokia account. To make an emergency call during the account setup, select .

 **Important:** Emergency calls can be made using the cellular phone. It is not possible to make an emergency call using voice calls over the internet (internet calls). Connections in all conditions cannot be guaranteed. Never rely solely on any wireless device for essential communications like medical emergencies.

108 Product and safety information

Small children

Your device and its accessories are not toys. They may contain small parts. Keep them out of the reach of small children.

Medical devices

Operation of radio transmitting equipment, including wireless phones, may interfere with the function of inadequately protected medical devices. Consult a physician or the manufacturer of the medical device to determine whether they are adequately shielded from external radio frequency energy.

Implanted medical devices

Manufacturers of medical devices recommend a minimum separation of 15.3 centimetres (6 inches) between a wireless device and an implanted medical device, such as a pacemaker or implanted cardioverter defibrillator, to avoid potential interference with the medical device. Persons who have such devices should:

- Always keep the wireless device more than 15.3 centimetres (6 inches) from the medical device.
- Not carry the wireless device in a breast pocket.
- Hold the wireless device to the ear opposite the medical device.
- Turn the wireless device off if there is any reason to suspect that interference is taking place.
- Follow the manufacturer directions for the implanted medical device.

If you have any questions about using your wireless device with an implanted medical device, consult your health care provider.

Hearing



Warning:

When you use the headset, your ability to hear outside sounds may be affected. Do not use the headset where it can endanger your safety.

Some wireless devices may interfere with some hearing aids.

Nickel



Note: The surface of this device does not contain nickel in the platings. The surface of this device contains stainless steel.

Protect your device from harmful content

Your device may be exposed to viruses and other harmful content. Take the following precautions:

- Be cautious when opening messages. They may contain malicious software or otherwise be harmful to your device or computer.
- Be cautious when accepting connectivity requests, browsing the internet, or downloading content. Do not accept Bluetooth connections from sources you do not trust.
- Only install and use applications and other software from sources that you trust. Applications from untrusted sources may include malicious software that can access data stored in your device, cause financial harm, or damage your device.
- Install antivirus and other security software on your device and any connected computer. Only use one antivirus application at a time. Using more may affect performance and operation of the device and/or computer.
- If you access preinstalled bookmarks and links to third party internet sites, take the appropriate precautions. Nokia does not endorse or assume liability for such sites.

Operating environment

This device meets radio frequency exposure guidelines in the normal use position at the ear or at least 1.5 centimetres (5/8 inch) away from the body. Any carry case, belt clip, or holder for body-worn operation should not contain metal and should position the device the above-stated distance from your body.

To send data files or messages requires a quality connection to the network. Data files or messages may be delayed until such a connection is available. Follow the separation distance instructions until the transmission is completed.

Parts of the device are magnetic. Metallic materials may be attracted to the device. Do not place credit cards or other magnetic storage media near the device, because information stored on them may be erased.

Vehicles

Radio signals may affect improperly installed or inadequately shielded electronic systems in motor vehicles such as electronic fuel injection, electronic antilock braking, electronic speed control, and air bag systems. For more information, check with the manufacturer of your vehicle or its equipment.

Only qualified personnel should install the device in a vehicle. Faulty installation or service may be dangerous and may invalidate your warranty. Check regularly that all wireless device equipment in your vehicle is mounted and operating properly. Do not store or carry flammable liquids, gases, or explosive materials in the same compartment as the device, its parts, or accessories. Remember that air bags inflate with great force. Do not place your device or accessories in the air bag deployment area.

Potentially explosive environments

Switch off your device in any area with a potentially explosive atmosphere, for example near gas pumps at service stations. Sparks in such areas could cause an explosion or fire resulting in bodily injury or death. Observe restrictions in fuel service stations, storage, and distribution areas; chemical plants; or where blasting operations are in progress. Areas with a potentially explosive atmosphere are often, but not always, clearly marked. They include areas where you would be advised to turn off your vehicle engine, below deck on boats, chemical transfer or storage facilities and where the air contains chemicals or particles such as grain, dust, or metal powders. You should check with the manufacturers of vehicles using liquefied petroleum gas (such as propane or butane) to determine if this device can be safely used in their vicinity.

Certification information (SAR)

This mobile device meets guidelines for exposure to radio waves.

Your mobile device is a radio transmitter and receiver. It is designed not to exceed the limits for exposure to radio waves recommended by international guidelines. These guidelines were developed by the independent scientific organisation ICNIRP and include safety margins designed to assure the protection of all persons, regardless of age and health.

The exposure guidelines for mobile devices employ a unit of measurement known as the Specific Absorption Rate or SAR. The SAR limit stated in the ICNIRP guidelines is 2.0 watts/kilogram (W/kg) averaged over 10 grams of tissue. Tests for SAR are conducted using standard operating positions with the device transmitting at its highest certified power level in all tested frequency bands. The actual SAR level of an operating device can be below the maximum value because the device is designed to use only the power required to reach the network. That amount changes depending on a number of factors such as how close you are to a network base station.

The highest SAR value under the ICNIRP guidelines for use of the device at the ear is 1.16 W/kg.

Use of device accessories may result in different SAR values. SAR values may vary depending on national reporting and testing requirements and the network band. Additional SAR information may be provided under product information at www.nokia.com.

Copyright and other notices

DECLARATION OF CONFORMITY

CE 0434 ⓘ

Hereby, NOKIA CORPORATION declares that this RM-696 product is in compliance with the essential requirements and other relevant provisions of Directive 1999/5/EC. A copy of the Declaration of Conformity can be found at <http://www.nokia.com/global/declaration>.

© 2012 Nokia. All rights reserved.

Nokia, Nokia Connecting People, Nokia Original Accessories, and Nseries are trademarks or registered trademarks of Nokia Corporation. Nokia tune is a sound mark of Nokia Corporation. Other product and company names mentioned herein may be trademarks or tradenames of their respective owners.

Reproduction, transfer, distribution, or storage of part or all of the contents in this document in any form without the prior written permission of Nokia is prohibited. Nokia operates a policy of continuous development. Nokia reserves the right to make changes and improvements to any of the products described in this document without prior notice.

When using this device, obey all laws and respect local customs, privacy and legitimate rights of others, including copyrights. Copyright protection may prevent you from copying, modifying, or transferring images, music, and other content.

Manufactured under license from Dolby Laboratories.

Dolby and the double-D symbol are trademarks of Dolby Laboratories.

The Bluetooth word mark and logos are owned by the Bluetooth SIG, Inc. and any use of such marks by Nokia is under license.

This product is licensed under the MPEG-4 Visual Patent Portfolio License (i) for personal and noncommercial use in connection with information which has been encoded in compliance with the MPEG-4 Visual Standard by a consumer engaged in a personal and noncommercial activity and (ii) for use in connection with MPEG-4 video provided by a licensed video provider. No license is granted or shall be implied for any other use. Additional information, including that related to promotional, internal, and commercial uses, may be obtained from MPEG LA, LLC. See <http://www.mpegla.com>.

To the maximum extent permitted by applicable law, under no circumstances shall Nokia or any of its licensors be responsible for any loss of data or income or any special, incidental, consequential or indirect damages howsoever caused.

The contents of this document are provided "as is". Except as required by applicable law, no warranties of any kind, either express or implied, including, but not limited to, the implied warranties of merchantability and fitness for a particular purpose, are made in relation to the accuracy, reliability or contents of this document. Nokia reserves the right to revise this document or withdraw it at any time without prior notice.

Reverse engineering of software in the device is prohibited to the extent permitted by applicable law. Insofar as this user guide contains any limitations on Nokia's representations, warranties, damages and liabilities, such limitations shall likewise limit any representations, warranties, damages and liabilities of Nokia's licensors.

The availability of products, features, applications and services may vary by region. For more information, contact your Nokia dealer or your service provider. This device may contain commodities, technology or software subject to export laws and regulations from the US and other countries. Diversion contrary to law is prohibited.

Nokia does not provide a warranty for or take any responsibility for the functionality, content, or end-user support of third-party applications provided with your device. By using an application, you acknowledge that the application is provided as is. Nokia does not make any representations, provide a warranty, or take any responsibility for the functionality, content, or end-user support of third-party applications provided with your device.

The availability of Nokia services may vary by region.

FCC NOTICE

Your device may cause TV or radio interference (for example, when using a telephone in close proximity to receiving equipment). The FCC can require you to stop using your telephone if such interference cannot be eliminated. If you require assistance, contact your local service facility. This device complies with part 15 of the FCC rules. Operation is subject to the following two conditions: (1) This device may not cause harmful interference, and (2) this device must accept any interference received, including interference that may cause undesired operation. Any changes or modifications not expressly approved by Nokia could void the user's authority to operate this equipment.

The FCC ID is printed inside the SIM card slot. To view the ID, remove the SIM card holder.

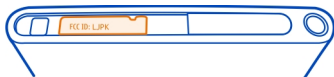

Some operations and features are SIM card and/or network dependent, MMS dependent, or dependent on the compatibility of devices and the content formats supported. Some services are subject to a separate charge.

/Issue 1.2 EN

Index

A

A-GPS (assisted GPS)	76
access codes	103
accounts	55, 58, 97
alarm clock	88, 89
antennas	8
applications	16, 18, 95, 96
— developing	100
availability	47
availability status	55

B

backing up content	94
battery	11, 106
— charging	9, 10
— saving power	101
blogs	42
Bluetooth	38, 39
bookmarks	42
browser	
See <i>web browser</i>	

C

cable connection	40
calculator	92
calendar	89, 90, 91
call waiting	52
calls	47, 49, 51, 53
— answering	49
— conference	48
— dismissing	49
— diverting	50
— emergency	107
— forwarding	50
— internet calls	53, 54
— last dialled	53
— log	52
— making	48

— rejecting	49
camera	65
— location info	68
— recording videos	69
— sending photos	69
— sending videos	69
— sharing pictures	70
— sharing videos	70
— taking photos	66, 67, 68
charging the battery	9, 10, 106
chat services (IM)	56, 58
clock	88, 89
connectivity	33
contacts	43, 47
— adding	43
— copying	13, 45
— editing	43
— favourites	44
— groups	45, 46
— in social networks	46
— photos	44
— ringtones	45
— saving	43
— synchronising	97, 98
copying content	12, 14, 97

D

data connections	32, 33
— Bluetooth	38
— costs	33
— packet data	33
— WLAN	33
date and time	89
device lock	22, 98
diverting calls	50
DLNA (Digital Living Network Alliance)	35, 63, 73, 75
Dolby™	65
Drive	
— changing views	87
— favourites	88

— map view	86, 87
— navigating	85, 87
— planning routes	86
— routes	85
— saving places	87
— synchronising	88
— voice guidance	86

E

e-mail	58
See <i>mail</i>	
emergency calls	107
environmental tips	104
event	90

F

factory settings, restoring	101
favourites	44
feeds, news	42
file management	94
flight mode	28
forwarding calls	50

G

Gallery	71
GPS (global positioning system)	76, 77

H

headphones	65
headset	7, 38, 65
help	15
home screen	15

I

icons	19
IM (instant messaging)	56, 58
IMEI number	103
inbox, messages	57
indicators	19
installing applications	95
internet	

 See *web browser*

internet calls	53, 54
internet connection	32

K

keyboard	24, 26
keyguard	12
keys and parts	6, 7

L

language settings	58
location info	68
location information	76, 91
lock code	22, 23, 98, 99, 103, 104
locking	
— device	23, 99
— keys	12
— phone	22, 23, 98, 99, 104
— screen	12
log	52
loudspeaker	28, 51

M

mail	58, 60, 61
— attachments	59
— creating	59
— mailbox	58
— reading and replying to	59
— sending	59
— setup	58
— threads	60
Mail for Exchange	60, 61
mailbox	
— voice	51
Maps	78
— changing views	80
— compass	84
— current location	78
— downloading maps	81
— feedback	84
— finding locations	82

— guidance	80
— map view	78, 80
— navigating	83
— offline	81
— positioning	76
— saved places	82, 83
— saving places	82
— sharing locations	83
— walking routes	83
meeting requests	61
memory	101
— clearing	97
menu	18
messages	56, 57
— sending	57
MMS (multimedia message service)	57
mobile data connection	33
movies	75
multimedia messages	56, 57
multitasking	16
music	30, 61, 62, 63
— playlists	62

N

news feeds	42
NFC	35
NFC (Near Field Communication)	36, 37
noise cancellation	51
Nokia account	30
Nokia Link	14
Nokia Maps	30
Nokia services	29, 30
Nokia Store	30
Nokia support information	15
notes	93
notifications	100

O

office applications	92
on-screen keyboard	24, 26

P

personalising your device	31
personalising your phone	31
phone	
— rebooting	100
— setup	12
— switching on/off	11, 100
phone lock	22, 98
phonebook	
— See <i>contacts</i>	
Photo editor	74
photos	
— editing	74
— location info	68
— organising	72
— sending	69
— sync	40
— tagging	73
— taking	66, 67, 68
— viewing	71, 73, 75
— viewing on a TV	73, 75
pictures	
— sending	39
— sharing	70
PIN codes	103
playlists	62
positioning information	76
powering on/off	11
powering phone on/off	100
profiles	28, 29
PUK codes	103

Q

quick launch bar	17
------------------	----

R

rebooting	100
recording	
— videos	69
recycling	104
restoring content	96

restoring settings	101	transferring content	12, 13, 14, 40, 63, 64, 97
ringing tones	50	turning on/off	11
ringtones	45	turning phone on/off	100
S			
searching	29	TV	
security code	22, 23, 98, 99, 103, 104	— viewing photos	73
settings		U	
— access points	32	updates	
— language	58	— applications	94
— restoring	101	— apps	93
sharing, online	70	— phone software	93, 94
shortcuts	31	USB charging	10
silent profile	29	USB connection	40
SIM card	8, 45	user guide	15
SMS (short message service)	57	V	
social networks	46	video	
software	94	— editing	75
software updates	93, 94	videos	64
speakerphone	28	— downloading	64
status menu	17	— location info	68
status updates	46	— organising	72
support	15	— playing	64
switching on/off	11	— recording	69
switching phone on/off	100	— sending	39, 69
Swipe	26	— sharing	70
sync	40, 63, 64	— streaming	64
synchronisation	97, 98	— sync	40, 64
T			
tags	72, 73	— watching	64, 71, 73, 75
taking photos		— watching on a TV	73, 75
<i>See camera</i>		virtual keyboard	24, 26
tasks	90	voice calls	
technical information	105	<i>See calls</i>	
text input	24, 26	volume control	28
text messages	56, 57	W	
time and date	89	wallpaper	31
touch screen	20, 24, 26	web browser	40, 41
transfer		— bookmarks	42
— content	98	web connection	32

web feeds 42

WLAN (wireless local area network) 34, 35