

# Nokia 6265 User's Guide

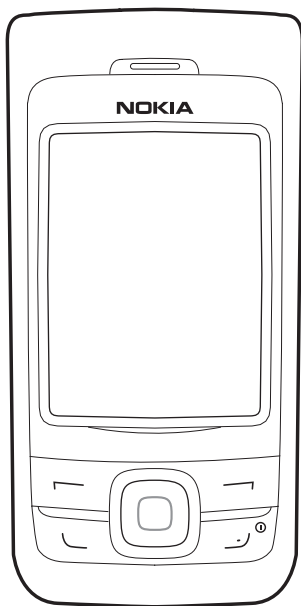

## LEGAL INFORMATION

Copyright ©2005 Nokia. All rights reserved.

Nokia, Nokia Connecting People, Nokia 6265, Pop-Port, and the Nokia Original Enhancements logos are trademarks or registered trademarks of Nokia Corporation. Other company and product names mentioned herein may be trademarks or trade names of their respective owners.



Bluetooth wireless technology is a registered trademark of Bluetooth SIG, Inc.



miniSD is a registered trademark of the SD Card Association.



Includes RSA BSAFE cryptographic or security protocol software from RSA Security.



Java is a trademark of Sun Microsystems, Inc.

The information contained in this user guide was written for the Nokia 6265 product. Nokia operates a policy of ongoing development. Nokia reserves the right to make changes to any of the products described in this document without prior notice.

UNDER NO CIRCUMSTANCES SHALL NOKIA BE RESPONSIBLE FOR ANY LOSS OF DATA OR INCOME OR ANY SPECIAL, INCIDENTAL, AND CONSEQUENTIAL OR INDIRECT DAMAGES HOWSOEVER CAUSED. THE CONTENTS OF THIS DOCUMENT ARE PROVIDED "AS IS." EXCEPT AS REQUIRED BY APPLICABLE LAW, NO WARRANTIES OF ANY KIND, EITHER EXPRESS OR IMPLIED, INCLUDING, BUT NOT LIMITED TO, THE IMPLIED WARRANTIES OF MERCHANTABILITY AND FITNESS FOR A PARTICULAR PURPOSE, ARE MADE IN RELATION TO THE ACCURACY AND RELIABILITY OR CONTENTS OF THIS DOCUMENT. NOKIA RESERVES THE RIGHT TO REVISE THIS DOCUMENT OR WITHDRAW IT AT ANY TIME WITHOUT PRIOR NOTICE.

**EXPORT CONTROLS** This device may contain commodities, technology, or software subject to export laws and regulations from the U.S. and other countries. Diversion contrary to law is prohibited.

# Contents

|                                   |      |                                    |    |
|-----------------------------------|------|------------------------------------|----|
| <b>For your safety</b> .....      | viii | Make calls.....                    | 9  |
| About your device .....           | ix   | Using the keypad.....              | 9  |
| Network Services .....            | ix   | Use the save contact option.....   | 9  |
| Shared memory.....                | x    | Use the contacts list .....        | 9  |
|                                   |      | Use the last dialled number.....   | 10 |
| <b>Welcome</b> .....              | xi   | Make a conference call .....       | 10 |
| Getting help .....                | xi   | Answer calls.....                  | 10 |
| Find your phone label .....       | xi   | Answer or silence an incoming      |    |
| Nokia support and contact         |      | call.....                          | 10 |
| information.....                  | xii  | Adjust the earpiece volume .....   | 10 |
|                                   |      | Answer a call with the keypad      |    |
| <b>1. Phone at a glance</b> ..... | 1    | locked .....                       | 10 |
| Keys and parts .....              | 1    | Use the loudspeaker.....           | 11 |
| Standby mode.....                 | 2    | Mute phone during call.....        | 11 |
| Quick keys.....                   | 2    | Options during a call.....         | 11 |
| Indicators and icons .....        | 2    | Keyguard .....                     | 11 |
| Phone menus .....                 | 3    |                                    |    |
| Scroll method.....                | 3    | <b>3. Text entry</b> .....         | 13 |
| Main menu display.....            | 4    | Standard mode.....                 | 13 |
| In-phone help.....                | 4    | Text (Abc) .....                   | 13 |
| Security functions .....          | 4    | Numbers (123) .....                | 13 |
| Go to functions.....              | 5    | Change language .....              | 13 |
| Select options .....              | 5    | Punctuation and special            |    |
| Organise functions.....           | 5    | characters.....                    | 14 |
|                                   |      | Predictive text mode .....         | 14 |
| <b>2. Set up your phone</b> ..... | 6    | Activate and deactivate .....      | 14 |
| Antenna .....                     | 6    | Enter text .....                   | 14 |
| Battery.....                      | 6    | Change case and mode.....          | 15 |
| Remove the back cover .....       | 6    | Delete text.....                   | 15 |
| Remove the battery.....           | 7    |                                    |    |
| UIM (CDMA SIM) card slot.....     | 7    | <b>4. Messaging</b> .....          | 16 |
| Replace the battery .....         | 7    | Text messages.....                 | 16 |
| Replace the back cover .....      | 7    | Text message folders and options   | 16 |
| Charge the battery.....           | 7    | Write and send text messages ..... | 17 |
| MiniSD card.....                  | 8    | Use a template.....                | 18 |
| Turn your phone on or off.....    | 8    | Read and reply to text messages.   | 18 |
| Connect the headset .....         | 8    | Choose a text message option ..... | 18 |
|                                   |      | Use custom folders.....            | 19 |
|                                   |      | Delete text messages.....          | 20 |

|   |           |                                 |           |
|---|-----------|---------------------------------|-----------|
| Text message settings .....                 | 20        | Save other details.....         | 36        |
| Multimedia messages .....                   | 21        | Change default number.....      | 36        |
| Multimedia message folders and options..... | 22        | Send business cards.....        | 36        |
| Write and send multimedia messages.....     | 22        | Edit contacts .....             | 37        |
| Read and reply to multimedia messages.....  | 23        | Modify contact settings.....    | 38        |
| Choose a multimedia message option.....     | 24        | Set up caller groups .....      | 38        |
| Delete multimedia messages.....             | 26        | Set up a caller group.....      | 38        |
| Multimedia message settings .....           | 27        | Modify a caller group .....     | 38        |
| Distribution lists .....                    | 28        | Set up voice tags.....          | 38        |
| Create distribution lists .....             | 28        | Assign a voice tag .....        | 39        |
| Add and remove contacts .....               | 28        | Use a voice tag.....            | 39        |
| Use distribution lists.....                 | 28        | Play back a voice tag.....      | 39        |
| Voice messages.....                         | 29        | Modify a voice tag .....        | 39        |
| Save voice mailbox number.....              | 29        | Delete a voice tag .....        | 40        |
| Call and set up your voice mail... ..       | 29        | Set up speed dial.....          | 40        |
| Listen to your voice mail .....             | 29        | Assign a key to speed dial..... | 40        |
| Automate voice mail .....                   | 29        | Change speed dial numbers ..... | 40        |
| Minibrowser messages .....                  | 30        | Delete speed dial numbers.....  | 40        |
|   |           | Display phone number.....       | 40        |
|   |           | Delete contacts.....            | 41        |
|   |           | Delete individual contacts..... | 41        |
|   |           | Delete all contacts .....       | 41        |
| <b>5. Log .....</b>                         | <b>31</b> | <b>7. Camera.....</b>           | <b>42</b> |
| View missed calls .....                     | 31        | Take a photo.....               | 42        |
| View received calls .....                   | 31        | Use the self-timer .....        | 43        |
| View dialled numbers.....                   | 31        | Take a sequence of photos.....  | 43        |
| Time of call .....                          | 31        | Record a video .....            | 44        |
| Clear log lists.....                        | 32        | Camera options .....            | 44        |
| Call duration.....                          | 32        | Modify camera settings .....    | 45        |
| Duration of data or fax calls.....          | 32        | Image quality.....              | 45        |
| Duration of minibrowser calls.....          | 33        | Image size.....                 | 45        |
|   |           | Video clip quality.....         | 45        |
| <b>6. Contacts .....</b>                    | <b>34</b> | Video clip length.....          | 45        |
| View contacts.....                          | 34        | Camera sounds.....              | 45        |
| Search contacts.....                        | 34        | Default title.....              | 46        |
| Add new contacts .....                      | 35        | Image storage.....              | 46        |
| Save a name and number .....                | 35        | Default mode .....              | 46        |
| Save a number (only).....                   | 35        |                                 |           |
| Save a contact.....                         | 35        |                                 |           |
| Insert dialling codes.....                  | 35        |                                 |           |
| Save multiple numbers .....                 | 36        |                                 |           |

|  |           |                                     |    |
|--|-----------|-------------------------------------|----|
| <b>8. Gallery .....</b>                    | <b>47</b> | End call when slide closed .....    | 60 |
| Open a folder .....                        | 47        | Calling card.....                   | 60 |
| Gallery options .....                      | 48        | International prefix .....          | 61 |
| <b>9. Media.....</b>                       | <b>49</b> | Data and fax calls .....            | 61 |
| Music player.....                          | 49        | Call summary .....                  | 62 |
| Play music tracks .....                    | 49        | Show call time on display .....     | 62 |
| Music player options.....                  | 50        | Ringing tone for no caller ID ..... | 62 |
| Radio .....                                | 51        | Phone .....                         | 62 |
| Play radio.....                            | 51        | Language settings.....              | 62 |
| Radio options .....                        | 52        | Automatic keyguard.....             | 62 |
| Voice recorder.....                        | 52        | Navigation key.....                 | 62 |
| Record speech or sound .....               | 52        | Memory status.....                  | 63 |
| Recording list .....                       | 53        | Security keyguard .....             | 63 |
| Change the storage folder.....             | 53        | DTMF tones.....                     | 63 |
| Equaliser .....                            | 53        | Start-up tone .....                 | 64 |
| Activate an equaliser set .....            | 53        | Help text activation .....          | 64 |
| Create a custom equaliser set.....         | 53        | Voice commands.....                 | 64 |
| <b>10. Settings.....</b>                   | <b>55</b> | Add a voice tag.....                | 64 |
| Profiles.....                              | 55        | Activate a voice command .....      | 65 |
| Activate a profile.....                    | 55        | Voice command options.....          | 65 |
| Personalise a profile .....                | 55        | Connectivity .....                  | 65 |
| Set a timed profile .....                  | 55        | Bluetooth connectivity.....         | 65 |
| Display.....                               | 56        | Infrared connectivity.....          | 68 |
| Standby mode settings.....                 | 56        | Data cable transfer.....            | 69 |
| Banner.....                                | 56        | Data and fax transfer.....          | 70 |
| Screen saver.....                          | 56        | Enhancement settings.....           | 70 |
| Sleep mode .....                           | 57        | Headset.....                        | 71 |
| Backlight time-out .....                   | 57        | Handsfree .....                     | 71 |
| Themes.....                                | 57        | Loopset.....                        | 71 |
| Tones .....                                | 57        | Charger .....                       | 71 |
| Time and date.....                         | 58        | Hearing aid .....                   | 71 |
| Clock.....                                 | 58        | Security .....                      | 72 |
| Date.....                                  | 58        | Phone lock.....                     | 72 |
| Set the auto-update of date and time ..... | 59        | Allowed number if lock active.....  | 72 |
| Call.....                                  | 59        | Change lock code.....               | 73 |
| Anykey answer .....                        | 59        | Call restrictions .....             | 74 |
| Automatic redial.....                      | 59        | Voice privacy .....                 | 74 |
| Speed dial .....                           | 59        | Application settings.....           | 74 |
| Answer when slide opened.....              | 60        | Network.....                        | 75 |
|  |           | Roaming options .....               | 75 |
|  |           | Mode.....                           | 75 |

|                                   |           |                                       |           |
|-----------------------------------|-----------|---------------------------------------|-----------|
| Network services.....             | 75        | Stopwatch.....                        | 86        |
| Store a feature code.....         | 75        | Measure split or lap time.....        | 86        |
| Restore factory settings.....     | 76        | Save a time.....                      | 87        |
| Phone details.....                | 76        | Stopwatch options.....                | 87        |
|                                   |           | Operation note.....                   | 87        |
| <b>11. Organiser.....</b>         | <b>77</b> | <b>12. Mobile web.....</b>            | <b>88</b> |
| Alarm clock.....                  | 77        | Mobile Internet access.....           | 88        |
| Set an alarm.....                 | 77        | Sign on to the mobile Internet.....   | 89        |
| Repeat alarm.....                 | 77        | Navigate the mobile Internet.....     | 89        |
| Set the alarm tone.....           | 77        | Phone keys.....                       | 89        |
| Set the snooze time-out.....      | 78        | Receive a call while online.....      | 89        |
| Turn an alarm off.....            | 78        | Make an emergency call while          |           |
| Calendar.....                     | 78        | online.....                           | 89        |
| Open calendar.....                | 78        | Clear the cache and disconnect..      | 90        |
| Calendar options.....             | 78        |                                       |           |
| Make a calendar note.....         | 79        | <b>13. Extras.....</b>                | <b>91</b> |
| View calendar notes (day view)... | 79        | Games.....                            | 91        |
| Options while viewing a day.....  | 80        | Select games.....                     | 91        |
| Send a calendar note.....         | 80        | Memory status.....                    | 91        |
| Receive a note in calendar format |           | Collection.....                       | 91        |
| (vCal).....                       | 80        | Select application.....               | 91        |
| Modify calendar settings.....     | 80        | Memory status.....                    | 91        |
| Notes.....                        | 81        | <b>14. PC connectivity.....</b>       | <b>92</b> |
| Open notes.....                   | 81        | PC data transfer.....                 | 92        |
| Make a note.....                  | 81        | Nokia PC Suite.....                   | 92        |
| Send a note.....                  | 82        |                                       |           |
| Notes options.....                | 82        | <b>15. Enhancements.....</b>          | <b>93</b> |
| To-do list.....                   | 82        |                                       |           |
| Open to-do list.....              | 82        | <b>16. Reference information.....</b> | <b>95</b> |
| Make a to-do list note.....       | 82        | Batteries and chargers.....           | 95        |
| Edit to-do list notes.....        | 83        | Nokia battery authentication          |           |
| View to-do list notes.....        | 83        | guidelines.....                       | 96        |
| Send a to-do list note.....       | 83        |                                       |           |
| To-do list options.....           | 84        | <b>17. Care and maintenance.....</b>  | <b>98</b> |
| Calculator.....                   | 84        |                                       |           |
| Use calculator.....               | 84        |                                       |           |
| Currency converter.....           | 85        |                                       |           |
| Countdown timer.....              | 85        |                                       |           |
| Set the normal timer.....         | 85        |                                       |           |
| Change the timer.....             | 86        |                                       |           |
| Stop the timer before the alarm   |           |                                       |           |
| sounds.....                       | 86        |                                       |           |

## 18. Additional safety information 99

Operating environment..... 99

Medical devices..... 99

Vehicles ..... 100

Potentially explosive  
environments ..... 100

Emergency calls ..... 101

Certification information (SAR)..... 101

Index ..... 103

# For your safety

Read these simple guidelines. Not following them may be dangerous or illegal. Read the complete user guide for further information.



## SWITCH ON SAFELY

Do not switch the device on when wireless phone use is prohibited or when it may cause interference or danger.



## ROAD SAFETY COMES FIRST

Obey all local laws. Always keep your hands free to operate the vehicle while driving. Your first consideration while driving should be road safety.



## INTERFERENCE

All wireless phones may be susceptible to interference, which could affect performance.



## SWITCH OFF IN HOSPITALS

Follow any restrictions. Switch the device off near medical equipment.



## SWITCH OFF IN AIRCRAFT

Follow any restrictions. Wireless devices can cause interference in aircraft.



## SWITCH OFF WHEN REFUELLING

Don't use the device at a refuelling point. Don't use near fuel or chemicals.



## SWITCH OFF NEAR BLASTING

Follow any restrictions. Don't use the device where blasting is in progress.



## USE SENSIBLY

Use only in the normal position as explained in the product documentation. Don't touch the antenna unnecessarily.



## QUALIFIED SERVICE

Only qualified personnel may install or repair this product.



## ENHANCEMENTS AND BATTERIES

Use only approved enhancements and batteries. Do not connect incompatible products.



## WATER-RESISTANCE

Your phone is not water-resistant. Keep it dry.



## BACK-UP COPIES

Remember to make back-up copies or keep a written record of all important information.



## CONNECTING TO OTHER DEVICES

When connecting to any other device, read its user guide for detailed safety instructions. Do not connect incompatible products.



### EMERGENCY CALLS

Ensure the phone is switched on and in service. Press the end key as many times as needed to clear the display and return to standby mode. Enter the emergency number, then press the call key. Give your location. Do not end the call until given permission to do so.

## ■ About your device

The wireless device described in this guide is approved for use on the CDMA 800 and 1900, and AMPS 800 networks. Contact your service provider for more information about networks.

When using the features in this device, obey all laws and respect privacy and legitimate rights of others.

When taking and using images or video clips, obey all laws and respect local customs as well as privacy and legitimate rights of others.



**Warning:** To use any features in this device, other than the alarm clock, the device must be switched on. Do not switch the device on when wireless device use may cause interference or danger.

## ■ Network Services

To use the phone you must have service from a wireless service provider or network operator. Many of the features in this device depend on features in the wireless network to function. These network services may not be available on all networks or you may have to make specific arrangements with your service provider before you can utilise network services. Your service provider may need to give you additional instructions for their use and explain what charges will apply.

Some networks may have limitations that affect how you can use network services. For instance, some networks may not support all language-dependent characters and services.

Your service provider may have requested that certain features be disabled or not activated in your device. If so, they will not appear on your device menu. Your device may also have been specially configured. This configuration may include changes in menu names, menu order and icons. Contact your service provider for more information.

This device supports WAP 2.0 protocols (HTTP and SSL) that run on TCP/IP protocols. Some features of this device, such as *Mobile web* require network support for these technologies.

## ■ Shared memory

The following features in this device may share memory: *Messaging*, *Contacts*, *Gallery*, *Organiser*, and *Extras*. Use of one or more of these features may reduce the memory available for the remaining features sharing memory. For example, saving many photos to the *Gallery* may use all of the available memory. Your device may display a message that the memory is full when you try to use a shared memory feature. In this case, delete some of the information or entries stored in the shared memory features before continuing. Some of the features, such as *Messaging* and *Contacts*, may have a certain amount of memory specially allotted to them in addition to the memory shared with other features.

# Welcome

Congratulations on your purchase of the Nokia 6265 mobile phone. Your phone provides many functions which are practical for daily use, such as a hands-free loudspeaker, camera, MP3 player, video recorder, and more. Your phone can also connect to a PC, laptop, or other device using a USB data cable, Bluetooth wireless technology, or infrared.

## ■ Getting help

### Find your phone label

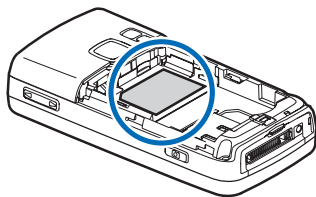

If you need help, Nokia Care Contact Centre is available for assistance. Before calling, we recommend that you write down the Electronic serial number (ESN) and have it available.

The ESN is found on the type label, which is located beneath the battery on the back of the phone. See "[Remove the back cover](#)", p. 6 and "[Remove the battery](#)", p. 7 for more information.

## Nokia support and contact information

For the latest version of this guide, downloads, services and additional information related to your Nokia product, please visit [www.nokia-asia.com/support](http://www.nokia-asia.com/support) or your local Nokia web site.

Should you still require assistance, please refer to [www.nokia-asia.com/contactus](http://www.nokia-asia.com/contactus).

To check for the nearest Nokia care center location for maintenance services, you may like to visit [www.nokia-asia.com/repair](http://www.nokia-asia.com/repair).

# 1. Phone at a glance

## Keys and parts

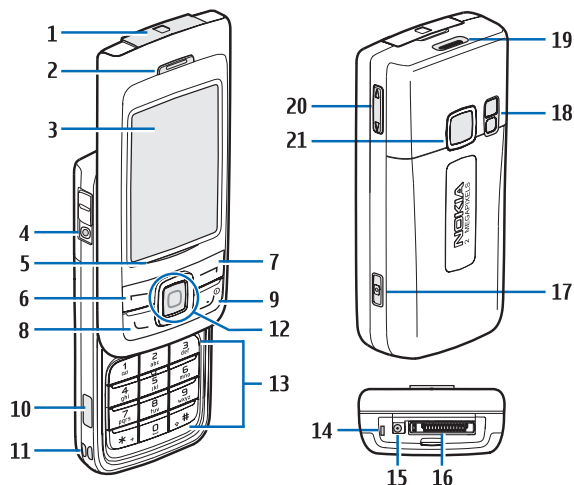

- miniSD card slot (1)
- Earpiece (2)
- Display (3)
- Headset connector (4)
- LED indicator (5)
- Left selection key (6)
- Right selection key (7)
- Call key (8)
- End and power key (9)
- Infrared (10)
- Strap holder (11)
- Center selection and scroll key (12)
- Keypad (13)
- Microphone (14)
- Charger port (15)
- Pop-Port™ connector (16)
- Camera key (17)
- Camera flash and self-portrait mirror (18)
- Loudspeaker (19)
- Volume key (20)
- Camera lens (21)

## ■ Standby mode

Depending on your wireless service provider or network operator and the model number of your phone, some or all of the following selection keys may appear in standby mode.

The standby mode indicates your phone is idle.

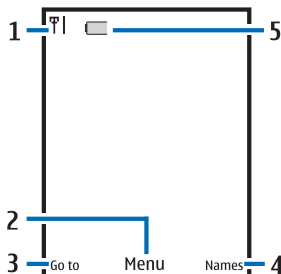

Signal strength (1)—More bars indicate a stronger network signal.

**Menu** (2)—Press the center selection key to select this option.

**Go to** (3)—Press the left selection key to select this option.

**Names** or network operator menu (4)—Press the right selection key to select this option.

Battery level (5)—A filled in battery indicates more power.

## ■ Quick keys

Depending on your wireless service provider or network operator and the model number of your phone, some or all of the following scroll key shortcuts may be available in standby mode.

In standby mode, the four-way scroll and center selection keys instantly take you to frequently-accessed menus:

Scroll up key—Go to the contacts list or network operator menu.

Scroll right key—View the calendar.

Scroll down key—Go to the contacts list.

Scroll left key—Create a text message.

Center selection key—Displays available applications or selects highlighted menus and submenus.

## ■ Indicators and icons

Depending on your wireless service provider or network operator and the model number of your phone, some or all of the following indicators and icons may appear on standby mode.

 You have one or more text or picture messages. See ["Read and reply to text messages"](#), p. 18.

 You have one or more voice messages. See ["Voice messages"](#), p. 29.

 Your phone keypad is locked. See ["Keyguard"](#), p. 11.

 Your phone is set to the silent profile. See "[Profiles](#)", p. 55.

 The alarm clock is on. See "[Alarm clock](#)", p. 77.





 The countdown timer is running. See "[Countdown timer](#)", p. 85.



 The stopwatch timing is running in the background. See "[Stopwatch](#)", p. 86.

 Integrated hands free or loudspeaker is active.

 The timed profile is selected. See "[Profiles](#)", p. 55.

 Phone can be connected to a Bluetooth wireless technology device. See "[Bluetooth connectivity](#)", p. 65.

    or   
An enhancement, such as headset, handsfree, hearing aid, TTY/TTD, or loopset is active or connected. See "[Enhancement settings](#)", p. 70.

 or  Voice privacy encryption is active or inactive in the network.

 Phone is roaming outside of your home network.

 Phone is in a digital network. See "[Network Services](#)", p. ix.

 Phone is in a 1XRTT network. See "[Network Services](#)", p. ix.

## Phone menus

Phone features are grouped according to function and are accessed through the main menus. Each main menu contains submenus and lists from which you can select or view items and personalise your phone features. You can access these menus and submenus by using the scroll method or by using a shortcut.



**Note:** Some features may not be available, depending on your network. For more information, contact your wireless provider.

## Scroll method

1. In standby mode, select **Menu** using the center selection key.



Scroll through the main menu using the scroll key.

On the right side of the screen, a scroll bar is displayed with a tab that moves up or down as you move through the menus. This provides a visual representation of your current position in the menu structure.

2. When you arrive at a menu, press **Select** (the center selection key) to enter submenus.

Select *Back* from the submenu level to return to the previous menu.

Press the end key to return to standby mode from any menu or submenu.

## Main menu display

You can control whether your phone main menu is displayed as a *List*, *Grid* or *Grid with labels*. By default, the main menu displays in *Grid with labels* format.

In standby mode, select *Menu > Options > Main menu view > List, Grid, or Grid with labels*.

If supported by your wireless service provider or network operator, you can also change the order of menus in your main menu.

In standby mode, select *Menu > Options > Organise*. Highlight a menu, select *Move*. Use the scroll key to move the menu to a new location, select *OK*. You can repeat this procedure to personalise your main menu.

Select *Done > Yes* to save the changes.

## In-phone help

Many features have brief descriptions (help text) that can be viewed on the display. To view these descriptions, scroll to a feature, and wait for about 15 seconds. Scroll down to view all of the description, or select *Back* to exit.

In order to view the descriptions, you must activate help text.

In standby mode, select *Menu > Settings > Phone > Help text activation > On or Off*.

## ■ Security functions

The security feature protects your device from unauthorised outgoing calls or denies access to the stored information with a lock or security code. The lock code is a four-digit number, while the security code is a five-digit number. By default, the security feature uses the lock code (defaulted to the last four digits of your phone number), instead of the security code to protect your phone.

You must enter your lock code to access the *Security* menu.

To access the *Security* menu, do the following:

1. In standby mode, select *Menu > Settings > Security*.
2. Enter the lock code, and select *OK*. See "*Security*", p. 72 for more information.



**Note:** Depending on your wireless service provider or network operator, the preset lock code may be 1234 or 0000 instead of the last four digits of your phone number. If none of these work, contact your wireless service provider or network operator for more help.

To enter the lock code to restore the factory settings, do the following:

1. In standby mode, select *Menu* > *Settings* > *Restore factory sett.*
2. Enter the lock code, and select *OK*.



**Note:** Depending on your wireless service provider or network operator, your phone may ask for the security code (defaulted to 12345) instead of the lock code.

## ■ Go to functions

The *Go to* menu allows you to change the function of the left selection key on your phone so that your most frequently used functions can be quickly accessed from the *Go to* menu in standby mode.

## Select options

1. In standby mode, select *Go to* > *Options* > *Select options*.
2. Scroll to the options you want to add.
3. Select *Mark* to add an option or *Unmark* to remove an option.
4. Select *Done* when you have added all desired options.
5. Select *Yes* to save the changes.
6. In standby mode, select *Go to* to display a list of the options that you selected in step 3.

## Organise functions

In standby mode, select *Go to* > *Options* > *Organise*. Highlight an option, and select *Move*. Scroll to move the option to a new location, and select *OK*. You can repeat this procedure to personalise your *Go to* menu.

Select *Done* > *Yes* to save the changes.

## 2. Set up your phone

### ■ Antenna

Your device has an internal antenna.

Hold the device as you would any other telephone with the antenna area pointed up and over your shoulder.



**Note:** As with any other radio transmitting device, do not touch the antenna unnecessarily when the device is switched on. Contact with the antenna affects call quality and may cause the device to operate at a higher power level than otherwise needed. Avoiding contact with the antenna area when operating the device optimises antenna performance and battery life.



Avoid touching electronic components while changing the covers.

Always store and use the device with the covers attached.

Prolonged, continuous use of your device may increase the device temperature. The increased temperature is a normal function of this product and does not pose a safety concern for you or the device. If the temperature is uncomfortable to you, use a headset or allow your device to return to room temperature before your next call.

### Remove the back cover

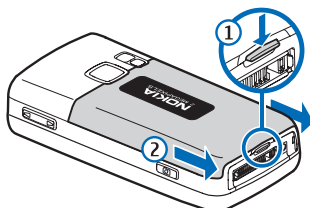

1. With the back of the phone facing you, press down and hold the back cover latch.
2. Slide the back cover toward the bottom of the phone, lift up and remove.

### ■ Battery

Always switch off the power and disconnect the charger before removing the battery.

## Remove the battery

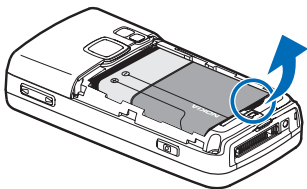

After you have removed the back cover, insert your finger into the finger grip, and lift the battery from its compartment.

## UIM (CDMA SIM) card slot

Your phone has a UIM card slot built into the mechanics. However, the UIM is not functional in this phone model. Avoid placing anything into the UIM card slot.

## Replace the battery

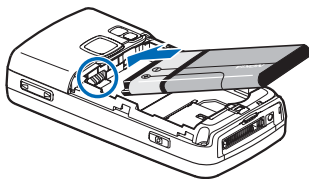

1. Insert the battery, gold-coloured contact end first, into the battery slot.
2. Push down on the other end of the battery to snap the battery into place.

## Replace the back cover

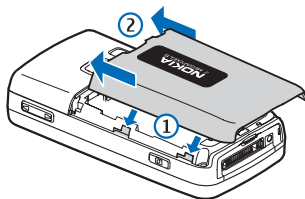

1. Set the back cover on the phone with the cover tabs aligned with the slots in the phone.
2. Press the back cover latch down and slide the back cover toward the top of phone.
3. Make sure back cover latch is secure.

## Charge the battery

1. Plug the charger transformer into a standard ac outlet.

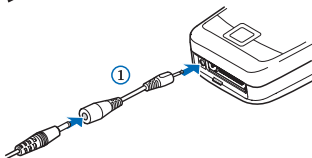
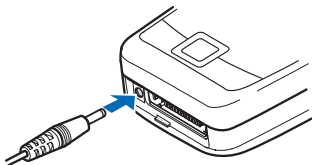

2. Insert the charger output plug into the round jack at the bottom end of the phone.

If necessary, you can use a CA-44 adapter cable (1) to connect a charger and the phone.

After a few seconds, the battery indicator in the display scrolls. If the battery is completely discharged, it may take a few minutes before the charging indicator appears on the display or before any calls can be made.

### ■ MiniSD card

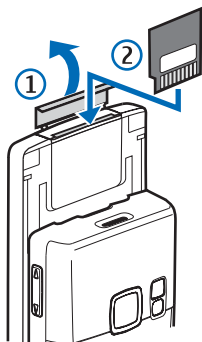

To insert the miniSD, complete the following steps.

1. Slide open the phone and lift open the miniSD slot cover.
2. Insert card firmly as shown in the illustration. The card clicks into place.

To remove the miniSD card, firmly press the card until it releases from the card slot and slides out.



**Important:** Do not remove the memory card while reading or writing to the card. Doing so may cause data corruption on the card or the phone.

### ■ Turn your phone on or off



1. To turn your phone on or off, press and hold the end key for at least 3 seconds.
2. Enter the lock code, if necessary, and select **OK**.

### ■ Connect the headset

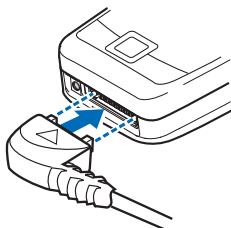

A compatible headset, such as HS-5, may be purchased with your phone or separately as an enhancement. See ["Enhancement settings"](#), p. 70 for information.

1. Plug the headset connector into the Pop-Port™ connector at the

bottom end of your phone.   
appears on the display.

2. Position the headset on your ear.

With the headset connected, you can make, answer, and end calls as usual.

- Use the keypad to enter numbers.
- Press the call key to place a call.
- Press the end key to end a call.

You can also plug a compatible headset, such as the HS-9 Universal Headset, into the 2.5 mm headset jack on the side of your phone to allow hands-free operation. See

"[Enhancement settings](#)", p. 70.



**Warning:** When you use the headset, your ability to hear outside sounds may be affected. Do not use the headset where it can endanger your safety.

## ■ Make calls

### Using the keypad

1. Enter the phone number, and press the call key. To delete a character to the left of the cursor, select *Clear*.
2. To end the call, press the end key. To cancel the call attempt, select *End call*.

### Use the save contact option

1. In standby mode, enter the phone number and select *Save*, enter a name for the contact, and select *OK*.
2. To make the call, press the call key. To return to standby mode, select *Done*.

### Use the contacts list

1. In standby mode, scroll down to display your contacts.
2. Scroll to the contact you wish to dial, press the call key. To view details of the entry, select *Details*.

## Use the last dialled number

1. In standby mode, press the call key to display the last 30 numbers dialled.
2. Scroll to the number or name you wish to redial, and press the call key.

## Make a conference call

This service is network dependent.

1. Make a call to the first participant.
2. With the first participant on the line, select *Options* > *New call*.
3. Enter the phone number of the second participant; or, to retrieve a number from your contacts, select *Search* and the number you want to call.
4. Press the call key. The first participant is put on hold.
5. When the second participant picks up, press the 3 key and then the call key to connect the calls.
6. To end the conference call, select *Options* > *End all calls*, or press the end key.

## ■ Answer calls

### Answer or silence an incoming call

1. To answer the call, press the call key or select *Answer*.
2. To reject the call, press the end key.

Select *Silence* to mute the ringing tone. Select *Dismiss* or do nothing, and the call is eventually forwarded to voice mail.

If your phone is set to *Silent* in the *Profiles* menu, select *Dismiss*, and the call is forwarded to voice mail.

## Adjust the earpiece volume

Press the up arrow or down arrow on the volume key located on the right side of your phone to adjust the volume of the earpiece.

When adjusting the volume, a bar chart appears in the display indicating the volume level.

## Answer a call with the keypad locked

To answer a call with the keypad locked, simply press the call key.

During the call, all features function as normal. When you end or reject the call, the keypad automatically relocks.

See "*Keyguard*", p. 11 for details.

When the device is locked, calls may be possible to the official emergency number programmed into your device.

## Use the loudspeaker



**Warning:** Do not hold the device near your ear when the loudspeaker is in use because the volume may be extremely loud.

You can use your phone loudspeaker during a call:

- To activate the loudspeaker, select *Loudsp.*
- To deactivate the loudspeaker, select *Handset*.

The loudspeaker is deactivated automatically when a call or a call attempt ends or when certain enhancements are connected.

## Mute phone during call

To mute your phone during a call, select *Mute*; to unmute the phone, select *Unmute*.

## Options during a call

Many of the options that you can use during a call, are network services. Check with your wireless service provider or network operator for more information.

During a call, select *Options* and one of the following:

*Loudspeaker* or *Handset*—Activate or deactivate the loudspeaker while in a call.

*New call*—Initiate a conference call. See "Make a conference call", p. 10 for information.

*Save*—Save a number entered during a call.

*Add to contact*—Add a number entered during a call to a contact in your list.

*End all calls*—Disconnect from all active calls.

*DTMF tones*—Enter the numbers, and select *Tones* to send the numbers as tones.

*Contacts*—View the contacts list.

*Menu*—View the phone menu.

## ■ Keyguard

With keyguard, you can lock the keypad to prevent keys from being pressed accidentally. Remember to lock your phone keypad to prevent accidental calls. If the keypad is locked, it unlocks when you receive a call. After the call, the lock automatically reactivates.

When the keyguard is on, calls may be possible to the official emergency number programmed into your device.

When the phone slide is open:

- To unlock the keypad, select *Unlock*, and press \* within 2 seconds.
- To lock the keypad, select *Menu*, and press \* within 2 seconds.

When the phone slide is closed:

- To unlock the keypad, open the slide or select *Unlock > OK*.
- To lock the keypad, select *Menu*, and press \* within 2 seconds.

### 3. Text entry

You can use two methods for entering text and numbers: standard mode and predictive text mode.

#### ■ Standard mode

Standard mode is the only way to enter text into the contacts list, and to rename caller groups.

#### Text (Abc)

- Press a key once to insert the first letter on the key, twice for the second letter, etc. If you pause briefly, the last letter in the display is accepted and your phone awaits the next entry.
- Press 0 to enter a space, thereby accepting a completed word.
- Press 1 as many times as necessary to scroll through a list of commonly used characters.
- Press \* to display a complete list of special characters.
- Press and hold # to open *Editor settings* > *Number mode*, *Dictionary on* or *Dictionary off*, or *Writing language*.

#### Numbers (123)

To switch to 123 mode from Abc mode, press and hold # at any message entry screen to bring up the *Editor settings* menu list of *Number mode*, *Dictionary on* or *Dictionary off*, and *Writing language*. Select *Number mode*, and the device returns to the message entry screen and switches the ABC icon in the upper left corner of the display to the 123 icon (or back). To return to Abc mode, press and hold #.

#### Change language

To change the language, do the following:

1. Press and hold #.
2. At the *Editor settings* menu list, select *Writing language*, and the new language.

The phone will return to the message entry screen, and you can compose in the new language.

## Punctuation and special characters

While at any text entry screen, press \* to display special characters (press and hold \* if predictive text is on). Press \* again to cycle through all available characters. Scroll to navigate through the list of special characters. Once a character is highlighted, select *Use* to insert the character into your message.

## Predictive text mode

Predictive text input allows you to write messages quickly using your keypad and the built-in dictionary. It is much faster than the standard mode method, because for each letter, you only press the corresponding key on your keypad once.

## Activate and deactivate

At any text entry screen, select and hold *Options* to turn predictive text on or off depending on previous mode; or, select *Options* > *Dictionary on* or *Dictionary off*. Press # twice to change from predictive text mode to standard mode and back.

## Enter text

The illustration below simulates your display each time a key is pressed. For example, to write Nokia with predictive text on and with the English dictionary selected, press each of the following keys once:

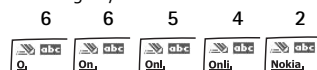

- Press 0 to enter a space and begin writing the next word.
- If a displayed word is not correct, press \* to see other matches. To return to the previous word in the list of matches, select *Previous*.
- If ? appears after a word, it is not in the dictionary. Select *Spell* to add the word to the dictionary.
- Press 1 to insert a period into your message.
- Press and hold \* to display special characters. Press \* again to cycle through all available characters.
- Press and hold the specific number key to enter a number.
- Press and hold # to bring up the *Editor settings* menu list of *Number mode*, *Dictionary on* or *Dictionary off*, and *Writing language*.

## ■ Change case and mode

Press # to switch between uppercase, lowercase, and sentence case, as well as standard and predictive text modes. Case and mode are indicated by the following icons that appear in the upper centre of the display screen.



Uppercase text: standard mode is on.



Lowercase text: standard mode is on.



Sentence case text: standard mode is on. Only available at the beginning of a sentence.



Uppercase text: predictive text is on.



Lowercase text: predictive text is on.



Sentence case text: predictive text is on. Only available at the beginning of a sentence.

## ■ Delete text

To delete text, use one of the following options:

- Select *Clear* to backspace the cursor and delete a character.
- Select and hold *Clear* to backspace continuously and delete characters.

## 4. Messaging



Your phone is capable of creating and receiving text, multimedia, voice and minibrowser messages. Check with your service provider to see what messaging is available for you.

### ■ Text messages

Text messaging is a network service. See “[Network Services](#)”, p. ix for more information. If your wireless service provider or network operator supports this feature, you can send and receive text messages to compatible phones that are also subscribed to the service.

When composing text messages, check the number of characters allowed in the top right corner of the message. Using special (unicode) characters takes up more space. If there are special characters in your message, the indicator may not show the message length correctly. Before the message is sent, the phone will tell you if the message exceeds the maximum length allowed for one message. Also, you can make distribution lists that contain phone numbers and names from your contact list. See “[Distribution lists](#)”, p. 28 for more information.



Note: When sending messages, your device may display *Message sent*. This is an indication that the message has been sent by your device to the network. This is not an indication that the message has been received at the intended destination. For more details about messaging services, check with your service provider.

### Text message folders and options

In standby mode, select *Menu* > *Messaging* > *Text messages* and from the following:

*Create message*—Create and send messages.

*Inbox*—Check for received text messages. Text messages are automatically stored in the *Inbox* when they are received. A notification appears when a message arrives in the *Inbox*.

*Outbox*—Check for outgoing text messages. Text messages are automatically stored in the *Outbox* as they are sent. If your service is interrupted while sending, the text

message is stored in the *Outbox* until another delivery attempt is made.

*Sent items*—Sent text messages are stored in *Sent items*.

*Drafts*—Save incomplete text messages in a draft. Store drafts of text messages in *Drafts* to be completed at a later time.

*Archive*—Save text messages in *Archive*.

*Templates*—Select from a collection of prewritten *Templates*, when creating text messages. Preloaded *Templates* can be edited and personalised.

*My folders*—Create and name personal folders.

*Delete messages*—Delete messages from a selected folder or all folders.

*Message settings*—Change settings for reading, writing, and sending text messages.

*Send numeric page*—Send a numeric page.

*Add-ins*—Add a sound, animation, or picture object.

*Styles*—Change font appearance and size, and text alignment.

## Write and send text messages



1. In standby mode, select *Menu* > *Messaging* > *Text messages* > *Create message*.

To go quickly to the *Create message* screen, scroll left in standby mode.

2. Compose a text message using the keypad. See “*Choose a text message option*”, p. 18 for composing options.
3. Select *Send to* > *Recently used*, *Send to number*, *Send to e-mail*, *Send to many*, or *Send to distribution list* (if you have created one).
4. Select a number or distribution list, enter the recipient's phone number or e-mail address, or select *Search* to retrieve a number or e-mail address from your contacts list; select *Send*.

## Use a template

Templates are short, prewritten messages that can be retrieved and inserted into new text messages.

1. In standby mode, select *Menu* > *Messaging* > *Text messages* > *Create message* > *Options* > *Use template*.
2. Select one of the available templates and complete the text message using the keypad.

## Read and reply to text messages

When you receive a text message, a notification appears and the unopened letter icon (✉) is displayed.

1. Select *Show* to read the text message or *Exit* to dismiss the notification.  
Scroll to view the whole message, if necessary.  
When unopened messages are in your inbox, ✉ is shown in the upper centre of the display screen during standby mode as a reminder.
2. Select *Reply* > *Empty screen*, *Original text*, *Template*, or one of the predefined answers provided.
3. Compose your reply with the keypad, and select *Send*.

## Choose a text message option

### Create message options

When you create or reply to a text message, depending on the mode of text input you are using and the features supported by your wireless service provider or network operator, some or all of the following are available:

*Sending options*—*Mark* or *Unmark* a message as *Urgent*, *Delivery reports*, *Callback number*, or *Signature*.

*Clear text*—Erase all text from your message.

*Insert contact*—Insert detail from your contacts list into your message.

*Insert number*—Insert a phone number or find a phone number in the contacts list.

*Save*—Save the message in *Drafts*.

*Exit editor*—Exit the message editor.

*Use template*—Insert a predefined template.

*Insert smiley*—Insert a smiley.

*Insert word* or *Edit word*—Enter or edit the text of a new word that might not appear in the predictive text dictionary. This displays only when predictive text is on.

*Insert symbol*—Insert a special character. This displays only when predictive text is on.

**Writing language**—To change the language from a pre-defined list.

**Dictionary on or Dictionary off**—Turn predictive text on or off.

**Matches**—View matches found in the predictive text dictionary for the word you want to use. This displays only when predictive text is on.

## Read message options

When you read a text message, the following options are available:

**Delete**—Discard the text message.

**Use detail** > *Number, E-mail address, or Web address*—Select *Save* to create a new contact; select *Options* > *Add to contact, Send message, or Call* for other options.

**Move**—Save the message to *Archive, Templates*, or a folder you have created.

**Divert**—Forward the text message to another phone number.

**Lock or Unlock**—Lock or unlock the text message. The appropriate option appears.

**Rename**—Edit the title of the text message.

## Use custom folders

Your phone has a folder system that saves and stores text messages. Additionally you can create custom folders.

## Create a custom folder

To organise your messages, create custom folders, and save messages you want to keep there.

1. In standby mode, select *Menu* > *Messaging* > *Text messages* > *My folders* > *Add fldr.* to create your initial custom folder.

Select *Menu* > *Messaging* > *Text messages* > *My folders* > *Options* > *Add folder* to create an additional custom folder.

2. Enter a name for the new folder, and select *OK*.

## Rename a custom folder

1. In standby mode, select *Menu* > *Messaging* > *Text messages* > *My folders*.
2. Folders you have created appear in the display. Scroll to the folder you wish to rename, and select *Options* > *Rename folder*.
3. Select and hold *Clear* to delete the existing entry; enter a new name for the folder; select *OK* to confirm or *Back* to exit.

## Delete a custom folder

Only folders in *My folders* can be deleted. The *Inbox, Outbox, Sent items, Drafts, Archive, and Templates* folders are protected. When you delete a folder, all messages in the folder are also deleted.

1. In standby mode, select *Menu > Messaging > Text messages > My folders*.
2. Scroll to the folder you wish to delete, and select *Options > Delete folder*.
3. Select *Yes* to delete or *No* to exit.

### Delete text messages

If your message memory is full and you have more text messages waiting at the network,  blinks in standby mode. You can do the following:

- Read some of the unread text messages, and delete them.
- Delete text messages from some of your folders.

### Delete a single text message

To delete a single text message, you need to open it first.

1. In standby mode, select *Menu > Messaging > Text messages*.
2. Select the folder containing the text message you wish to delete.
3. Select the message you wish to delete and *Options > Delete*.
4. Select *Yes* to delete the message or *No* to exit.

### Delete all messages in a folder

1. In standby mode, select *Menu > Messaging > Text messages > Delete messages* and one of the following:
  - All*—Deletes all text messages in the folder.
  - All read*—Deletes only the read text messages in the folder.
  - All unread*—Deletes all unread text messages in the *Inbox*.
2. If you select *All* or *All read*, select *Mark* or *Unmark* to choose the folders from which to delete text messages. Select *Options > Mark all* to choose all folders.
3. Select *Done* after choosing the folders.
4. Select *Yes* to delete the message or *No* to exit.

## Text message settings

### Sending options

In standby mode, select *Menu > Messaging > Text messages > Message settings > Sending options* and the setting you wish to change:

- Priority > Normal* or *Urgent*—Select the priority of the message.
- Delivery reports*—Select *On* to receive a note confirming delivery of a text message.

*Send callback number*—Select *OK* to send your default phone to the recipient.

*Signature*—Select *On* to append a signature to an outgoing text message. If you have not created a signature, select *On*; enter a signature, and select *OK*.

## Other settings

In standby mode, select *Menu* > *Messaging* > *Text messages* > *Message settings* > *Other settings* and the setting you wish to change:

*Message font size* —Select the desired font size for the display.

*Message overwriting* > *Sent items only*, *Inbox only*, *Sent items & Inbox*, or *Off*—Set your phone to automatically replace old messages in *Inbox* or *Sent items* when new ones arrive. When the message memory is full, your phone cannot send or receive any new messages.

*Save sent messages*—Select *Always save* or *Always prompt* to save sent text messages to *Sent items*. Select *Off* to not save messages.

*Queue msgs. if no digital*—Select *On* or *On prompt* to store text messages in the *Outbox* until they can be sent with a digital service. Select *Off* to not store messages.

## Multimedia messages

Multimedia messaging is a network service. See “[Network Services](#)”, p. ix for more information. If your wireless service provider or network operator supports this feature, you can send and receive multimedia messages to compatible phones that are also subscribed to the service.

A multimedia message can contain text, sound, a picture, or a video clip. Your phone supports multimedia messages that are up to 600 KB. If the maximum size is exceeded, the phone may not be able to receive the message.



**Note:** Only devices that have compatible features can receive and display multimedia messages. The appearance of a message may vary depending on the receiving device.

Depending upon your network, you may receive a message that includes an Internet address where you can go to view the multimedia message. Pictures are scaled to fit the display area of the phone. Your phone has a multimedia message viewer for playing messages and a multimedia inbox for storing saved messages. Once you save the multimedia message, you can use the image as a screen saver or the sound as a ringing tone.

Copyright protections may prevent some images, ringing tones, and other content from being copied, modified, transferred, or forwarded.

Multimedia messaging only supports the following formats:

- Picture: JPEG, GIF, animated GIF, WBMP, BMP, and PNG
- Sound: MP3, eAAC+, SP-MIDI, AMR audio, QCELP, and monophonic ringing tones
- Video: clips in H.264 format with QCIF image size

You cannot receive multimedia messages if you have a call in progress, games or other applications running, or an active browsing session. Because delivery of multimedia messages can fail for a variety of reasons, do not rely solely upon them for essential communications.

### Multimedia message folders and options

In standby mode, select *Menu* > *Messaging* > *Multimedia msgs.* and from the following:

*Create message*—Create and send multimedia messages.

*Inbox*—Check for received multimedia messages. Multimedia messages are automatically stored in the *Inbox* when they are received. You receive a

notification when a message arrives in your *Inbox*.

*Outbox*—Check for outgoing multimedia messages. Multimedia messages are automatically stored in the *Outbox* as they are sent. If your service is interrupted while sending, then messages are stored in the *Outbox* until another delivery attempt is made.

*Sent items*—Sent multimedia messages are stored in *Sent items*.

*Saved items*—Save multimedia messages for later use in *Saved items*.

*Delete messages*—Delete multimedia messages from the *Inbox*, *Outbox*, *Sent items*, or *Saved items*.

*Message settings*—Change the settings for multimedia messages.

### Write and send multimedia messages



1. In standby mode, select *Menu > Messaging > Multimedia msgs. > Create message.*
2. Compose a message using the keypad. See “Choose a multimedia message option”, p. 24 for composing options.
3. Select *Send to > Recently used, To phone number, To e-mail address, To many, or Distribution lists.*
4. Select a number or distribution list, and enter the recipient's phone number or e-mail address; or select *Search* to retrieve a number or e-mail address from your contacts list.
5. Select *Send.*

The multimedia message is moved to the *Outbox* for sending.

The wireless network may limit the size of multimedia messages. If the inserted picture exceeds this limit, the device may make it smaller so that it can be sent by multimedia messaging.

It takes more time to send a multimedia message than to send a text message. While the multimedia message is being sent, the animated indicator  is displayed and you can use other functions on the phone. If there is an interruption while the message is being sent, the phone automatically tries to resend it a few

times. If this fails, the message remains in the *Outbox* and you can try to manually resend it later. Check your *Outbox* for unsent messages.





**Note:** When sending messages, your device may display the words *Multimedia message sent.* This is an indication that the message has been sent by your device to the network. This is not an indication that the message has been received at the intended destination. For more details about messaging services, check with your service provider.

Messages that you send are saved in *Sent items* if the setting *Save sent messages* is set to *Yes*.

See “Multimedia message settings”, p. 27. This is not an indication that the message has been received at the intended destination.

## Read and reply to multimedia messages

When a multimedia message is received,  appears in the display along with the percentage display indicating the download progress. Once the message has been fully downloaded,  and a notification appears in the display.

1. To view the multimedia message immediately, select *Show*.

To save the message to the inbox for later viewing, select *Exit*.

To view a saved message, select *Menu > Messaging > Multimedia msgs. > Inbox* and the message you want to view.

While viewing a message, select *Play* to play the entire message.

2. Select *Options > Reply* or *Reply to all*, and compose your reply.
3. Select *Send to* and *OK* to confirm delivery number.

If  blinks and *Multimedia memory full. View waiting message.* appears, the memory for multimedia messages is full. To view the waiting message, select *Show*. Before you can save the message, you need to delete some of your old messages. See “[Delete multimedia messages](#)”, p. 26 for more information.



**Important:** Exercise caution when opening messages. Multimedia message objects may contain malicious software or otherwise be harmful to your device or PC.

## Choose a multimedia message option

### Create message options

When you create or reply to a multimedia message, depending on the mode of text input you are using and the features supported by your wireless service provider or network operator, some or all of the following options are available:

*Send to album*—Send message to an online album. This is an online network service. Check with your service provider for more information.

*Insert > Image, Sound clip, or Video clip*—Insert an image, sound clip, or video clip file from your *Gallery*. Open the desired folder, and select the file and *Options > Insert*.

Copyright protections may prevent some images, ringing tones, and other content from being copied, modified, transferred, or forwarded.

*Insert > New image*—Open the camera to create a new image that you attach to the message.

*Insert > New sound clip*—Open the voice recorder to create a new sound clip that you attach to the message.

*Insert > Slide*—Insert a slide into your message. Each slide can contain text, business card, calendar note, one image, and one sound clip.

*Insert > Business card*—Insert contact as a business card.

*Insert > Calendar note*—Insert a calendar note.

*Delete > Image, Sound clip, or Video clip*—Delete an image, sound clip, or video clip file from your message. Only appears when your message has a file attachment.

*Delete > Slide*—Delete the current slide from your message.

*Edit subject*—Edit the subject heading.

*Clear text*—Erases all text from the current slide in your message.

*Preview*—Preview the message or slide presentation before sending it. Select *Stop* to end the preview. Select *Play* to start the preview again or *Back* to return to the list of options.

*Previous slide*—Move to the previous slide. Option only appears if there is a previous slide.

*Next slide*—Move to the next slide. Option only appears if there is next slide.

*Slide list*—Shows a list of all slides. Select the slide you wish to edit.

*Slide timing*—Set the timing interval for each slide. By default, each slide appears for 12 seconds.

*Place text first* or *Place text last*—Move text to the top or bottom of the slide.

By default, the text appears at the bottom or last.

*Save*—Saves the message to *Saved items*.

*More options > Insert contact*—Insert a name from your contacts list into your message.

*More options > Insert number*—Insert a phone number or find a phone number in the contacts list.

*More options > Message details*—Show the details of your multimedia message.

*Exit editor*—Exit the message editor.

*Insert smiley*—Insert a smiley.

*Insert word* or *Edit word*—Enter or edit the text of a new word that might not appear in the predictive text dictionary. This appears only when predictive text is on.

*Insert symbol*—Insert a special character. This appears only when predictive text is on.

*Writing language*—Choose the language you want to use.

*Dictionary on* or *Dictionary off*—Turn predictive text on or off.

*Matches*—View matches found in the predictive text dictionary for the word you want to use. This appears only when predictive text is on.

## Read message options

When you read a multimedia message, the following options are available:

*Set contrast*—Adjust the contrast of an image. This option is only available when viewing an image.

*Details*—Displays the details of a highlighted file attachment.

*Save image, Save sound clip, or Save video clip*—Save the corresponding file to the *Gallery*. Images, sound clips, and video clips must be open before you can save them.

*Save link*—Save the corresponding Web link. This appears only when a Web link is highlighted.

*View text*—View only the text included in the message.

*Activate image, Activate tone, or Activate video clip*—View or listen to the corresponding file.

*Open business card*—Open an attached business card.

*Open calendar note*—Open an attached calendar note.

*Delete*—Delete the message you are viewing.

*Reply or Reply to all*—Enter a reply and send it to the original sender and any other recipients of the message.

*Use detail*—Use a corresponding number or e-mail address. The number or e-mail address must be highlighted.

*Send to number, Send to e-mail, or Send to many*—Forward the message to a phone number, to an e-mail address, or to multiple recipients.

*Album*—Forward the message to an online album. This is an online network service. Check with your service provider for more information.

*Message details*—View the sender's name and phone number, the message center used, reception date and time, message size and type.

## Delete multimedia messages

If your message memory is full and you have more multimedia messages waiting at the network,  blinks in standby mode. You can do the following:

- Read some of the unread multimedia messages, and delete them.
- Delete multimedia messages from some of your folders.

## Delete a single multimedia message

To delete a single multimedia message, you need to open it first.

1. In standby mode, select *Menu* > *Messaging* > *Multimedia msgs*.
2. Select the folder containing the multimedia message you wish to delete.

3. Select the message you wish to delete and *Options > Delete*.
4. Select *Yes* to delete or *No* to exit.

### Delete all multimedia messages in a folder

1. In standby mode, select *Menu > Messaging > Multimedia msgs. > Delete messages > Inbox, Outbox, Sent items, or Saved items*.
2. Select *Yes* to delete the all messages in the folder or *No* to exit.

### Multimedia message settings

#### Save sent messages

You can save the multimedia messages that you send to the *Sent items* folder.

In standby mode, select *Menu > Messaging > Multimedia msgs. > Message settings > Save sent messages > No* or *Yes*.

#### Delivery reports

You can request delivery reports to inform you if a message is delivered.

In standby mode, select *Menu > Messaging > Multimedia msgs. > Message settings > Delivery reports > On* or *Off*.

### Scale image down

You can request for images to be automatically scaled down.

In standby mode, select *Menu > Messaging > Multimedia msgs. > Message settings > Scale image down > Yes* or *No*.

### Default slide timing

You can set the default time in mm:ss for the slides of a multimedia message.

In standby mode, select *Menu > Messaging > Multimedia msgs. > Message settings > Default slide timing*, enter a slide time, and select *OK*.

### Allow multimedia reception

Before you can use the multimedia message feature, you must specify whether you want to receive message at all times or only if you are in the service provider's home system. This is a network service. Check with your service provider for more information.

The default setting of the multimedia message service is generally on. The appearance of a multimedia message may vary depending on the receiving device.

You can choose to receive all messages, to block all messages, or to receive messages only when you are in the service provider's home network.

In standby mode, select *Menu > Messaging > Multimedia msgs. > Message settings > Allow multimedia receipt.* and one of the following:

*Yes*—Allow all incoming messages.

*In home network*—Allow incoming messages only if you are in the service provider's home system. This is a network service. Check with your service provider for more information.

*No*—Block all incoming messages.

## Distribution lists

*Distribution lists* allow you to send text or multimedia messages to a designated group of people.

## Create distribution lists

1. In standby mode, select *Menu > Messaging > Distribution lists > New list.*

If you create a second distribution list, select *Menu > Messaging > Distribution lists > Options > Create new list.*

2. Enter a name for the list, and select *OK.*
3. To add a contact to this list, select *Add new*, and add the contacts one by one.

A distribution list only contains phone numbers of recipients.

## Add and remove contacts

To add contacts, select *Menu > Messaging > Distribution lists > the list > Add new.* Add the contacts one by one.

To remove contacts, select *Menu > Messaging > Distribution lists > the list > Options > remove contact name.*

## Use distribution lists

1. In standby mode, select *Menu > Messaging > Distribution lists.*
2. Lists you create are displayed. Scroll to the list you wish to modify; select *Options* and one of the following:

*Create new list*—Create a new distribution list.

*Rename list*—Rename the distribution list.

*Clear list*—Clear the distribution list of all current contacts.

*Delete list*—Delete the distribution list.

## ■ Voice messages

If you subscribe to voice mail, your wireless provider will furnish you with a voice mailbox number. You need to save this number to your phone to use voice mail. When you receive a voice message, your phone will beep, displaying a message, or both. If you receive more than one message, your phone shows the number of messages received.

### Save voice mailbox number

Your wireless provider may have already saved your voice mailbox number to your phone. If so, the number will appear in the display in step 2. Select *OK* to leave the number unchanged.

1. In standby mode, select *Menu > Messaging > Voice messages > Voice mailbox number*.
2. If the number is not displayed or incorrect, enter your voice mailbox area code and number.
3. Select *OK*.

### Call and set up your voice mail

1. After you save the voice mailbox, in standby mode, press and hold 1.
2. When you connect to voice mail and the prerecorded greeting begins, follow the automated

instructions to set up your voice mail.

### Listen to your voice mail

After you set up voice mail, you can dial the number in one of four ways:

- Dial the number using the keypad.
- Press and hold 1.
- Select *Listen* if there is a notification on the display.
- In standby mode, select *Menu > Messaging > Voice messages > Listen to voice messages*.

When you connect and the prerecorded greeting begins, follow the automated instructions to listen to your voice messages.

### Automate voice mail

Voice mail services vary by service provider. The following instructions are examples of common operations. Please check with your service provider for specific instructions for using your voice mail service.

### Write down number and process

1. Write down your voice mailbox number.
2. Call and check your voice mail as you normally would.
3. Write down your interaction with the recorded prompts step-by-step.

Note that each voice mail service may vary. Your steps may resemble the following:

Dial 2145551212, pause 5 seconds, press 1, pause 2 seconds, press 1234, and press \*.

### ■ Minibrowser messages

Minibrowser messaging is a network service. See "[Network Services](#)", p. ix for more information.

If your wireless service provider or network operator supports this feature, you can check for e-mail messages using the minibrowser. In standby mode, select *Menu > Messaging > Minibrowser msgs. > Connect.*

See "[Mobile web](#)", p. 88 for more information on using your phone to access web pages.

## 5. Log



*Log* stores information about the last 30 missed, 30 received, or 30 dialled calls. It also adds the total duration of all calls. When the number of calls exceed the maximum, the most recent call replaces the oldest.

Whether viewing missed, received, or dialled calls, the menu options are the same:

*Time of call*—Display the date and time of the call.

*Send message*—Send a message to the number.

*Use number*—Edit the number and associate a name with the number.

*Delete*—Clear the number from memory.

*Call*—Call the number.

### ■ View missed calls

The missed calls feature does not function when your phone is switched off. Missed calls are calls that were never answered.

1. In standby mode, select *Menu > Log > Missed calls*; if a missed call notification appears, select *List*.
2. Scroll to a name or number, select *Options*, and a menu option.

### ■ View received calls

Received calls are calls that have been answered.

1. In standby mode, select *Menu > Log > Received calls*.
2. Scroll to a name or number, select *Options*, and a menu option.

### ■ View dialled numbers

Dialled calls are numbers you have previously dialled from your phone:

1. In standby mode, press the call key; or select *Menu > Log > Dialled numbers*.
2. Scroll to a name or number, select *Options*, and a menu option.

### ■ Time of call

You can make or receive up to five calls to or from the same number and view the time each call occurred. Your clock must be set for this feature to work accurately.

1. While viewing a missed, received, or dialled call, select *Options > Time of call*.
2. Scroll down to view the most recent call times from this number.

3. Select *Back* to return to the options list.

## ■ Clear log lists

You can delete any missed, dialled, or received calls from phone memory.

In standby mode, select *Menu > Log > Clear log lists > All call lists, Missed calls, Received calls, Dialled numbers, or Message recipients.*

## ■ Call duration



**Note:** The actual invoice for calls and services from your service provider may vary, depending on call plans, network features, rounding off for billing, taxes and so forth.

You can view the duration of your calls.

In standby mode, select *Menu > Log > Call duration* and one of the following options:

*Last call duration*—Check the time of your last call.

*Dialled calls' duration*—Check the combined time of calls you dialled for either *Home* or *Roaming*.

*Received calls' duration*—Check the combined time of calls you received for either *Home* or *Roaming*.

*All calls' duration*—Check the combined time of all calls.

*Life timer*—Check the total airtime minutes logged on your phone.

*Clear timers*—Enter your security code, and select *OK* to clear all timers on your phone.



**Note:** Some timers, including the life timer, may be reset during service or software upgrades.

## ■ Duration of data or fax calls

*Data/fax calls* are a network service. See "*Network Services*", p. ix for more information. If your wireless service provider or network operator supports this feature, you can view the size or duration of sent or received data and fax calls.



**Note:** The actual invoice for calls and services from your service provider may vary, depending on call plans, network features, rounding off for billing, taxes and so forth.

In standby mode, select *Menu > Log > Data/fax calls* and one of the following options:

*Last sent data/fax*—View the size (KB) of the last sent data or fax call.

*Last received data/fax*—View the size (KB) of the last received data or fax call.

*All sent data/fax*—View the size (KB) of all sent data and fax calls.

*All received data/fax*—View the size (KB) of all received data and fax calls.

*Last data/fax's duration*—View the duration time of the last data or fax call.

*All data/fax calls' duration*—View the duration time of all calls.

*Clear all data/fax registers*—Select *Yes* to clear all data and fax registers.

*All sent browser data*—View the size (KB) of all sent browser data.

*All received browser data*—View the size (KB) of all received browser data.

*Last browser session*—View the duration time of the last browser session.

*All browser sessions*—View the duration time of all browser sessions.

*Clear all browser logs*—Select *OK > Yes* to clear all browser logs.

## ■ Duration of minibrowser calls

Minibrowser is a network service. See "[Network Services](#)", p. ix, for more information. If your wireless service provider or network operator supports this feature, you can view the size or duration of sent or received data from the minibrowser.



**Note:** The actual invoice for calls and services from your service provider may vary, depending on call plans, network features, rounding off for billing, taxes and so forth.

In standby mode, select *Menu > Log > Minibrowser calls* and one of the following options:

*Last sent browser data*—View the size (KB) of the last send browser data.

*Last rcvd. browser data*—View the size (KB) of the last received data.

## 6. Contacts



The contacts list can hold up to 500 contacts with multiple numbers and text notes for each contact. The amount of numbers and text entries that you can save may vary, depending on length and the total number of entries in the contacts list.

In standby mode, select **Menu** > **Contacts** and from the following options:

**Names**—List of contacts currently on your phone.

**Settings**—Change your contact settings.

**Caller groups**—Assign contacts to caller groups.

**Voice tags**—Assign voice commands to phone numbers.

**Speed dial**—Assign specific keys to phone numbers.

**My number**—Shows the current number assigned to the phone.

**Delete all contacts**—Delete all contacts on your phone.

To quickly access your contacts scroll up or down while in standby mode.

### ■ View contacts

In standby mode, select **Menu** > **Contacts** > **Names** or scroll down to see your current list of contacts. While viewing your contact list, you can select **Details** for the contact information or **Options** and one of the following:

**Search**—Search your contacts.

**Add new contact**—Add a new contact.

**Delete contact**—Delete the highlighted contact.

To make a call, highlight a contact, and select **Call**.

### ■ Search contacts

In standby mode, select **Menu** > **Contacts** > **Names** > **Options** > **Search**. Enter the first character of the contact name, and highlight the contact you wish to view.



**Note:** If the right selection key on your phone is **Names**, you can select **Names** > **Options** > **Search** in the standby mode.

## ■ Add new contacts

### Save a name and number

1. In standby mode, enter the phone number you wish to save.
2. Select *Save*.
3. Enter the name, and select *OK* > *Done*.

When you enter a number, you can select *Options* > *Insert pause ('p')* to insert a pause code or *Options* > *Insert wait ('w')* to insert a wait code.

### Save a number (only)

1. In standby mode, enter the phone number you wish to save.
2. Select and hold *Options*.

### Save a contact

1. In standby mode, select *Menu* > *Contacts* > *Names* > *Options* > *Add new*.
2. Enter the name, and select *OK*.
3. Enter the phone number, and select *OK*.

### Insert dialling codes

You can insert special characters called dialling codes into phone numbers such as voice mail, and save the number to a speed dial location. Dialling codes instruct the receiving system to pause, wait, bypass,

or accept the numbers that follow them in the dialling string.

You can automate voice mail with dialling codes. For more information, see "[Automate voice mail](#)", p. 29.

Press \* repeatedly to cycle through dialling codes. When the desired code appears in the display, pause briefly and the code is inserted into the dialling string.

The following dialling codes are available:

| Dialling code | Indicates...   |
|---------------|--|
| *             | Bypasses a set of instructions.  |
| +             | Causes the international access code to be replaced by +.                            |
| p             | Pauses for 2.5 seconds before sending any numbers that follow.                       |
| w             | Waits for you to press the call key before sending the numbers or codes that follow. |

### Save multiple numbers

You can save different types of phone numbers per contact. The first number you save for any entry is automatically set as the default, but the default number can always be changed.

1. In standby mode, scroll down to display your list of contacts.
2. Select the contact to which you want to add a phone number.
3. Select *Details > Options > Add detail > Number > General, Mobile, Home, Office, or Fax.*
4. Enter the phone number, and select *OK.*

If you want to change the number type, highlight the number and select *Details > Options > Change type > General, Mobile, Home, Office, or Fax.*

### Save other details

To add an address or note an existing contact, do the following:

1. In standby mode, scroll down to display your list of contacts.
2. Scroll to the contact to which you want to add an address or note.
3. Select *Details > Options > Add detail > E-mail address, Web address, Postal address, or Note.*
4. Enter the text for the note or address, and select *OK.*

To associate an image or tone to an existing contact, do the following:

1. In standby mode, scroll down to display your list of contacts.
2. Scroll to the contact to which you want to add an address or note.
3. Select *Details > Options > Add detail > Image* to save an image from the Gallery or to save a new image with the camera function, or *Tone* to select the default tone or a new tone from the Gallery.

### Change default number

To change the default number for an existing contact.

1. In standby mode, scroll down to display your list of contacts.
2. Select the contact for which you want to change the default number and *Details.*
3. Highlight the new default number, and select *Options > Set as default.*

### Send business cards

You can send a business card to a compatible phone or other handheld device.

1. In standby mode, scroll down to display your list of contacts.
2. Select the contact to which you want sent as a business card and *Details.*

3. Select the number to use and *Options > Send business card > Via multimedia, Via text message, Via infrared, or Via Bluetooth.*
4. Select *Default number* or *All details.*
5. Enter the number for your recipient, or select *Search* to retrieve a number from your contacts; select *OK.*

## ■ Edit contacts

1. In standby mode, scroll down to display your list of contacts.
2. Highlight a contact, select *Details.*
3. Highlight the name, number, detail, or image you wish to edit and select *Options.* The type of detail you highlight determines your selection of options. Choose one of the following options:

*View*—View the phone number of the contact.

*Add detail > Name*—Add a name to the contact. This option appears only if the contact does not have a name.

*Add detail > Number > General, Mobile, Home, Office, or Fax*—Add a number to the contact.

*Add detail > E-mail address, Web address, Postal address, Note, Image, or Tone*—Add an additional detail to the contact.

*Edit name, Edit number, or Edit detail*—Edit the detail of the contact.

*Change image*—Change the image associated with the contact.

*Delete*—Select *Delete number* to delete a detail or *Delete contact* to delete the entire contact entry from your contacts.

*Send message*—Create and send a text message or multimedia message to the contact.

*Use number*—Display the phone number, ready for use.

*Set as default*—Make the number the default for the contact.

*Change type > General, Mobile, Home, Office, or Fax*—Change the number type.

*Add voice tag*—Add a voice tag to the contact.

*Save to gallery*—Save the image to your *Gallery.*

*Send business card > Via infrared, Via text message, Via Bluetooth, or Via multimedia*—Send the contact as a business card to another phone.

*Caller groups > Select No group* to remove the contact from a caller group or *Family, VIP, Friends, Business, or Other* to add the contact to an existing caller group.

*Speed dial*—Assign the contact to your speed dial list.

### ■ Modify contact settings

In standby mode, select *Menu* > *Contacts* > *Settings* and the setting you wish to change:

*Scrolling view*—Select *Normal name list*, *Name and number*, *Large name list*, or *Name and image* view.

*Memory status*—View the amount of phone memory used as well as the amount of phone memory available.

### ■ Set up caller groups

You can add contacts to any of five caller groups, and assign a unique ringing tone or graphic to that group. This enables you to identify callers from the group by their unique ringing tone or graphic.

#### Set up a caller group

1. In standby mode, scroll down to display your list of contacts.
2. Highlight a contact, select *Details*.
3. Highlight a number, select *Options* > *Caller groups* and the select the caller group you wish to add the number to.

### Modify a caller group

In standby mode, select *Menu* > *Contacts* > *Caller groups* > *Family*, *VIP*, *Friends*, *Business*, or *Other* and one of the following options:

*Group name*—Rename the group to your preference.

*Group ringing tone*—Set the ringing tone for the group.

*Group logo*—Turn the graphic for the caller group on or off.

*Group members*—Add or remove members from the caller group.

### ■ Set up voice tags

Before using voice tags, note the following:

- Voice tags are not language-dependent. They are dependent on the speaker's voice.
- You must say the name exactly as you said it when you recorded it.
- Voice tags are sensitive to background noise. Record voice tags, and use them in a quiet environment.
- Very short names are not accepted. Use long names, and avoid similar names for different numbers.



**Note:** Using voice tags may be difficult in a noisy environment or during an emergency, so you should not rely solely upon voice dialling in all circumstances.

## Assign a voice tag

To use voice dialling, you must first assign a voice tag to a number.

1. In standby mode, scroll down to display your list of contacts.
2. Highlight a contact, select *Details*.
3. Highlight the number you want to assign a voice tag, select *Options* > *Add voice tag*.
4. Select *Start*, then speak clearly into the microphone. Do not select *Quit* unless you want to cancel the recording.
5. After you finish speaking, the phone automatically stops recording, saves, and replays the voice tag.



appears next to the phone numbers which have voice tags assigned.

## Use a voice tag

1. In standby mode, select and hold *Names*.
2. When you hear several beeps and *Speak now* appears, release the key.
3. Pronounce the voice tag clearly into the microphone.

When the phone finds the voice tag, a notification appears, and the phone automatically dials the number. If the phone does not locate a number or recognise the voice tag, *No match found* appears.

## Play back a voice tag

1. In standby mode, select *Menu* > *Contacts* > *Voice tags*.
2. Select the voice tag you want to play back, and select *Playback*.

## Modify a voice tag

1. In standby mode, select *Menu* > *Contacts* > *Voice tags*.
2. Select the voice tag you want to change, and select *Change*.
3. Select *Start*, and speak clearly into the microphone. The phone repeats your voice tag, and *Voice tag changed* appears.

### Delete a voice tag

1. In standby mode, select *Menu* > *Contacts* > *Voice tags*.
2. Select the voice tag you want to delete, and select *Delete*. *Delete voice tag?* appears.
3. Select *Yes* to erase the voice tag.

### ■ Set up speed dial

You can associate any entry in your contacts with a key from 2–9; to dial those entries, press and hold the assigned key.

### Assign a key to speed dial

1. In standby mode, select *Menu* > *Contacts* > *Speed dial*.
2. Scroll to any empty slot, and select *Assign*.
3. Enter the number (including the area code), and select *OK*; or select *Search* to retrieve a number from your contacts.
4. If necessary, enter the contact name for the number, and select *OK*.

If *Speed dial* is off, the phone displays a prompt asking if you want to activate *Speed dial*. Select *Yes* to activate *Speed dial*.

### Change speed dial numbers

1. In standby mode, select *Menu* > *Contacts* > *Speed dial*.
2. Scroll to the *Speed dial* entry you wish to change, and select *Options* > *Change*.
3. Enter the new number, or select *Search* to retrieve a number from your contacts; select *OK*.
4. If necessary, enter the contact name for the number, and select *OK* to change the key assignment.

### Delete speed dial numbers

1. In standby mode, select *Menu* > *Contacts* > *Speed dial*.
2. Scroll to the *Speed dial* location you wish to delete.
3. Select *Options* > *Delete* > *Yes* to delete the key assignment.

### ■ Display phone number

In standby mode, select *Menu* > *Contacts* > *My number* to display your phone number.

## ■ Delete contacts

### Delete individual contacts

1. In standby mode, scroll down to display your list of contacts.
2. Highlight a contact, and select *Options > Delete contact > Yes* or *No*.

### Delete all contacts

1. In standby mode, select *Menu > Contacts > Delete all contacts > Yes*.
2. Enter your lock code, and press *OK*.  
See "*Security*", p. 72 for more information.

## 7. Camera



You can take photos and record video clips with the built-in camera and adjust its settings. The camera lens is on the back of the phone.

The camera produces photos in JPEG format and video clips in H.263 (QCIF) format. After you take a picture or video, you can attach it to a multimedia message, send it as a multimedia message, save it as a wallpaper, save it to a compatible PC using Nokia PC Suite software, and upload it to a Web address with the content image uploader. When you attach a picture to a contact, the picture is displayed when the contact calls you.

If there is not enough memory to take a new photo, delete old photos or other files in the *Gallery*.

This device supports an image capture resolution of 320 x 240 pixels on the display. The image resolutions in these materials may appear different.

Keep a safe distance when using the flash. Do not use the flash on people or animals at close range. Do not cover the flash while taking a picture.

When the phone is in camera mode, the interface will switch from portrait to landscape. Turn the phone on its

side to use the camera and view the available options.

### Take a photo

You can use your camera to take photographs. To take a picture, complete the following steps:

1. In standby mode, press the camera key or select *Menu > Camera*. This activates the camera. The display is now landscape.

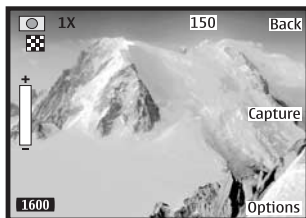

If you are in *Video* mode, select *Options > Still image* to switch to *Still image* mode.

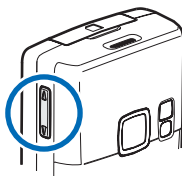

2. To take a picture, press the camera key or select *Capture* to take the photo. Press the volume key

displayed here or the scroll keys to zoom in and out.

When taking a photo, a shutter sound is heard. The phone saves the photo in the *Images* folder of the *Gallery* menu. The saved photo is shown on the display.

3. Select *Back* to take another photo, *Delete* to erase the photo, or *Options* and one of the following:  
*Zoom*—Zoom in on a captured photo; scroll to navigate around the photo.

*New image*—Returns to camera mode.

*Send* > *Via multimedia*, *Via Bluetooth*, or *Via infrared*—Send a photo to a compatible phone or PC.

*Attach to contact*—Attach the photo to a contact.

*Rename*—Edit the name of the photo.

*Open Gallery*—Open the *Gallery*, where photos are saved.

*Set contrast*—Scroll to adjust the contrast of the photo.

*Edit image*—Opens the photo for editing.

*Use image* > *Set as wallpaper*, *Set as screen saver*, or *Set as contact image*—Use the photo.

*Details* > View details of the photo.

## ■ Use the self-timer

You can use the camera self-timer to delay taking a photo for approximately 10 seconds.

1. In standby mode, select *Menu* > *Camera* > *Options* > *Self-timer on*.
2. Select *Start*.

A beep sounds while the self-timer is running, and beeps faster when the camera is about to capture the photo. After the time-out, the camera takes the photo and saves it to the *Images* folder of the *Gallery* menu.

## ■ Take a sequence of photos

You can use the camera image sequence option to take up to four photos in quick succession.

1. In standby mode, select *Menu* > *Camera* > *Options* > *Img. sequence on*.
2. Select *Sequence*.

The camera take five photos in sequence. After the photos are taken, the camera saves them to a folder in the *Images* folder of the *Gallery* menu.

## ■ Record a video

1. In standby mode, press the camera key or select *Menu > Camera*. This activates the camera. The display is now landscape. If you are in *Still image* mode, select *Options > Video* to switch to *Video* mode.

2. Select *Record* to begin recording the video clip.

While you are recording, the indicator and the remaining recording time are shown at the top of the display.

3. Select *Pause* to pause the recording, *Continue* to resume the recording, or *Stop* to stop the recording.

The phone saves the video clip in the *Video clips* folder of the *Gallery* menu.

4. Select *Back* to take another video clip, *Play* to play the video clip, or *Options* and one of the following.

*Delete*—Delete the video clip from the *Gallery*.

*New video clip*—Returns to video mode.

*Send > Via multimedia, Via infrared, or Via Bluetooth*—Send the video clip to a compatible phone or PC.

*Rename*—Edit the name of the video clip.

*Open Gallery*—Opens the *Gallery*, where video clips are saved.

*Mute audio* or *Unmute audio*—Turn the video clip sound on or off.

*Set contrast*—Use the scroll keys to adjust the contrast of the video clip.

*Use video clip > Set as screen saver*—Use the video clip.

*Details*—View details of the video clip.

## ■ Camera options

In standby mode, select *Menu > Camera > Options* and from the following:

*Still image* or *Video*—Choose camera mode to take a picture or record a video.

*Mute audio* or *Unmute audio*—Turn the sound on or off for the video clip. Option only appears when camera is in video mode.

*Night mode on* or *Night mode off*—Switch the camera night mode on and off.

*Flash on* or *Flash off*—Turn the camera flash on and off.

*Self-timer on* or *Self-timer off*—Turn the self-timer on and off. This option only appears in still image mode.

*Img. sequence on* or *Img. sequence off*—Turn image sequencing on or off. The pictures are then saved to the gallery. This option only appears in still image mode.

*View previous*—View the previous photo or video taken. This option only appears when a photo has been taken during that session.

*Open Gallery*—Open the *Gallery* to view saved images, videos, and recordings.

*Settings*—Change the settings for the phone camera.

## ■ Modify camera settings

### Image quality

Define file compression when saving the image. High-quality images have less file compression and provide the best image quality, but take more memory.

In standby mode, select *Menu > Camera > Options > Settings > Image quality > High, Normal, or Basic*.

### Image size

Set the size of an image when taking a picture. A larger image has better resolution, but takes more memory.

In standby mode, select *Menu > Camera > Options > Settings > Image size* and a resolution size.

### Video clip quality

Define file compression when saving the video clip. High-quality video clips have less file compression and provide the best video quality, but take more memory.

In standby mode, select *Menu > Camera > Options > Settings > Video clip quality > High, Medium, or Low*.

### Video clip length

You can change the maximum length of a video clip. The maximum size of a video clip can be 600 KB. A recording will stop once it reaches the maximum size, even if the maximum length is set longer. Only video clips that are default length or shorter can be sent in a multimedia message.

In standby mode, select *Menu > Camera > Options > Settings > Video clip length > Default or Maximum*.

### Camera sounds

You can turn off the camera sounds that happen when a picture is taken or video recorded.

In standby mode, select *Menu > Camera > Options > Settings > Camera sounds > On or Off*.

## Default title

You can change the default title your phone uses to assign names to new photos and video clips.

In standby mode, select *Menu > Camera > Options > Settings > Default title > Automatic* or *My title*.

If you select *My title*, enter new text upon which filenames the phone creates are based on.

## Image storage

You can change where your phone camera stores files.

In standby mode, select *Menu > Camera > Options > Settings > Image and video storage > Default folder* or *Other folder*. If you select *Other folder*, locate the new your new location. This setting is only available when you are using a miniSD card.

## Default mode

You can change the default mode of your phone camera.

In standby mode, select *Menu > Camera > Options > Settings > Default mode > Standard photo* or *Video*.

## 8. Gallery



You can save pictures, video clips, recordings, music files, and ringing tones to folders in the *Gallery*, and add new folders to the ones already there. You can download images and tones using multimedia messaging, text messaging, mobile Internet sites, or Nokia PC Suite.

Your phone supports a digital rights management system to protect content that you have acquired. A piece of content, such as a ringing tone, can be protected and associated with certain usage rules, for example, the number of usage times or a certain usage period. The rules are defined in the content activation key that can be delivered with the content or separately, depending on the service provider. You may be able to update these activation keys. Always check the delivery terms of any content and activation key before acquiring them, as they may be subject to a fee.

Copyright protection may prevent some images, ringing tones, and other content from being copied, modified, transferred, or forwarded.

Your phone has about 20 MB of memory for storing files in the *Gallery*. This memory is not shared with other

functions, such as contacts. If the phone displays a message that the memory is full, delete some existing files before proceeding. You can also use a compatible miniSD card to add memory.



**Warning:** Use only compatible miniSD cards with this device. Other memory cards, such as multimedia cards, do not fit in the miniSD card slot and are not compatible with this device. Using an incompatible memory card may damage the memory card as well as the device, and data stored on the incompatible card may be corrupted.

### ■ Open a folder

In standby mode, select *Menu* > *Gallery* to view the folder system. The phone folder system includes:

*Memory card*—If there is a miniSD card in the phone, the miniSD name is displayed below the signal strength indicator. You can access your miniSD card folder system.

*Images*—By default, camera photos are saved to this folder.

**Video clips**—By default, camera video clips are saved to this folder.

**Music files**—By default, music files are saved to this folder.

**Themes**—A set of themes included with your phone is stored here.

**Graphics**—A set of graphics included with your phone is stored here.

**Tones**—A set of ring tones included with your phone is stored here.

**Recordings**—By default, voice recordings are saved to this folder.

**Received files**—Files sent directly to your phone are stored here.

**Your folders**—Folders you create appear after the preset folders.

To open a folder, highlight the folder and select **Open**. Once you open the folder list and highlight a file, you can access the file or the options associated with that specific file type.

## ■ Gallery options

In standby mode, select **Menu > Gallery > Options** and one of the following:

**Rename memory card**—Enter a name for the miniSD card. This option is available only for the miniSD card folder.

**Format memory card**—Delete all files and folders stored on the miniSD card.

This option is available only for the miniSD card folder.

**Delete folder**—Delete a folder you have created. You cannot delete a preset folder.

**Move**—Move the selected folder into another folder. After selecting **Move**, highlight another folder, and select **Move to**. You cannot move a preset folder.

**Rename folder**—Rename a folder you have created. You cannot rename a preset folder.

**Details**—Show the name, size, and date of creation of the selected folder.

**Type of view**—Choose whether to view the folders as a list with details, list only or a grid.

**Sort**—Sort the contents of the selected folder by name, date, format, or size.

**Add folder**—Create a new folder.

**Memory status**—Check the available memory for the phone handset or the miniSD card.

**Activation key list**—View the list of available activation keys. You can delete activation keys if desired.

**Mark** or **Mark all**—Allow you to mark Gallery folders to be moved into another folder. This function only applies to folders you have created.

Other options appear depending on the type of files that exist in the folders.

## 9. Media



### ■ Music player

Your phone includes a *Music player* for listening to music or other tracks in MP3 or AAC format. You can transfer files from a PC to your phone using a USB data cable, an infrared, or a Bluetooth wireless technology connection. To transfer music tracks from a compatible PC and manage the music tracks and track lists, see the instructions for the Nokia Audio Manager application in the Nokia PC Suite online help. See “Data cable transfer”, p. 69; “Infrared connectivity”, p. 68; and “Bluetooth connectivity”, p. 65 for more information on transferring music tracks to your phone.





Music files stored in the *Music files* folder of the *Gallery* are automatically detected and added to the default playlist. Music files stored elsewhere, such as in a miniSD card folder, must be defined in a track list before you can listen to them.

You can listen to the sound files through a compatible headset or the phone loudspeaker.

You can make or answer a call while using *Music player*. During a call, the playback is paused. When the call ends, *Music player* restarts where it left off.

### Play music tracks

In standby mode, select *Menu* > *Media* > *Music player*. If there are no music files in the *Music files* folder, you can select another folder before entering the *Music player*. The details of the first track on the default track list are shown.

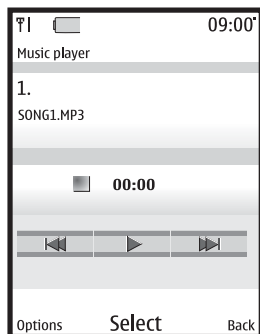

To use the graphical keys, , , , or , on the display, scroll left or right to the desired key, and select it.





Play track—To play a track, select .

**Adjust volume**—To adjust the volume level, use either the volume key or the left and right selection keys.

**Stop track**—To stop the playing, select  or press and hold the end key.

**Skip tracks**—To skip to the beginning of the next track, select . To skip to the beginning of the previous track, select  twice.

**Rewind or fast forward**—To rewind the current track, select and hold . To fast forward the current track, select and hold . Release the key at the position you want.



**Warning:** Listen to music at a moderate level. Continuous exposure to high volume may damage your hearing.

## Music player options

Select *Music files* or other music folder and *Options* and one of the following:

*Play via Bluetooth*—Make a connection to an audio enhancement using Bluetooth connectivity.

*Track list*—View all the tracks available on a track list. To play a track, highlight the track, and select *Play*. Select *Options* > *Send* to send the music file. Select *Options* > *Refresh all tracks* to refresh the track list (for example, after adding new tracks to the list). Select *Options* > *Change track list* to change the track list that is shown

when you open the *Music player* menu, if several track lists are available in the phone.

*Play options*—Select *Random* to play the tracks on the track list in random order. Select *Repeat* to play the current track or the entire track list repeatedly.

*Media equaliser*—The equaliser enhances the sound quality when using a headset (only) with the *Music player* by amplifying or attenuating frequency bands. There are five preset equaliser settings (*Normal*, *Pop*, *Rock*, *Jazz*, and *Classical*) and two customisable settings.

*Headset or Loudspeaker*—With the headset attached you can toggle between listening to the *Music player* through a headset or the loudspeaker. When using a compatible headset, you can skip to the next track by pressing the headset key quickly. To stop the playing, press and hold the headset key.



**Warning:** When using the stereo headset your ability to hear outside sounds may be affected. Do not use the stereo headset where it can endanger your safety.

*Send* > *Via multimedia*, *Via infrared*, or *Via Bluetooth*—Send music files to a compatible device.

*Memory status*—View used and free memory of *Handset* and *Memory card*.

## Radio

Your phone has an FM radio that also functions as an alarm clock radio. You can listen to the FM radio on your phone through the hands-free speaker enhancement or with a headset. For FM stereo, connect a compatible music stand or stereo headset to the connector on the bottom of the phone or connect a 2.5 mm headset to the headset port on the side of the phone.

The FM radio depends on an antenna other than the wireless device antenna. A compatible headset or enhancement needs to be attached to the device for the FM radio to function properly.

The quality of a radio broadcast depends on coverage of the radio station in that particular area.







**Warning:** Listen to music at a moderate level. Continuous exposure to high volume may damage your hearing.





## Play radio

In standby mode, with an enhancement or headset connected, select *Menu > Media > Radio*.

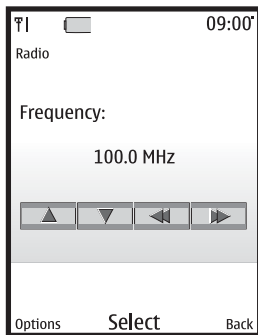
The *Radio* turns on and plays the last radio frequency you used.

To use the graphical keys, , , , or , on the display, scroll left or right to the desired key, and select it.



**Channel search**—To start a channel search, select and hold  or . To change the radio frequency in 0.1 MHz steps, briefly press  or .

**Switch off**—Press and hold the end key to turn off the radio.

**Adjust volume**—To adjust the volume level, use the volume key.

**Save channel**—To save the channel to a memory location 1 to 9, press and hold the corresponding number key. To save a channel to a memory location 10 to 20, briefly press 1 or 2, then press and hold the desired number. Enter the name of the channel, select *OK*.

**Select channel**—To select to a channel, select ▲ or ▼. To go directly to a saved channel, briefly press the corresponding number key.

When an application using a browser connection is sending or receiving data, it may interfere with the radio.

When you place or receive a call, the radio automatically mutes. Once the call is ended, the radio switches back on.

## Radio options

In standby mode, select *Menu* > *Media* > *Radio*. The radio turns on. Select *Options* and one of the following:

**Turn off**—Turn off the radio.

**Save station**—Enter a name for the channel, and select *OK*. Select one of 20 locations to save the channel location.

**Stations**—Select from the list of current saved channels on your phone. Use *Options* > *Delete station* to clear channels or *Options* > *Rename* to rename channels.

**Mono output or Stereo output**—Listen to the radio in monaural mode or in stereo (default). Stereo output is available through a stereo enhancement.

**Headset or Loudspeaker**—With the headset attached, listen to the radio through a headset or the loudspeaker.

**Set frequency**—Manually enter the frequency of a known radio station, and select *OK*. You can also press \* to set a frequency.

## Voice recorder

Voice recorder allows you to make a short (up to 3 minutes) recording and save it to the *Recordings* folder or another folder in the *Gallery*. The recorder cannot be used when a data call is active.

## Record speech or sound

1. In standby mode, select *Menu* > *Media* > *Voice recorder*.
2. To start the recording, select record virtual button.
3. Hold the phone in the normal position near your ear, and record your message.
4. When you are finished recording, select stop virtual button.

The recording is given a default name and saved to the *Recordings list*. The default location of the *Recordings*

*list* is the *Recordings* folder in the *Gallery*.

After you have made a recording you can select *Play last recorded* to replay the recording and *Send last recorded > Via infrared, Via Bluetooth, or Via multimedia* to send the recording to a compatible phone. These options are only available during the current recording session.

## Recording list

1. In standby mode, select *Menu > Media > Voice recorder > Options > Recordings list > Recordings*.
2. Navigate through the *Recordings* folder, and select a recording you want to modify.
3. Select *Open* to open and play the recording or *Options* to use the *Gallery* options.

## Change the storage folder

You can select a folder other than *Recordings* as the default folder to store your voice recordings.

1. In standby mode, select *Menu > Media > Voice recorder > Options > Select memory*.
2. Highlight the new location, and select *Set*.

## Equaliser

The equaliser enhances the sound quality when using *Music player* by amplifying or attenuating frequency bands. There are five preset equaliser settings (*Normal, Pop, Rock, Jazz, and Classical*) and two customisable settings.

### Activate an equaliser set

In standby mode, select *Menu > Media > Equaliser*, and highlight the desired equaliser setting, and select *Activate*. Select *Options > View* to display the equaliser settings.

### Create a custom equaliser set

1. In standby mode, select *Menu > Media > Equaliser*.
2. Highlight a customisable setting, and select *Options > Edit*.

The selected set appears in the display with the bar on the far left highlighted. The bars adjust frequencies, from the lowest (the far left bar) to the highest (the far right bar). The higher the indicator on a particular bar, the more that frequency is amplified.

3. To adjust the lowest frequency, scroll up and down to move the indicator on the bar.

4. To adjust other frequencies, scroll right and left to move to the other bars.
5. Repeat steps 3 and 4 to adjust the setting for each frequency.
6. When you are finished, select *Save*.
7. To rename the setting, select *Options > Rename*, enter a new name, and select *OK*.
8. To activate the setting, select *Activate*.

## 10. Settings



Use the *Settings* menu to change profiles, display settings, themes, tone settings, time and date settings, call settings, phone settings, voice commands, connectivity, enhancements, security settings, application settings, network settings, network services, restore factory settings, and view phone details.

### ■ Profiles

*Profiles* define how your phone reacts when you receive a call or message, how your keypad sounds when you press a key, and more. Ringing options, keypad tones, and other settings for each of the available profiles can be left at their default setting, or personalised to suit your needs. The following profiles are available: *General*, *Silent*, *Meeting*, *Outdoor*, and two customisable profiles.

Profiles are also available for enhancements such as a headset and car kit. See "*Enhancement settings*", p. 70.

### Activate a profile

In standby mode, select *Menu* > *Settings* > *Profiles* > *General*, *Silent*, *Meeting*, *Outdoor*, or custom profile > *Activate*.

### Personalise a profile

To modify a profile, do the following:

In standby mode, select *Menu* > *Settings* > *Profiles* > *General*, *Silent*, *Meeting*, *Outdoor*, or custom profile > *Personalise* > and a profile option. You cannot rename the *General* profile. To personalise profile tones, see "*Tones*", p. 57.

### Set a timed profile

Timed profiles can be used to prevent missed calls. For example, suppose you attend an event that requires your phone be set to *Silent* before the event starts, but you forget to return it to *General* until long after the event. A timed profile can prevent missed calls by returning your phone to the default profile at a time you specify.

To set a timed profile, do the following:

1. In standby mode, select *Menu* > *Settings* > *Profiles* > *General*, *Silent*, *Meeting*, *Outdoor*, or custom profile > *Timed*.
2. Enter the time for the profile to expire, and select *OK*.

Timed profiles can be set up to 24 hours in advance.

## ■ Display

### Standby mode settings

#### Wallpaper

You can set either an *Image* or a folder of images (*Slide set*) as wallpaper for the phone display.

In standby mode, select *Menu* > *Settings* > *Display* > *Standby mode settings* > *Wallpaper* and one of the following:

*On*—Activate wallpaper on your phone.

*Off*—Deactivate wallpaper on your phone.

*Image*—Choose an image from the *Gallery* for wallpaper. Select *Open* to browse the *Graphics* folder. Select the image of your choice for the wallpaper.

*Slide set*—Select a folder in your *Gallery* to act as a slide show for the wallpaper.

#### Font colour

You can set font colour of your phone when in standby mode.

1. In standby mode, select *Menu* > *Settings* > *Display* > *Standby mode settings* > *Standby font color*.
2. Scroll to select a colour from the colour grid.

#### Banner

Banner is a network service.

See "*Network Services*", p. ix for more information.

If your wireless service provider or network operator supports this feature, you can choose whether the display shows the operator logo or a custom banner, when the phone is in standby mode.

In standby mode, select *Menu* > *Settings* > *Display* > *Banner* > *Default* or *Personalise*.

#### Screen saver

You can choose a screen saver for the phone display. In standby mode, select *Menu* > *Settings* > *Display* > *Screen saver* and one of the following:

*On*—Activate screen saver on your phone.

*Off*—Deactivate screen saver on your phone.

*Screen savers > Image, Slide set, Video Clip, Digital clock, or Open Camera*—Choose an image, video clip or other option to act as your screen saver.

*Time-out* > Modify the idle time before the screen saver activates.



**Note:** Power saver is automatically activated following screen saver time-out to optimise battery life.

## Sleep mode

*Sleep mode* is a power-saving feature that turns the phone display off during inactivity. You can activate the sleep mode feature on your phone. In standby mode, select *Menu > Settings > Display > Sleep mode > On* or *Off*.

When *Sleep mode* is activated the display is completely blank. A blinking LED indicator shows that the phone is still on.

## Backlight time-out

You can control the time-out of the backlight on your phone.

In standby mode, select *Menu > Settings > Display > Backlight time-out > Default* (15 seconds). To change the time-out between 15 seconds and 4 minutes, select *Personalise*.

## Themes

Themes allows you to personalise the ringtone, screensaver and background on your phone.

In standby mode, select *Menu > Settings > Themes > Select theme* and a theme of your choice.

## Tones

You can adjust the ringing volume, keypad tones, and more for the active profile.

In standby mode, select *Menu > Settings > Tones* and one of the following:

*Incoming call alert*—Select how your phone will alert you when there is an incoming call: *Ringing, Ascending, Ring once, Beep once, Off*.

*Ringing tone*—Select *Open Gallery > Tones* to select the ringing tone for incoming calls.

*Ringing volume*—Use the left and right scroll keys to set the volume of your ringing tone.

*Vibrating alert*—Activate the vibrating call alert. Select *On* to activate the vibrating alert.

*Message alert tone*—Select the alert tone for incoming messages: *Off, Standard, Special, Beep once, Long & loud, Ringing tone*.

**Keypad tones**—Use the left and right scroll keys to set the volume of your keypad tones (or turn them off).

**Warning tones**—Turn warning and confirmation tones on or off

**Alert for**—Set the phone to alert only when a member of a selected caller group calls. See “[Set up caller groups](#)”, p. 38 for more information.

## ■ Time and date

### Clock

#### Show or hide the clock

In standby mode, select *Menu* > *Settings* > *Time and date* > *Clock* > *Show clock* or *Hide clock*.

#### Set the time

1. In standby mode, select *Menu* > *Settings* > *Time and date* > *Clock* > *Set the time*.
2. Enter the time (in hh:mm format), and select *OK*.
3. Select *am* or *pm* (this option displays only when 12-hour format is in use).

### Change the time zone

In standby mode, select *Menu* > *Settings* > *Time and date* > *Clock* > *Time zone* and your time zone based on Greenwich Mean Time (GMT), plus or minus hours in your time zone.

For example, GMT-8 is US Pacific time in Los Angeles, CA. GMT does not include Daylight savings time, so add or subtract accordingly.

### Change the format

In standby mode, select *Menu* > *Settings* > *Time and date* > *Clock* > *Time format* > *24-hour* or *12-hour*.

### Date

#### Show or hide the date

In standby mode, select *Menu* > *Settings* > *Time and date* > *Date* > *Show date* or *Hide date*.

#### Set the date

In standby mode, select *Menu* > *Settings* > *Time and date* > *Date* > *Set the date*, enter the date, and select *OK*.

### Change the format

1. In standby mode, select *Menu* > *Settings* > *Time and date* > *Date* > *Date format* and the format of your choice.
2. With *Date* on the display, select *Date separator*, and the separator of your choice.

## Set the auto-update of date and time

Auto-update is a network service.

See "Network Services", p. ix for more information.

If your wireless service provider or network operator supports this feature, you can allow the digital network to set the clock, which is useful when you are out of your home area (for example, when you have traveled to another network or time zone).

In standby mode, select *Menu > Settings > Time and date > Auto-update of date/time > On, Confirm first*, or *Off*.

If you use the *Auto-update of date/time* option while outside your digital network, you may be prompted to enter the time manually. Network time will replace the time and date when you reenter your digital network.

If your battery has been removed or has discharged outside the digital network, you may be prompted to enter the time manually (once the battery is replaced or recharged, and you are still outside of the digital network).

## Call

### Anykey answer

When *Anykey answer* is on, briefly press any key except the right selection or end key to answer a call.

In standby mode, select *Menu > Settings > Call > Anykey answer > On* or *Off*.

### Automatic redial

Occasionally, your network may experience heavy traffic, resulting in a fast busy signal when you dial. With automatic redial activated, your phone redials the number, and notifies you once the network is available.

In standby mode, select *Menu > Settings > Call > Automatic redial > On* or *Off*.

### Speed dial

To activate or deactivate *Speed dial*, do the following:

In standby mode, select *Menu > Settings > Call > Speed dialling > On* or *Off*. For more information on *Speed dialling*, see "Set up speed dial", p. 40.

### Answer when slide opened

Set your phone to answer a call when you open the slide. If the setting is off, you must press the call key after you open the slide.

In standby mode, select *Menu* > *Settings* > *Call* > *Answ. when slide opened* > *On* or *Off*.

### End call when slide closed

Set your phone to end a call when you close the slide. If the setting is off, you must press the end key after you close the slide.

In standby mode, select *Menu* > *Settings* > *Call* > *End call when slide closed* > *On* or *Off*.

### Calling card

If you use a calling card for long distance calls, you can save the calling card numbers in your phone. Your phone can store up to four calling cards.

#### Save information

1. In standby mode, select *Menu* > *Settings* > *Call* > *Calling card*.
2. Enter your security code or lock code, and select *OK*.  
(See "Security", p. 72.)
3. Scroll to one of the four memory locations, and select *Options* > *Edit* > *Dialling sequence*.

4. Select one of the following sequence types:

*Access + phone + card*—Dial the access number, the phone number, the card number and PIN, if required.

*Access + card + phone*—Dial the access number, the card number and PIN, if required, then phone number.

*Prefix + phone + card*—Dial the prefix (numbers that must precede the phone number) and phone number you want to dial, then card number and PIN, if required.

5. Enter the required information (access number or prefix and card number), and select *OK* to confirm your entries.
  6. Select *Card name*.
  7. Enter the card name, and select *OK*.
- Contact your calling card company for more information.

#### Make calls

After you have saved your calling card information in your phone, you can make a call using your calling card.

1. In standby mode, select *Menu* > *Settings* > *Call* > *Calling card*.
2. Enter your security code or lock code, and select *OK*.
3. Scroll to the calling card of your choice, and select *OK*.

4. Press the end key to return to standby mode; then enter the phone number, including any prefix (such as 0 or 1) that your calling card may require when you make a calling card call. See your calling card for instructions.
5. Press and hold the call key for a few seconds until *Card call* is displayed.
6. When you hear the tone or system message, select *OK*.

## International prefix

If supported by your service provider, you can store an international prefix into your phone. When you enter + at the beginning of a phone number, your phone automatically inserts the international prefix that you have stored.

1. In standby mode, select *Menu > Settings > Call > International prefix*.
2. Enter the international prefix (for example, 0011), and select *OK*.
3. In standby mode, enter + and the phone number you want to call. For example, +3546789.

The phone dials the international prefix you have stored in your phone and the phone number you have entered. For example, the phone dials 0011354789.

## Data and fax calls

### Receive data or fax calls

*Data/fax calls* is a network service.

See "Network Services", p. ix for more information.

If your wireless service provider or network operator supports this feature, you can set up the phone to send or receive data or fax calls when a terminal, such as a PDA or PC, is connected.

For better performance during data calls, place the phone on a stationary surface. Do not move the phone by holding it in your hand during a data call.

For more information on connectivity, refer to the PC/PDA Connectivity Guide. The PC/PDA Connectivity Guide can be downloaded from the Nokia website at [www.nokia-asia.com](http://www.nokia-asia.com).

1. In standby mode, select *Menu > Settings > Call > Data/fax calls > Incoming data/fax call* and one of the following:
  - General*—The phone receives incoming calls as usual.
  - Data calls only*—The phone receives only data calls.
  - Fax calls only*—The phone receives only fax calls.
2. Select *Data calls only* or *Fax calls only*.

- When you are finished receiving the fax or data call, repeat steps 1 and 2, and select *General*.

### View data transfer

You can view the transmission speed when sending or receiving data or fax calls.

In standby mode, select *Menu > Settings > Call > Data/fax calls > Data rate display > Graphic* or *Off*.

### Call summary

Your phone can display the time spent on a call when you hang up.

In standby mode, select *Menu > Settings > Call > Call summary > On* or *Off*.

### Show call time on display

Your phone can display the call time during the phone call.

In standby mode, select *Menu > Settings > Call > Show call time on display > On* or *Off*.

### Ringing tone for no caller ID

You can select a different ringing tone for calls received with no caller ID.

In standby mode, select *Menu > Settings > Call > Ring. tone for no caller ID > On* or *Off*. See "Personalise a profile", p. 55 for more information on selecting a ringing tone.

## ■ Phone

### Language settings

*Phone language* allows you set the language of the display text seen on the phone. In standby mode, select *Menu > Settings > Phone > Phone language* and the language of your choice.

### Automatic keypad

*Automatic keypad* allows you to automatically lock your phone after a defined time.

In standby mode, select *Menu > Settings > Phone > Automatic keypad > On* or *Off*.

### Navigation key

If supported by your wireless service provider or network operator, you can set the features that are activated when you press the scroll key.

- In standby mode, select *Menu > Settings > Phone > Navigation key*.
- Highlight the scroll up, scroll down, scroll right, or scroll left arrow; select *Change*.
- Select a function to assign to the action.

## Memory status

You can view the memory usage of your phone or miniSD card. If you do not have a miniSD card, you will only see the options for your phone memory. Some or all of the following options are available on your phone.

### Phone memory

In standby mode, select *Menu > Settings > Phone > Memory status > Phone* and one of the following possible options.

*Free memory*—Show the amount of phone memory available for file storage.

*Contacts*—Show the amount of phone memory currently used for Contacts.

*Text messages*—Show the amount of phone memory currently used for Text messages.

*Gallery*—Show the amount of phone memory currently used for Gallery.

*Organiser*—Show the amount of phone memory currently used for Organiser.

*Applications*—Show the amount of phone memory currently used for Applications.

*Multimedia msgs.*—Show the amount of phone memory currently used for Multimedia messages.

## Card memory

In standby mode, select *Menu > Settings > Phone > Memory status > Card name* and one of the following:

*Free memory*—Show the amount of phone memory available for file storage.

*Used memory*—Show the amount of phone memory currently used for file storage.

*Size*—Show the total amount of phone memory you can use for file storage.

## Security keyguard

If supported by your wireless service provider or network operator, *Automatic keyguard* controls whether the security keyguard is on or off.

In standby mode, select *Menu > Settings > Phone > Automatic keyguard > On* or *Off*.

## DTMF tones

*DTMF tones* are the tones that sound when you press the keys on your phone keypad. You can use *DTMF tones* for many automated dial-up services such as banking and airlines or for entering your voice mailbox number and password.

*DTMF tones* are sent during an active call. You can send them manually from your phone keypad, or send them automatically by saving them in your phone.

### Set type

In standby mode, select *Menu > Settings > Phone > DTMF tones > Manual DTMF tones* and one of the following:

*Continuous*—The tone sounds for as long as you press and hold a key.

*Fixed*—Used to send tones of the duration you specify in the *DTMF tone length* option.

*Off*—Used to turn off tones. No tones are sent when you press a key.

### Set length

You can also specify DTMF tone length when using the *Fixed* option.

In standby mode, select *Menu > Settings > Phone > DTMF tones > DTMF tone length > Short* (0.1 seconds) or *Long* (0.5 seconds).

### Start-up tone

If the *Start-up tone* is activated, the tone sounds when you turn on your phone. In standby mode, select *Menu > Settings > Phone > Start-up tone > On* or *Off*.

### Help text activation

Your phone displays brief descriptions for most menu items. When you arrive at a feature or menu, pause for about 15 seconds and wait for the help text to display. Scroll to page through the full help text, if necessary.

The default setting for help text is on. However, you can turn help text on or off.

In standby mode, select *Menu > Settings > Phone > Help text activation > On* or *Off*.

### Voice commands

You can set up to five *Voice commands*, which allow hands-free operation of certain phone features.

### Add a voice tag

Before using *Voice commands*, you must first add a voice tag to the phone function.

1. In standby mode, select *Menu > Settings > Voice commands*.
2. Select a function option you wish to tag, and select *Add*.
3. Select *Start*, and speak the voice tag clearly into the microphone.

Do not select *Quit* unless you want to cancel the recording.

The phone replays then saves the recorded tag.  appears next to the function option for which you add a voice tag.

## Activate a voice command

After you have associated a voice command tag with a phone function, you can issue a command by speaking the voice command tag.

1. In standby mode, select and hold *Names*.
2. When *Speak now* appears, pronounce the voice tag clearly into the microphone.

When the phone finds the voice command tag, *Found:* appears, and the phone plays the recognised voice command tag through the earpiece. The function you requested is activated.

## Voice command options

You can modify voice command tags. In standby mode, select *Menu > Settings > Voice commands*, highlight the voice command tag, and select one of the following options:

*Play*—Listen to the voice command tag.

*Options > Change*—Change the voice command tag.

*Options > Delete*—Erase the voice command tag.

## Connectivity

You can connect the phone to a compatible device using an IR connection. You can also connect the phone to a compatible PC using IR or a USB data cable; and use the phone as a modem to enable connectivity from the PC.

For more information, see the Nokia PC Suite online help. Nokia PC Suite and all related software can be downloaded from the U.S. Mobile Phone products section of [www.nokia-asia.com/pcsuite](http://www.nokia-asia.com/pcsuite).



**Important:** Only install and use applications and other software from sources that offer adequate security and protection against harmful software.

## Bluetooth connectivity

Bluetooth technology connectivity enables cost-free wireless connections between electronic devices and can be used to send and receive images, texts, gallery files, voice recordings, video clips, notes, business cards, and calendar notes. It can also be used to connect wirelessly to products that use Bluetooth wireless technology, such as computers. You can synchronise your phone and your PC using Bluetooth connectivity.

Since devices with Bluetooth connectivity communicate using radio waves, your phone and the other device do not need to be in direct line-of-sight.

The two devices only need to be within a maximum of 30 feet (10 meters) of each other. The connection can be subject to interference from obstructions such as walls or other electronic devices.

The Bluetooth wireless technology application whether used actively or in the background, consumes the battery and reduces the operating time of the phone.

This device is compliant with Bluetooth Specification 1.2 and supports the following profiles:

- Object push profile (OPP)
- File transfer profile (FTP)
- Dial-up networking profile (DUN)
- Generic object exchange profile (GOEP)
- Headset profile (HSP)
- Hands-free profile (HFP)
- Generic access profile (GAP)
- Serial port profile (SPP)

To ensure interoperability between other devices supporting Bluetooth technology, use Nokia approved enhancements for this model. Check with the manufacturers of other

devices to determine their compatibility with this device.

There may be restrictions on using Bluetooth technology in some locations. Check with your local authorities or service provider. If you want more information on this function, visit the Bluetooth Technology organisation website: <https://www.bluetooth.org/>.

### Pairing

You can set up a permanent association (pairing) between your phone and another device with Bluetooth technology. Some devices may require pairing before data transfer can take place.

To pair with a device, you and the owner of the other device must agree on a pass code of 1–16 numeric characters. The first time you try to connect the devices, you must each enter the same pass code. Once the devices are paired, you will not need to use the pass code again, so there is no need to remember it.

Paired devices are placed in your paired device list. You can view the list even when Bluetooth connectivity is not active or when the devices in the list are not available for connection.

In standby mode, select *Menu* > *Settings* > *Connectivity* > *Bluetooth* > *Paired devices* > *Options* and one of the following:

*Assign short name*—Give a nickname to the selected device (visible to you only).

*Auto-conn. without conf.*—Select *No* if you want the phone to connect to the selected device automatically or *Yes* if you want the phone to ask for your permission first.

*Delete pairing*—Delete the pairing to the selected device.

*Pair new device*—Search for active devices with Bluetooth technology within range, scroll to the desired device, and select *Pair* to establish pairing with that device. Do not accept Bluetooth connectivity from sources you do not trust.

## Bluetooth connectivity settings

You can define how your phone is shown to other devices with Bluetooth connectivity.

In standby mode, select *Menu > Settings > Connectivity > Bluetooth > Bluetooth settings* and one of the following:

*My phone's visibility*—Select *Shown to all* to show the phone to all other devices with Bluetooth connectivity or *Hidden* to show the phone only to the paired devices. Operating the phone in hidden mode is a safer way to avoid malicious software.

*My phone's name*—Change your phone name that is seen by other users.

## Set up a connection

1. In standby mode, select *Menu > Settings > Connectivity > Bluetooth > On*. The active Bluetooth technology connection is indicated by  at the top of the display.
2. Select *Search for audio enhancements* to search for compatible devices with Bluetooth connectivity. The list of found devices appears in the display.
3. Select the desired device.
4. If required, enter the Bluetooth connectivity pass code of the device to pair with the device.

Your phone connects to the device.  
You can start data transfer.

To view the device you are connected to, select *Menu > Settings > Connectivity > Bluetooth > Active device*.

To deactivate Bluetooth connectivity, select *Menu > Settings > Connectivity > Bluetooth > Off*. Deactivation of the Bluetooth technology connection will not affect other functions of the phone.

### Send data

Instead of using the *Connectivity* menu, you can use other phone menus to send various types of data to other devices with Bluetooth connectivity. For example, you can send a video clip from the *Video clips* folder of the *Gallery* menu. See the appropriate sections of the user guide for information about sending different types of data.

### Receive a data transfer

When a Bluetooth technology connection is active in your phone, you can receive notes, business cards, video clips, and other types of data transfers from another device with Bluetooth connectivity. When you receive a data transfer, an alarm sounds, and a message appears in standby mode.

To view the transferred item immediately from the standby mode, select *Show*. To view the item at a later time, select *Exit*.

Depending on the nature of the item, it is saved in the appropriate menu in your phone. For example, a business card would be saved in *Contacts*, and a calendar note would be saved in *Calendar*.

### Infrared connectivity

You can set up the phone to receive data through its infrared (IR) port. To use an IR connection, transmission and reception must be to or from an IR compatible phone or device.



**Warning:** Do not point the IR beam at anyone's eye or allow it to interfere with other IR devices. This device is a Class 1 laser product.

### Send and receive data



1. Ensure that the IR ports of the sending and receiving devices are pointing at each other and that there are no obstructions between the devices.

The preferable distance between the two devices in an IR connection is from 7.6 centimeters (3 inches) to 0.9 meters (3 feet).

2. To activate IR in your phone, select *Menu > Settings > Connectivity > Infrared*.
3. The user of the other device should activate IR as well.

If data transfer is not started within 2 minutes after the activation of the IR port, the connection is cancelled and must be restarted.

## Connection indicator

- When  is shown continuously, the IR connection is activated and your phone is ready to send or receive data using its IR port.
- When  blinks, your phone is trying to connect to the other device or a connection has been lost.

## Data cable transfer

You can transfer data from your phone to a compatible PC, or from a compatible PC to your phone using a CA-53 USB data cable.



**Important:** Disconnect the USB data cable from the phone to make a call.

## Enable default mode connection

Connect to your PC in *Default mode* to transfer phone data and files between your phone and PC using Nokia's PC Suite.

1. Connect your PC and your phone with a CA-53 USB data cable. A notification appears on the display asking which mode you want to select.
2. Select **OK** > *Default mode*.  
A notification appears on the display stating a connection is active.

You can now use PC Suite to connect to your phone.

## Enable data storage connection

Connect to your PC in *Data storage* mode to transfer music, photo, and video files to the phone miniSD card, and from the phone miniSD to your PC with Windows Explorer.

1. Connect your PC and your phone with a CA-53 USB data cable.  
A notification appears on the display that asking which mode you want to select.
2. Select **OK** > *Data storage*.  
The notification *Data storage mode* displays while the phone is in data transfer mode.
3. Open Windows Explorer.  
Your phone miniSD card will appear as a local drive (named by Nokia 6265), and with a drive letter assigned to it.
4. Click on the folders to display a window that shows the contents of the folder on the phone miniSD card.
5. Open a second instance of Windows Explorer and display on your PC, the contents of the folder where you have stored the MP3 files, photo files, or video files.
6. Select on your PC the files that you wish to transfer to the phone.

7. Drag and drop the files from the second window into the first window and place them in a folder.
8. The files are transferred to the phone and can be played by the *Music player*, or accessed by the *Media player*.

If you select a file or files that require more memory than can fit on the available phone memory, you will get an error note. Deselect some of your selected files until the required memory is less than or equal to the available memory on your phone.

### Disable data storage connection

1. To disable the USB data cable, double-click the green arrow on the task bar at the bottom of your PC screen.

A window pops up that shows Unplug or Eject Hardware.

2. Click on USB Device in the Hardware devices window.

A popup window shows Stop a Hardware device.

3. Highlight USB device, and click OK.

The popup window Safe to Remove Hardware is shown with the message "The 'USB Device' device can now be safely removed from the system".

4. Click OK.



**Important:** To ensure that all memory card operations are completed in a controlled way, do not unplug the connectivity cable until Windows notifies you that it is safe to do so. Uncontrolled completion or unexpected disruptions of the memory card operations may cause the memory card and the information stored on it to become corrupted. A corrupted memory card may have to be formatted before it can be used again. When a memory card is formatted, all information on the card is permanently lost.

### Data and fax transfer

You can make data and fax transfers during a phone call. For more information, see "[Data and fax calls](#)", p. 61.

## ■ Enhancement settings

The *Enhancement settings* menu displays the hearing aid compliant option by default, and shows other options only if the phone is or has been connected to a compatible enhancement type.

## Headset

In standby mode, select *Menu* > *Settings* > *Enhancements* > *Headset* and one of the following:

*Default profile*—Choose the profile you wish to be automatically activated when a headset is connected.

*Automatic answer*—Calls are answered automatically after one ring when a headset is connected. Select *On* or *Off*.



**Note:** Automatic answer will only be active whilst "*General*" profile is active

## Handsfree

In standby mode, select *Menu* > *Settings* > *Enhancements* > *Handsfree* and one of the following:

*Default profile*—Choose the profile you wish to be automatically activated when a car kit is connected.

*Automatic answer*—Calls are answered automatically after one ring when a car kit is connected. Select *On* or *Off*.



**Note:** Automatic answer will only be active whilst "*General*" profile is active

*Lights*—Choose to keep the phone lights always on, or to shut off automatically after several seconds. Select *On* or *Automatic*.

## Loopset

A LPS-4 Loopset accessory allows your device to optimise sound quality when coupled with a hearing aid that is set to T-coil mode.

In standby mode, select *Menu* > *Settings* > *Enhancements* > *Loopset* > *Use Loopset* > *Yes* or *No*.

If the *Loopset* is connected and recognised through the Pop-Port™ connector, the phone automatically uses the *Loopset*.

## Charger

In standby mode, select *Menu* > *Settings* > *Enhancements* > *Charger* and one of the following:

*Default profile*—Select the profile you want to automatically activate when your phone is connected to the charger.

*Lights*—Select *On* or *Automatic* to keep the phone lights always on or to shut off automatically after several seconds.

## Hearing aid

To optimise sound quality, you can set your phone to couple to a T-coil-equipped hearing aid.

In standby mode, select *Menu* > *Settings* > *Enhancements* > *Hearing aid* > *T-coil hearing aid mode*. Select *On* to activate the HAC.

Verify that the hearing aid is set to T-coil mode, and hold the phone against the ear.

Only activate the *T-coil hearing aid mode* when using your device with a hearing aid or it may impact the audio performance of the device.

## ■ Security

To access *Security* for the first time, you must enter the preset lock code. By default, the preset lock code is the last four digits of your phone number. Depending on your wireless service provider or network operator, the preset lock code may be a four digit number such as 1234 or 0000. If none of these work, contact your wireless service provider or network operator for help.

## Phone lock

The phone lock feature protects your phone from unauthorised outgoing calls or unauthorised access to information stored in the phone. When phone lock is activated, *Phone locked* is displayed each time you turn your phone on.

When the device is locked, you can still call the official emergency number programmed into your phone.

1. In standby mode, select *Menu > Settings > Security*.

2. Enter the lock code, and select *OK*.
3. Select *Phone lock* and one of the following:

*Off*—Immediately turns off the phone lock feature.

*Lock now*—Immediately turns on the phone lock feature.

*On power-up*—Turns on the phone lock feature the next time you turn the phone on.

If you select *Lock now*, you must enter your lock code before the phone will function normally. After the lock code is accepted, your phone functions normally.

*Call not allowed* appears if you attempt to place a call while your phone is locked.

To answer a call with phone lock on, select *Answer*, or press the call key.

## Allowed number if lock active

With phone lock on, the only outgoing calls you can make are to the emergency number programmed into your phone (for example, 000, 111, or 911) and the numbers stored in the *Allowed no. if lock active* location.

1. In standby mode, select *Menu > Settings > Security*.
2. Enter the lock code, and select *OK*.

3. Select *Allowed no. if lock active > Assign*.
4. Enter the phone number, or select *Search* to retrieve the number from the phone book; select *OK*.

To place a call to an allowed number when the phone is locked, enter the allowed number and press the call key.

## Change lock code

When changing the lock code, avoid using codes similar to emergency numbers such as 000, 111, or 911 to prevent accidental dialling of an emergency number.

By default, the preset lock code is the last four digits of your phone number. Depending on your wireless service provider or network operator, the preset lock code may be a four-digit number such as 1234 or 0000. If none of these work, contact your wireless service provider or network operator for help.

If you enter an incorrect lock code five times in a row, your phone may ask you for the security code. By default, the security code is the five-digit number, 12345.



**Note:** If you enter the wrong lock code five times in succession, your phone will not accept your current lock code for 5 minutes. This occurs even if when you power down the phone between incorrect attempts.

To change the phone lock code, do the following:

1. In standby mode, select *Menu > Settings > Security*.
2. Enter the current lock code, and select *OK*.
3. Select *Change lock code*.
4. Enter the new lock code (only 4 characters), and select *OK*.
5. Enter the new lock code again for verification, and select *OK*.

When you change your lock code, make sure to remember it. If necessary, write it down and store it in a safe place away from your phone. Avoid entering a lock code similar to emergency numbers to prevent accidental emergency calls.

## Call restrictions

*Call restrictions* allows you to block or allow numbers for incoming or outgoing calls.

1. In standby mode, select *Menu* > *Settings* > *Security*.
2. Enter the lock code, and select *OK*.
3. Select *Call restrictions* and the type of calls you wish to restrict:
  - Restrict outgoing calls*—Set restrictions on making calls.
  - Restrict incoming calls*—Set restrictions on receiving calls.
4. Select whether to block or allow numbers:
  - Blocked numbers*—Set numbers that are blocked on incoming calls, allowing all other numbers. When a number is blocked, the call is sent to voice mail.
  - Allowed numbers*—Set numbers that are allowed, blocking all other numbers.
5. To modify the restriction list, select from the following options:
  - Select*—Add numbers to the restriction list.
  - Add restriction*—Add a restriction to a number (unavailable if memory is full).
  - Edit*—Edit a restriction on a number.

*Delete*—Delete a number from restriction list.

When calls are restricted, calls may be possible to the official emergency number programmed into your device.

## Voice privacy

*Voice privacy* is a network service, and its function depends on a variety of services. Contact your service provider for more information.

If your wireless service provider or network operator supports this feature, the voice privacy feature protects the privacy of your current phone conversation from other callers placing phone calls on your same network.

1. In standby mode, select *Menu* > *Settings* > *Security*.
2. Enter the lock code, and select *OK*.
3. Select *Voice privacy* > *On* or *Off*.

## Application settings

The *Application settings* menu changes game and application settings.

In standby mode, select *Menu* > *Settings* > *Application settings* and one of the following:

*Application sounds* > *On* or *Off*—Play sounds during an application.

*Application lights* > *Application defined* or *Default*—Play lights during an application.

*Application vibration > On or Off*—Vibrate phone during an application.

## ■ Network

The menu options you see in your phone are based on your service provider's network. The network determines which options actually appear in the phone menu. Check with your service provider for more information.

The *Network* menu personalises the way your phone chooses a network in which to operate while you are within or outside of your primary or home system. Your phone is set to search for the most cost-effective network. If your phone cannot find a preferred network, it selects a network automatically based on the option you choose in the *Network* menu.

## Roaming options

If supported by your wireless service provider or network operator, you can select which roaming option you wish to use. In standby mode, select *Menu > Settings > Network > Roaming options* and the following:

*Automatic*—The phone automatically searches for service in another digital network. If one is not found, the phone uses analog service. The roaming rate applies when not in the home service area.

## Mode

If supported by your wireless service provider or network operator, you can choose whether your phone will use digital or analog service. In standby mode, select *Menu > Settings > Network > Mode* and the following.

*Digital only*—You can make and receive calls on a digital network only.

## ■ Network services

The following features are network services. See also "*Network Services*", p. ix.

## Store a feature code

*Network feature setting* allows you to activate network services in your phone using feature codes received from your service provider.

1. In standby mode, select *Menu > Settings > Network services > Network feature setting*.
2. Enter the feature code from your service provider (for example, \*900 for activating *Divert if busy*), and select *OK*.
3. Select *Call divert*.
4. Scroll to the type of forwarding that matches the feature code you entered (for example, *Divert if busy*), select *Activate*.

The activated feature code is now stored in your phone, and you are returned to the *Feature code*: prompt. Continue entering other feature codes (for example, \*900 to cancel *Divert if busy*), or press the end key to return to standby mode.

When you enter a network feature code successfully the feature becomes visible in the *Network services* menu.

### Call divert

*Call divert* tells your network to redirect incoming calls to another number. *Call divert* is a network service and may not work the same in all networks, so contact your wireless provider for availability and information.

To activate, do the following:

1. In standby mode, select *Menu* > *Settings* > *Network services* > *Call divert* and the following:  
*Divert all calls*—Forward all calls to the number you specify.
2. Select *Activate*.
3. Enter the number to which your calls, data, or other information are forwarded, and select *OK*.

To cancel, in standby mode, select *Menu* > *Settings* > *Network services* > *Call divert* > *Cancel all call diverting*. *Cancel all call diverting* may affect your ability to receive voice mail

messages. Contact your wireless provider for specific details.

### Restore factory settings

You can reset some of the menu settings to their original values. Data that you have entered or downloaded is not deleted (for example, entries in your contacts list are not affected).

1. In standby mode, select *Menu* > *Settings* > *Restore factory sett.*
2. Enter the lock code, and select *OK*.



**Note:** Depending on your wireless service provider or network operator, your device may request the security code (defaulted to 12345) instead of the lock code.

### Phone details

You can view the current details of your phone. In standby mode, select *Menu* > *Settings* > *Phone details* and one of the following options:

*User details*—Show the phone's current number details.

*Version details*—Show the hardware, software and browser version information for the phone.

*System details*—Show the digital network the phone is on.

*Icon details*—Show the icons used.

# 11. Organiser



Your phone contains features to help organise your everyday life, including an alarm clock, calendar, calculator, countdown timer, and stopwatch.

## ■ Alarm clock

### Set an alarm

The alarm clock is based on the phone clock. It sounds an alert any time you specify and even works if the phone is turned off.

1. In standby mode, select *Menu* > *Organiser* > *Alarm clock* > *Alarm time*.
2. Enter the time for the alarm in hh:mm format, and select *OK*.
3. Select *am* or *pm* if 12-hour clock format is on.

*Alarm on* appears briefly in the display, and  appears in standby mode.

If you need to reset the alarm select *Menu* > *Organiser* > *Alarm clock* > *Alarm time* > *On* from standby mode.

To turn off the alarm, select *Menu* > *Organiser* > *Alarm clock* > *Alarm time* > *Off* from standby mode.

### Repeat alarm

You can set the alarm to repeat every day or only on certain days of the week.

1. In standby mode, select *Menu* > *Organiser* > *Alarm clock* > *Repeat alarm* > *On*.
2. Check the day or days of the week you wish to repeat the alarm, and select *Mark*. Select *Unmark* to remove a day.
3. Select *Done* when you have added all desired days.

If you need to revise the days for a repeated alarm, select *Menu* > *Organiser* > *Alarm clock* > *Repeat alarm* > *Repetition days* from standby mode.

If you need to stop a repeated alarm, select *Menu* > *Organiser* > *Alarm clock* > *Repeat alarm* > *Off* in standby mode.

### Set the alarm tone

You can set which tone is played when the alarm sounds.

In standby mode, select *Menu* > *Organiser* > *Alarm clock* > *Alarm tone* and one of the following:

*Standard*—Select the default alarm.

*Radio*—Select the radio as the alarm.

*Open Gallery*—Select a tone from the *Gallery* as the alarm.

## Set the snooze time-out

You can set the *Snooze time-out* for the alarm.

In standby mode, select *Menu* > *Organiser* > *Alarm clock* > *Snooze time-out* and choose a snooze time.

When the alarm sounds, your phone beeps, vibrates (if vibrate alert is on in the currently active profile), and lights up.

With the phone on, select *Stop* to shut the alarm off or *Snooze*. If you select *Snooze*, the alarm stops for 10 minutes.

If you do not press a key, the alarm stops (snoozes) for the *Snooze time-out*, then sounds again.

If the alarm time is reached while the phone is switched off, the phone switches itself on and starts sounding the alarm tone. If you select *Stop*, the device asks whether you want to activate the phone for calls. Select *No* to switch off the device or *Yes* to make and receive calls. Do not select *Yes* when wireless phone use may cause interference or danger.

## Turn an alarm off

In standby mode, select *Menu* > *Organiser* > *Alarm clock* > *Alarm time* > *Off*.

## Calendar

The calendar keeps track of reminders, calls you need to make, meetings, memos, and birthdays. It can even sound an alarm for any of these events.

Monthly view provides an overview of the selected month and weeks.

You can also jump to a specific date. Any days or dates that appear in bold font contain calendar notes such as a meeting or reminder. A short summary of notes for the day appears at the bottom of the screen.

## Open calendar

In standby mode, select *Menu* > *Organiser* > *Calendar*.

Scroll to move the cursor in the calendar view.

## Calendar options

In standby mode, select *Menu* > *Organiser* > *Calendar* > *Options* and one of the following:

*Week view*—View your calendar by weeks. To return to month view select *Back*, while in the *Week view*.

**Make a note**—Create a note on the selected date.

**Go to date**—Jump to a specific date. Enter the date (for example, 15/07/2005), and select **OK**.

**Go to today**—Jump to the current date.

**Settings**—Modify the calendar settings.

**Go to to-do list**—Go directly to your to-do list.

**Delete all notes**—Delete all calendar notes.

## Make a calendar note

You can make a calendar note for a specific date. You can choose from five types of notes. Your phone asks for further information depending on which note you select. You can also set an alarm for your note.

1. In standby mode, select **Menu** > **Organiser** > **Calendar**.
2. Highlight the date for which you want to make a note. Scroll or select **Options** > **Go to date**.
3. Select **Options** > **Make a note** and one of the following:

**Meeting**—Enter the subject, and select **Save**. Enter a location, and select **Save**. Enter a start and end time. Choose an alarm option.

**Call**—Enter the phone number, and select **Save**. Enter a name, and select **Save**. Enter a time. Choose an alarm option. You can also select **Options** > **Search** to search your contacts.

**Birthday**—Enter the person's name, and select **Save**. Enter the year of birth. Choose an alarm option.

**Memo**—Enter the subject, and select **Save**. Enter a start and end date. Choose an alarm option.

**Reminder**—Enter the reminder, and select **Save**. Choose an alarm option.

## View calendar notes (day view)

You can view the calendar notes for a day.

1. In standby mode, select **Menu** > **Organiser** > **Calendar**.
2. Scroll to the date you want to view or select **Options** > **Go to date**. Days with notes appear in bold type.
3. Select **View** to see the list of notes for that day.

To view a specific note, highlight the note, and select **View** again. If there are no notes for that date, select **Add** to create a new calendar note.

## Options while viewing a day

When viewing a day's list of note, you can highlight a note, select *Options* and one of the following:

*Make a note*—Create a new note for the selected date.

*Delete*—Delete the note.

*Edit*—Edit the note.

*Use detail*—Use a detail contained in the note.

*Move*—Move the note to another date on your calendar.

*Repeat*—Enable the note to recur on a regular basis (daily, weekly, biweekly, monthly, and yearly). *Repeat* is not available for *Birthday* note.

*Go to date*—Jump to another date on your calendar.

*Go to today*—Return to the current date.

*Send note > Send as message, Via calendar, Via infrared, or Via*

*Bluetooth*—Send a calendar note in calendar format (vCal), in a text message, in a multimedia message, or directly to another device.

*Copy*—Copy the note. You can paste the note to another date.

*Settings*—Modify the calendar settings.

*Go to to-do list*—Go directly to your to-do list.

## Send a calendar note

1. In standby mode, select *Menu > Organiser > Calendar*.
2. Highlight the note you wish to send, and select *Options > Send note > Send as message, Via calendar, Via infrared, or Via Bluetooth* to send the calendar note in calendar format (vCal), in a text message, in a multimedia message, or directly to another device.

## Receive a note in calendar format (vCal)

When you receive a calendar note in calendar-to-calendar format (vCal), your phone displays *Calendar note received*.

Select *Show* to view the calendar note.

Select *Save* to save the note to your calendar or *Options > Discard* to discard the note.

## Modify calendar settings

In standby mode, select *Menu > Organiser > Calendar > Options > Settings* and one of the following:

*Set the date*—Enter the current date, and select *OK*.

*Set the time*—Enter the current time, and select *OK*.

*Time zone*—Select your current time zone.

*Date format*—Select your preferred date format.

*Date separator*—Select your preferred date separator.

*Time format*—Select your preferred time format.

*Default view*—Select a monthly or weekly view.

*Week starts*—Select the day the week starts.

*Auto-delete notes*—Select when to delete past notes.

## ■ Notes

You can write text notes with the *Notes*. You can also send notes using text message, IR, or Bluetooth connectivity.

## Open notes

In standby mode, select *Menu > Organiser > Notes*. You see your current list of notes.

If there are no notes, select *Add* to create your first note. If there are existing notes, highlight a note, and select *View*.

## Make a note

### Initial note

In standby mode, select *Menu > Organiser > Notes > Add*. Create your note, and select *Save*.

## Additional notes

In standby mode, select *Menu > Organiser > Notes > Options > Make a note*. Create your note, and select *Save*.

## Create note options

When you create a note, the following options are available:

*Insert time and date*—Add the time and date to your note.

*Close*—Return you to the notes list.

*Insert smiley*—Insert a smiley into your message.

*Insert word* or *Edit word*—Enter or edit the text of a new word that might not appear in the predictive text dictionary. Option only appears when predictive text is on.

*Insert symbol*—Inserts a special character into your message. Option only appears when predictive text is on.

*Dictionary on* or *Dictionary off*—Turn predictive text on or off.

*Matches*—View matches found in the predictive text dictionary for the word you want to use. This displays only when predictive text is on.

## Send a note

1. In standby mode, select *Menu* > *Organiser* > *Notes*.
2. Highlight the note you wish to send, and select *Options* > *Send note* > *Send as message*, *Via infrared*, or *Via Bluetooth* to send the note in a text message, in a multimedia message, or directly to another device.

## Notes options

In standby mode, select *Menu* > *Organiser* > *Notes* > *Options* and one of the following:

*Make a note*—Create a new note.

*Delete*—Delete the note you selected.

*Edit*—Edit the note you selected.

*Use detail*—Use a detail contained in the note.

*Send note* > *Send as message*, *Via infrared*, or *Via Bluetooth*—Send a note in a text message, in a multimedia message, or directly to another device.

*Delete all notes*—Delete all notes.

The note options appear only when you have created one or more notes.

## To-do list

Use the *To-do list* feature to keep track of your tasks. You can save a task or errand as a to-do list note, select a priority level for the to-do list note, and mark it as done when you have completed it. You can sort the to-do list notes by priority or by date.

## Open to-do list

In standby mode, select *Menu* > *Organiser* > *To-do list*. You see your current to-do list.

If there are no to-do tasks, select *Add* to create your first to-do list note.

If there are existing to-do list notes, highlight a to-do list note, and select *View*.

## Make a to-do list note

### Initial to-do list note

In standby mode, select *Menu* > *Organiser* > *To-do list* > *Add*. Enter the subject, and select *Save* > *High*, *Medium*, or *Low*.

### Additional to-do list notes

In standby mode, select *Menu* > *Organiser* > *To-do list* > *Options* > *Add*. Enter the subject, and select *Save* > *High*, *Medium*, or *Low*.

## Create to-do list note options

When you create a to-do list note, the following options are available:

*Insert smiley*—Insert a smiley into your message.

*Insert word* or *Edit word*—Enter or edit the text of a new word that might not appear in the predictive text dictionary. This displays only when predictive text is on.

*Insert symbol*—Insert a special character into your message. This displays only when predictive text is on.

*Writing language*—Choose the language you want to use.

*Dictionary on* or *Dictionary off*—Turn predictive text on or off.

*Matches*—View matches found in the predictive text dictionary for the word you want to use. This displays only when predictive text is on.

## Edit to-do list notes

In standby mode, select *Menu > Organiser > To-do list > View > Edit*. Edit the subject, select *Save*.

## View to-do list notes

In standby mode, select *Menu > Organiser > To-do list > View*.

*Deadline*—Change the deadline of the to-do list note.

*Mark note as done* or *Mark as not done*—Indicate whether the to-do list note is completed or not.

*Delete*—Delete the to-do list note.

*Use detail*—Use a detail contained in the note.

*Edit priority*—Change the priority to *High*, *Medium*, or *Low*.

*Send > Send as message*, *Via calendar*, *Via infrared*, or *Via Bluetooth*—Send the to-do list note in calendar format (vCal), in a text message, in a multimedia message, or directly to another device.

*Go to calendar*—Leave the to-do list, and go to the calendar.

*Save to calendar*—Save the to-do list note to your calendar.

## Send a to-do list note

1. In standby mode, select *Menu > Organiser > To-do list*.
2. Highlight the note you wish to send, and select *Options > Send > Send as message*, *Via calendar*, *Via infrared*, or *Via Bluetooth* to send the to-do list note in calendar format (vCal), in a text message,

in a multimedia message, or directly to another device.

## To-do list options

In standby mode, select *Menu* > *Organiser* > *To-do list* > *Options* and one of the following:

*Add*—Create a new to-do list note.

*Delete*—Delete the to-do list note you selected.

*Mark note as done* or *Mark as not done*—Indicate whether the to-do list note is completed or not.

*Use detail*—Use a detail contained in the note.

*Sort by deadline* or *Sort by priority*—Sort the to-do list by either date or priority.

*Send* > *Send as message*, *Via calendar*, *Via infrared*, or *Via Bluetooth*—Send the to-do list note in calendar format (vCal), in a text message, in a multimedia message, or directly to another device.

*Go to calendar*—Leave the to-do list, and go to the calendar.

*Save to calendar*—Save the to-do list note you selected to your calendar.

*Delete done notes*—Delete the to-do list note you selected to your calendar.

*Delete all notes*—Delete all to-do list notes.

The to-do list options appear only when you have created one or more notes.

## Calculator

The calculator in your phone adds, subtracts, multiplies, divides, calculates the square and the square root, changes the sign of the number entered, and converts currency values.



**Note:** This calculator has a limited accuracy and is designed for simple calculations.

## Use calculator

1. In standby mode, select *Menu* > *Organiser* > *Calculator*.

2. Enter the first number in the calculation.

Press # for a decimal point if necessary.

Press the scroll key up or down to change the sign of your number or value.

Press \* to cycle through the add (+), subtract (-), multiply (\*), and divide (/) characters. Pause briefly to select the displayed character.

3. Enter the second number in your calculation.

4. Select *Equals*.

To perform a square or square root calculation, select *Options* > *Square* or *Square root*.

## Currency converter

You can convert foreign currency to domestic, or vice versa, directly from standby mode or from the *Calculator* menu.



**Note:** When you change base currency, you must enter the new rates because all previously set exchange rates are set to zero.

1. In standby mode, select *Menu* > *Organiser* > *Calculator* > *Options* > *Exchange rate* > *Foreign units in domestic* or *Domestic units in foreign*.

*Foreign units in domestic*—The number of home units it takes to make one unit of foreign currency.

*Domestic units in foreign*—The number of foreign units it takes to make one unit of your home currency.

2. Enter the exchange rate (press # to insert a decimal), and select *OK*.
3. Select *Back* to return to the *Calculator* screen, and enter the currency amount to convert.
4. Select *Options* > *In domestic* or *In foreign*.

*In domestic*—converts foreign currency to domestic currency.

*In foreign*—converts domestic currency to foreign currency.

5. If you have not already entered an exchange rate, the device prompts you to enter it. Select *OK*. You can edit the exchange rate at any time.

## Countdown timer

The countdown timer in your device enables you to enter a specific time (up to 99 hours, 59 minutes, and 59 seconds). When the time runs out, your device sounds an alarm.

The countdown timer only works when the phone is on. Once you turn off your phone, the timer is no longer active.

## Set the normal timer

1. In standby mode, select *Menu* > *Organiser* > *Countdown timer*.
2. Enter the time (in hh:mm:ss format), and select *OK*.
3. Enter a note for the timer, and select *Start*.



and the timer (in hh:mm:ss format) appear in standby mode when the countdown timer is running.

When the time runs out, your phone sounds an alarm, vibrates, and flashes its lights. If you are in standby mode, select *Restart* or *Exit*. If you are not in

standby mode, press any key during the alarm to stop the timer.

After 60 seconds the timer alert expires automatically. Select *Exit* or press the end key to clear the timer note.

## Change the timer

After you have set a timer, you can change the time.

1. In standby mode, select *Menu > Organiser > Countdown timer > Change time*.
2. Enter the new time, and select *OK*.
3. Leave the note as it was, or enter a new note, and select *Start*.

## Stop the timer before the alarm sounds

After you have set the timer, you can stop the timer.

In standby mode, select *Menu > Organiser > Countdown timer > Stop timer*.

## ■ Stopwatch

Your phone has a stopwatch that can be used to track time. The stopwatch displays time in hours, minutes, seconds, and fractions of a second in hh:mm:ss.ss format.

Using the stopwatch or allowing it to run in the background when using

other features increases the demand on battery power and reduces battery life.

## Measure split or lap time

Use the split time or lap time functions for activities where you need to pace yourself.

1. In standby mode, select *Menu > Organiser > Stopwatch > Split timing* or *Lap timing > Start*.  
*Split timing*—Use the split time function for such activities as a long distance race when you need to pace yourself. Select *Split* to note the lapsed time. The timer continues to run and the split time appears below the running time. Each time you select *Split*, the new measured time appears at the beginning of the list. The maximum number of splits is 20.  
*Lap timing*—Use the lap time function when you want to track how long it takes to complete each cycle or lap. Select *Lap* to note the lap time. The clock stops, then immediately restarts from zero. The lap time appears below the running time. Each time you select *Lap*, the new measured time appears at the beginning of the list. The maximum number of laps is 20.
2. Select *Stop* to end timing and display total time.

## Save a time

To save a time while the clock is running, select *Stop* > *Save*, enter a name for the measurement, and select *OK*. If you do not enter a name, the total time is used as the default title for the lap or split time.

## Stopwatch options

In standby mode, select *Menu* > *Organiser* > *Stopwatch* and one of the following:

*Continue*—Continues to measure time. Only appears if clock is running and you are returning to stopwatch screen.

*Show last time*—View the last measured time.

*Split timing*—Use the split time function.

*Lap timing*—Use the lap time function.

*View times*—Browse saved times.

*Delete times* > *One by one* or *Delete all*—Delete saved times.

## Operation note

If you press the end key and return to standby mode, the clock continues to run in the background, and  appears at the top of the screen.

To return to the *Stopwatch* screen, do the following:

1. In standby mode, select *Menu* > *Organiser* > *Stopwatch* > *Continue*.
2. To stop the clock, select *Stop*.

## 12. Mobile web



*Mobile web* is a network service.

See “[Network Services](#)”, p. ix, for more information.

Your phone has a built-in browser you can use to connect to selected services on the mobile Internet. If your wireless service provider or network operator supports this feature, you can view weather reports, check news or flight times, view financial information, and much more. The Web browser on your phone can display WAP-based content.

Your device may have some bookmarks loaded for sites not affiliated with Nokia. Nokia does not warrant or endorse these sites. If you choose to access them, you should take the same precautions, for security or content, as you would with any Internet site.

If the security indicator () is displayed during a connection, the data transmission between the device and the Internet gateway or server is encrypted. The service provider secures the data transmission between the gateway and the content server.



**Important:** Use only services that you trust and that offer adequate security and protection against harmful software.

### ■ Mobile Internet access

Because mobile Internet content is designed to be viewed from your phone, your wireless provider is now your mobile Internet service provider as well.

Your wireless provider has created a home page and set up your browser to go to this page when you log on to the mobile Internet. Once at your service provider's home page, you may find links to a number of other sites.

It should not be necessary to manually configure the browser on your phone. Normally this is done by your wireless provider when you subscribe to the feature. Contact your wireless provider if you have problems using the browser.

## ■ Sign on to the mobile Internet

In standby mode, select *Menu* > *Mobile web*.

After a brief pause, your phone attempts to connect to your wireless provider's home page. If you receive an error message, your phone may not be set up for browsing. Contact your wireless provider to make sure that your phone is configured properly.

## ■ Navigate the mobile Internet

Since your phone screen is much smaller than a computer screen, mobile Internet content is displayed differently than you may be accustomed to seeing. This section contains guidelines for using phone keys to navigate a WAP site.

### Phone keys

- To browse the WAP site, scroll up or down.
- Select a highlighted item.
- To enter text, press # to switch text input modes, and then press 0-9.
- To enter special characters, press \*.

## Receive a call while online

Depending on your wireless service provider or network operator, you may still be able to receive a voice call while using the WAP browser.

- To answer the incoming call, press the call key.
- To reject the incoming call, press the end key.

After you end your voice call, the mobile Internet connection automatically resumes.

If your wireless service provider or network operator does not support incoming calls while browsing, incoming calls are automatically forwarded to voice mail.

## Make an emergency call while online

You can end your data connection and make an emergency call.

1. To close your mobile Internet connection, press the end key.
2. Press the end key as many times as needed to clear the display and ready the phone for calls.
3. Enter the emergency number for your present location (for example, 000, 111, or 911). Emergency numbers vary by location.
4. Press the call key.

## Clear the cache and disconnect

A cache is a memory location that is used to store data temporarily. If you have tried to access or have accessed confidential information requiring passwords, empty the cache after each use. The information or services you have accessed are stored in the cache.

To empty the cache while in the browser menu, select Navigate > Advanced > Clear. Highlight and select Cache > Clear. The cache also clears when you press and hold the end key to power off your device.

To close your mobile Internet connection while browsing, press the end key.

## 13. Extras



### ■ Games

#### Select games

In standby mode, select *Menu* > *Extras* > *Games* to display the games on your device.

#### Memory status

You can view the memory available for game installations. In standby mode, select *Menu* > *Extras* > *Games* > *Options* > *Memory status*.



**Note:** Only install applications from sources that offer adequate protection against harmful software.

#### Memory status

You can view the memory available for application installations. In standby mode, select *Menu* > *Extras* > *Collection* > *Options* > *Memory status*.

### ■ Collection

#### Select application

In standby mode, select *Menu* > *Extras* > *Collection* > Select application. Scroll to an application and select Open, or press the call key.

An application may require a few seconds to load. When you open an application, wait for the launch screen to disappear. At that point, the application is ready.

Leaving applications running in the background increases the demand on battery power and reduces the battery life.

## 14. PC connectivity

### ■ PC data transfer

You can transfer data, such as music, photos, and videos, from your device to a compatible PC or from a compatible PC to your device using Bluetooth connectivity. For more information, see "[Bluetooth connectivity](#)", p. 65.

You can transfer data, such as music, photos, and videos, from your device to a compatible PC or from a compatible PC to your device using an IR connection. For more information, see "[Infrared connectivity](#)", p. 68.

### ■ Nokia PC Suite

Nokia PC Suite software is available for this phone. Nokia PC Suite is a collection of powerful tools that you can use to manage your phone features and data. Each component is a separate program that includes online helps.

Nokia PC Suite software, installation instructions, and other documentation is provided free of charge and can be downloaded from the software downloads of the Nokia web site: [www.nokia-asia.com/pcsuite](http://www.nokia-asia.com/pcsuite).

Some of the features in your phone require network support. Contact your service provider for availability and configuration instructions.

## 15. Enhancements



Check the model number of any charger before use with this device. This device is intended for use when supplied with power from the AC-3 or AC-4 charger.



**Warning:** Use only batteries, chargers and enhancements approved by Nokia for use with this particular model.

The use of any other types may invalidate any approval or warranty, and may be dangerous.

For availability of approved enhancements, please check with your dealer. When you disconnect the power cord of any enhancement, grasp and pull the plug, not the cord

A few practical rules about accessories and enhancements:

- Keep all accessories and enhancements out of the reach of small children.
- When you disconnect the power cord of any accessory or enhancement, grasp and pull the plug, not the cord.

- Check regularly that enhancements installed in a vehicle are mounted and are operating properly.
- Installation of any complex car enhancements must be made by qualified personnel only.

### Power

- Standard 1150 mAh Li-Ion Battery (BL-6C)
- Compact Charger (AC-3)
- Travel Charger (AC-4)
- Mobile Charger (DC-4)
- Charger Adapter (CA-44)

Use the CA-44 charger adapter to connect the phone with Nokia chargers with a larger barrel size, including ACP-7, ACP-8, ACP-9, ACP-12, AC-1 (retractable charger), and LCH-12 (mobile charger).

### USB data cable

- Connectivity Cable (CA-53)

### Handsfree

- Headrest Handsfree (BHF-3)
- CDMA Headrest Handsfree (BHF-4)
- Easy to Use Car Handsfree (HF-3)
- Advanced Plug-in Car Handsfree (HF-6)
- Wireless Plug-in Car Handsfree (HF-6W)

### Headsets

- Mono Headsets (HDB-4, HS-5, HS-6, HS-8, HS-9)
- Stereo Headsets (HDS-3, HS-3, HS-23)
- Wireless Mono Headsets (HDW-3, HS-4W, HS-11W, HS-21W, HS-36W, HS-37W)
- Wireless Image Headsets (HS-13W)
- Wireless Stereo Headsets (HS-12W)

### Miscellaneous

- Inductive Loopset (LPS-4)
- TTY Adapter (HDA-10)
- Advanced Car Kit (CK-1W)
- Wireless Car Kit (CK-7W)
- Digital Pen (SU-1B)
- Audio Adapter (AD-15)
- Music Stand (MD-1)

## 16. Reference information

This section provides information about your phone batteries, enhancements, chargers, safety guidelines, and technical information. Be aware that the information in this section is subject to change as batteries, chargers, and enhancements change.

### ■ Batteries and chargers

Your device is powered by a rechargeable battery. The full performance of a new battery is achieved only after two or three complete charge and discharge cycles. The battery can be charged and discharged hundreds of times, but it will eventually wear out. When the talk and standby times are noticeably shorter than normal, replace the battery. Use only Nokia approved batteries, and recharge your battery only with Nokia approved chargers designated for this device.

If a replacement battery is being used for the first time or if the battery has not been used for a prolonged period, it may be necessary to connect the charger and then disconnect and reconnect it to start the charging.

Unplug the charger from the electrical plug and the device when not in use. Do not leave fully charged battery connected to a charger, since overcharging may shorten its lifetime. If left unused, a fully charged battery will lose its charge over time.

If the battery is completely discharged, it may take a few minutes before the charging indicator appears on the display or before any calls can be made.

Use the battery only for its intended purpose. Never use any charger or battery that is damaged.

Do not short-circuit the battery. Accidental short-circuiting can occur when a metallic object such as a coin, clip, or pen causes direct connection of the positive (+) and negative (-) terminals of the battery. (These look like metal strips on the battery.) This might happen, for example, when you carry a spare battery in your pocket or purse. Short-circuiting the terminals may damage the battery or the connecting object.

Leaving the battery in hot or cold places, such as in a closed car in summer or winter conditions, will reduce the capacity and lifetime of the battery. Always try to keep the battery

between 15°C and 25°C (59°F and 77°F). A device with a hot or cold battery may not work temporarily, even when the battery is fully charged. Battery performance is particularly limited in temperatures well below freezing.

Do not dispose of batteries in a fire as they may explode. Batteries may also explode if damaged. Dispose of batteries according to local regulations. Please recycle when possible. Do not dispose as household waste.

### **Nokia battery authentication guidelines**

Always use original Nokia batteries for your safety. To check that you are getting an original Nokia battery, purchase it from an authorised Nokia dealer, look for the Nokia Original Enhancements logo on the packaging and inspect the hologram label using the following steps:

Successful completion of the four steps is not a total assurance of the authenticity of the battery. If you have any reason to believe that your battery is not an authentic original Nokia battery, you should refrain from using it, and take it to the nearest authorised Nokia service point or dealer for assistance. Your authorised Nokia

service point or dealer will inspect the battery for authenticity. If authenticity cannot be verified, return the battery to the place of purchase.

### **Authenticate hologram**

1. When looking at the hologram on the label, you should see the Nokia connecting hands symbol from one angle and the Nokia Original Enhancements logo when looking from another angle.



2. When you angle the hologram left, right, down, and up, you should see 1, 2, 3, and 4 dots on each side respectively.



3. Scratch the side of the label to reveal a 20-digit code, for example, 12345678919876543210. Turn the battery so that the numbers are facing upwards. The 20-digit code reads starting from the number at the top row followed by the bottom row.

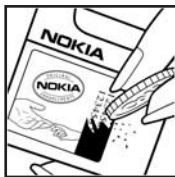

4. Confirm that the 20-digit code is valid by following the instructions at [www.nokiaoriginals.com/check](http://www.nokiaoriginals.com/check).



To create a text message enter the 20-digit code, for example, 12345678919876543210, and send to +44 7786 200276.

To create a text message,

- For countries in Asia Pacific, excluding India: Enter the 20-digit code, for example, 12345678919876543210, and send to +61 427151515.
- For India only: Enter Battery followed by the 20-digit battery code, for example, Battery 12345678919876543210, and send to 5555.

National and international operator charges will apply.

You should receive a message indicating whether the code can be authenticated.

If you need assistance confirming the battery code, contact your local Nokia Care Centres listed at [www.nokia-asia.com/carecentrelocator](http://www.nokia-asia.com/carecentrelocator).

What if your battery is not authentic?

If you cannot confirm that your Nokia battery with the hologram on the label is an authentic Nokia battery, please do not use the battery. Take it to the nearest authorised Nokia service point or dealer for assistance. The use of a battery that is not approved by the manufacturer may be dangerous and may result in poor performance and damage to your device and its enhancements. It may also invalidate any approval or warranty applying to the device.

To find out more about original Nokia batteries, visit [www.nokiaoriginals.com/battery](http://www.nokiaoriginals.com/battery).

## 17. Care and maintenance

Your device is a product of superior design and craftsmanship and should be treated with care. The suggestions below will help you protect your warranty coverage.

- Keep the device dry. Precipitation, humidity and all types of liquids or moisture can contain minerals that will corrode electronic circuits. If your device does get wet, remove the battery and allow the device to dry completely before replacing it.
- Do not use or store the device in dusty, dirty areas. Its moving parts and electronic components can be damaged.
- Do not store the device in hot areas. High temperatures can shorten the life of electronic devices, damage batteries, and warp or melt certain plastics.
- Do not store the device in cold areas. When the device returns to its normal temperature, moisture can form inside the device and damage electronic circuit boards.
- Do not attempt to open the device other than as instructed in this guide.
- Do not drop, knock, or shake the device. Rough handling can break internal circuit boards and fine mechanics.

- Do not use harsh chemicals, cleaning solvents, or strong detergents to clean the device.
- Do not paint the device. Paint can clog the moving parts and prevent proper operation.
- Use a soft, clean, dry cloth to clean any lenses, such as camera, proximity sensor, and light sensor lenses.
- Use only the supplied or an approved replacement antenna. Unauthorised antennas, modifications, or attachments could damage the device and may violate regulations governing radio devices.
- Use chargers indoors.
- Always create a backup of data you want to keep, such as contacts and calendar notes, before sending your device to a service facility.

All of the above suggestions apply equally to your device, battery, charger, or any enhancement. If any device is not working properly, take it to the nearest authorised service facility for service.

## 18. Additional safety information

Your device and its enhancements may contain small parts. Keep them out of the reach of small children.

### ■ Operating environment

Remember to follow any special regulations in force in any area and always switch off your device when its use is prohibited or when it may cause interference or danger. Use the device only in its normal operating positions. This device meets RF exposure guidelines when used either in the normal use position against the ear or when positioned at least 2.2 centimeters away from the body. When a carry case, belt clip or holder is used for body-worn operation, it should not contain metal and you should position the device the above-stated distance from your body.

In order to transmit data files or messages, this device requires a good quality connection to the network. In some cases, transmission of data files or messages may be delayed until such a connection is available. Ensure the above separation distance instructions are followed until the transmission is completed.

Parts of the device are magnetic. Metallic materials may be attracted to the device, and persons with a hearing aid should not hold the device to the

ear with the hearing aid. Do not place credit cards or other magnetic storage media near the device, because information stored on them may be erased.

### ■ Medical devices

Operation of any radio transmitting equipment, including wireless phones, may interfere with the functionality of inadequately protected medical devices. Consult a physician or the manufacturer of the medical device to determine if they are adequately shielded from external RF energy or if you have any questions. Switch off your device in health care facilities when any regulations posted in these areas instruct you to do so. Hospitals or health care facilities may be using equipment that could be sensitive to external RF energy.

#### Pacemakers

Pacemaker manufacturers recommend that a minimum separation of 15.3 centimeters (6 inches) be maintained between a wireless phone and a pacemaker to avoid potential interference with the pacemaker. These recommendations are consistent with the independent research by and recommendations of Wireless Technology Research. Persons with pacemakers should:

- Always keep the device more than 15.3 centimeters (6 inches) from the pacemaker;
- Not carry the device in a breast pocket; and
- Hold the device to the ear opposite the pacemaker to minimise the potential for interference.

If you suspect interference, switch off your device and move the device away.

### Hearing aids

Some digital wireless devices may interfere with some hearing aids. If interference occurs, consult your service provider.

## ■ Vehicles

RF signals may affect improperly installed or inadequately shielded electronic systems in motor vehicles such as electronic fuel injection systems, electronic antiskid (antilock) braking systems, electronic speed control systems, air bag systems. For more information, check with the manufacturer or its representative of your vehicle or any equipment that has been added.

Only qualified personnel should service the device, or install the device in a vehicle. Faulty installation or service may be dangerous and may invalidate any warranty that may apply to the device. Check regularly that all wireless device equipment in your vehicle is mounted and operating properly. Do not store or carry

flammable liquids, gases, or explosive materials in the same compartment as the device, its parts, or enhancements. For vehicles equipped with an air bag, remember that air bags inflate with great force. Do not place objects, including installed or portable wireless equipment in the area over the air bag or in the air bag deployment area. If in-vehicle wireless equipment is improperly installed and the air bag inflates, serious injury could result.

Using your device while flying in aircraft is prohibited. Switch off your device before boarding an aircraft. The use of wireless teledevices in an aircraft may be dangerous to the operation of the aircraft, disrupt the wireless telephone network, and may be illegal.

## ■ Potentially explosive environments

Switch off your device when in any area with a potentially explosive atmosphere and obey all signs and instructions. Potentially explosive atmospheres include areas where you would normally be advised to turn off your vehicle engine. Sparks in such areas could cause an explosion or fire resulting in bodily injury or even death. Switch off the device at refuelling points such as near gas pumps at service stations. Observe restrictions on the use of radio equipment in fuel depots, storage, and distribution areas, chemical plants or where blasting operations are in progress. Areas with

a potentially explosive atmosphere are often but not always clearly marked. They include below deck on boats, chemical transfer or storage facilities, vehicles using liquefied petroleum gas (such as propane or butane), and areas where the air contains chemicals or particles such as grain, dust, or metal powders.

## ■ Emergency calls



**Important:** Wireless phones, including this phone, operate using radio signals, wireless networks, landline networks, and user-programmed functions. Because of this, connections in all conditions cannot be guaranteed. You should never rely solely on any wireless phone for essential communications like medical emergencies.

### To make an emergency call:

1. If the phone is not on, switch it on. Check for adequate signal strength.
2. Press the end key as many times as needed to clear the display and ready the phone for calls.
3. Enter the official emergency number for your present location. Emergency numbers vary by location.
4. Press the call key.

If certain features are in use, you may first need to turn those features off before you can make an emergency

call. Consult this guide or your service provider.

When making an emergency call, give all the necessary information as accurately as possible. Your wireless phone may be the only means of communication at the scene of an accident. Do not end the call until given permission to do so.

## ■ Certification information (SAR)

### THIS DEVICE MEETS INTERNATIONAL GUIDELINES FOR EXPOSURE TO RADIO WAVES

Your mobile device is a radio transmitter and receiver. It is designed and manufactured not to exceed the limits for exposure to radio frequency (RF) recommended by international guidelines (ICNIRP). These limits are part of comprehensive guidelines and establish permitted levels of RF energy for the general population.

The guidelines were developed by independent scientific organisations through periodic and thorough evaluation of scientific studies. The guidelines include a substantial safety margin designed to assure the safety of all persons, regardless of age and health.

The exposure standard for mobile devices employs a unit of measurement known as the Specific Absorption Rate, or SAR. The SAR limit stated in the international guidelines is 2.0 watts/kilogram (W/kg)\*. Tests for

SAR are conducted using standard operating positions with the device transmitting at its highest certified power level in all tested frequency bands. Although the SAR is determined at the highest certified power level, the actual SAR of the device while operating can be well below the maximum value. This is because the device is designed to operate at multiple power levels so as to use only the power required to reach the network. In general, the closer you are to a base station, the lower the power output of the device.

The highest SAR value for this device when tested for use at the ear is 0.78 W/kg.

SAR values may vary depending on national reporting and testing requirements and the network band. Use of device accessories and enhancements may result in different SAR values. Additional SAR information may be provided under product information at [www.nokia-asia.com](http://www.nokia-asia.com).

\* The SAR limit for mobile devices used by the public is 2.0 W/kg averaged over 10 grams of body tissue. The guidelines incorporate a substantial margin of safety to give additional protection for the public and to account for any variations in measurements. SAR values may vary depending on

national reporting requirements and the network band. For SAR information in other regions, please look under product information at [www.nokia.com](http://www.nokia.com).

## Battery information

This section provides information about battery charging times with the Compact Charger (AC-3), the Travel Charger (AC-4), talk-times, and standby times. Be aware that the information in this section is subject to change. For more information, contact your service provider.

### Charging times

The following charging times are approximate with the BL-6C 1150 mAh Li-Ion battery:

Travel Charger (AC-4): up to 1 hour 45 minutes

Compact Charger (AC-3): up to 3 hours

### Talk and standby times

Operation times are estimates only and depend on signal strength, phone use, network conditions, features used, battery age and condition (including charging habits), temperatures to which the battery is exposed, and many other factors.

Talk time: 3 to 4 hours (digital)

Standby time: 8 to 12 days

# Index

## A

- About your device ix
- Active profile 55
- Alarm clock
  - repeating 77
  - setting 77
  - tone 77
  - turn off 78
- Allowed number if lock active 72
- Analog service 75
- Answer calls 10
  - slide open 60
- Antenna 6
- Anykey answer 59
- Applications
  - collection 91
  - settings 74
- Authenticate hologram 96
- Automatic
  - keyguard 62
  - redial 59
  - update of time and date 59
  - voice mail 29

## B

- Back cover
  - remove 6
  - replace 7
- Backlight time-out 57
- Banner 56
- Battery 6, 102
  - charge 7
  - charging times 102
  - remove, replace 7
  - talk and standby times 102
- Bluetooth connectivity 65
  - receive data 68
  - set up 67
  - settings 67
- Business cards 36

## C

- Calendar 78
  - make notes 79
  - open 78
  - options 78
  - receive, send notes 80
  - settings 80
  - view 79
- Call
  - divert 76
  - duration 32
  - log, *see logs* 31
  - register, *see logs* 31
  - settings 59
  - summary 62
  - time 31
- Caller
  - groups 38
- Calling cards 60
- Calls
  - answer 10
  - conference 10
  - duration 32
  - make 9
  - mute phone during 11
  - options during 11
  - restrictions 74
  - show times on display 62
  - silence 10
- Camera
  - changing options 44
  - photo sequence 43
  - recording videos 44
  - settings 45
  - take photos 42
  - use self-timer 43
- Certification information (SAR) 101
- Change lock code 73
- Charger 71, 95
  - connect 7
  - times 102
- Clock settings, *see time and date*
- Conference calls 10
- Confirmation tones 58

- Contacts
  - add 35
  - delete 41
  - edit 37
  - search 34
  - settings 38
  - view 34

- Countdown timer 85
- Currency converter 85
- Custom profile 55

## D

- Data
  - call duration 32
  - calls 61
  - transfer 92
- Date settings, *see time and date*
- Dialled numbers 31
- Dialling codes 35
- Digital service 75
- Display
  - main menu 4
  - settings 56
- Distribution lists 28
- DTMF tones 63

## E

- Emergency calls 89, 101
- End calls 10
  - slide closed 60
- Enhancements 70
  - approved 93
- Equaliser 53
- ESN xi
- Extras 91

## F

- Fax calls 32, 61
- Feature codes 75
- File transfer 69
- FM radio, *see radio*
- Folders, *see gallery*
- Font colour 56

## G

- Gallery
  - opening folders 47
  - options 48
- Games 91
- Go to functions 5

## H

- Handsfree settings 71
- Headset
  - connect 8
  - settings 71
- Hearing aid
  - settings 71
- Help
  - get xi
  - in-phone 4
  - text activation 4, 64

## I

- Indicators and icons 2
- Infrared 68
- International prefix 61
- Internet, *see wireless Internet*

## K

- Keyguard
  - automatic 62
  - lock and unlock 11
  - security 63
- Keypad tones 57

## L

- Language 62
- Lap time 86
- Listen to voice mail 29
- Lock code
  - change 73
  - preset 72
- Logs
  - clearing 32
  - dialled numbers 31
  - missed calls 31
  - received calls 31
- Loopset settings 71
- Loudspeaker 11

## M

- Main menu display 4
- Make calls 9
- Memory
  - card 63
  - checking status 63
  - phone 63
- Messages
  - minibrowser, *see minibrowser*
  - messages
  - multimedia, *see multimedia*
  - messages
  - text, *see test messages*
  - voice, *see voice messages*
- Minibrowser
  - call duration 33
  - messages 30
- MiniSD card 8
  - memory 63
- Missed calls 31
- Mobile web 88
- Multimedia messages 21
  - create 22, 24
  - delete 26
  - folders 22
  - read 23
  - reply 23
  - send 23
  - settings 27
- Music player 49
- Mute phone 11
- My phone number, display 40

## N

- Navigation key 62
- Network
  - approved for ix
  - services ix, 75
  - settings 75
- Network services ix
- No caller IDs 62
- Nokia battery authentication guidelines 96
- Nokia Care Contact Centre xi
- Nokia PC Suite 92
- Nokia support and contact information xii

- Notes 81
  - make 81
  - open 81
  - options 82
  - send 82

## O

- Organiser 77

## P

- PC connectivity 92
- Phone
  - care and maintenance 98
  - details 76
  - keys and parts 1
  - language 62
  - lock 72
  - memory 63
  - set up your 6
- Photographs 42
- Play
  - music tracks 49
  - radio 51
- Predictive text 14
- Profiles 55

## Q

- Quick keys 2

## R

- Radio
  - options 52
  - play 51
- Received calls 31
- Recording sound 52
- Repeating alarm 77
- Restore factory settings 76
- Ring
  - tone for no caller ID 62
  - volume 57
- Roaming options 75

## S

- Safety information viii
  - battery 102
  - explosive environments 100
  - hearing aids 100
  - operating environment 99
  - pacemakers 99
  - vehicles 100
- Screen saver 56
- Scroll method 3
- Security 4
  - keyguard 63
  - settings 72
- Self-timer, camera 43
- Sequence of photos 43
- Set
  - alarm 77
  - date 58
  - time 58
- Set up speed dial 40
- Settings 55
- Shared memory x
- Show call time 62
- Sleep mode 57
- Slide
  - answer calls 60
  - end calls 60
- Snooze time-out 78
- Speed dial 59
- Split time 86
- Standby mode 2
  - settings 56
- Standby time 102
- Start-up tone 64
- Stopwatch 86

## T

- Talk time 102
- Text entry
  - changing language 13
  - predictive 14
  - standard 13
- Text messages
  - create 17
  - delete 20
  - folders 16
  - read 18
  - reply 18
  - send 17

- settings 20
- templates 18
- Theme 57
- Time and date 58
- Timed profiles 55
- To-do list
  - edit 83
  - make 82
  - open 82
  - options 84
  - send 83
  - view 83
- Tones 57
  - DTMF 63
  - start-up 64
- Transfer files 69
- Turn phone on or off 8

## V

- Vibrating alert 57
- Videos 44
- Voice
  - commands 64
  - privacy 74
  - recorder 52
- Voice messages
  - automate 29
  - listen 29
  - mailbox number 29
  - setting up mailbox 29
- Voice tags
  - assign 39
  - delete 40
  - modify 39
  - use 39
- Volume 10

## W

- Wallpaper 56
- Warning tones 58
- Wireless Internet
  - access 88
  - clear cache 90
  - disconnect 90
  - make emergency call while online 89
  - receive call while online 89
  - sign on 89