

User's Guide for Nokia 1600

DECLARATION OF CONFORMITY

We, NOKIA CORPORATION declare under our sole responsibility that the product RH-64 is in conformity with the provisions of the following Council Directive: 1999/5/EC.

A copy of the Declaration of Conformity can be found at
http://www.nokia.com/phones/declaration_of_conformity/.

C€168

Copyright © 2005 Nokia. All rights reserved.

Reproduction, transfer, distribution or storage of part or all of the contents in this document in any form without the prior written permission of Nokia is prohibited.

US Patent No 5818437 and other pending patents. T9 text input software Copyright © 1997-2005. Tegic Communications, Inc. All rights reserved.

Nokia, Nokia Connecting People, Xpress-on and Pop-Port are trademarks or registered trademarks of Nokia Corporation. Other product and company names mentioned herein may be trademarks or tradenames of their respective owners.

Nokia tune is a sound mark of Nokia Corporation.

Nokia operates a policy of continuous development. Nokia reserves the right to make changes and improvements to any of the products described in this document without prior notice.

Under no circumstances shall Nokia be responsible for any loss of data or income or any special, incidental, consequential or indirect damages howsoever caused.

The contents of this document are provided "as is". Except as required by applicable law, no warranties of any kind, either express or implied, including, but not limited to, the implied warranties of merchantability and fitness for a particular purpose, are made in relation to the accuracy, reliability or contents of this document. Nokia reserves the right to revise this document or withdraw it at any time without prior notice.

The availability of particular products may vary by region. Please check with the Nokia dealer nearest to you.

THIS DEVICE MAY CONTAIN COMMODITIES, TECHNOLOGY OR SOFTWARE SUBJECT TO EXPORT LAWS AND REGULATIONS FROM THE US AND OTHER COUNTRIES. DIVERSION CONTRARY TO LAW IS PROHIBITED.

Issue 1

Contents

For your safety.....	v	3. Write text.....	11
General information	ix	4. Menu functions	14
Access codes.....	ix	Messages.....	14
Shared memory.....	x	Create message.....	14
1. Getting started	1	Read a text message (Inbox).....	15
How to get started	1	Drafts and Sent items.....	16
Insert a SIM card and battery	2	Chat (Network service).....	16
Charge the battery.....	3	Picture messages (Network service).....	17
Switch on or off	4	Distribution lists.....	17
Change the covers	5	Screened messages.....	18
Demo mode.....	6	Delete messages.....	18
Shortcuts in the standby mode.....	6	Message counter.....	18
Lock the keypad.....	7	Message settings.....	18
2. Call functions.....	8	Service com. editor (Network service).....	20
Make a call.....	8	Contacts	20
Make a conference call.....	8	Search for a name and phone number.....	20
Redial a number.....	9	Settings for Contacts.....	21
Speed dial	9	Call register	22
Answer a call.....	9	Recent call lists	23
Loudspeaker.....	10	Call timers.....	23
Voice messages (Network service).....	10	Message counter.....	23

Settings.....	24	5. Battery information.....	38
Tone settings.....	24	Charging and discharging	38
Display settings.....	25	Nokia battery authentication	
Profiles.....	26	guidelines	39
Time settings.....	26		
Call settings	27	6. Genuine Enhancements.....	43
Phone settings.....	28	Power	44
Cost settings.....	29	Standard Charger (ACP-7)	44
Enhancement settings.....	30	Travel Charger (ACP-12)	45
Security settings.....	31	Audio	45
Right navigation key setting.....	32	Headset HDC-5.....	45
Restore factory settings	33		
Clock	33	7. Care and maintenance.....	46
Reminders.....	34		
Games.....	34	8. Additional safety	
Extras.....	34	information	48
Calculator	34	Index	54
Converter	35		
Countdown timer	35		
Stopwatch	36		
Composer	36		
Demo mode.....	37		
SIM services.....	37		

For your safety

Read these simple guidelines. Not following them may be dangerous or illegal. Read the complete user guide for further information.



SWITCH ON SAFELY

Do not switch the phone on when wireless phone use is prohibited or when it may cause interference or danger.



ROAD SAFETY COMES FIRST

Obey all local laws. Always keep your hands free to operate the vehicle while driving. Your first consideration while driving should be road safety.



INTERFERENCE

All wireless phones may be susceptible to interference, which could affect performance.



SWITCH OFF IN HOSPITALS

Follow any restrictions. Switch the phone off near medical equipment.



SWITCH OFF IN AIRCRAFT

Follow any restrictions. Wireless devices can cause interference in aircraft.



SWITCH OFF WHEN REFUELLING

Do not use the phone at a refuelling point. Do not use near fuel or chemicals.



SWITCH OFF NEAR BLASTING

Follow any restrictions. Do not use the phone where blasting is in progress.



USE SENSIBLY

Use only in the normal position as explained in the product documentation. Do not touch the antenna unnecessarily.



QUALIFIED SERVICE

Only qualified personnel may install or repair this product.



ENHANCEMENTS AND BATTERIES

Use only approved enhancements and batteries. Do not connect incompatible products.



WATER-RESISTANCE

Your phone is not water-resistant. Keep it dry.



BACK-UP COPIES

Remember to make back-up copies or keep a written record of all important information stored in your phone.



CONNECTING TO OTHER DEVICES

When connecting to any other device, read its user guide for detailed safety instructions. Do not connect incompatible products.



EMERGENCY CALLS

Ensure the phone is switched on and in service. Press the end key as many times as needed to clear the display and return to the start screen. Enter the emergency number, then press the call key. Give your location. Do not end the call until given permission to do so.

■ About your device

The wireless device described in this guide is approved for use on the EGSM 900/1800 networks. Contact your service provider for more information about networks.

When using the features in this device, obey all laws and respect privacy and legitimate rights of others.



Warning: To use any features in this device, other than the alarm clock, the device must be switched on. Do not switch the device on when wireless device use may cause interference or danger.

■ Network services

To use the phone you must have service from a wireless service provider. Many of the features in this device depend on features in the wireless network to function. These network services may not be available on all networks or you may have to make specific arrangements with your service provider before you can utilize network services. Your service provider may need to give you additional instructions for their use and explain what charges will apply. Some networks may have limitations that affect how you can use network services. For instance, some networks may not support all language-dependent characters and services.

Your service provider may have requested that certain features be disabled or not activated in your device. If so, they will not appear on your device menu. Your device may also have been specially configured. This configuration may include changes in menu names, menu order and icons. Contact your service provider for more information.

■ Chargers and enhancements

Always switch the device off and disconnect the charger before removing the battery. Check the model number of any charger before use with this device. This device is intended for use when supplied with power from the ACP-7 and ACP-12 chargers.



Warning: Use only batteries, chargers, and enhancements approved by Nokia for use with this particular model. The use of any other types may invalidate any approval or warranty, and may be dangerous.

For availability of approved enhancements, please check with your dealer. When you disconnect the power cord of any enhancement, grasp and pull the plug, not the cord.

General information

■ Access codes

For details about access codes and their operations, see "[Security settings](#)" on page 31.

- **Security code:** This code, supplied with the phone, helps to protect your phone against unauthorised use. The preset code is 12345.
- **PIN code:** This code, supplied with the SIM card, helps to protect the card against unauthorised use.

To set your phone to request PIN code each time it is switched on, in the standby mode, select **Menu** > **Settings** > **Security settings** > **PIN code request**, enter the PIN code, and select **On**.

If you enter the PIN code incorrectly three times in succession, the SIM card is blocked. You must enter the PUK code to unblock the SIM card and set a new PIN code.

- **PIN2 code:** This code is supplied with some SIM cards and is required to access certain services, such as call cost settings. If you enter the PIN2 code incorrectly three times in succession, **PIN2 code blocked** appears on the display, and you will be asked for the PUK2 code.

Change the security code, PIN code and PIN2 code in **Change access codes** in the **Security settings** menu (see "[Security settings](#)" on page 31). Keep the new codes secret and in a safe place separate from your phone.

- **PUK and PUK2 code:** These codes may be supplied with the SIM card. If this is not the case, contact your local service provider.

■ Shared memory

The following features in this device may share memory: *Messages*, *Contacts*, and *Composer*. Use of one or more of these features may reduce the memory available for the remaining features sharing memory. For example, saving many text messages may use all of the available memory. Your device may display a message that the memory is full when you try to use a shared memory feature. In this case, delete some of the information or entries stored in the shared memory features before continuing. Some of the features, such as *Contacts* may have a certain amount of memory specially allotted to them in addition to the memory shared with other features.

1. Getting started

■ How to get started

The display indicators described below are shown when the phone is ready for use and no characters have been keyed in. This state is called the standby mode.

- Signal intensity of the cellular network (1)
- Battery bar indicating battery charge level (2)
- Current function of the two selection keys (3)
- Selection keys (4)

The function of the selection keys depends on the text shown on the display above them.

- Scroll keys (5)
- Call key (6)
 - Dials a phone number.
 - Answers a call.

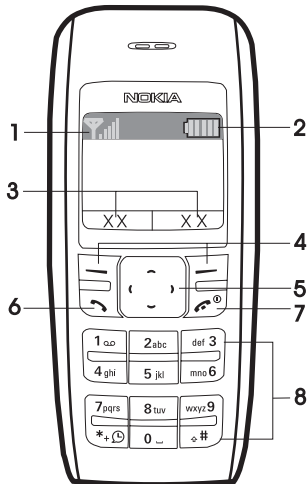

Getting started

- End key (7)
A long press switches the phone on or off.
A brief press ends an active call or exits from any function.
- Keypad (8)

■ Insert a SIM card and battery

Keep all SIM cards out of the reach of small children.

For availability and information on using SIM card services, contact your SIM card vendor. This may be the service provider, network operator, or other vendor.

This phone is intended for use with BL-5C battery.

1. Press the back cover release button (1), open the back cover, and remove it (2, 3).

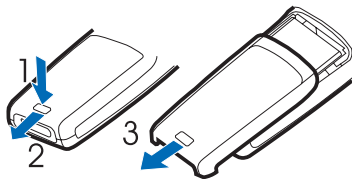

2. Lift the battery from the finger grip, and remove it (4). Carefully lift the SIM card holder from the finger grip of the phone (5).

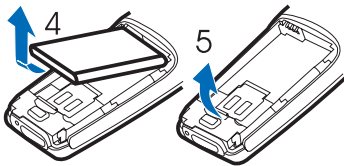

3. Insert the SIM card, ensuring that the bevelled corner is on the upper right side and that the golden contact is facing downward (6).
4. Close the SIM card holder (7), and press it to lock it into place.
5. Insert the battery (8, 9).

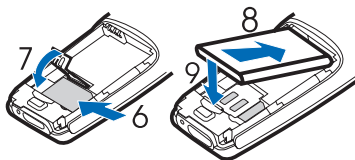

■ Charge the battery

1. Connect the charger to an ac wall outlet.
2. Connect the plug from the charger to the base of the phone. The battery indicator bar starts scrolling.

If **Not charging** is displayed, wait for a while, disconnect the charger, plug it in again, and retry. If charging still fails, contact your dealer.

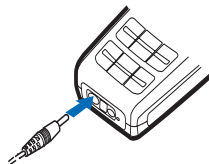

3. When the battery is fully charged, the bar stops scrolling. Disconnect the charger from the phone and the ac outlet.

■ Switch on or off

Press and hold the end key for a few seconds.



Warning! Do not switch on the phone when wireless phone use is prohibited or when it may cause interference or danger.

Use the phone only in its normal operating position.

Your device has an internal antenna.



Note: As with any other radio transmitting device, do not touch the antenna unnecessarily when the device is switched on. Contact with the antenna affects call quality and may cause the device to operate at a higher power level than otherwise needed. Avoiding contact with the antenna area when operating the device optimizes the antenna performance and the battery life.



Note: Avoid touching this connector as it is sensitive to electrostatic discharge.

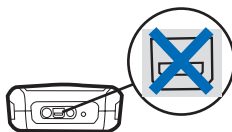

■ Change the covers



Note: Always switch off the power and disconnect the charger and any other device before removing the cover. Avoid touching electronic components while changing the cover. Always store and use the device with the cover attached.

1. Press the back cover release button (1), open the back cover, and remove it (2, 3).

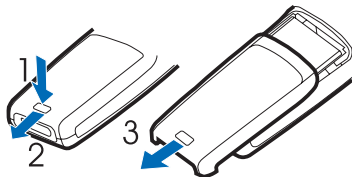

2. Take off the front cover carefully (4).



3. Insert the keymat in the new front cover (5).

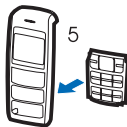

- Align the top of the front cover to the top of the phone, and press the front cover to lock it into place (6,7).



Demo mode

You may view how to use certain features of your phone. To access the demo, use one of the two ways:

- If the SIM card is not installed, select **Demo**.
 - Basics**—To view the demo of *Make a call*, *Answer a call*, *Send text msg.*, or *Set an alarm*
 - More**—To view the demo of *Speaking clock*, *Ringing tones*, or *Themes*
 - Games**—To play the games in your phone
- If the SIM card is installed, select **Menu** > **Extras** > **Demo** > **Basics** or **More**; or, you can access the demo mode by scrolling right in the standby mode.

Shortcuts in the standby mode

Scroll up to access *Call register*.

Scroll down to access the names and numbers saved in *Contacts*.

Scroll left to write a message.

Scroll right to access the demo mode.

Press and hold * to activate the speaking clock.

Press the call key once to access the list of dialled numbers. Scroll to the name or number that you want, and to call the number, press the call key.

■ Lock the keypad

The keypad lock helps to prevent keys from being pressed accidentally.

To lock the keypad, in the standby mode, select **Menu**, and press * quickly; to unlock, select **Unlock**, and press * quickly.

To automatically turn on the keylock, see "[Phone settings](#)" on page 28.

When the keypad lock is on, calls may be possible to the official emergency number programmed into your device.

Enter the emergency number, and press the call key. The emergency number you have entered may not be displayed on the screen.

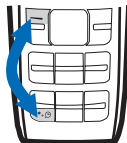

2. Call functions

■ Make a call

1. Enter the phone number and the area code if necessary.

To make international phone calls, press * twice quickly, add the country (or region) code then the area code (delete the leading 0 if necessary).

To delete the last digit entered, select **Clear**.

2. Press the call key to call the number. Scroll right to increase or scroll left to decrease the volume of the earpiece or headset during the phone call.
3. Press the end key to end the call (or to cancel the call attempt).

Make a conference call

Conference call (Network service) allows up to five people to participate in the same call.

1. To make a call to a new participant, select **Options** > *New call*; select **Clear** to clear the screen if necessary. Enter the number you want, and press the call key.
2. When the new call is answered, add it to the conference call by selecting **Options** > *Conference*.

Redial a number

To redial one of the last twenty phone numbers that you have called or attempted to call, press the call key once in the standby mode, scroll to the phone number or name that you want, and press the call key.

Speed dial

In the standby mode, select **Menu** > *Contacts* > *Speed dials* and one of the following options:

- *On* or *Off* to set speed dial on or off
- *Edit* to edit the speed dial list

Scroll to select the number key you want (2 to 9), and select **Assign**; choose if you want to assign to call or to SMS, and select the name you want.

To dial a number using speed dial, press and hold the relevant assigned number key in the standby mode.

■ Answer a call

When there is an incoming call, press the call key to answer. To reject the call without answering, press the end key.

■ Loudspeaker

If available, you may select **Loudsp.** or **Hands.** to use the loudspeaker or the earpiece of the phone during a call.





Warning: Do not hold the device near your ear when the loudspeaker is in use, because the volume may be extremely loud.

■ Voice messages (Network service)

To receive your voice mailbox number, contact your service provider. To call your voice mailbox, press and hold **1** in the standby mode. You may need to enter the number when calling for the first time. To change the voice mailbox number, see "[Settings for Contacts](#)" on page [21](#).

To divert calls to your voice mailbox, see "[Call settings](#)" on page [27](#).

3. Write text

You can enter text in two different ways, the traditional text input , or predictive text input (built-in dictionary) .

To use traditional text input, press the key marked with the letter that you want repeatedly until the letter appears.

Not all characters available under a number key are printed on the key. The characters available depend on the *Language* you have chosen. See "[Phone settings](#)" on page 28.

To enter a letter that is on the same key as the previous one, wait until the cursor appears, or press any of the scroll keys, and then enter the letter.

The most common punctuation marks and special characters are available by pressing the number key 1.

Set predictive English input on or off

When writing text, select **Options** > *Dictionary*.

- To set the predictive text input on, select a language in the dictionary options list. Predictive text input is only available for the languages on the list.
- To change back to the traditional text input, select *Dictionary off*.

Write text

To use predictive text input:

1. Enter the word you want by pressing each key once for a single letter. The word changes after each keystroke. For example, to write 'Nokia' when the English dictionary is selected, press 6, 6, 5, 4, 2.
2. If the displayed word is the one you want, press 0, and start writing the next word.

If you want to change the word, press * repeatedly until the word you want appears.

If the "?" is displayed after the word, the word is not in the dictionary. To add the word to the dictionary, select **Spell**, enter the word (using traditional text input), and select **OK**.

To add a compound word with predictive input, enter the first half of the word, scroll right, and enter the second half.

Tips for writing text with traditional and predictive text input:

- To move the cursor left, right, up, or down, press the respective scroll key.
- To add a space, press 0.
- To delete the character to the left of the cursor, select **Clear**. To clear all the text you have entered, press and hold the right selection key.
- To switch between upper and lower cases, or between traditional and predictive text input when predictive text input is selected, press # repeatedly and check the indicator at the top of the display.
- To switch between letters and numbers, press and hold #.
- To add a number, press and hold the desired number key.

- To get a list of special characters when using traditional text input, press *; when using predictive text input, press and hold *. In traditional text input, you can also add punctuation marks and certain special characters by pressing 1 repeatedly.

4. Menu functions

In the standby mode, select **Menu** and the desired menu and submenu. Select **Exit** or **Back** to exit the current level of menu. Press the end key to return to the standby mode directly.

■ Messages



Create message

Your device supports the sending of text messages beyond the character limit for a single message. Longer messages will be sent as a series of two or more messages. Your service provider may charge accordingly. Characters that use accents or other marks, and characters from some language options like Chinese, take up more space limiting the number of characters that can be sent in a single message.

The number of available characters/the current part number of a multipart message is shown on the top right of the display, for example, 902/1.

To send a message, the phone number of your message centre has to be saved in the phone. See "[Message settings](#)" on page 18.

1. In the standby mode, select **Menu** > *Messages* > *Create message*.
2. Write the message. The number of available characters and the current part number are shown on the top right of the display.

- When the message is complete, select **Options** > *Send*, enter the recipient's phone number, and select **OK**.

If you want to send the message to several people, select **Options** > *Sending options* > *Send to many*, scroll to the first recipient, and select **OK**. Repeat this for each recipient. When you have finished, select **Done**.

To send a message to a predefined distribution list, select **Options** > *Sending options* > *Send to list*. For details about distribution list, see "[Distribution lists](#)" on page 17.



Note: When sending messages, your device may display *Message Sent*. This is an indication that the message has been sent by your device to the message centre number programmed into your device. This is not an indication that the message has been received at the intended destination. For more details about messaging services, check with your service provider.

When editing a message, if you selected **Options** > *Clear text*, and you have not entered any new text, or changed input method or language, or changed the dictionary mode, you may select **Options** > *Undo clear* to restore the text you just cleared.

Read a text message (Inbox)

When you receive text messages, the number of new messages as well as an  icon are shown on the display in the standby mode.

Select **Show** to view the messages immediately.

To view the messages later, select **Exit**. When you want to read the messages, select **Menu** > *Messages* > *Inbox* and the desired message.

Drafts and Sent items

In the *Drafts* menu, you can view the messages that you saved with the *Save message* menu. In the *Sent items* menu, you can view the copies of the messages that you sent.

Chat (Network service)

You can have a conversation with other people using this text message service. Each chat message is sent as a separate text message. The messages received and sent during a chat session are not saved.

To start a chat session, select **Menu** > *Messages* > *Chat*; or, when reading a received text message, select **Options** > *Chat*.

1. Enter the person's phone number or search for it in the *Contacts*, and select **OK**.
2. Enter your nickname for the chat session, and select **OK**.
3. Enter your message, and select **Options** > *Send*.
4. The reply from the other person is displayed above the message you sent. To reply to the message, select **Back**, and repeat step 3.

When writing a message, you can select **Options** > *Chat name* or *Chat history* to edit your nickname or view the previous messages.

Picture messages (Network service)

You can receive and send messages that contain pictures. Received picture messages are saved in the *Inbox*. Note that each picture message comprises several text messages. Therefore, sending one picture message may cost more than one text message.



Note: Picture message function can be used only if it is supported by your network operator or service provider. Only compatible devices that offer picture message features can receive and display picture messages. The appearance of a message may vary depending on the receiving device.

To create a picture message, select **Menu** > *Messages* > *Picture messages*. Scroll to the picture you want, and select **Use**. Add text if you want, and select **Options** > *Send*.

To view the message immediately, select **Show**.

Distribution lists

You can define up to six distribution lists with up to ten recipients in each. To add a new distribution list in the standby mode, select **Menu** > *Messages* > *Distribution lists* > **Options** > *Add list*. Give the distribution list a name, and select **OK**.

To add a name to a distribution list, scroll to the desired distribution list, select **Options** > *View list* > **Options** > *Add contact*. Each message to every recipient will be charged separately.

Screened messages

Messages from screened numbers are saved here. See "*No. screening*" on page 20. To view the screened messages, select **Menu** > *Messages* > *Screened messages* and the desired message.

When viewing the screened message, select **Options** > *Delete* to delete the message, or *Delete from list* to delete the number from the list of screened numbers.

Delete messages

To delete all read messages or all the messages in a folder, select **Menu** > *Messages* > *Delete messages* > *All read* or the desired folder.

Message counter

Select **Menu** > *Messages* > *Message counter*. Scroll down to view the number of sent and received messages. To reset the message counters, select *Clear counters* and the counters you want to reset.

Message settings

To view or edit your text message settings in the standby mode, select **Menu** > *Messages* > *Message settings* and one of the following options:

- *Info service* (Network service)—To setup whether you will receive messages on various topics, for example, traffic conditions, from the network and to manage the topics.

For more information, please contact your service provider.

- *Templates*—To view, edit, or delete the preset messages that can be used for writing a message
- *Smileys*—To view, edit, or delete preset smileys that you can use in writing messages
- *Signatures*—To manage the signature that will be added to your message
Select *Include sig.* to set the automatic insertion of signature on or off; select *Signature text* to edit your signature.
- *Sending profile*—To manage your sending profiles
Select your desired profile and one of the following options:
 - *Message centre number* to save the phone number needed for sending text and picture messages. You obtain this number from your service provider.
 - *Messages sent as* (Network service) to choose the message type *Text*, *Fax*, *Paging* or *E-mail*
 - *Message validity* (Network service) to choose how long the network should attempt to deliver your message
 - *Rename sending profile* to change the name of the sending profile
- *Delivery reports* (Network service)—To request the network to send delivery reports on your messages
- *Reply via same centre* (Network service)—To allow the recipient to reply through your message centre
- *Character support* (Network service)—To set whether the *Full* or *Reduced* coding is used when sending a text message

- *No. screening*—To view or edit the list of filtered numbers

Scroll to a number, and select **Options** > *Add number* or *Delete from list* to add a number to the filtered list or delete the highlighted number from the list.

Messages from the filtered numbers will be saved directly to the *Screened messages* folder.

When a filtered number calls, your phone will not ring or vibrate, regardless of the mode. If the call is not answered, it will be stored in the folder of *Missed calls* under *Call register*.

Service com. editor (Network service)

Select *Service com. editor* to send service request to your service provider. For more information, contact your service provider.

■ Contacts

You can save names and phone numbers in the phone memory and in the SIM card memory. The internal phone book can store up to 200 names.



Search for a name and phone number

In the standby mode, select **Menu** > *Contacts* > *Search*. Enter the first letters of the name you are looking for, and select **Search**. Scroll up or down to find the name you want.



QUICK SEARCH: Scroll down in the standby mode, and enter the first letters of the name. Scroll to the name that you want.

You can also use the following options in the *Contacts* menu:

- *Add contact*—To save names and phone numbers in the phone book
- *Delete*—To delete names and phone numbers from the phone book individually or all at once
- *Copy*—To copy names and phone numbers all at once or one by one from the internal phone book to the SIM phone book, or vice versa
- *Settings*: See "[Settings for Contacts](#)" on page 21.
- *Speed dials*—To activate the speed dial function and to edit the numbers assigned to the speed dial keys
- *No. screening*: See "[No. screening](#)" on page 20.
- *Service numbers* (Network service)—To call the service numbers of your service provider if the numbers are included on your SIM card
- *Info numbers* (Network service)—To call the information numbers of your service provider if the numbers are included on your SIM card



Settings for Contacts

In the standby mode, select **Menu** > *Contacts* > *Settings* and one of the following options:

- *Voice mailbox number* (Network service)—To save and change the phone number of your voice mailbox

- *Memory in use*—To select whether the names and phone numbers are saved in *Phone* or *SIM card*

When you change the SIM card, *SIM card* memory is automatically selected.

- *Contacts view*—To select how the names and phone numbers are shown
When you view the **Details** of a contact with *Contacts view* set to *Name list* or *Name only*, the name or phone number saved in the SIM card memory is indicated by  at the upper right-hand corner of the display and the name or phone number saved in the phone memory is indicated by .

- *Memory status*—To check how many names and phone numbers are already saved and how many can still be saved in each phone book
- *Contact images*—To select whether the icons are displayed with the names and numbers in the phonebook

When *Contact images* is set to *On*, you may select an icon when you add a new contact in the phonebook; you may also change the icon for a contact that you are viewing by selecting **Options** > *Change image*.

■ Call register

The phone registers the phone numbers of missed, received, and dialled calls; the approximate length of your calls; and the number of sent and received messages.



The phone registers missed and received calls if it is switched on, within the network service area, and the network supports these functions.

Recent call lists

In the standby mode, select **Menu** > *Call register* > *Missed calls*, *Received calls*, or *Dialled numbers* > **Options** to view the time of the call; edit, view or call the registered phone number; add it to the phone book or to the list of screened numbers; or delete it from the recent call list. You can also send a text message.

To reset the recent call lists, in the standby mode, select **Menu** > *Call register* > *Delete recent call lists*, and select the lists you want to reset.

Call timers

Select **Menu** > *Call register* > *Call duration* to view the approximate duration of the last call, all received calls, all dialled calls, or the approximate duration of all calls.

To reset the timers, select *Clear timers*, enter the security code, and select **OK**.



Note: The actual invoice for calls and services from your service provider may vary, depending upon network features, rounding off for billing, taxes and so forth.

Message counter

The *Message counter* menu is also located in the *Messages* main menu, see "Message counter" on page 18.

■ Settings



In this menu, you can adjust various phone settings. You can also reset some menu settings to their default values by choosing

Restore factory settings

Tone settings

Select **Menu** > *Settings* > *Tone settings* and one of the following options:

- *Ring tone*—To set the tone for incoming calls
- *Ring volume*—To set the volume level for the ringing and message alert tones

If you set *Ring volume* to be level 2 or above, your phone rings with the ringing volume ascending from level 1 to the level you have set when there is an incoming call.

- *Vibrating alert*—To set the phone to vibrate when you receive a call or a text message
- *Message alert tone*—To set the tone to sound when you receive a text message
- *Keypad tones*—To set the volume for keypad tones
- *Warning tones*—To set the phone to sound tones, for example, when the battery is running out of power
- *Rhythmic backlight alert*—To set the phone backlight to follow the rhythm of the ringing tone when there is an incoming call or message

Display settings

Select **Menu** > *Settings* > *Display settings* and one of the following options:

- *Themes*—To set and edit a theme for the phone display
Highlight the theme that you want, select **Options** and one of the following options:
 - *Activate* > *Current profile* or *All profiles* to use the theme with only the current profile or with all profiles
 - *Edit* to edit the theme
Select the *Wallpaper* for display in the standby mode, and *Menu background*, and *Colour schemes* for the theme.
- *Colour schemes* to adjust the colour scheme of the theme in use.
- *Power saver clock*—To set the phone to show the digital or classic clock and all the main display icons as a screen saver
Select *Digital+clock* or *Classic clock* to use digital or classic clock as the screen saver; select *off* to turn off the *Power saver clock*.
- *Operator logo* (Network service)—To set the operator logo on or off in the standby mode
- *Cell info display* (Network service)—To set the phone to indicate when it is used in a cellular network that is based on Micro Cellular Network (MCN) technology

- **Backlight time**—To select whether the backlights are switched on for 15 seconds (*Normal*), for 30 seconds (*Extended*), or not at all (*Off*)
Even if *Off* is selected, the backlight stays on for 15 seconds when the phone is switched on
- **Brightness**—To modify the display brightness by scrolling left or right
- **Screen saver**—To turn the screen saver on or off, to set the time for turning on the screen saver (*Time-out*), or to select the picture for your screen saver (*Screen saver*)

Profiles

You can customise the profiles to use certain features, such as ringing tones and screen saver.

Select **Menu** > *Settings* > *Profiles*. Select the profile that you want to modify, then *Personalise*.

You can also change the settings of the currently selected profile in the *Tone settings* menu (see "Tone settings" on page 24), and *Display settings* menu (see "Display settings" on page 25).



To activate a profile quickly in the standby mode: Press the end key quickly, scroll to the desired profile, and select **OK**.

Time settings

Select **Menu** > *Settings* > *Time settings* and one of the following options:

- *Clock*—To hide or show the clock, to set the time, or to edit the time format
- *Date setting*—To set the date
- *Auto-update of date and time* (network service)—To set your phone to automatically update time and date from network

Using this feature may cause some set alarms to expire.



Note: If the battery was removed from the phone, you may need to set the time and date again.

Call settings

Select **Menu** > *Settings* > *Call settings* and one of the following options:

- *Call divert* (Network service)—To divert your incoming calls to your voice mailbox or to some other phone number

Select the divert option you want, for example, select *Divert when busy* to divert the calls when you are on a call or when you reject a call.

Several divert options may be active at the same time. When *Divert all voice calls* is activated,  is shown on the display in the standby mode. To deactivate all call diverts, select *Cancel all diverts*

To set the selected divert option on, select *Activate*; to set it off, select *Cancel*; to check whether the selected option is active, select *Check status*; to specify a delay for certain diverts, select *Set delay time* (not available for all divert options).

- *Automatic redial*—To set your phone to make up to ten attempts to connect the call after an unsuccessful call attempt
- *Call waiting service* (Network service)—To let the network notify you of a new incoming call while you have a call in progress
- *Send my caller identity* (Network service)—To set your phone number to be displayed (*On*) or hidden (*Off*) from the person you are calling
When you select *Default*, the setting agreed with your service provider is used.
- *Line for outgoing calls* (Network service)—To select either phone line 1 or 2 for making calls, or prevent line selection, if supported by your SIM card
- *No. screening* refer to *No. screening* on 20.

Phone settings

Select **Menu** > *Settings* > *Phone settings* and one of the following options:

- *Language*—To select the language for the display texts
- *Keyguard settings*.
 - *Automatic keyguard* > *On* to activate the automatic keyguard
Enter the delay time in the format of minutes:seconds, and select **OK**.
You can set the time from 10 seconds to 59 minutes and 59 seconds.
To deactivate the automatic keyguard, select *Off*.

- *Keyguard code* to activate the security keyguard
Enter the security code, and select **OK**. After you have selected *On*, the phone asks for the security code every time you select **Unlock**. To deactivate the security keyguard, select *Off*.
- *Network selection*—To set the phone to automatically select a cellular network available in your area, or you can select the network manually.
- *Start-up tone*—To switch on or off the tone that sounds when the phone is powered on
- *Welcome note*—To enter a message that will be shown briefly on the display when the phone is switched on
- *Confirm SIM service actions*. For more information, contact your service provider.

Cost settings



Note: The actual invoice for calls and services from your service provider may vary, depending on network features, rounding off for billing, taxes and so forth.

Select **Menu** > *Settings* > *Cost settings* and one of the following options:

- *Prepaid tracker* (Network service)—To view information of prepaid credit
When using a prepaid SIM card, you can make calls only when there are enough credit units on the SIM card.



Note: When no more charging units or currency units are left, calls may only be possible to the official emergency number programmed into the device.

- *In-call timer*—To turn the call time display on or off
- *Call summary*—To turn the approximate call time report on or off
- *Call costs* (Network service)—To view the approximate cost of your last call or all calls in terms of units specified within the *Show costs in* function
- *Fixed dialling*—To restrict your outgoing calls to selected phone numbers, if allowed by your SIM cards (PIN2 code may be required.)

Enhancement settings

Select **Menu** > *Settings* > *Enhancement settings* > *Headset* or *Loopset* and one of the following options:

- *Default profile*—To select the profile the phone uses when the enhancement is connected
- *Automatic answer*—To set the phone to automatically answer an incoming call after five seconds

The accessory settings item becomes visible only after one of the accessories has been connected to the phone. The other accessory related items also become visible only after the corresponding accessory has been connected once to the phone.

Security settings

When security features that restrict calls are in use (such as call barring, closed user group and fixed dialling) calls still may be possible to the official emergency number programmed into your device.

Select **Menu** > *Settings* > *Security settings* and one of the following options:

- *PIN code request*—To set your phone to ask for the PIN code of the SIM card when the phone is switched on
Some SIM cards do not allow this function to be turned off.
- *Call barring service* (Network service)—To restrict the making and receiving of calls with your phone
Select one of the barring options and set the option on (*Activate*) or off (*Cancel*) or check whether a service is activated (*Check status*).
- *Closed user group* (Network service)—To specify a group of people whom you can call and who can call you
- *Security level*—To control the use of your phone or the phone memory
Enter the security code; select *Phone* to set the phone to ask for the security code when a new SIM card is inserted, or select *Memory* to set the phone to ask for security code when a new SIM card is inserted and you select the internal phone book, or select *None* to set the phone not to ask for security code when a new SIM card is inserted or the internal phonebook is selected.



Note: When you change the security level, all the recent calls lists, including missed calls, received calls and dialled numbers, may be cleared.

- *Change access codes*—To change the security code, PIN code, PIN2 code or barring password

These codes can include the numbers 0 to 9 only.

Avoid using access codes similar to the emergency numbers, such as 112, to prevent accidental dialling of the emergency number.

Right navigation key setting

In the standby mode, you may select **Go to** to access a list of shortcuts. To define or organise the shortcuts, select **Menu** > *Settings* > *R. navigation key settings* and one of the following options:

- *Select options*—To select the functions that you want as shortcuts
Highlight the desired functions, and select **Mark**. The functions are listed in the shortcut list in the order that you select them. When you have finished selecting functions, select **Done** > **Yes** to save the changes.
- *Organise*—To organise the order of the functions in the shortcut list
Highlight the function that you want to move, select **Move** and the desired moving option. When you have finished organising functions, select **Back** > **Yes** to save the changes.

Restore factory settings

To reset some of the menu settings to their original values, select **Menu** > *Settings* > *Restore factory settings*. Enter the security code, and select **OK**. The names and phone numbers saved in the phone book are not deleted.

■ Clock



In the standby mode, select **Menu** > *Clock* and one of the following options:

- *Alarm time*—To set the time for the alarm
Enter the time, and select **OK**.
- *Alarm tone*—To select the tone for the alarm
- *Repeat alarm*—To set the alarm to sound only once or repeatedly on certain days of the week
- *Speaking clock*—To let the phone speak the time
- *Time settings* See "[Time settings](#)" on page 26.

When the alarm sounds, select **Stop** to stop the alarm, or **Snooze** to stop the alarm and set it to ring again in 10 minutes.

If the alarm time is reached while the device is switched off, the device switches itself on and starts sounding the alarm tone. If you select **Stop**, the device asks whether you want to activate the device for calls. Select **No** to switch off the device or **Yes** to make and receive calls. Do not select **Yes** when wireless phone use may cause interference or danger.

■ Reminders



You can save short text notes with an alarm.

Select **Menu** > *Reminders* and one of the following options:

- *Add new*—To add a new reminder
- *View all*—To view all the reminders
- *Delete*—To delete the reminders
- *Alarm tone*—To select the alarm tone for the expiry of the reminder

While viewing the reminder, you may select **Options** > *Delete*, *Edit*, or *Send*.

When the reminder time is reached, select **Quit** to stop the alarm, or **Postp.** to let the phone alarm again in 10 minutes.

■ Games



Each game has a brief help text.

To adjust common game settings, select **Menu** > *Games* > *Settings*. You can set the sounds (*Game sounds*) and vibrations (*Shakes*) for the game.

■ Extras



Calculator



Note: This calculator has limited accuracy and is designed for simple calculations.

Select **Menu** > *Extras* > *Calculator*.

1. Press keys 0 to 9 to insert digits and # to insert a decimal point. To delete the last digit, select **Clear**.

To change the sign of the entered number, press *.

2. Scroll up or down to highlight +, -, x, or /.
3. Repeat steps 1 and 2 if necessary.
4. To get the result, select **Equals**.

Converter

You can convert different measurement units.

In the standby mode, select **Menu** > *Extras* > *Converter*. To access your last five conversions, select *Last 5 conv*. You can also select to use the six predefined unit categories: *Temperature*, *Weight*, *Length*, *Area*, *Volume*, and *Currency*.

You can add your own conversions with *My conversions*.

When doing a conversion, you may scroll up or down to swap the positions of the units in the conversion.

Countdown timer

Select **Menu** > *Extras* > *Countd. tim*. Enter the alarm time in the format of hours:minutes and select **OK**. You can also enter a note for the alarm, change the time and stop the timer.

When the timer is running,  is shown in the standby mode.

When the alarm time is reached, the phone sounds a tone and flashes the related text. Select **Restart** to restart the timer or **Quit** to stop the alarm.

Leaving the timer running in the background increases the demand on battery power and reduces the battery life.

Stopwatch

Select **Menu** > *Extras* > *Stopwatch*.

Select **Start** to start timing. To take the time, select **Stop**. When the timing is stopped, you can select **Options** > *Start*, *Reset*, or *Exit*.

To set the timing to continue in the background when it is running, press the end key. While the time is running,  flashes in the standby mode.

Using the stopwatch or allowing it to run in the background when using other features increases the demand on battery power and reduces the battery life.

Composer

Select **Menu** > *Extras* > *Composer* and a tone. You can create your own ringing tones by keying in the notes. For example, press 4 for note f.

c	d	e
f	g	a

8 shortens (-) and 9 lengthens (+) the duration of the note or rest. 0 inserts a rest. * sets the octave. # makes the note sharp (not available for notes e and b). Scroll left or right to move the cursor left or right. Select **Clear** to delete a note or rest to the left of the cursor.

b	.	+
123	—	#

When the tone is complete, select **Options**, and select *Play, Save, Tempo, Send, Clear screen* or *Exit*.

Demo mode

See "Demo mode" on page 6.

■ SIM services

For more information, contact your service provider.



5. Battery information

■ Charging and discharging

Your device is powered by a rechargeable battery. The full performance of a new battery is achieved only after two or three complete charge and discharge cycles. The battery can be charged and discharged hundreds of times, but it will eventually wear out. When the talk and standby times are noticeably shorter than normal, replace the battery. Use only Nokia approved batteries, and recharge your battery only with Nokia approved chargers designated for this device.

If a replacement battery is being used for the first time or if the battery has not been used for a prolonged period, it maybe necessary to connect the charger and then disconnect and reconnect it to start the charging.

Unplug the charger from the electrical plug and the device when not in use. Do not leave fully charged battery connected to a charger, since overcharging may shorten its lifetime. If left unused, a fully charged battery will lose its charge over time.

If the battery is completely discharged, it may take a few minutes before the charging indicator appears on the display or before any calls can be made.

Use the battery only for its intended purpose. Never use any charger or battery that is damaged.

Do not short-circuit the battery. Accidental short-circuiting can occur when a metallic object such as a coin, clip, or pen causes direct connection of the positive (+) and negative (-) terminals of the battery. (These look like metal strips on the battery.) This might happen, for example, when you carry a spare battery in your pocket or purse. Short-circuiting the terminals may damage the battery or the connecting object.

Leaving the battery in hot or cold places, such as in a closed car in summer or winter conditions, will reduce the capacity and lifetime of the battery. Always try to keep the battery between 15°C and 25°C (59°F and 77°F). A device with a hot or cold battery may not work temporarily, even when the battery is fully charged. Battery performance is particularly limited in temperatures well below freezing.

Do not dispose of batteries in a fire as they may explode. Batteries may also explode if damaged. Dispose of batteries according to local regulations. Please recycle when possible. Do not dispose as household waste.

■ Nokia battery authentication guidelines

Always use original Nokia batteries for your safety. To check that you are getting an original Nokia battery, purchase it from an authorized Nokia dealer, look for the Nokia Original Enhancements logo on the packaging, and inspect the hologram label using the following steps:

Successful completion of the four steps is not a total assurance of the authenticity of the battery. If you have any reason to believe that your battery is not an authentic original Nokia battery, you should refrain from using it, and take it to the nearest authorized Nokia service point or dealer for assistance. Your authorized Nokia service point or dealer will inspect the battery for authenticity. If authenticity cannot be verified, return the battery to the place of purchase.

Authenticate hologram



1. When looking at the hologram on the label, you should see the Nokia connecting hands symbol from one angle and the Nokia Original Enhancements logo when looking from another angle.



2. When you angle the hologram left, right, down, and up, you should see 1, 2, 3, and 4 dots on each side respectively.

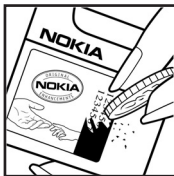

3. Scratch the side of the label to reveal a 20-digit code, for example, 12345678919876543210. Turn the battery so that the numbers are facing upwards. The 20-digit code reads starting from the number at the top row followed by the bottom row.



4. Confirm that the 20-digit code is valid by following the instructions at www.nokiaoriginals.com/check.

To create a text message enter the 20-digit code, for example, 12345678919876543210, and send to +44 7786 200276.

To create a text message,

- For countries in Asia Pacific, excluding India: Enter the 20-digit code, for example, 12345678919876543210, and send to +61 427151515.
- For India only: Enter **Battery** followed by the 20-digit battery code, for example, Battery 12345678919876543210, and send to 5555.

National and international operator charges will apply.

You should receive a message indicating whether the code can be authenticated.

Battery information

If you need assistance confirming the battery code, contact your local Nokia Care Centres listed at www.nokia-asia.com/carecentrelocator.

What if your battery is not authentic?

If you cannot confirm that your Nokia battery with the hologram on the label is an authentic Nokia battery, please do not use the battery. Take it to the nearest authorized Nokia service point or dealer for assistance. The use of a battery that is not approved by the manufacturer may be dangerous and may result in poor performance and damage to your device and its enhancements. It may also invalidate any approval or warranty applying to the device.

To find out more about original Nokia batteries, visit www.nokiaoriginals.com/battery.

6. Genuine Enhancements

A new extensive range of enhancements is available for your phone. Select the enhancements which accommodate your specific communication needs.



Some of the enhancements are described in detail below.

For availability of the enhancements, please check with your local dealer.

A few practical rules about accessories and enhancements:

- Keep all accessories and enhancements out of the reach of small children.
- When you disconnect the power cord of any accessory or enhancement, grasp and pull the plug, not the cord.
- Check regularly that enhancements installed in a vehicle are mounted and are operating properly.
- Installation of any complex car enhancements must be made by qualified personnel only.

Use only batteries, chargers and enhancements approved by the phone manufacturer. The use of any other types may invalidate any approval or warranty applying to the phone, and may be dangerous.

■ Power

Type	Tech	Talktime*	Standby*
BL-5C	Li-ion	Up to 4hr - 5hr 30min	Up to 285hr - 450hr

* Variation in operation times may occur depending on SIM card, network and usage settings, usage style and environments. Use of integrated hands-free will affect talktime and standby.

Standard Charger (ACP-7)

Small, lightweight and durable charger ACP-7 provides an easy and convenient way to charge the phone. It is easy to connect to phone or desktop stand.

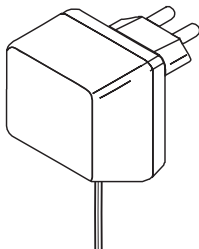

Note: The plug types vary according to different markets.

Travel Charger (ACP-12)

Small, lightweight travel charger with multi voltage (100 – 240V) switcher technology. Provides easy and convenient way to charge the phone.

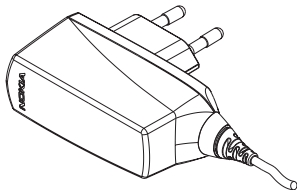

Note: The plug types vary according to different markets.

■ Audio

Headset HDC-5

For easy and simple operation this headset is provided with a remote control.

7. Care and maintenance

Your device is a product of superior design and craftsmanship and should be treated with care. The suggestions below will help you protect your warranty coverage.

- Keep the device dry. Precipitation, humidity and all types of liquids or moisture can contain minerals that will corrode electronic circuits. If your device does get wet, remove the battery and allow the device to dry completely before replacing it.
- Do not use or store the device in dusty, dirty areas. Its moving parts and electronic components can be damaged.
- Do not store the device in hot areas. High temperatures can shorten the life of electronic devices, damage batteries, and warp or melt certain plastics.
- Do not store the device in cold areas. When the device returns to its normal temperature, moisture can form inside the device and damage electronic circuit boards.
- Do not attempt to open the device other than as instructed in this guide.
- Do not drop, knock, or shake the device. Rough handling can break internal circuit boards and fine mechanics.
- Do not use harsh chemicals, cleaning solvents, or strong detergents to clean the device.
- Do not paint the device. Paint can clog the moving parts and prevent proper operation.
- Use only the supplied or an approved replacement antenna. Unauthorised antennas, modifications, or attachments could damage the device and may violate regulations governing radio devices.

- Use chargers indoors.
- Always create a backup of data you want to keep (such as contacts) before sending your device to a service facility.

All of the above suggestions apply equally to your device, battery, charger, or any enhancement. If any device is not working properly, take it to the nearest authorized service facility for service.

8. Additional safety information

Your device and its enhancements may contain small parts. Keep them out of the reach of small children.

■ Operating environment

Remember to follow any special regulations in force in any area and always switch off your device when its use is prohibited or when it may cause interference or danger. Use the device only in its normal operating positions. This device meets RF exposure guidelines when used either in the normal use position against the ear or when positioned at least 2.2 cm away from the body. When a carry case, belt clip or holder is used for body-worn operation, it should not contain metal and should position the device the above-stated distance from your body.

Parts of the device are magnetic. Metallic materials may be attracted to the device, and persons with a hearing aid should not hold the device to the ear with the hearing aid. Do not place credit cards or other magnetic storage media near the device, because information stored on them may be erased.

■ Medical devices

Operation of any radio transmitting equipment, including wireless phones, may interfere with the functionality of inadequately protected medical devices. Consult a physician or the manufacturer of the medical device to determine if they are adequately shielded from external RF energy or if you have any questions. Switch off your device in health care facilities when any regulations posted in these areas instruct you to do so. Hospitals or health care facilities may be using equipment that could be sensitive to external RF energy.

Pacemakers

Pacemaker manufacturers recommend that a minimum separation of 15.3 cm (6 in) be maintained between a wireless phone and a pacemaker to avoid potential interference with the pacemaker. These recommendations are consistent with the independent research by and recommendations of Wireless Technology Research. Persons with pacemakers should:

- always keep the device more than 15.3 cm (6 in) from the pacemaker;
- not carry the device in a breast pocket; and
- hold the device to the ear opposite the pacemaker to minimise the potential for interference.

If you suspect interference, switch off your device and move the device away.

Hearing aids

Some digital wireless devices may interfere with some hearing aids. If interference occurs, consult your service provider.

■ Vehicles

RF signals may affect improperly installed or inadequately shielded electronic systems in motor vehicles such as electronic fuel injection systems, electronic antiskid (antilock) braking systems, electronic speed control systems, air bag systems. For more information, check with the manufacturer or its representative of your vehicle or any equipment that has been added.

Only qualified personnel should service the device, or install the device in a vehicle. Faulty installation or service may be dangerous and may invalidate any warranty that may apply to the device. Check regularly that all wireless device equipment in your vehicle is mounted and operating properly. Do not store or carry flammable liquids, gases, or explosive materials in the same compartment as the device, its parts, or enhancements. For vehicles equipped with an air bag, remember that air bags inflate

Additional safety information

with great force. Do not place objects, including installed or portable wireless equipment in the area over the air bag or in the air bag deployment area. If in-vehicle wireless equipment is improperly installed and the air bag inflates, serious injury could result.

Using your device while flying in aircraft is prohibited. Switch off your device before boarding an aircraft. The use of wireless teledevices in an aircraft may be dangerous to the operation of the aircraft, disrupt the wireless telephone network, and may be illegal.

■ Potentially explosive environments

Switch off your device when in any area with a potentially explosive atmosphere and obey all signs and instructions. Potentially explosive atmospheres include areas where you would normally be advised to turn off your vehicle engine. Sparks in such areas could cause an explosion or fire resulting in bodily injury or even death. Switch off the device at refuelling points such as near gas pumps at service stations. Observe restrictions on the use of radio equipment in fuel depots, storage, and distribution areas, chemical plants or where blasting operations are in progress. Areas with a potentially explosive atmosphere are often but not always clearly marked. They include below deck on boats, chemical transfer or storage facilities, vehicles using liquefied petroleum gas (such as propane or butane), and areas where the air contains chemicals or particles such as grain, dust, or metal powders.

■ Emergency calls



Important: Wireless phones, including this device, operate using radio signals, wireless networks, landline networks, and user-programmed functions. Because of this, connections in all conditions cannot be guaranteed. You should never rely solely on any wireless device for essential communications like medical emergencies.

To make an emergency call:

1. If the device is not on, switch it on. Check for adequate signal strength.
Some networks may require that a valid SIM card is properly inserted in the device.
2. Press the end key as many times as needed to clear the display and ready the device for calls.
3. Enter the official emergency number for your present location. Emergency numbers vary by location.
4. Press the call key.

If certain features are in use, you may first need to turn those features off before you can make an emergency call. If the device is in offline or flight you must change the profile to activate the phone function before you can make an emergency call. Consult this guide or your service provider for more information.

If certain features are in use, you may first need to turn those features off before you can make an emergency call. Consult this guide or your service provider for more information.

When making an emergency call, give all the necessary information as accurately as possible. Your wireless device may be the only means of communication at the scene of an accident. Do not end the call until given permission to do so.

■ Certification information (SAR)

THIS DEVICE MEETS INTERNATIONAL GUIDELINES FOR EXPOSURE TO RADIO WAVES

Your mobile device is a radio transmitter and receiver. It is designed and manufactured not to exceed the limits for exposure to radio frequency (RF) recommended by international guidelines (ICNIRP). These limits are part of comprehensive guidelines and establish permitted levels of RF energy for the general population. The guidelines were developed by independent scientific organizations through periodic and thorough evaluation of scientific studies. The guidelines include a substantial safety margin designed to assure the safety of all persons, regardless of age and health.

The exposure standard for mobile devices employs a unit of measurement known as the Specific Absorption Rate, or SAR. The SAR limit stated in the international guidelines is 2.0 watts/kilogram (W/kg)*. Tests for SAR are conducted using standard operating positions with the device transmitting at its highest certified power level in all tested frequency bands. Although the SAR is determined at the highest certified power level, the actual SAR of the device while operating can be well below the maximum value. This is because the device is designed to operate at multiple power levels so as to use only the power required to reach the network. In general, the closer you are to a base station, the lower the power output of the device.

The highest SAR value for this device when tested for use at the ear is 0.82 W/kg.

SAR values may vary depending on national reporting and testing requirements and the network band. Use of device accessories and enhancements may result in different SAR values. Additional SAR information may be provided under product information at www.nokia-asia.com.

* The SAR limit for mobile devices used by the public is 2.0 W/kg averaged over 10 grams of body tissue. The guidelines incorporate a substantial margin of safety to give additional protection for the public and to account for any variations in measurements. SAR values may vary depending on national reporting requirements and the network band. For SAR information in other regions, please look under product information at www.nokia-asia.com.

Index

A

- About your device vii
- Access codes ix
- Additional safety information 48
- Answer a call 9

B

- Battery 44
- Battery information 38
 - type 44

C

- Call functions 8
- Call register 22
- Care and maintenance 46
- Certification information (SAR) 52
- Change the covers 5
- Charge the battery 3
- Chargers and enhancements viii
- Charging and discharging 38
- Clock 33
- Contacts 20

D

- Demo mode 6

E

- Emergency calls 50
- Extras 34

F

- For your safety v

G

- Games 34
- Genuine Enhancements 43
- Getting started 1

H

- Headset HDC-5 45
- How to get started 1

I

- Insert a SIM card and battery 2

L

- Lock the keypad 7
- Loudspeaker 10

M

Make a call 8
Medical devices 48
Menu functions 14
Messages 14

N

Network services vii
Nokia battery authentication
guidelines 39

O

Operating environment 48

P

Potentially explosive environments 50

R

Reminders 34

S

Settings 24
Shared memory x
Shortcuts in the standby mode 6
SIM services 37
Switch on or off 4

V

Vehicles 49
Voice messages (Network service) 10

W

Write text 11